



Service Bulletin

File in Section: -

Bulletin No.: PIP5118

Date: September, 2013

PRELIMINARY INFORMATION

Subject: 2014 Corvette 7 Speed Manual Transmission Exchange

Models: 2014 Chevrolet Corvette
Equipped with 7 speed manual transmission RPO MEP or MEL

The following diagnosis might be helpful if the vehicle exhibits the symptom(s) described in this PI.

Condition/Concern

Product teams continually seek valuable information for engineering improvements. To assist in this effort, the 2014 Chevrolet Corvette 7 Speed Manual Transmission P/Ns 24255978, 24255981 will be a GM Product Quality Center (PQC) Parts Restriction/ Exchange program. Dealerships are required to call the PQC, not GM Technical Assistance (TAC), to request an exchange. The PQC may refer the dealer technician to TAC if additional diagnosis is required. TAC will be available for product inquiries that do not require assembly replacement.

Recommendation/Instructions

The Tremec 7 speed manual transmission (TR6070) used in this vehicle is currently not internally serviceable and must be replaced as an assembly.

DO NOT disassemble the unit to determine root cause or point of failure. See the following illustrations for a list of serviceable items.

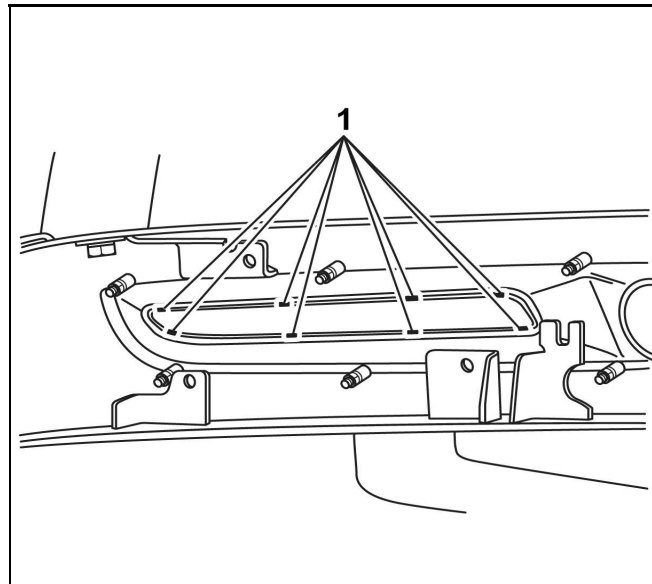

3605559

Item 29 Transmission Fluid Cooler Pipe Quick Connect Fitting

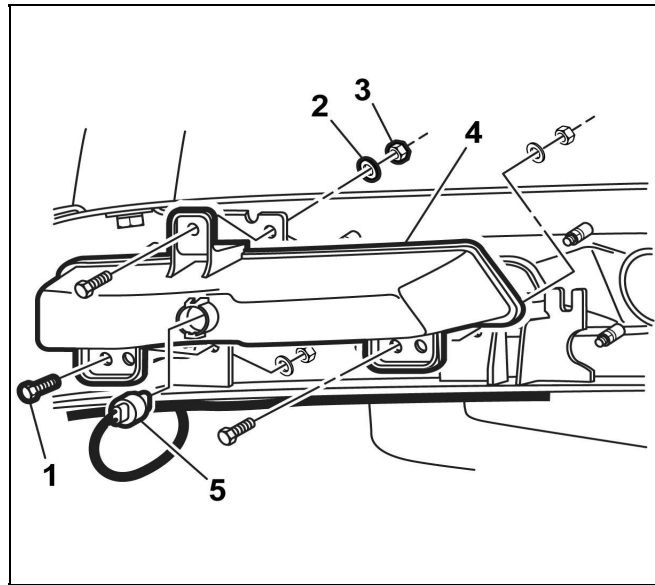

3605560

- 4 Manual Transmission Reverse Gear Blockout Solenoid
- 5 Manual Transmission Reverse Gear Blockout Solenoid O-Ring Seal
- 6 Reverse Lockout Solenoid Cover Shoulder Bolt
- 7 Reverse Lockout Solenoid Cover Hex Bolt
- 8 Wiring Harness Bracket
- 9 Manual Transmission Reverse Gear Blockout Solenoid Housing
- 10 Manual Transmission Reverse Gear Blockout Solenoid Housing Gasket
- 11 Shift Shaft Detent Spring
- 12 Shift Shaft Detent Roller
- 15 Backup Lamp Switch
- 20 Manual Transmission Fluid Temperature Sensor
- 21 Skip Shift Solenoid
- 22 Transmission Oil Fill Plug
- 23 Transmission Fluid Cooler Pipe Quick Connect Fitting

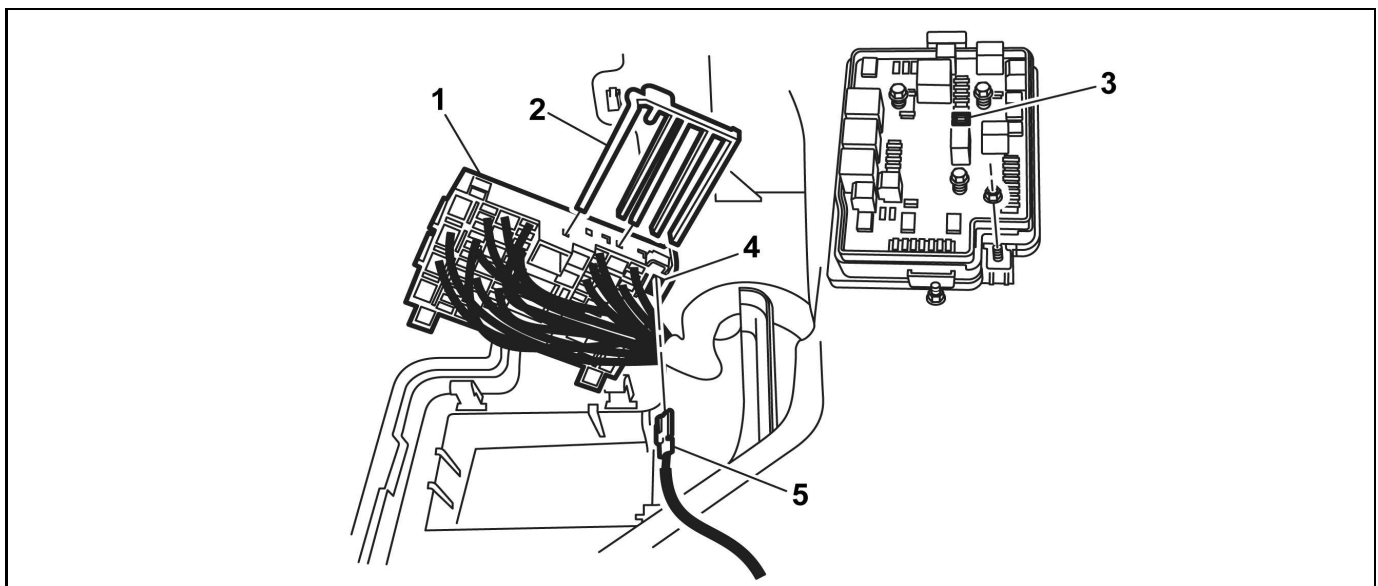

3605561

- 3 Main Shaft Rear Outer Seal
- 4 Manual Transmission Gear Position Sensor Gasket

5 Manual Transmission Gear Position Sensor
6 Manual Transmission Gear Position Sensor Bolt
7 Transmission Gap Magnet Bolt
8 Transmission Gap Magnet
9 Transmission Speed Sensor Bolt
10 Manual Transmission Output Speed Sensor
11 Vehicle Speed Sensor O-ring Seal
27 Transmission Oil Drain Plug

Prior to calling the PQC, please make sure to complete the 2014 Chevrolet Corvette 7 Speed transmission exchange template in this PI. Use of the templates will minimize the time spent on the telephone and avoid the need of a second call to the PQC. Guidelines for honoring exchange requests under this program are being strictly enforced.

Caller's Name/Position:

Technician's Direct Phone:

Dealer Parts Manager Name:

Parts Manager's Fax Number:

Dealership's Correct Address (NO P.O. BOX):

Q1: What was the customer's concern?

Q2: Has dealer completed questions in PIP5118 for the Corvette 7 Speed Manual Transmission Exchange and reviewed for the Serviceable Components?

(If no, dealer MUST complete PI and call back)

Q3: Has the vehicle been modified with non-production accessories?

Q4: Is the vehicle for personal or commercial use?

If commercial, what type of use?

Q5: Broadcast Code:

Q6: Serial Number:

Q7: Does the vehicle have any DTCs in the ECM/BCM?

Note: GDS must be launched from TIS to make sure all the data is captured and can be retrieved.

Q8: Describe the failure of the Corvette 7 Speed Manual Transmission:

Q9: Leaks

Any leaks?

What type of leak?

Where is the leak located?

Q10: Noise

Any noise?

What kind of noise?

Where is it?

What is the frequency of noise?

When does it occur?

How long does it last?

At what temperature does it occur?

Q11: Lubrication

Lubrication Level?

Any signs of oil contamination?

Q12: Performance

Any performance concerns?

Any vibration?

Warranty Information

For vehicles repaired under warranty use:

Labor Operation	Description	Labor Time
8441780	Transmission Replacement	Use Published Labor Operation Time

If the transmission is exchanged dealers are allowed to claim \$250.00 parts allowance for the transmission.

Please follow this diagnostic or repair process thoroughly and complete each step. If the condition exhibited is resolved without completing every step, the remaining steps do not need to be performed.