

© 2013 Mazda Motor of America, Inc.

Subject: MIL ON WITH DTC P2610	Bulletin No: 01-001/13
	Last Issued: 01/16/2013

BULLETIN NOTE

- This bulletin supersedes the previous bulletin 01-001/13, issued on 01/07/13. The DESCRIPTION has been revised.
- Changes are noted below in Red beside the change bar.

APPLICABLE MODEL(S)/VINS

2014 Mazda6

2013-2014 CX-5

DESCRIPTION

Some vehicles may experience MIL illumination with DTC P2610 (Instrument cluster internal engine off timer performance problem) stored in memory after engine start and room fuse 15A (A) removed.

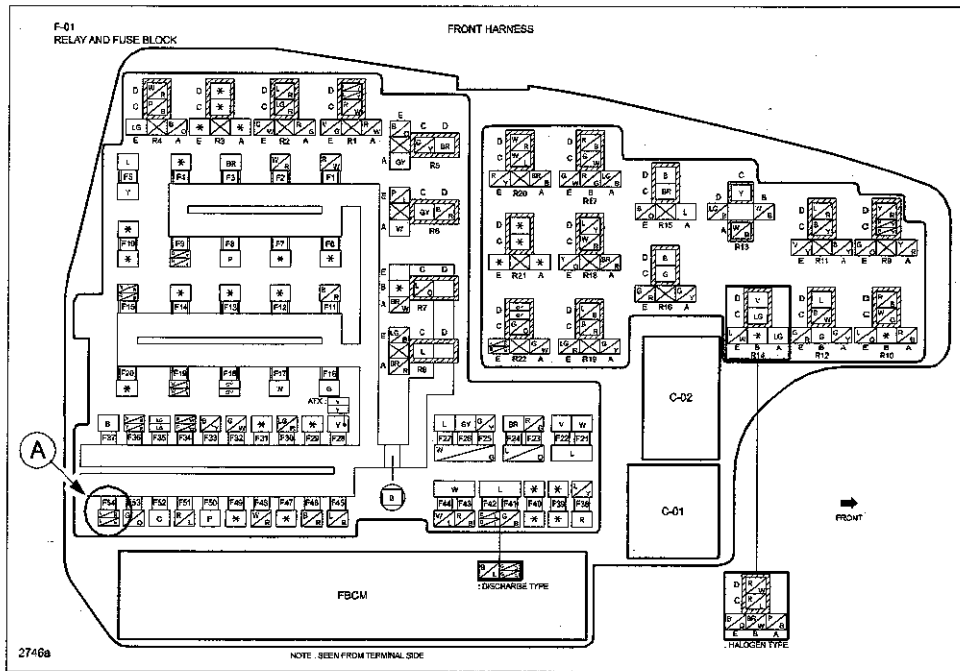

CONSUMER NOTICE: The information and instructions in this bulletin are intended for use by skilled technicians. Mazda technicians utilize the proper tools/equipment and take training to correctly and safely maintain Mazda vehicles. These instructions should not be performed by "do-it-yourselfers." Customers should not assume this bulletin applies to their vehicle or that their vehicle will develop the described concern. To determine if the information applies, customers should contact their nearest authorized Mazda dealership. Mazda North American Operations reserves the right to alter the specifications and contents of this bulletin without obligation or advance notice. All rights reserved. No part of this bulletin may be reproduced in any form or by any means, electronic or mechanical—including photocopying and recording and the use of any kind of information storage and retrieval system—without permission in writing.