

Authorized Field Change

NAVISTAR®

AFC 13908

Date: April 2013

Subject File: Clutch

Subject: 9900® and Paystar® Clutch Adjustment for Certain Vehicles Marked in Service PortalSM with AFC 13908

Model: 9900® and PayStar®

Start Date: 25 May 2010 End Date: 17 October 2012

DESCRIPTION

Certain 9900® and PayStar® models may not be able to obtain the proper clutch adjustment specification. If the clutch is not adjusted properly, this can cause improper clutch pedal free play, or the clutch brake may not function properly. If the clutch cannot be adjusted correctly, this AFC provides the service procedures to replace the vertical clutch rod and bell crank (clutch relay lever).

This AFC applies only to vehicles marked in Service PortalSM with AFC 13908.

PARTS INFORMATION

Table 1. **Parts Information**

Part Number	Description	Quantity
3524181C93	Rod Assembly, Control Clutch	1
3532753C1	Lever, Clutch Relay (Bell Crank)	1

SERVICE PROCEDURE

 **WARNING:** Park vehicle on hard flat surface, turn the engine off, set the parking brake, and block the wheels to prevent the vehicle from moving in both directions. Failure to do so may result in property damage, personal injury, and / or death.

 **WARNING:** If the vehicle must be raised, do not work under the vehicle supported only by jacks. Jacks can slip or fall over, potentially resulting in property damage, personal injury, and / or death.

 **WARNING:** Always wear safe eye protection when performing vehicle maintenance. Failure to do so may result in personal injury and / or death.

 **WARNING:** Keep flames or sparks away from vehicle and do not smoke while servicing the vehicle's batteries. Batteries expel explosive gases. Failure to do so may result in property damage, personal injury, and / or death.

 **WARNING:** Remove the ground cable from the negative terminal of the battery box before disconnecting any electrical components. Always connect the ground cable last. Failure to do so may result in property damage, personal injury, and / or death.

Removal Procedure

1. Bring truck into shop and park on flat surface.
2. Shift transmission to Park or Neutral, set parking brake, and install wheel chocks.
3. Open hood.

NOTE: For additional information, refer to appropriate Service Manual.

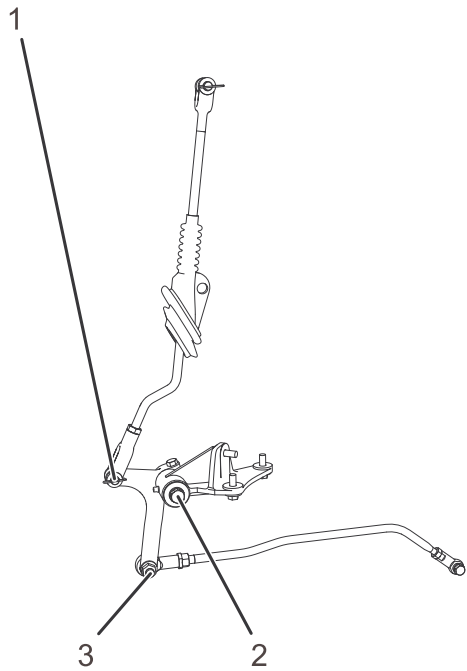

0000047857

Figure 1. Clutch Relay Lever (Bell Crank Lever).

1. Clutch rod vertical linkage
 2. Clutch relay lever connection to bracket
 3. Clutch relay lever horizontal linkage
4. Disconnect clutch rod vertical linkage (Figure 1, Item 1) from clutch relay lever (bell crank).
 5. Disconnect horizontal linkage (Figure 1, Item 3) from clutch relay lever.
 6. Remove clutch relay lever (Figure 1, Item 2) from clutch relay lever bracket.

Installation Procedure

1. Install new clutch relay lever (Figure 1, Item 2) on clutch relay lever bracket.
2. Install horizontal linkage (Figure 1, Item 3) to clutch relay lever.
3. Install new vertical clutch rod linkage (Figure 1, Item 1) to clutch relay lever.

NOTE: Make sure all spring clips are properly installed in the clevis pins.

4. Verify clutch adjustment. Refer to appropriate Service Manual for clutch adjustment.
5. Close and latch hood.
6. Remove wheel chocks.

LABOR INFORMATION

Operation number must appear on all claims.

Table 2. Labor Information

Operation No.	Description	Time
A40-13908-1	R&R Clutch Bell Crank Lever	1.0 hr
A40-13908-2	Clutch Adjustment (If Needed)	0.5 hr

ADMINISTRATIVE PROCEDURE

Expense is to be charged to Warranty. Claims are to be submitted in the normal manner, making reference to Authorized Field Change Number 13908.

It is important that the coding be completed properly to assist in processing the warranty claim. Complete instructions will be found in the Warranty Policy Manual, Section 7.1.8.

As with all claim submissions, items acquired locally must be submitted in the "Other Charges" tab. The cost of any bulk items (such as a bag of cable tie straps, roll of wire, barrel of oil, or tube of silicone) should be prorated for the cost of the individual pieces / amount used during each repair.

To ensure this important improvement is made in a timely manner, all claims for 13908 activity must be submitted by 30 April 2014 or within the normal warranty period for the vehicle, if after 30 April 2014.

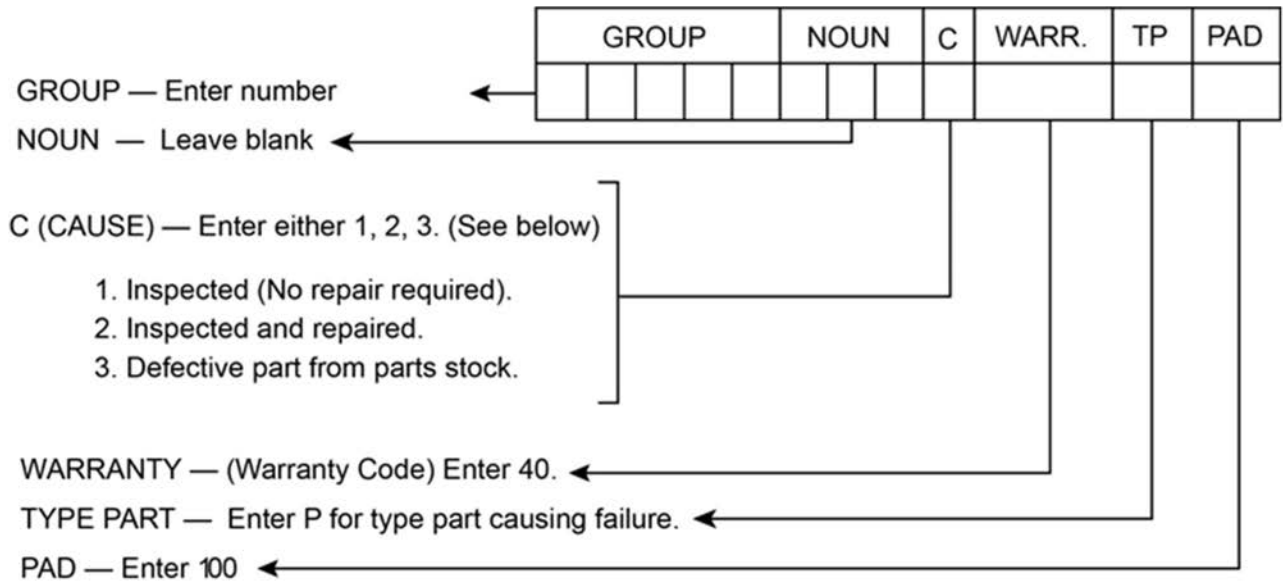

0000047910