



SERVICE BULLETIN

Classification: EL12-003	Reference: NTB13-008	Date: June 17, 2013
------------------------------------	--------------------------------	-------------------------------

2007-2012 SENTRA; STEERING WHEEL SWITCH SERVICE PARTS

APPLIED VEHICLES: 2007-2012 Sentra (B16)

SERVICE INFORMATION

If you confirm there is a need to replace the steering wheel switches on an Applied Vehicle for any reason:

- Do not replace the driver air bag module. The steering wheel switches are now available as a separate service part.
- Refer to the Service Procedure in this bulletin for steering wheel switch removal and installation instructions.



Steering Wheel Switch Service Parts

Nissan Bulletins are intended for use by qualified technicians, not 'do-it-yourselfers'. Qualified technicians are properly trained individuals who have the equipment, tools, safety instruction, and know-how to do a job properly and safely. NOTE: If you believe that a described condition may apply to a particular vehicle, DO NOT assume that it does. See your Nissan dealer to determine if this applies to your vehicle.

PARTS INFORMATION

DESCRIPTION	PART NUMBER	QUANTITY
SW ASSY-STRG	Reference an electronic parts catalog (FAST or equivalent) for the part number applicable to your vehicle	1
Bolt (for driver air bag module)	01121-0030U	2
Tapping Screw	01461-0013U	4*

*Only 2 Tapping Screws are needed if the steering wheel is not equipped with audio switches.

CLAIMS INFORMATION

Please refer to the Online Warranty Flat Rate Manual.

SERVICE PROCEDURE

IMPORTANT: Follow all cautions, warnings, and notes in the Electronic Service Manual (ESM) when working on or near a Supplemental Restraint System (SRS), such as an airbag.

1. Write down all radio station presets.

Presets	1	2	3	4	5	6
A						
B						
C						
SAT						

2. Disconnect both battery cables, negative cable first.
3. After disconnecting the battery cables, wait at least three minutes before proceeding with step 4.

4. Remove the Driver Air Bag Module.

- Refer to section **SRS, Driver Air Bag Module > Removal and Installation** in the applicable ESM for removal instructions.

5. Disconnect the horn connector. See Figure 1.

6. Using a suitable tool, gently pry open the three (3) harness retaining clips and release the harness. See Figure 1.

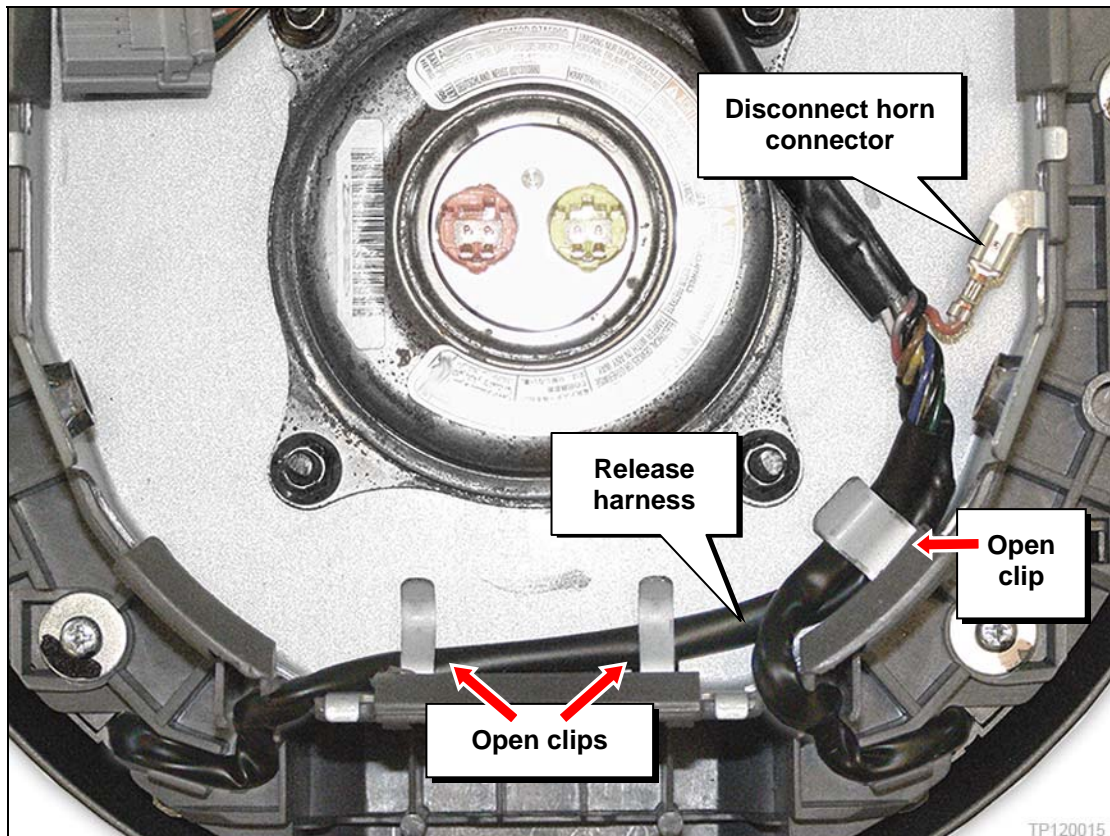

Figure 1

7. Remove the steering wheel switch screws.

- Remove four (4) screws if the steering wheel is equipped with audio switches.
- Remove two (2) screws if the steering wheel is not equipped with audio switches.

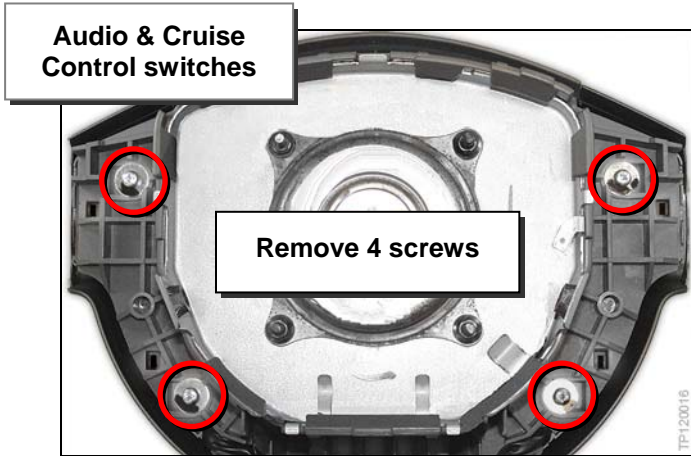

Figure 2

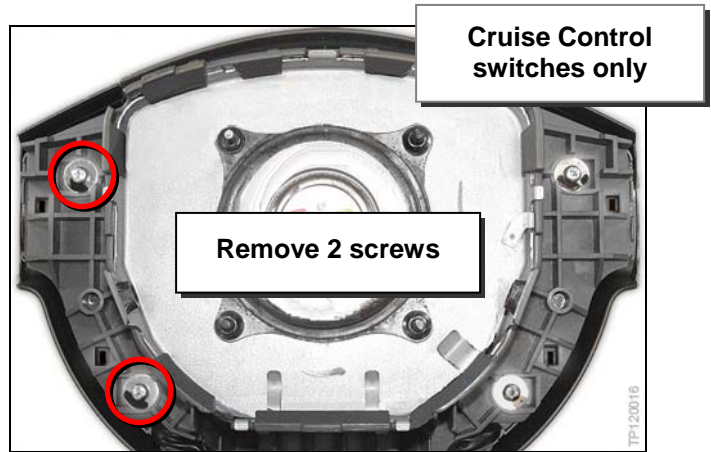

Figure 3

8. Detach the steering wheel switches from the driver air bag module by releasing the tabs.

- Each steering wheel switch part (RH or LH) has two (2) tabs.
- To release the tabs, pull the edge of the steering wheel switch part away from the air bag module.

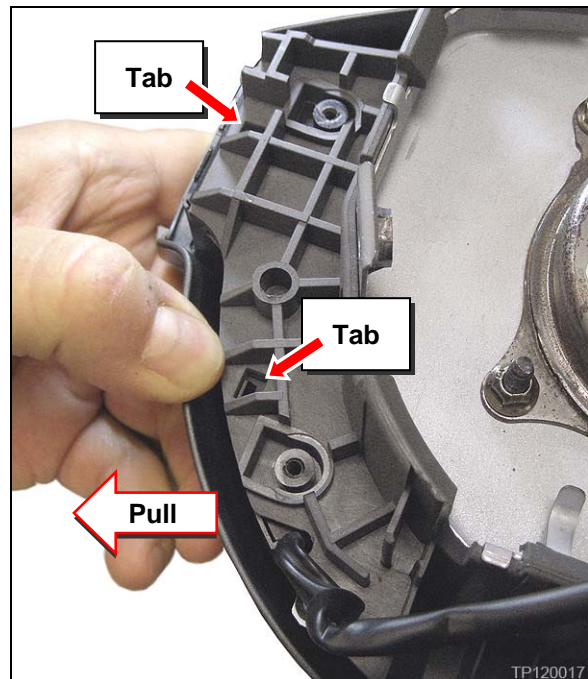

Figure 4

9. Attach the new steering wheel switches to the driver air bag module.

NOTE: Make sure all tabs (2 tabs per steering switch part) are aligned and have clicked/locked into place.



Figure 5



Figure 6

10. Install the new steering wheel switch screws listed in the Parts Information section. See Figures 2 and 3 for location of screws.

- DO NOT overtighten.

11. Confirm there are no gaps between the driver air bag module and the steering wheel switches.

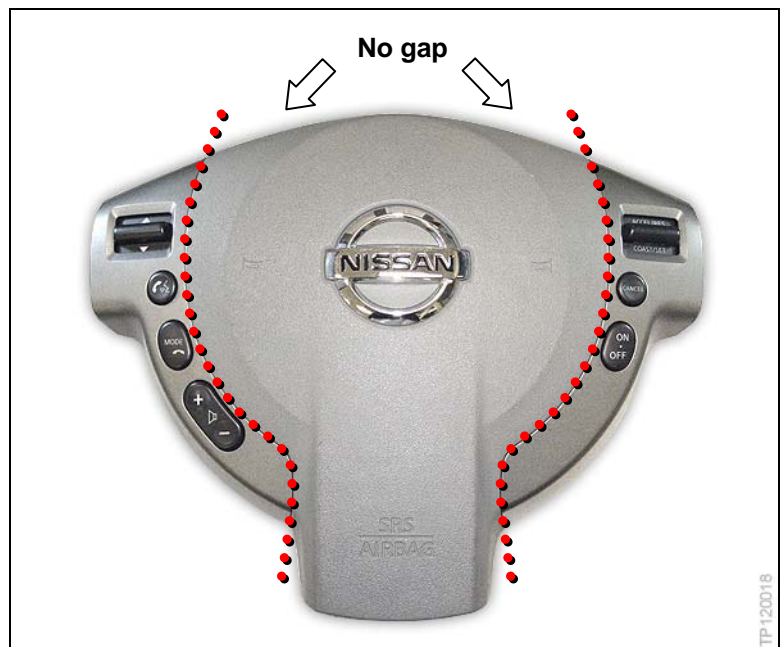

Figure 7

12. Route the harness through the three (3) retaining clips and close the retaining clips.

13. Reconnect the horn connector.

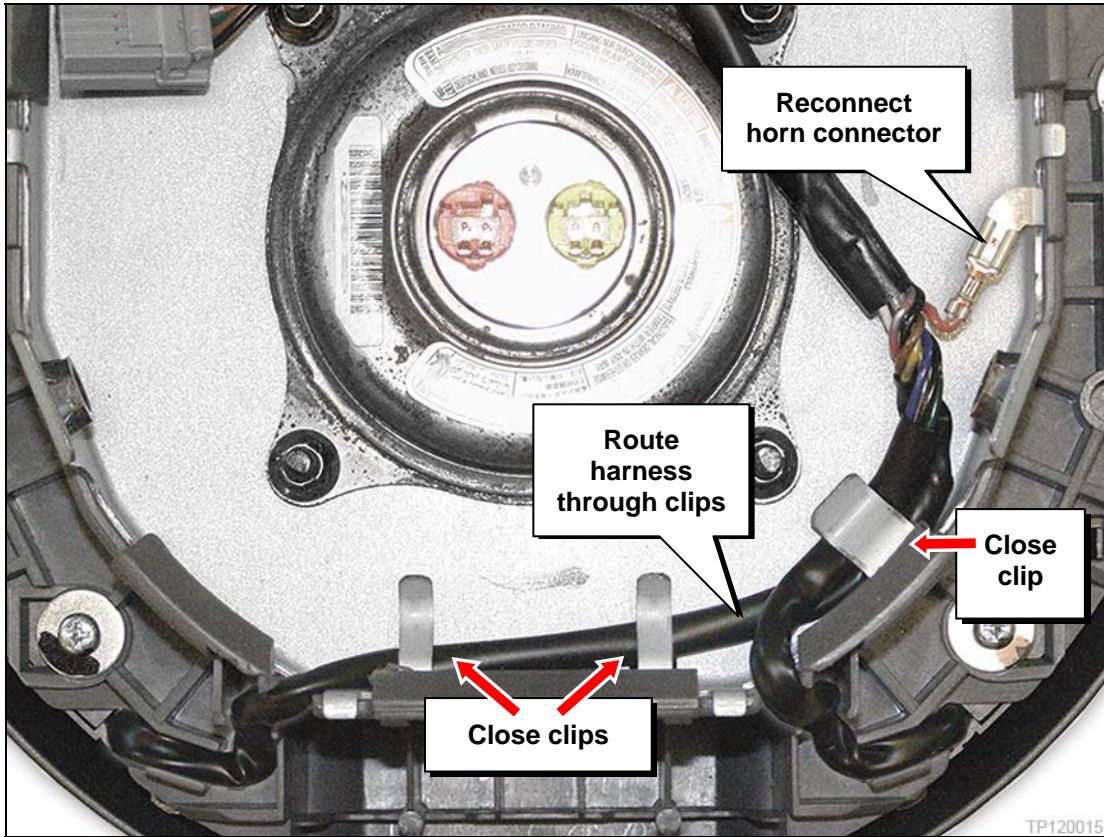

Figure 8

14. Reinstall the Driver Air Bag Module.

- Refer to section **SRS, Driver Air Bag Module > Removal and Installation** in the applicable ESM for installation instructions.
- For instructions on how to install the direct-connect SRS connectors, refer to section **SRC, Supplemental Restraint System > Direct-connect SRS Component Connectors** in the applicable ESM.

15. Reconnect the battery cables, negative cable last.

16. Perform SRS operation check.

- Refer to section **SRC, Trouble Diagnosis > SRS Operation Check** for instructions.

17. Reset the radio station presets.

