



Applies To: **2012 Civic Natural Gas** – Check the iN VIN status for eligibility

May 15, 2013

Product Update: Fuel Fill Pipe Leaks

(Supersedes 13-037, dated April 16, 2013, to revise the information marked by the black bars)

REVISION SUMMARY

- Under PARTS INFORMATION, the number of fuel pipe O-rings was changed.
- Under REPAIR PROCEDURE, steps were changed.
- An example of the customer letter was added.

BACKGROUND

During manufacturing, the fuel fill pipe end may not have been finished properly, which may result in a small leak between the fuel receptacle and the fuel fill pipe. The leak would only occur during fueling, and the customer may notice a hissing or may smell a gas odor. The gas in the tank will not leak out because a check valve in the tank does not let gas flow back to the fuel fill pipe.

CUSTOMER NOTIFICATION

Owners of affected vehicles will receive a notification of this product update starting in May 2013.

Before doing work on a vehicle, verify its eligibility by doing an iN VIN status inquiry.

Some vehicles affected by this campaign may be in your new or used vehicle inventory. Repair these vehicles before they are sold.

CORRECTIVE ACTION

Replace the fuel fill pipe and fuel receptacle adapter.

NOTE: You must be a Honda NGV-Certified Technician to do the fuel fill pipe replacement work.

PARTS INFORMATION

Fuel Fill Pipe A: P/N 17713-TR5-A00

Fuel Receptacle Adapter: 17664-SNF-A01

Fuel Pipe O-ring (two required): P/N 91067-S1G-B01

Valve Stem Assembly: P/N 17552-S1G-010

O-ring: P/N 91071-S1G-003

REQUIRED MATERIALS

PAG Oil: P/N 38897-P13-A01AH

Honda Brake Cleaner: P/N 08700-9201

Snoop Leak Detector Fluid: (order from *Swagelok.com*)

WARRANTY CLAIM INFORMATION

NOTE:

- You must have DPSM authorization when adding a letter code to fill the tank.
- Only one letter code can be added per claim.
- Each letter code covers the round trip to and from the filling station.

OP#	Description	FRT
3101W9	Replace fuel fill pipe, and drive up to five miles to fill CNG tank and check for leaks.	1.2
A	Drive 6-12 miles to fill tank.	0.2
B	Drive 13-20 miles to fill tank.	0.4
C	Drive 21-28 miles to fill tank.	0.6
D	Drive 29-36 miles to fill tank.	0.8
E	Drive 37-44 miles to fill tank.	1.0
F	Drive 45-52 miles to fill tank.	1.2
G	Drive 53-60 miles to fill tank.	1.4
H	Drive 61-68 miles to fill tank.	1.6
J	Drive 69-76 miles to fill tank.	1.8
K	Drive 77-83 miles to fill tank.	2.0

Failed Part: P/N 17713-TR5-A00

Defect Code: 5GX00

Symptom Code: S9200

Skill Level: Repair Technician
(Honda NGV Certified)

REPAIR PROCEDURE

NOTE: You must be a Honda NGV-Certified Technician to do the fuel fill pipe replacement work.

1. Place the vehicle on a lift, then remove the key from the ignition switch.
2. Raise the vehicle, and remove the left rear wheel.
3. Close the manual shut-off valve.
4. Remove the fuel pipe fill protector.

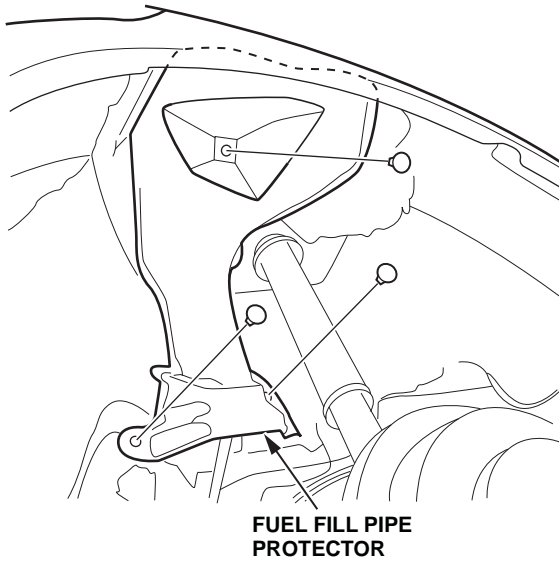

5. Remove the fuel receptacle cover.
 - Remove the two bolts from the fuel receptacle bracket and the two bolts on the support bracket; this allows the receptacle to be shifted and make it easier to remove the fuel receptacle cover.

View looking up through the wheelwell

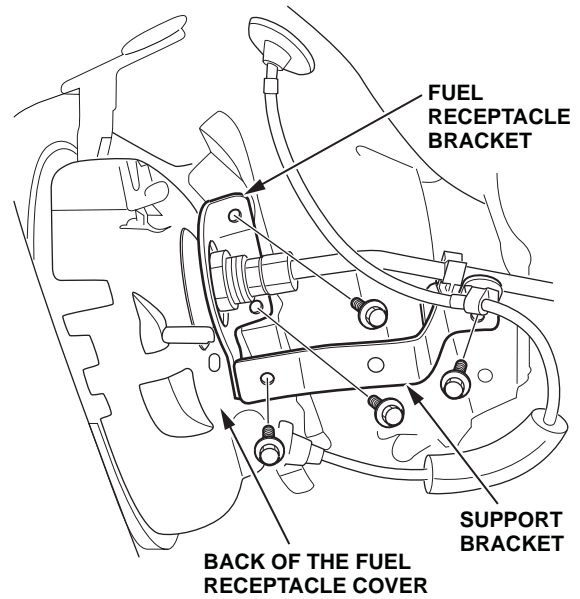

- Remove the fuel fill door switch from the fuel receptacle cover.

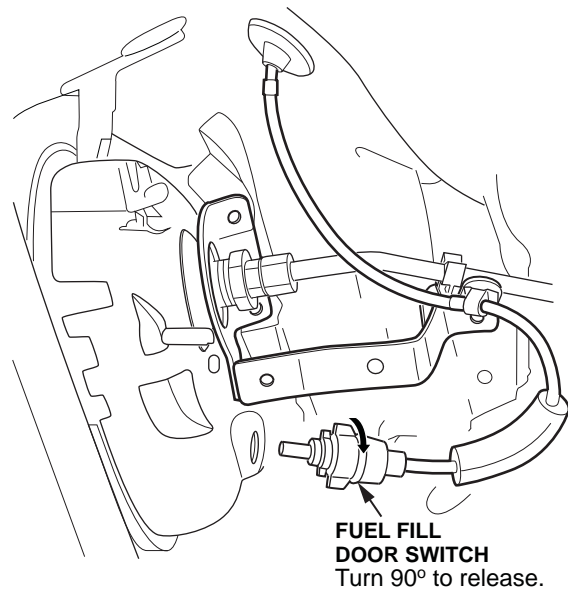

- Remove the bolt from the fuel fill pipe support.



**FUEL FILL
PIPE SUPPORT**
Unbolt.

- Lower the vehicle, open the fuel fill door and remove the screw securing the fuel receptacle cover.

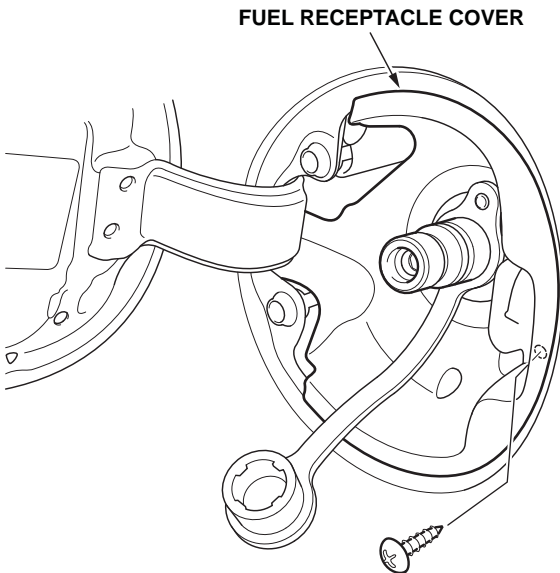

- Remove the rubber fuel receptacle protector.

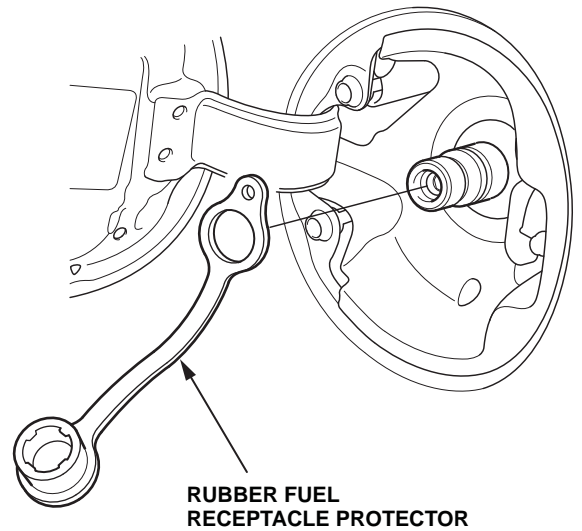

- Remove the fuel receptacle cover through the fuel fill door opening.

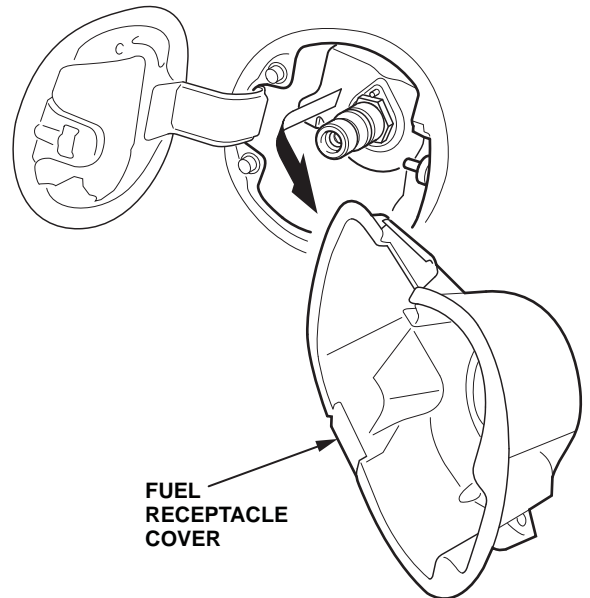

6. Remove the rear floor undercover.

NOTE: 2011 Natural Gas vehicle is shown, the 2012 is similar.

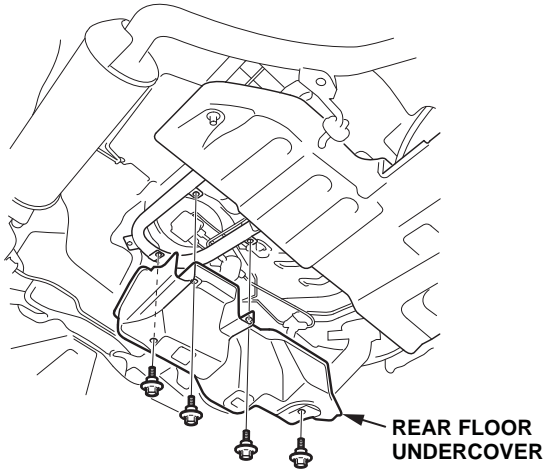

7. Remove the rear floor under bar.

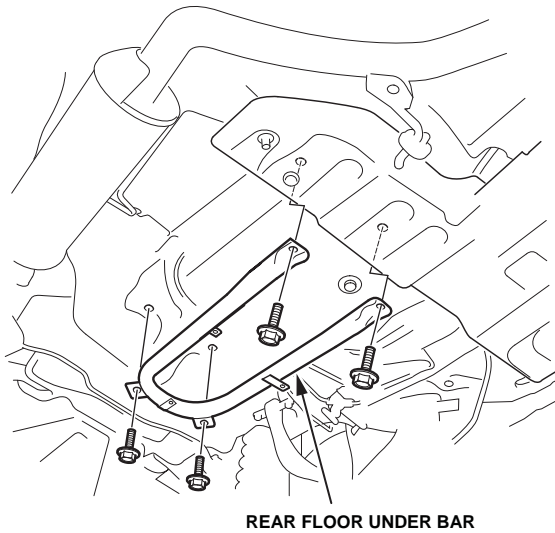

8. Remove the sealing bolt covering the fuel stem assembly.

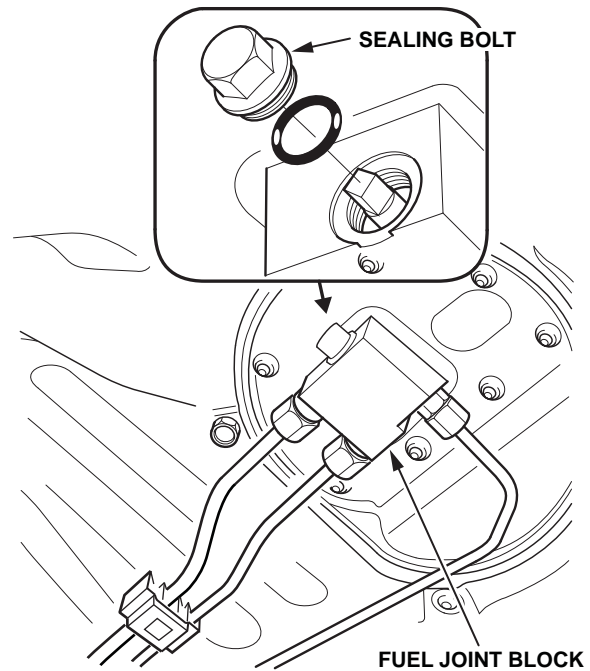

9. Turn the fuel stem counterclockwise 1/4 turn at a time until the pressure in the fuel line between the tank and the receptacle is released. Wait about 1 minute for the pressure to release, then remove the fuel stem from the joint block.

NOTE: If the fuel does not stop venting after about 1 minute, there may be a faulty check valve. Tighten the fuel stem and reinstall the sealing bolt. Contact Tech Line for further instructions.

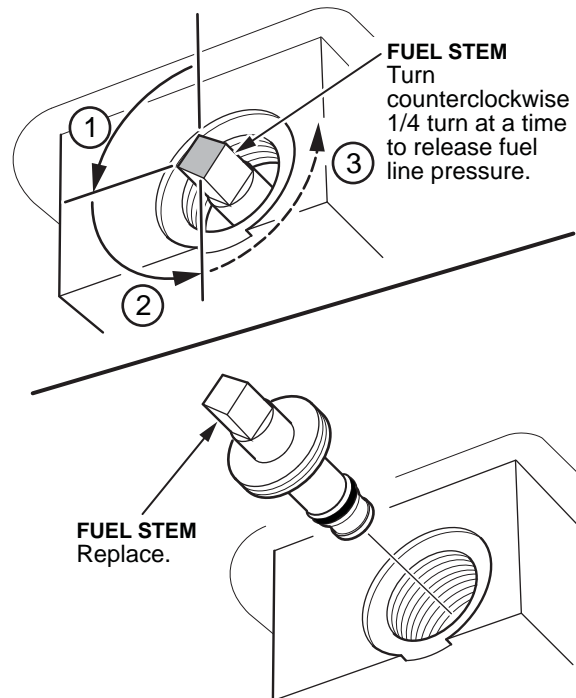

10. Replace the fuel stem and reinstall the sealing bolt.

> O-ring

> Fuel Stem

- Lubricate the fuel stem O-ring with PAG oil.
- Torque the fuel stem to **44 N•m (33 lb-ft)**.
- Lubricate the sealing O-ring with PAG oil.
- Torque the sealing bolt to **71 N•m (52 lb-ft)**.

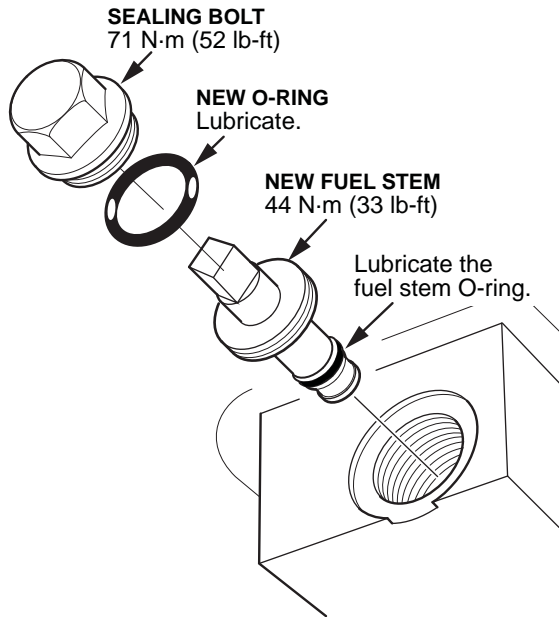

11. Disconnect the fuel fill pipe from the fuel joint block, then remove the O-ring.

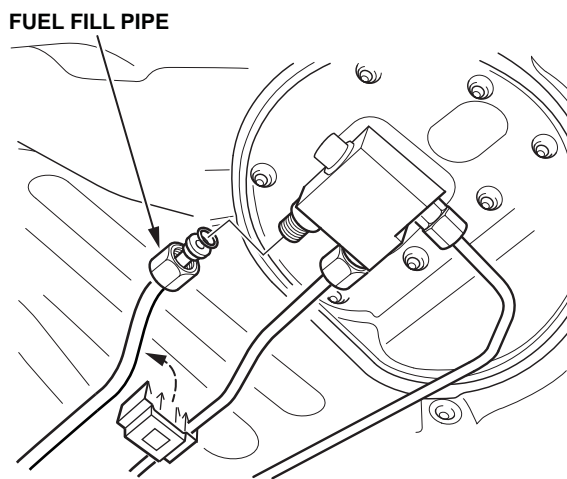

12. Remove the fuel fill pipe, the support, and the receptacle as a unit.

13. Disconnect the fuel fill pipe from the fuel receptacle.

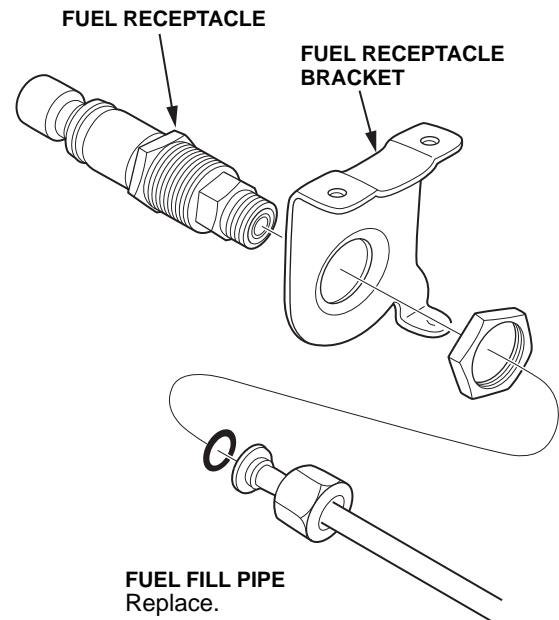

14. Remove the fuel receptacle from the bracket by loosening the large nut.

15. Clean the fuel receptacle rear fitting with Honda brake cleaner to remove any dirt, dust or corrosion from the fitting.

16. Place the fuel receptacle in a vise and remove the fuel receptacle adapter.

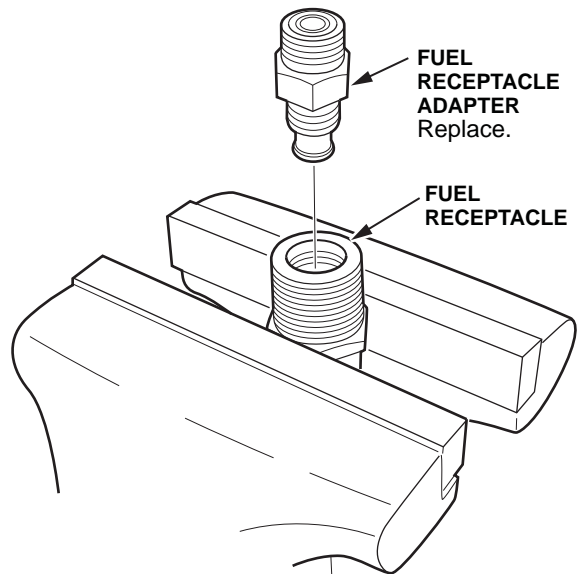

17. Check that the receptacle body and sealing surface are clean. Make sure there are no rag or paper fibers left on the sealing surface after cleaning.

NOTE: Do not put any lubrication on the adapter, as the new O-ring has its own lubrication.

18. Install the new fuel receptacle adapter and torque it to **54 N•m (40 lb-ft)**.

> Fuel Receptacle Adapter

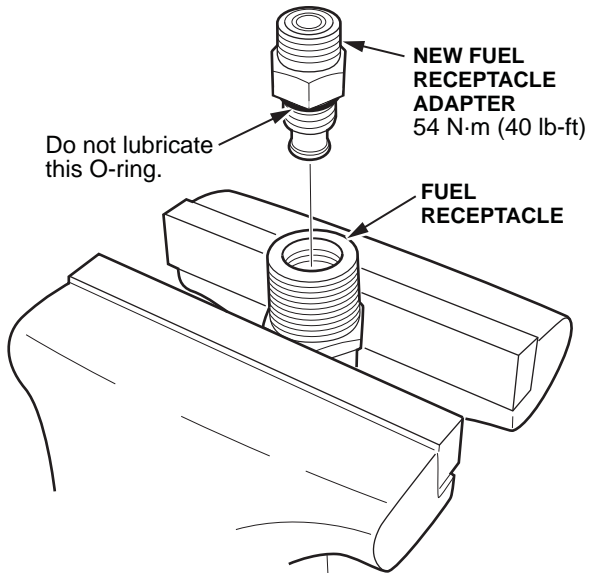

19. Reinstall the fuel receptacle bracket and torque the large nut to **82 N•m (111 lb-ft)**.

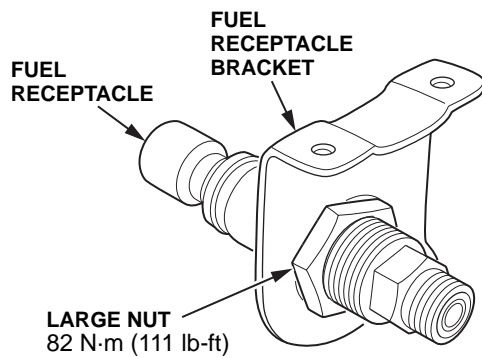

20. Reinstall the fuel receptacle cover into the vehicle.

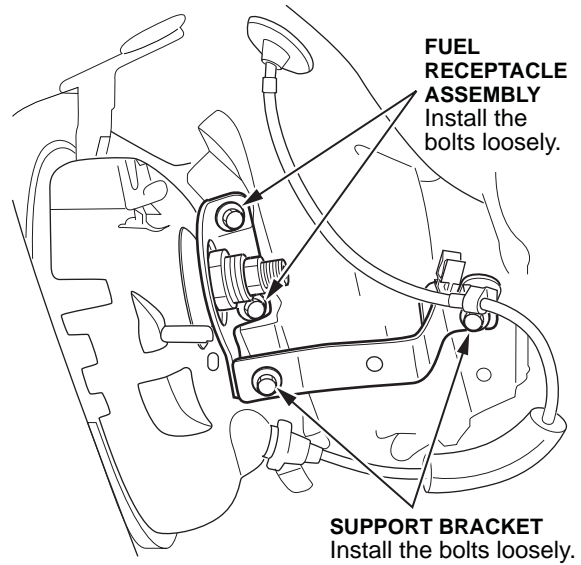

21. Reconnect the fuel fill door switch.

22. Reinstall the fuel receptacle, but leave the two bolts loose.

23. Reinstall the support bracket, but leave the two bolts loose.

24. Install the new fuel fill pipe.

> Fuel Fill Pipe A

> Fuel Pipe O-ring (2)

- Lubricate the O-ring on the fuel receptacle adapter with PAG oil.
- Hand-tighten the fuel pipe nut until it's snug. Make sure the O-ring stays in place.
- Lubricate the O-ring between the fuel fill pipe and joint block with PAG oil.
- Hand-tighten the fuel pipe nut until it's snug. Make sure the O-ring stays in place.
- First, torque the upper fitting to **47 N•m (35 lb-ft)**, then torque the lower fitting to **47 N•m (35 lb-ft)**.

NOTE: When torquing one fitting, make sure that you use a back-up wrench on the other fitting.

- Reinstall the fuel fill pipe support bolt.

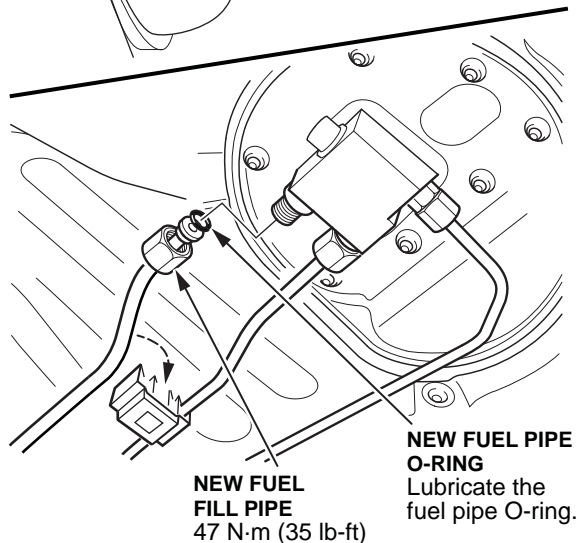
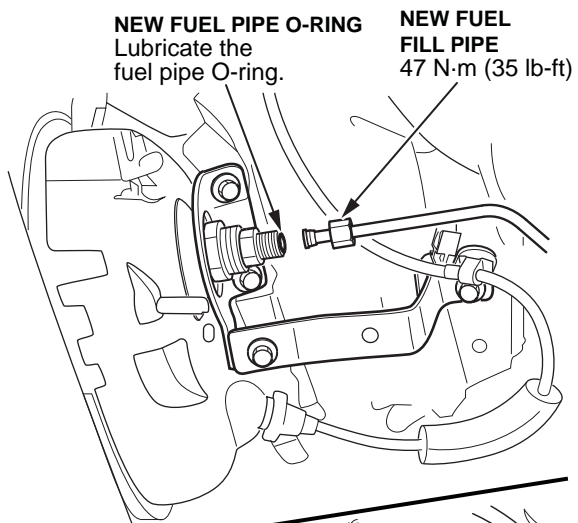

25. Torque the fuel receptacle mounting bracket bolts and the two bolts on the support bracket to **10 N•m (7 lb-ft)**.

NOTE: Do not let the bracket shift, which could misalign the fuel fill line.

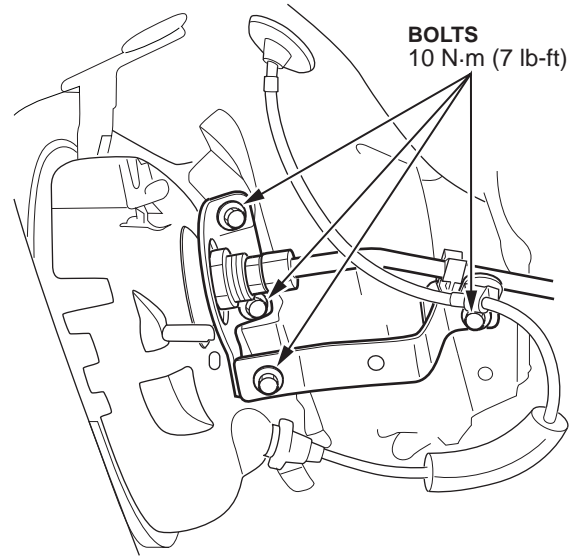

26. Reinstall the wheel.

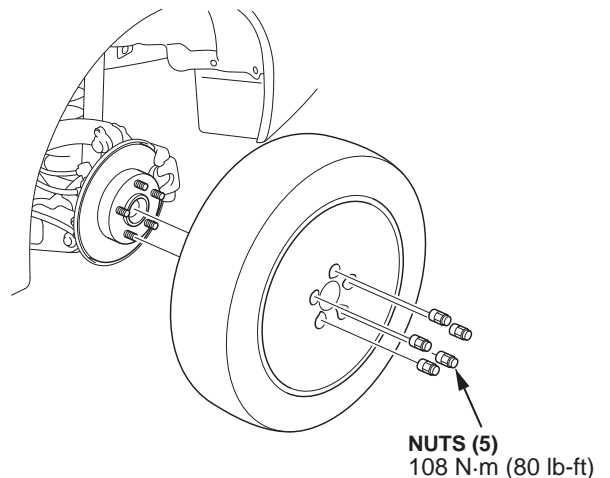

27. Turn the manual valve to the open position, then start the engine.

NOTE: Do not reinstall the covers until after you do a leak check.

28. Drive to a refueling station.

NOTE: If you have to travel to a refueling station, make sure you bring a jack, jack stand, and Snoop or electronic leak detector. Do not drive the vehicle back to the dealership before doing the leak check. If there is a leak, you have to diagnose it quickly because the fuel fill pipe will lose pressure and your leak check will not be effective.

29. Fill the tank to 3600 psi. While the tank is filling, listen for any leaks. After the filling is done, remove the fueling nozzle and listen again for leaks.

- If you can't hear any leaks, go to step 30.
- If you can hear a fuel leak, fix the leak, then refill the vehicle and listen for fuel leaks again.

30. Move the vehicle to a safe area close by, where you can safely jack up the rear part of the vehicle. Jack up the rear of the vehicle on the driver's side, and support the vehicle with a jack stand.

31. Using a snoop leak detector, check for leaks in all these areas:

- Between the adapter and the receptacle

View looking up through the wheelwell

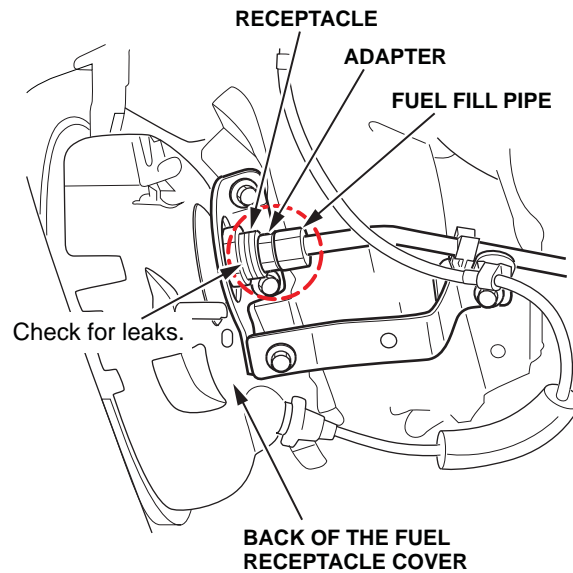

- Between the fuel fill pipe and the adapter
- Between the fuel fill pipe and the joint block

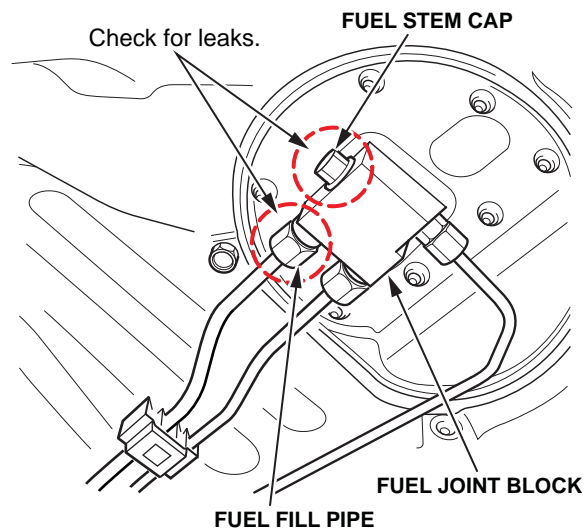

- Between the fuel stem cap and the joint block body
 - If any leaks are found, check the O-rings and sealing surfaces for defects or debris on the sealing surface. Clean or replace parts as needed, then repeat the leak check.
 - If no leaks are found, go to step 32.

32. Reinstall the fuel fill pipe protector.

33. Reinstall the rear floor under bar and the rear floor undercover.

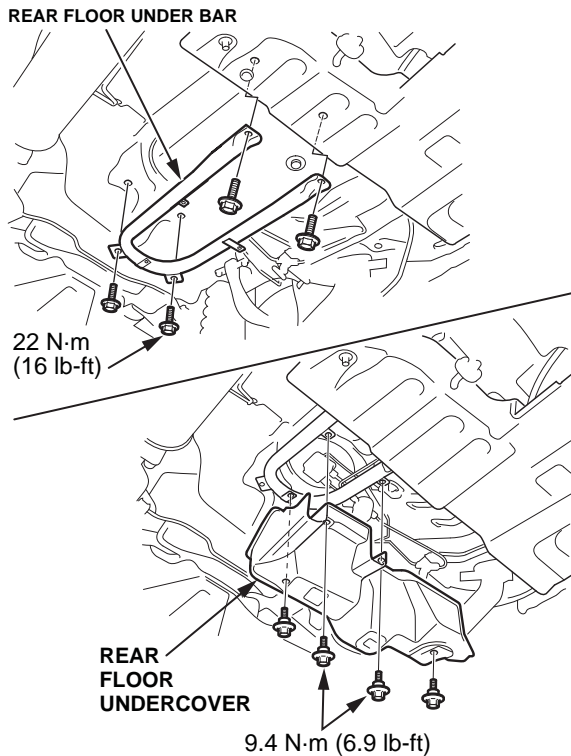

34. Make sure the fuel fill door works properly. Also, make sure that when the engine is running the fuel lid message does not come on in the MID.

35. **For California Residents Only:** Fill out a Vehicle Emissions Recall - Proof of Correction certificate, and use **S92** as the recall number. Give the certificate to your customer, and advise him or her to keep it as proof that the product update was completed. Your customer will need to submit the certificate to the DMV only if the DMV requests it.

If you need more certificates, contact Helm Inc. at **800-782-4356**, and use reorder number **Y0657**.

Vehicle Emission Recall - Proof of Correction				
License Number	Make	Year Model	Body Type	Vehicle Identification Number
Manufacturer _____			Recall Number S92	
The above described vehicle has been repaired, modified and/or equipped with new emission control devices to meet applicable California Emission Control Laws.				
Dealer's Name		Address, City, State and Zip		
Date		Dealership's Authorized Signature		
		X		
Return this certificate to DMV <u>only</u> when required - otherwise retain for your records.				
Y0657		ACL 24832 (0212)		

Example of Customer Letter

May 2013

Product Update: Fuel Fill Pipe Leaks

Dear Civic Natural Gas Owner:

This letter is to notify you of a potential problem with your vehicle and what you should do to resolve it.

What is the problem?

There may be a small leak between the fuel receptacle and the fuel fill pipe. The leak would only occur during fueling, and you may notice a hissing or smell a gas odor.

What should you do?

Contact any authorized Honda dealer for an appointment to have your vehicle's fuel fill pipe replaced. This work will be done free of charge. Please plan to leave your vehicle at the dealer for a day to allow them flexibility in scheduling.

California Owners Only

After completing the repair procedure, your dealer will give you a Vehicle Emission Recall - Proof of Correction certificate. Please make sure the dealer completes and gives you the certificate. Keep the certificate for your records as proof that the emissions recall was completed. Submit the certificate to the DMV only if the DMV requests it.

Because this Product Update campaign affects the vehicle's emission system, the California DMV treats it as an emission recall and will not renew your registration until after your vehicle has been repaired.

Lessor Information

If this is a leased vehicle, and you are the lessor/registered owner, please forward a copy of this notice to the lessee.

What to do if you feel this notice is in error

Our records show that you are the current owner or lessee of a 2012 Civic Natural Gas involved in this product update. If this is not the case, or the name/address information is not correct, please fill out and return the enclosed, postage-paid Information Change Card. We will then update our records.

If you have questions

If you have questions about this notice, or need assistance with locating a Honda dealer, please call Honda Automobile Customer Service at 1-800-999-1009, and select option 4. You can also locate a dealer online at Hondacars.com.

We apologize for any inconvenience this campaign may cause you.

Sincerely,

American Honda Motor Co., Inc.
Honda Automobile Division