

SB-10043466-3138



Countries:	CANADA, UNITED STATES	Document ID:	IK1200706
Availability:	ISIS, Fleet/ISIS	Revision:	2
Major System:	ENGINES	Created:	1/11/2012
Current Language:	English	Last Modified:	7/23/2013
Other Languages:	NONE	Author:	Charles South
Viewed:	689		

[Less Info](#)

Hide Details

Coding Information

Copy Link	Copy Relative Link	Bookmark	Add to Favorites	Print	Provide Feedback	Helpful	Not Helpful
		 View My Bookmarks				 106	 65

Title: MaxxFORce 11 and 13 – Special Fuel Rail Kit

Applies To: Specific Serial numbers within the range 125HM2Y4100013 and 125HM2Y4101731, see attached for further clarification **Vehicle – Models, MY2010 – includes – excludes - engines and features. Built From 7/21/2010 To 8/15/2010**

DESCRIPTION

Engines with serial number listed below were build with Fuel to Rail tubes that are excessively hard. During initial installation, these tubes may distort the fuel rail making a replacement fuel to rail tube not seat properly. When replacing any fuel to rail tubes (items 2 - 7) on one of the affected vehicles (listed below), the following kit should be used, 3014634C91. Subsequent repairs to tubes or rails should be done as directed in the service manual.

PARTS INFORMATION



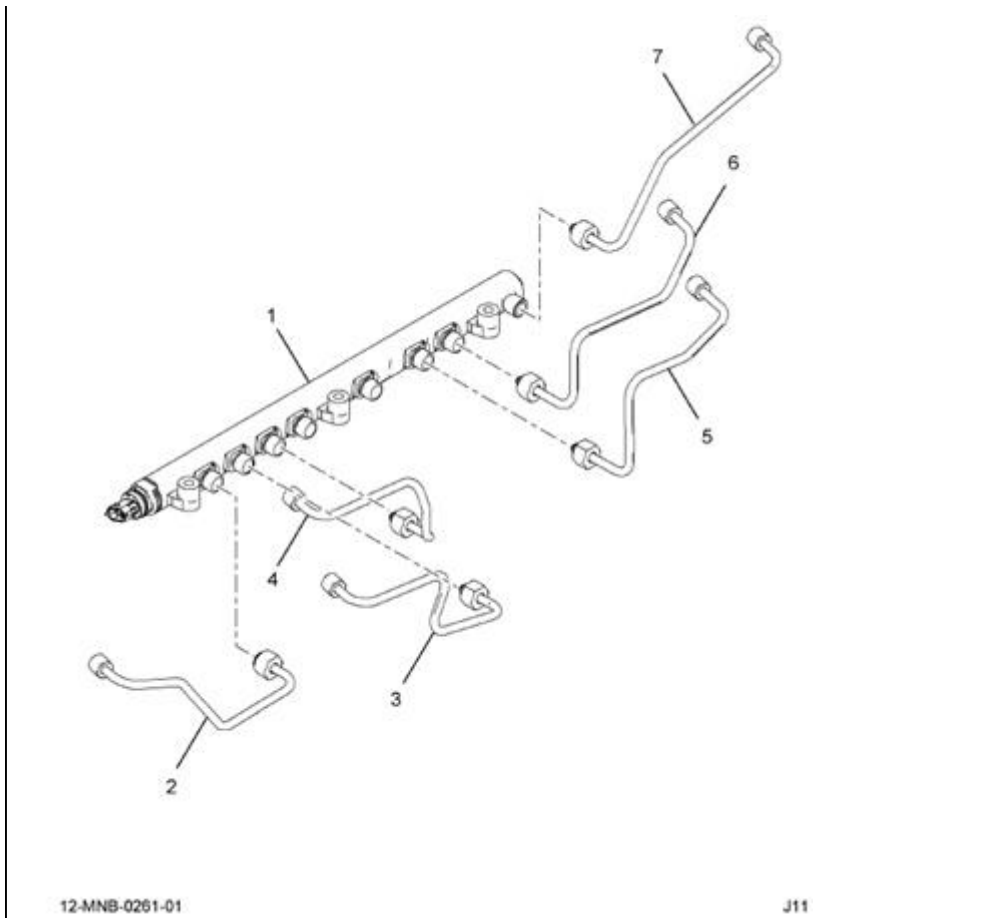

3014634C91 FUEL RAIL AND TUBE KIT, SPECIAL

Item	Part #	Description	Qty.
Kit	3014634C91	FUEL RAIL AND TUBE KIT, SPECIAL	1
Kit Contents			
1	3006765C91	RAIL ASM, FUEL	1
2	3012753C2	TUBE HI PRESS RAIL TO INJCTR 1	1
3	3006042C2	TUBE HI PRESS RAIL TO INJCTR 2	1
4	3005678C2	TUBE HI PRESS RAIL TO INJCTR 3	1
5	3005679C2	TUBE HI PRESS RAIL TO INJCTR 4	1
6	3012757C2	TUBE HI PRESS RAIL TO INJCTR 5	1
7	3012758C2	TUBE HI PRESS RAIL TO INJCTR 6	1

RESOURCES

[List of affected engines by Engine Serial Number \(PDF\)](#)



Hide Details

Feedback Information

Viewed: 688

Helpful: 106

Not Helpful: 65

No Feedback Found

Copyright © 2013 Navistar, Inc.