

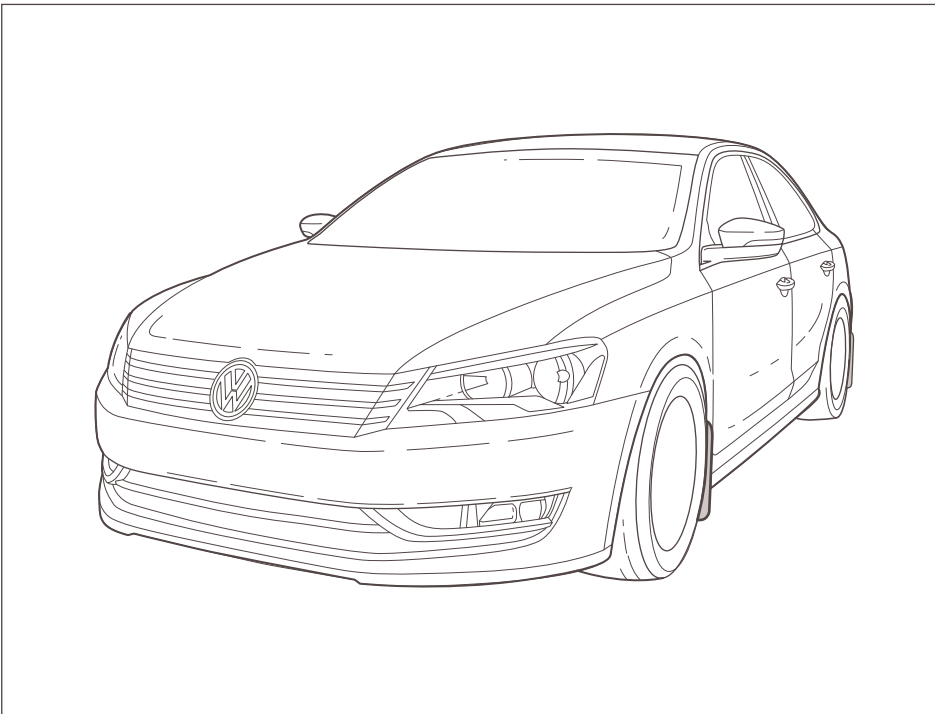

**FITTING INSTRUCTIONS
INSTRUCTIONS DE MONTAGE
INSTRUCCIONES DE MONTAJE**

ILLUMINATED DOOR SILLS

**PASSAT NAR 12 >>
561 071 300**



The right to modify specifications is reserved.

Le fabricant se réserve le droit de modifier les spécifications.

Reservado el derecho de modificar las especificaciones.

Distributed by Volkswagen of America, Inc.
3800 Hamlin Road, Auburn Hills, MI 48326

BILL OF MATERIALS / PIÈCES INCLUSES / PARTES INCLUIDAS

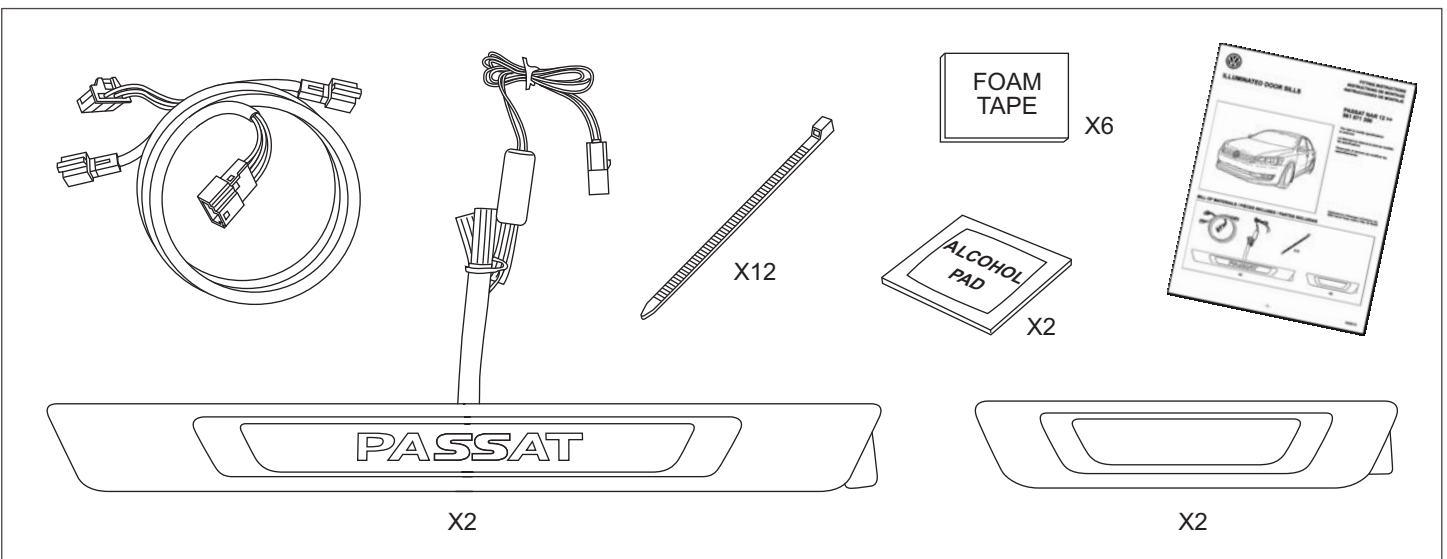

TOOLS REQUIRED / OUTILS NÉCESSAIRES / HERRAMIENTAS NECESARIAS

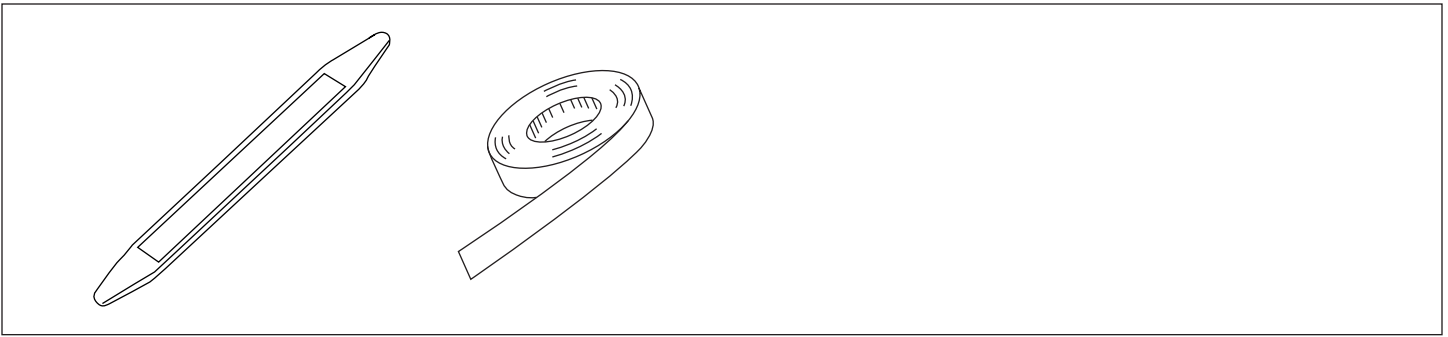

EN

Please read fitting instructions thoroughly before commencing installation.

We recommend that fitting is carried out by a specialist workshop.

Note: Further information regarding removal / fitting of respective parts can be found in repair guide "General body repairs, exterior".

Contact your nearest Volkswagen dealer for assistance or questions about this accessory.

FR

Lire attentivement les instructions de montage avant de commencer l'installation.

Nous recommandons de confier le montage à un atelier spécialisé.

Remarque: Vous trouverez dans le guide de réparation « Travaux de montage – Carrosserie extérieure » des informations supplémentaires sur le démontage et le montage des pièces correspondantes.

Communiquez avec votre concessionnaire Volkswagen le plus proche pour demander de l'aide ou poser des questions à propos de cet accessoire.

ES

Por favor, lea detenidamente las instrucciones de montaje antes de comenzar la instalación.

Le recomendamos que el montaje se lleve a cabo en un taller especializado.

Nota: Más información sobre la remoción/instalación de piezas correspondientes se puede encontrar en el manual de reparación "Reparaciones generales en la carrocería, exteriores".

Póngase en contacto con su distribuidor más cercano de Volkswagen para obtener asistencia o si tiene preguntas acerca de este accesorio.

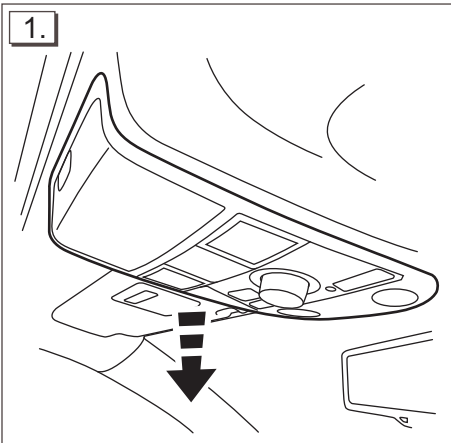

Remove Dome Light and discard harness.

SEE REPAIR MANUAL

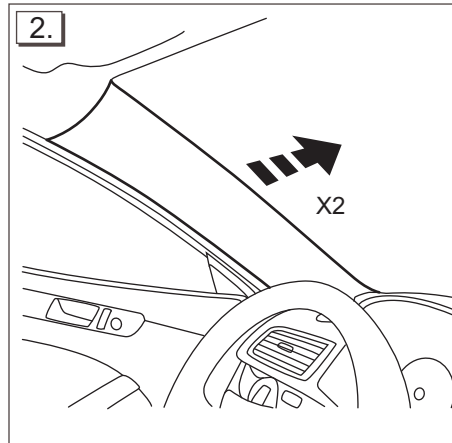

Remove A-Pillar Trim on Driver and Passenger side.

SEE REPAIR MANUAL

⚠ WARNING

IMPROPER DISASSEMBLY OF THE A-PILLAR TRIM CAN PREVENT SIDE AIRBAGS FROM WORKING PROPERLY AND RESULT IN SEVERE INJURIES.

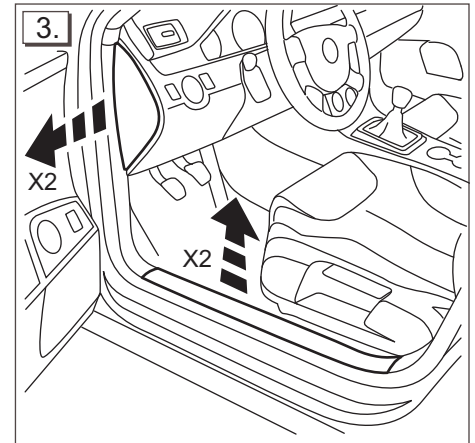

Remove Dash End Panel and Door Seal Trim Panel on Driver and Passenger side.

SEE REPAIR MANUAL

DO NOT REMOVE FOOTWELL TRIM PANEL

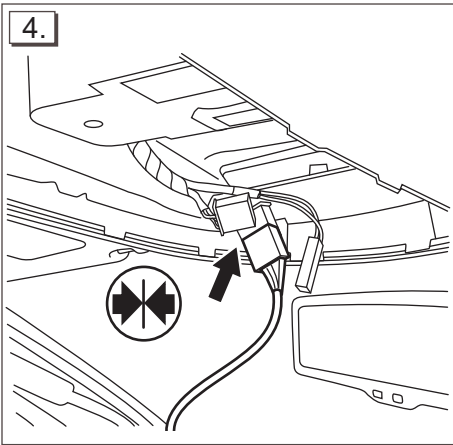

4. Connect harness provided to Dome Lamp Harness.

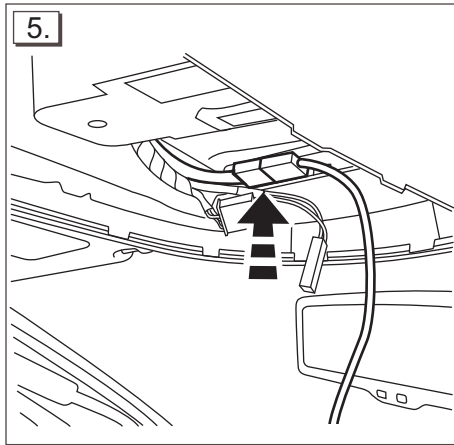

5. Attach a piece of foam tape to the back of the connector. Peel away the remaining adhesive backing and secure the connectors to the inside of the dome lamp area.

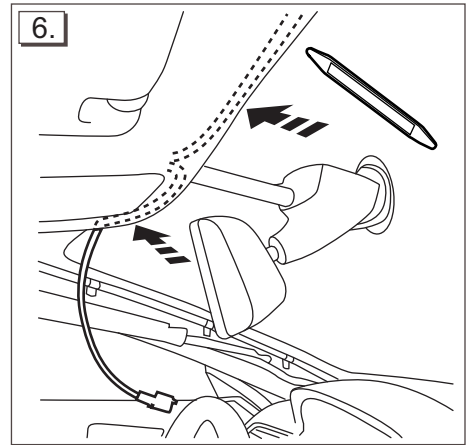

6. Use a Bone Tool to feed the harness up under the leading edge of the headliner and out towards the A-Pillars on both sides of the vehicle.

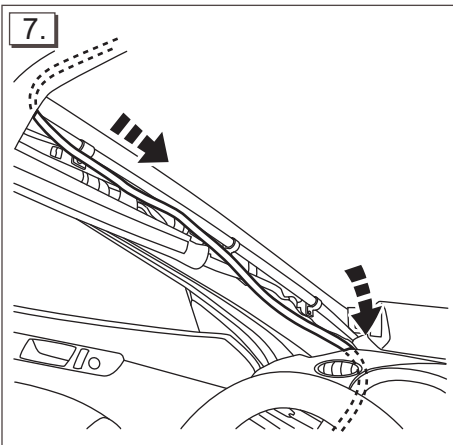

7. Route the Driver Side Harness down the A-Pillar to the Fuse Box area.

WARNING: DO NOT ROUTE IN FRONT OF AIRBAG.

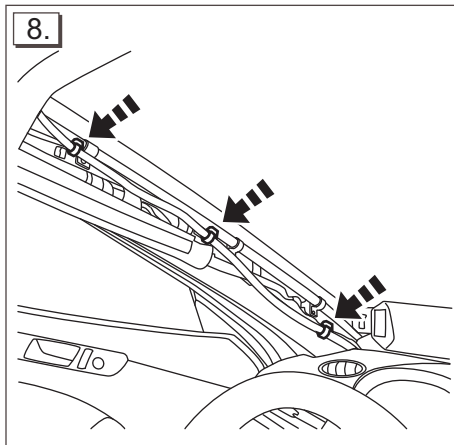

8. Secure the Driver Side Harness to the A-Pillar vehicle harness with three (3) cable ties.

WARNING: DO NOT ROUTE IN FRONT OF AIRBAG.

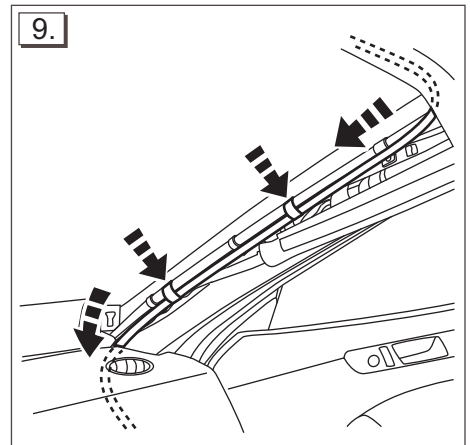

9. Route the Passenger Side Harness down the A-Pillar. Use foam tape to secure the harness to the drain tube.

WARNING: DO NOT PINCH DRAIN TUBE

WARNING: DO NOT ROUTE IN FRONT OF AIRBAG.

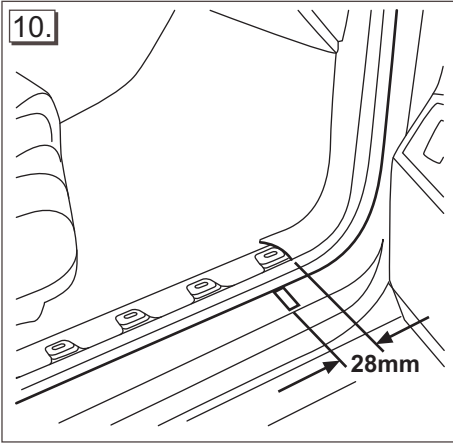

10. From front edge of the inner door sill trim, measure 28mm backwards and mark with tape.

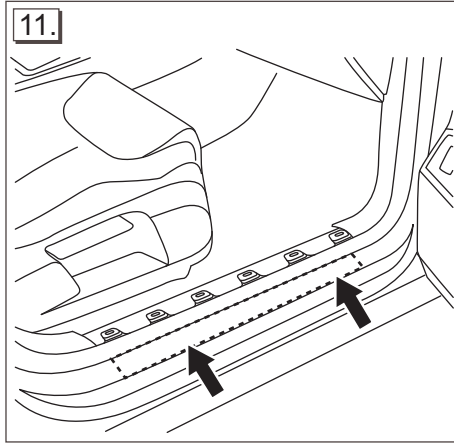

11. Clean Passenger side door sill mounting area with alcohol wipe.

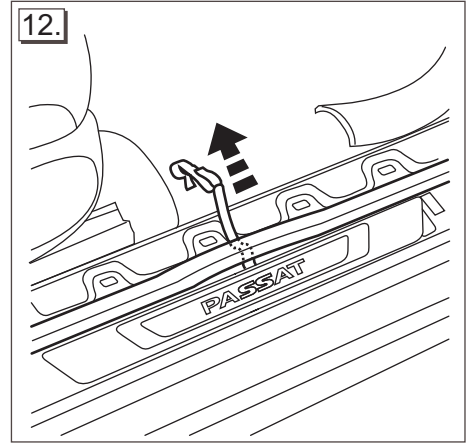

12. Pull up the door sill weather strip and feed the flat wire from the Illuminated Sill Plate underneath.

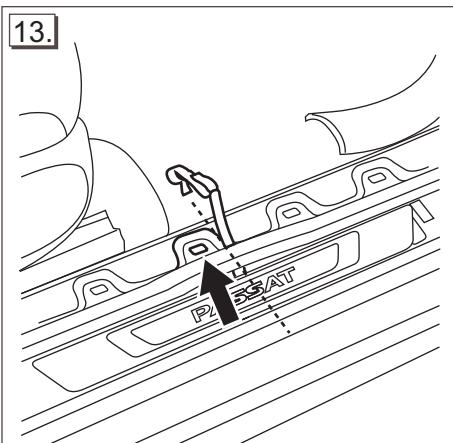

13. Be sure the ribbon wire is positioned along the right edge of the second clip mounting point from the rear.

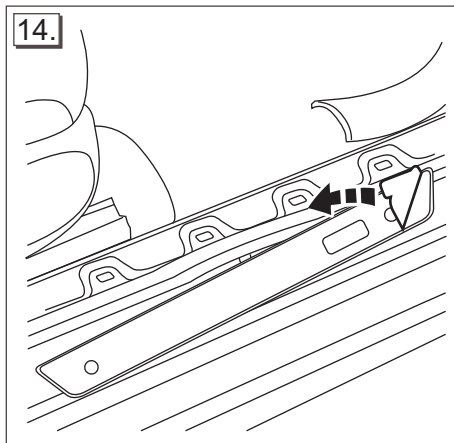

14. Turn Sill Plate over and remove adhesive backing strip.

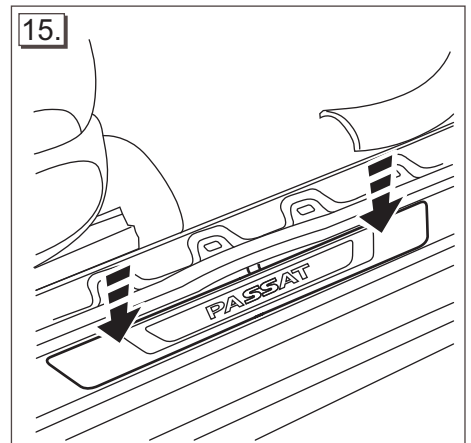

15. Apply even pressure along the Illuminated Sill Plate to secure it to the vehicle. Remove tape.

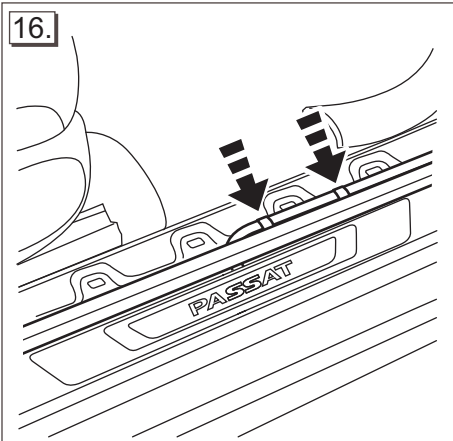

Route the Door Sill Plate harness up towards the dash and secure it along the vehicle harness with foam tape. Press weatherstrip back down into position.

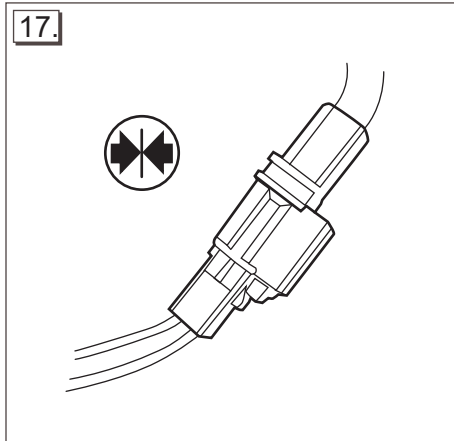

Connect the plug from the Illuminated Door Sill plate to the plug from the overhead light panel.

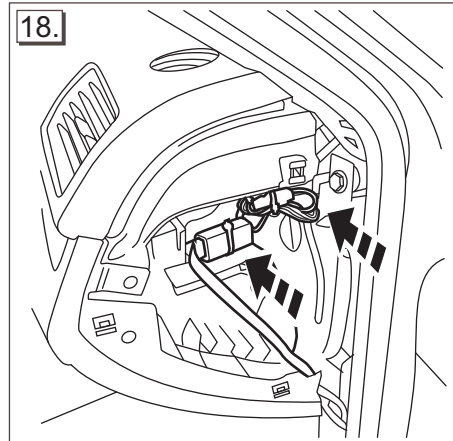

Bundle any extra wire and secure with a cable tie. Secure the bundle and the Circuit Board to the end of the dash with cable ties.

REPEAT STEPS 10 THROUGH 16 FOR DRIVER SIDE OF VEHICLE.

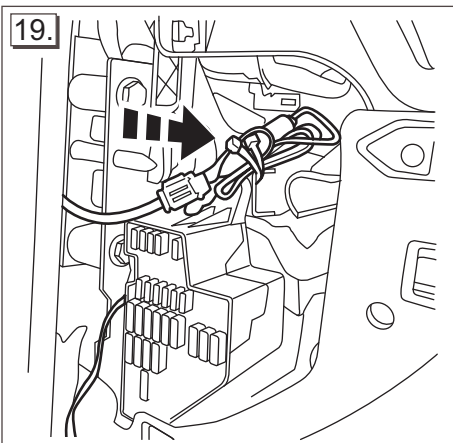

Bundle any extra wire on the Driver Side and secure with a cable tie. Secure the bundle and the Circuit Board to the end of the dash above the fuse box with cable ties.

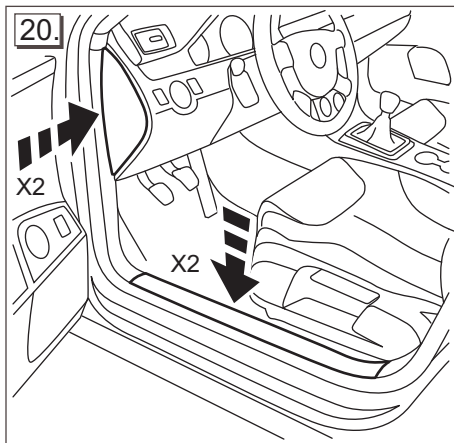

Reinstall Dash End Panel and Door Seal Trim Panel on Driver and Passenger side.

SEE REPAIR MANUAL

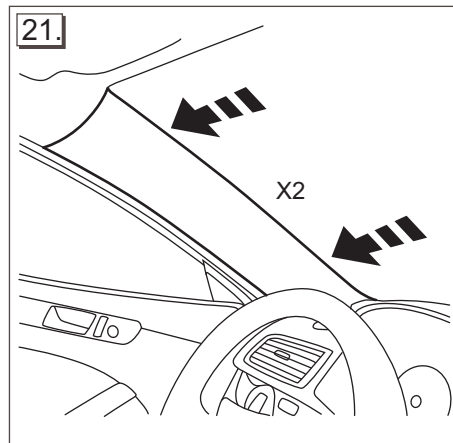

Reinstall A-Pillar Trim on Driver and Passenger side.

SEE REPAIR MANUAL

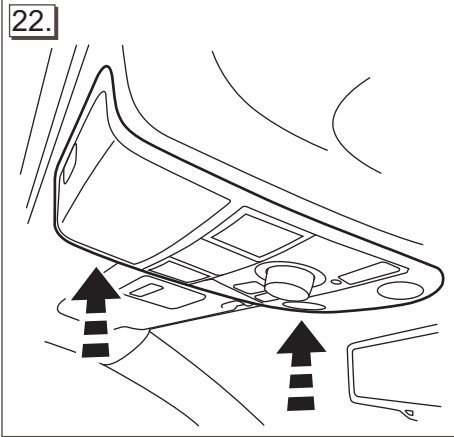

Reinstall Dome Light assembly.

SEE REPAIR MANUAL

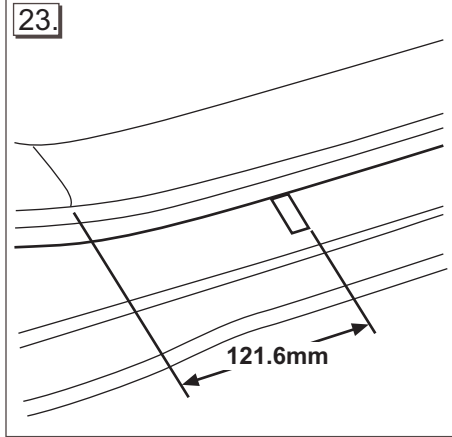

From rear edge of the inner door sill trim, measure 121.6mm forward and mark with tape.

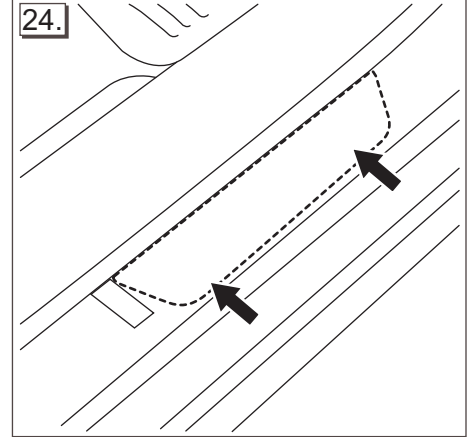

Clean rear Passenger side door sill mounting area with alcohol wipe.

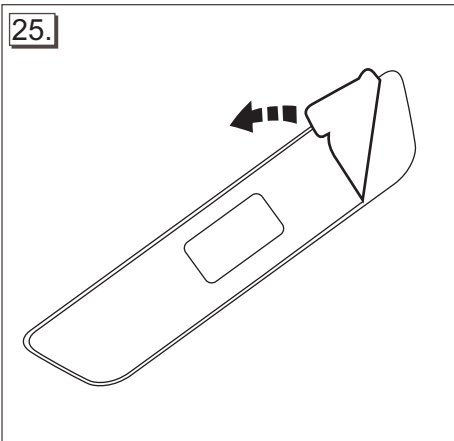

Turn Rear Sill Plate over and remove adhesive backing strip.

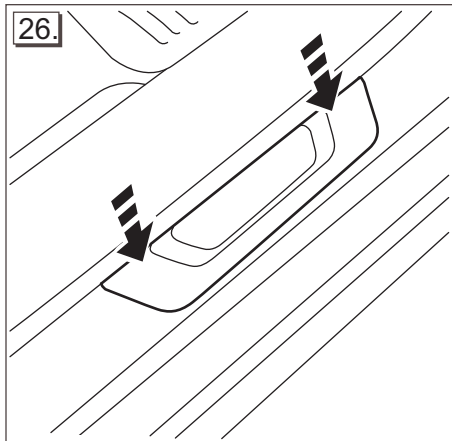

Locate Rear Sill Plate on door edge. Apply even pressure along the Rear Sill Plate to secure it to the vehicle. Remove tape.

REPEAT STEPS 22 THROUGH 24 FOR DRIVER SIDE OF VEHICLE.

NOTICE

TO PREVENT DAMAGE TO THE DOOR SILLS, DO NOT CONTACT THE PART SURFACE WITH ABRASIVE CHEMICALS SUCH AS ACETONE, METHONAL, BRAKE CLEANER, RIM CLEANER, BATTERY ACID, CAVITY SEALING MEDIUM, PRESERVATIVE REMOVER ETC.