

ATTENTION:

- GENERAL MANAGER
- PARTS MANAGER
- CLAIMS PERSONNEL
- SERVICE MANAGER

IMPORTANT - All Service Personnel Should Read and Initial in the boxes provided, right.

| | | |
|--|--|--|
| | | |
| | | |



QUALITY DRIVEN® SERVICE

SERVICE BULLETIN

APPLICABILITY: 2010MY and Later Outback Models
SUBJECT: Tire Rubbing Sound from Right Front

NUMBER: 15-159-13R
DATE: 01/10/13
REVISED: 06/03/13

INTRODUCTION

This Bulletin provides a modification procedure to address a customer concern of a tire rubbing-type sound heard from the right front of the vehicle. The sound will only occur when backing up with the wheels turned to the right a certain amount. It is caused by the right front tire coming in contact with the inside corner of the accessory splash guard. A similar production update to the accessory splash guard will take place as part of a running change in 2013.

PART INFORMATION

Right Front Splash Guard p.n. **J101SAJ520** is the new part number which includes the above referenced production update.

SERVICE PROCEDURE / INFORMATION

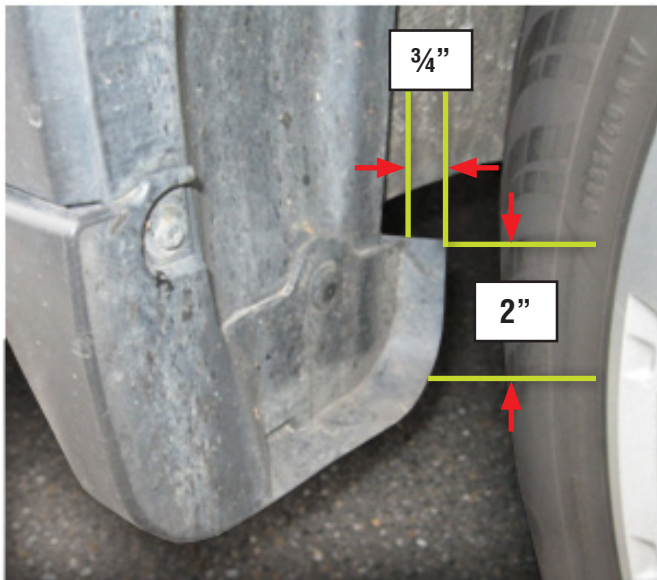

Before Modification

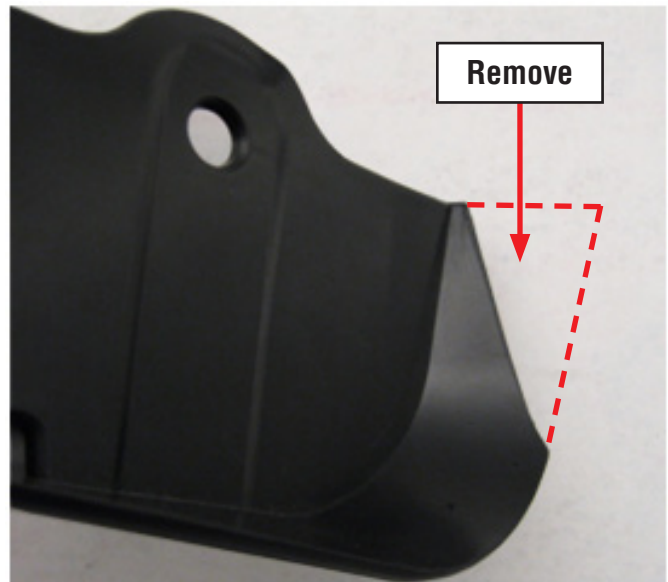

After Modification

Continued...

CAUTION: VEHICLE SERVICING PERFORMED BY UNTRAINED PERSONS COULD RESULT IN SERIOUS INJURY TO THOSE PERSONS OR TO OTHERS.

Subaru Service Bulletins are intended for use by professional technicians ONLY. They are written to inform those technicians of conditions that may occur in some vehicles, or to provide information that could assist in the proper servicing of the vehicle. Properly trained technicians have the equipment, tools, safety instructions, and know-how to do the job correctly and safely. If a condition is described, DO NOT assume that this Service Bulletin applies to your vehicle, or that your vehicle will have that condition.

SUBARU OF AMERICA, INC. IS "ISO 14001 COMPLIANT"

The international standard for excellence in Environmental Management Systems. Please recycle or dispose of automotive products in a manner that is friendly to our environment and in accordance with all local, state and federal laws and regulations.

- Remove the splash guard from the vehicle.
- Measure 3/4 of an inch back from the top inside corner and 2 inches down from the same corner and mark the edges of the splash guard as shown in the “**Before**” photo above.
- Using a straight-edge, draw a line to connect the 2 marks.
- Using a utility knife or equivalent, **carefully** trim off the corner as shown above, right.
- Smooth any sharp edges with sandpaper.
- Reinstall the splash guard to complete the repair.

WARRANTY / CLAIM INFORMATION

For vehicles within the Basic New Car Limited Warranty period, this repair may be claimed using the following information:

| LABOR DESCRIPTION | LABOR OPERATION # | FAIL CODE | LABOR TIME |
|---|-------------------|-----------|------------|
| R/F Splash Guard Modification for Rubbing Sound | A064-608 | ZDF-48 | 0.3 |

Continued...