

TECHNICAL BULLETIN
LTB00538NAS1
31 MAY 2013



© Jaguar Land Rover North America, LLC

NOTE: The information in Technical Bulletins is intended for use by trained, professional Technicians with the knowledge, tools, and equipment required to do the job properly and safely. It informs these Technicians of conditions that may occur on some vehicles, or provides information that could assist in proper vehicle service. The procedures should not be performed by 'do-it-yourselfers'. If you are not a Retailer, do not assume that a condition described affects your vehicle. Contact an authorized Land Rover service facility to determine whether this bulletin applies to a specific vehicle.

SECTION: 501-14

Soft Door Close Lock Functionality

AFFECTED VEHICLE RANGE:

Range Rover (LG)

Model Year:

2013

VIN:

DA100000-DA111289

MARKETS:

NAS

CONDITION SUMMARY:

Situation: The soft door close function may operate intermittently or will not fully close.

Cause: This may be caused by the soft door close mechanism spring becoming dislocated.

Action: In the event of a customer concern of the above, refer to the Service Instruction outlined below.

WARRANTY:



NOTE: Repair procedures are under constant review, and therefore times are subject to change; those quoted here must be taken as guidance only. Always refer to TOPIx to obtain the latest repair time.



NOTE: DDW requires the use of causal part numbers. Labor only claims must show the causal part number with a quantity of zero.

DESCRIPTION	SRO	TIME (HOURS)	CONDITION CODE	CAUSAL PART
Re-locate door latch spring - front - one side	76.37.89/53	1.00	42	LR048252
Re-locate door latch spring - front - both sides	76.37.89/54	2.00	42	LR048252
Re-locate door latch spring - rear - one side	76.37.89/55	0.80	42	LR048252
Re-locate door latch spring - rear - both sides	76.37.89/56	1.50	42	LR048252
Adjust 1 or 2 door(s) on striker(s)	05.10.10	0.10	42	LR048252
Adjust 3 or 4 doors on striker(s)	05.10.20	0.20	42	LR048252



NOTE: Normal Warranty policies and procedures apply.

SERVICE INSTRUCTION:

- WARNING:** The door latch mechanism may move automatically; DO NOT insert fingers in to the door latch mechanism.



NOTE: Front right door latch shown; others similar.

Check the operation of the door latch:

- Open the door.
 - Using a suitable tool, carefully move the door latch from position 1 to position 2.
 - The latch should automatically move from position 2 to position 3 due to the soft door close function.
- If the latch operates correctly in all three positions, carry on to step 2.
 - If the soft door close function moves the door latch to position 3, wait for two (2) seconds. Operate the internal or external door handle and observe the door latch movement. If the door latch is slow to return to position 1 or if it stops at position 2 and then returns to position 3, carry out steps 4-6.
 - If the door latch does not automatically move to position 3 **AND** cannot be manually moved to position 3, carry out steps 4-6.

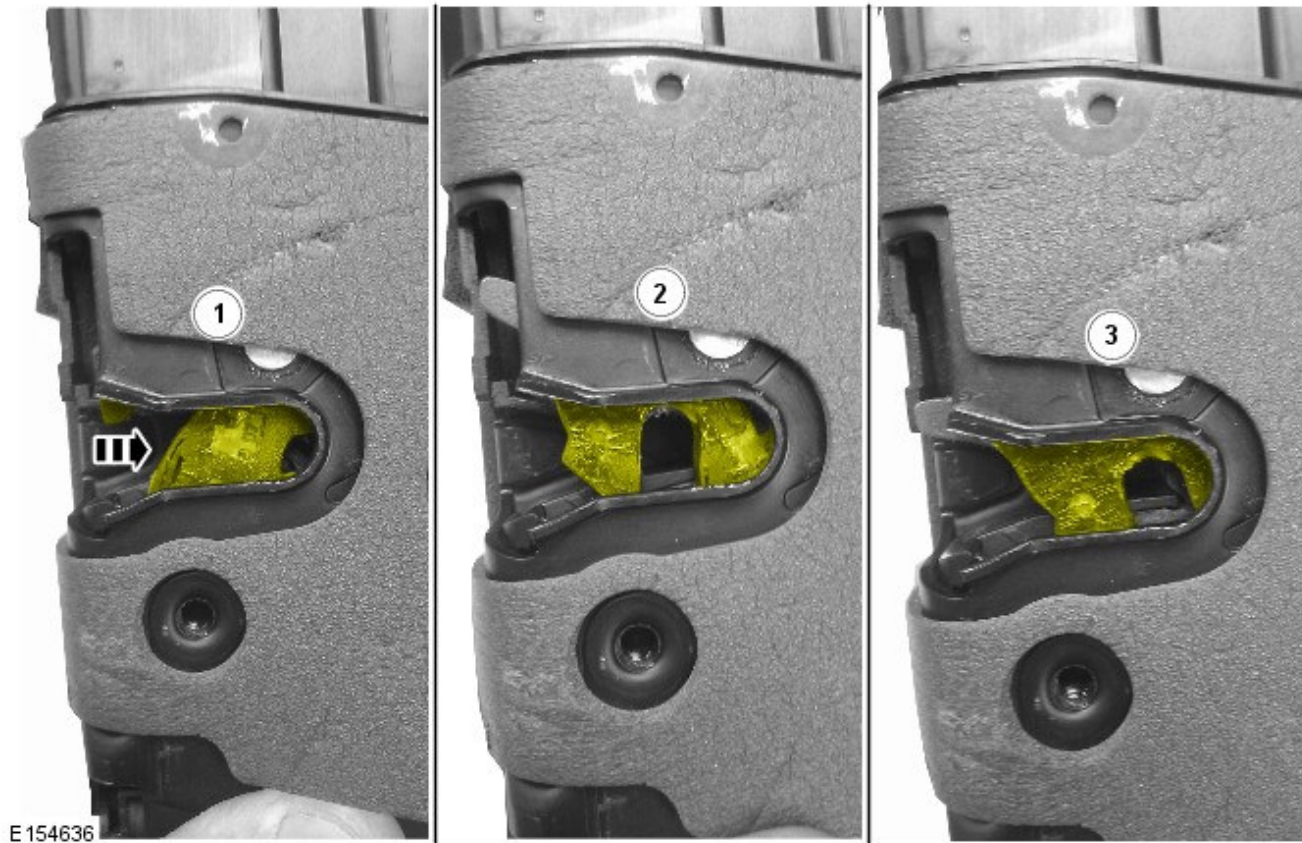

2.  **NOTE: Front left shown; others similar.**

 **NOTE: Make sure that the door is pulled at the 'ticked' position shown. Do not pull on the door handle as this will cause the door to unlatch / open.**

If the soft door close function is still intermittent, close the door and instigate the error state.

- Once the door is in the error state with the soft door close not pulling the door in, gently pull the door away from the vehicle body side by carefully pulling on the key cover.
- If the soft door close function then initiates and pulls

the door onto the primary latch position, adjust the striker for the door inboard by 1mm (see step 3).

- Retest soft door close function, and make sure that panel flushness has not been affected by the adjustment.

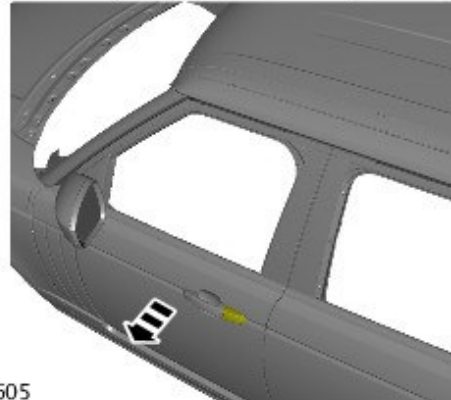
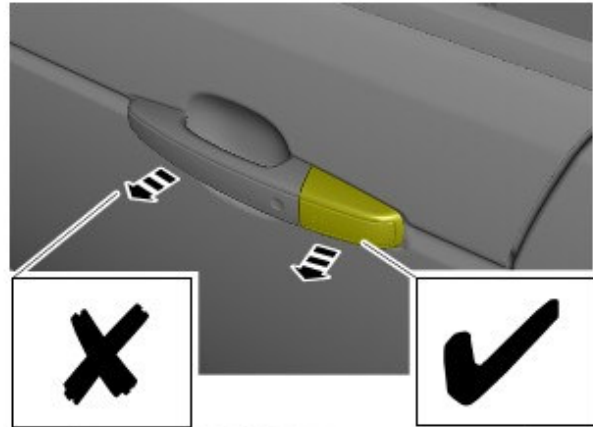

E155605

3. Adjust the affected door striker:

- To aid in identifying striker movement, apply suitable non-marking tape to the B- / C-pillar at the outer edge of the striker.
- Slacken the two (2) Torx bolts.
- Using a soft-faced mallet, re-position the striker inwards by 1mm.
- Tighten the two (2) Torx bolts to 25Nm.
- Remove the tape.



E154459



NOTE: Only carry out the steps below if a fault has been diagnosed in step 1.

4. Remove the affected door latch (see TOPIx Workshop Manual section 501-14: Handles, Locks, Latches and Entry Systems).



5. **CAUTION: Make sure that the spring is fully**

located in to the plastic recess.

Using a suitable tool, relocate the spring in to the recess as shown.

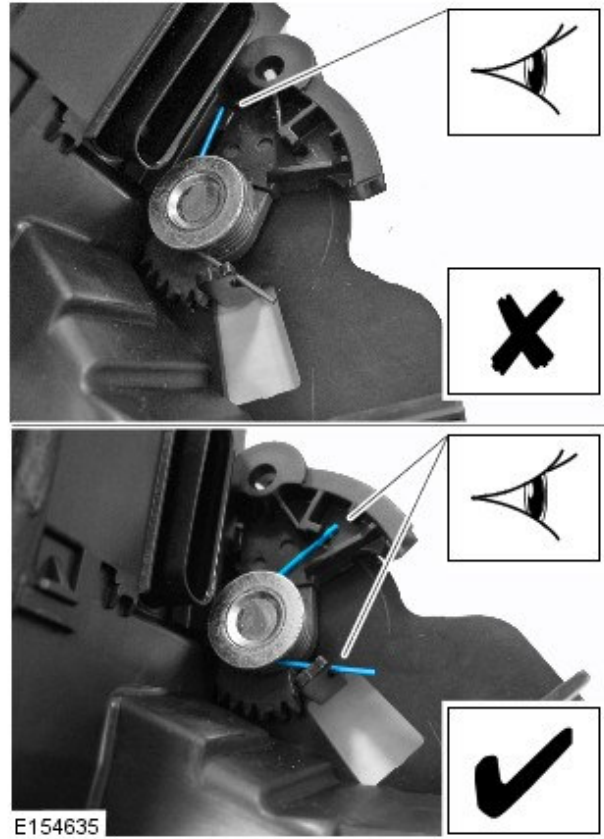

6. Install the door latch (see TOPIx Workshop Manual section 501-14: Handles, Locks, Latches and Entry Systems).