

Door Lock Cover Fitment SSM (1).pdf

Reference	SSM63857
Models	Range Rover (All New) / L405
Title	All New Range Rover Drivers Door Lock Covers not fitted correctly
Category	Body
Last modified	07-Mar-2013 00:00:00
Symptom	112000 Latches/Locks & Security
Content	<p><b>Concern</b>                      A number of Dealers have reported that the Drivers Door Lock cover on the 'All New Range Rover' has either come adrift after fitment or has shown signs of cracking again after fitment by the Dealer</p> <p><b>Action</b>                      It is important that the Dealer fit Driver's Door lock Cover is fitted correctly in order to prevent it coming adrift or cracking at a later date. Please refer to the attached file which details the fitting instructions.</p>

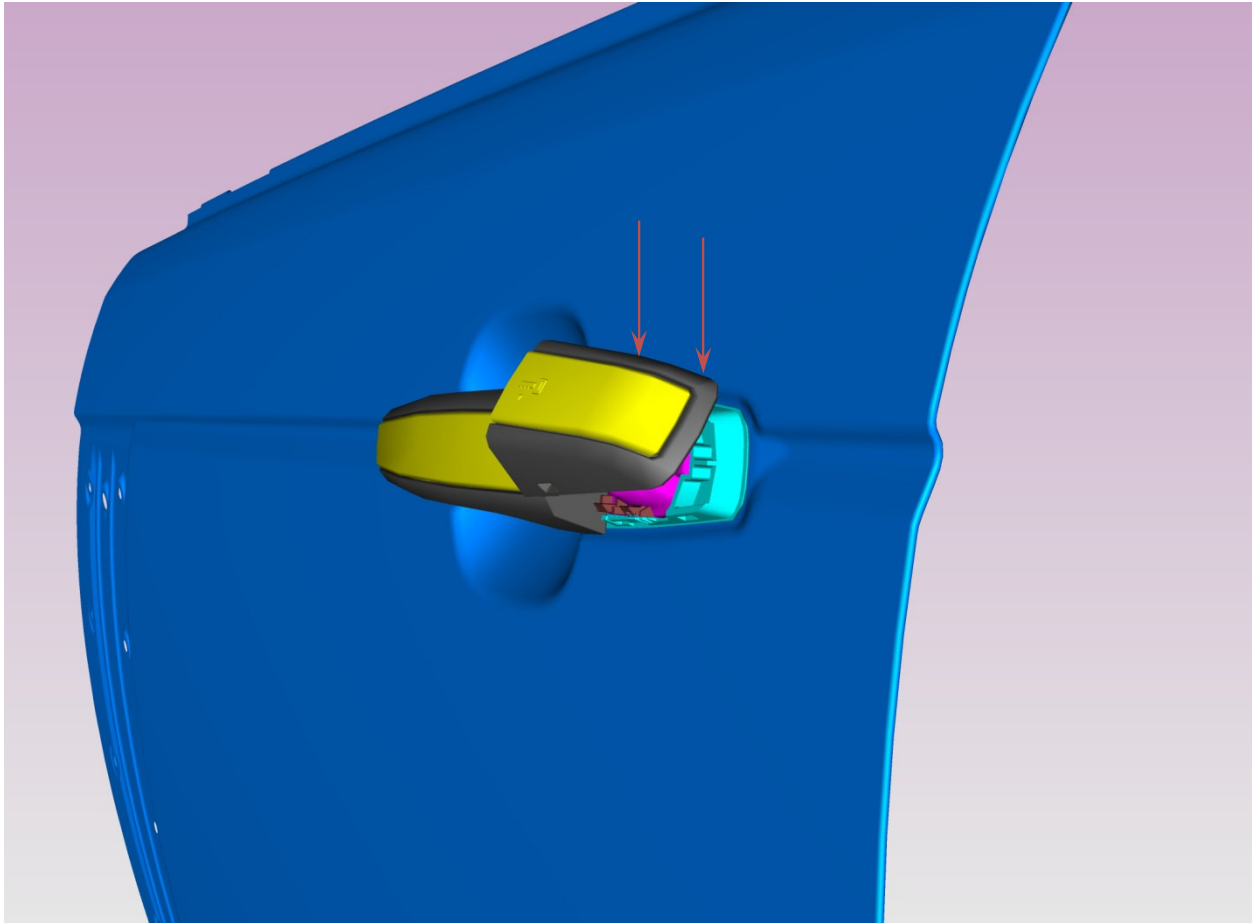

Approach the vehicle with the Door Lock Cover tilted upwards. There is a pair of clipping features that need to be carefully located into the gasket behind.

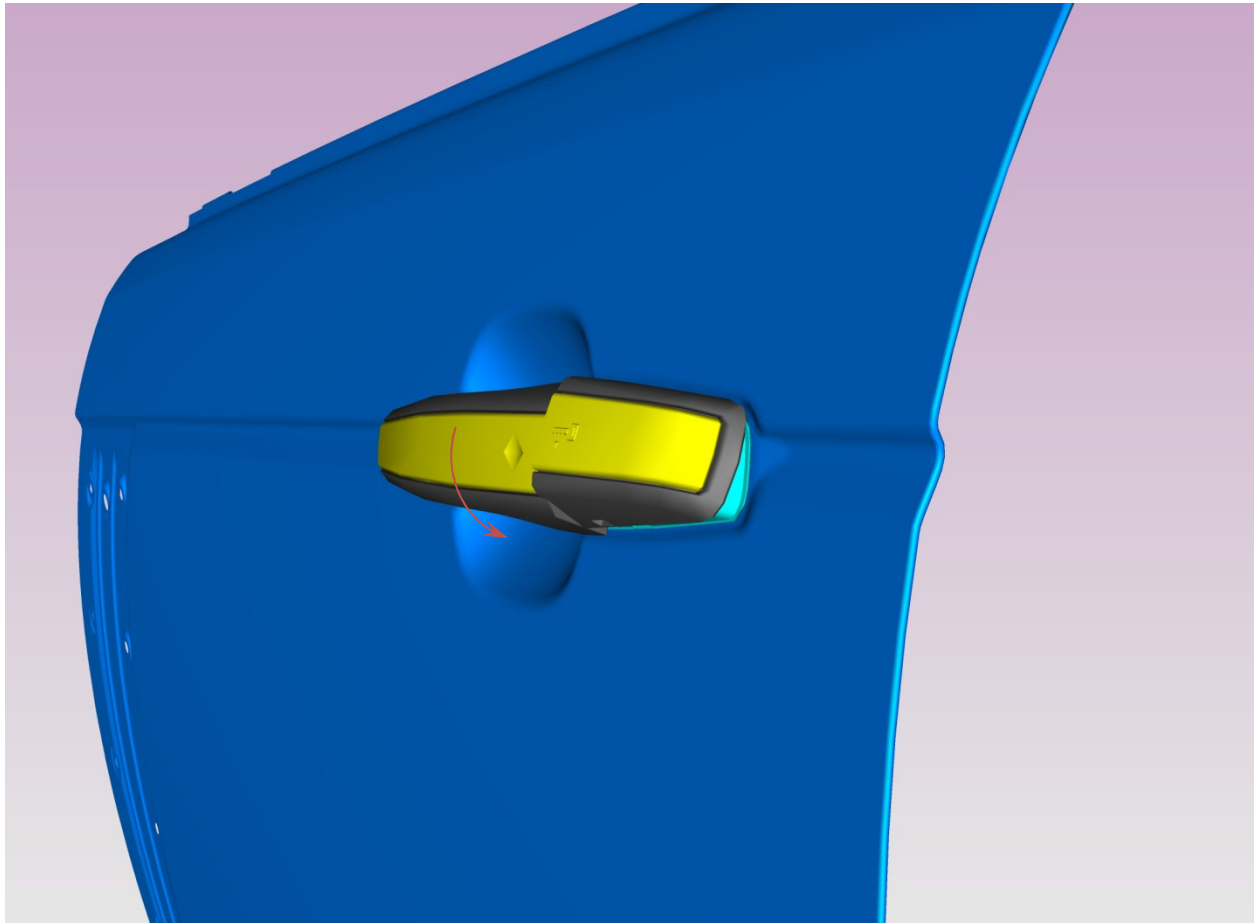

Located both of the clipping features into the gasket in a downwards motion. Once the upper retention lugs are located, rotated the Door Lock Cover downwards to engage the clip on the underside

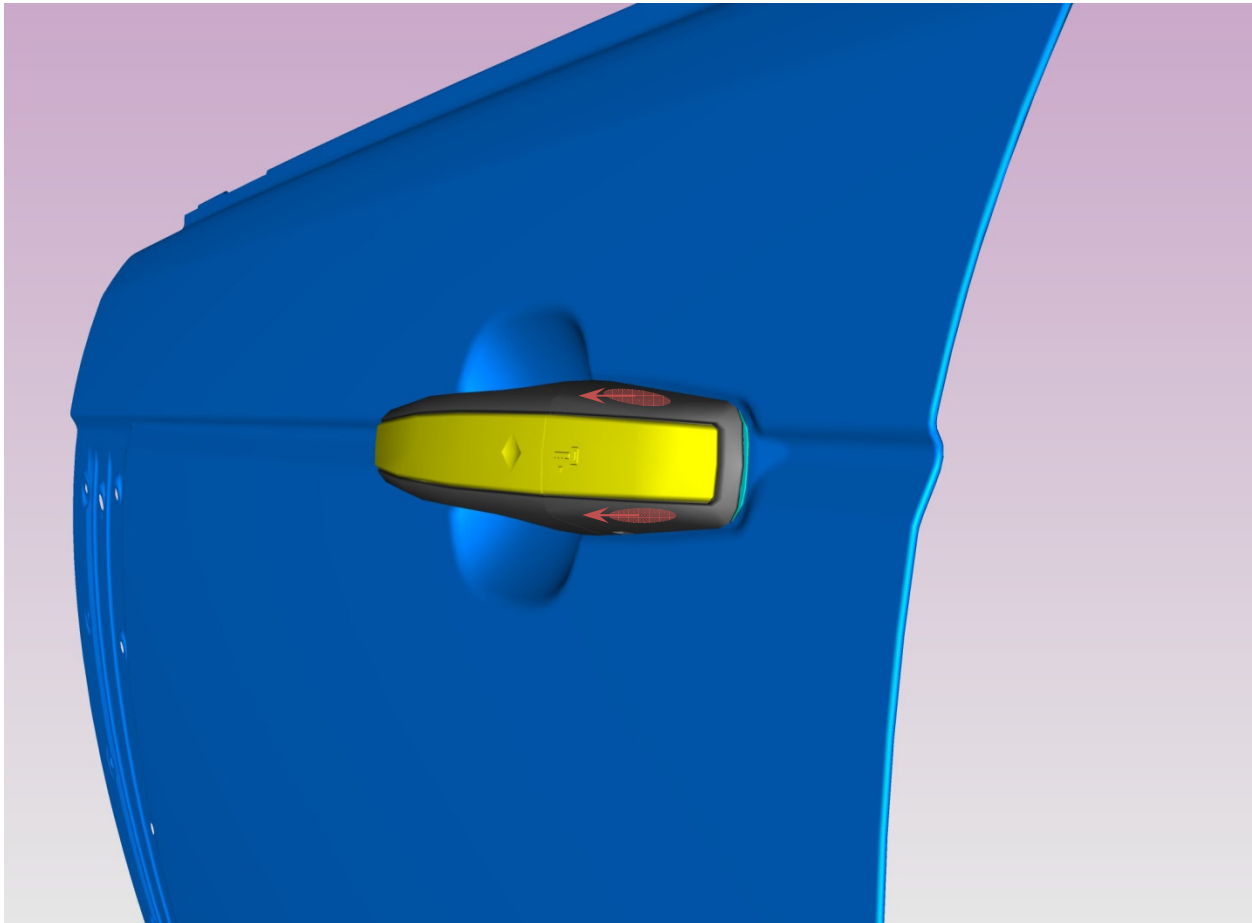

Rotate the Door Lock Cover downwards until a positive click is felt / heard, as the lower retention lug snaps into place in the gasket. Check the Door Lock Cover is secure by gently pulling it, it should remain securely in position on the vehicle.