

Contents

- Item 1. Brake Line Unions to ABS Modulator - Tiger 800 and Tiger 800XC
- Item 2. Neutral Light Switch Parts Kits - Speed Triple 1050, Speed Triple 1050 R, Sprint GT, Tiger 1050 ABS and Tiger Sport from VIN 596697
- Item 3. Dry Fill Oil Quantity - Thunderbird, Thunderbird with ABS, Thunderbird SE with ABS, Thunderbird Storm and Thunderbird Storm with ABS
- Item 4. Camshaft Cover Fixings - Street Triple and Street Triple R from VIN 560477
- Item 5. Breather Cover - Tiger Explorer, Tiger Explorer XC, Trophy and Trophy SE
- Item 6. Heated Grips Fuse Rating Change - Tiger Sport
- Item 7. Constant Tension Coolant Hose Clamps - All Water Cooled Models Currently in Production
- Item 8. Unpacking the Motorcycle - Sprint GT 1050, Trophy and Trophy SE
- Item 9. Unpacking the Motorcycle - All Models
- Item 10. Service Manual Issue Level and Part Numbers - All Models Currently in Production

Item 1.

Description: Brake Line Unions to ABS Modulator

Models affected: Tiger 800 and Tiger 800XC

The torque figure for the brake line unions to the ABS modulator has changed to **15 Nm** on the above models.

Note:

- **Models already in service need not be re-tightened unless the fixings have been loosened or removed.**

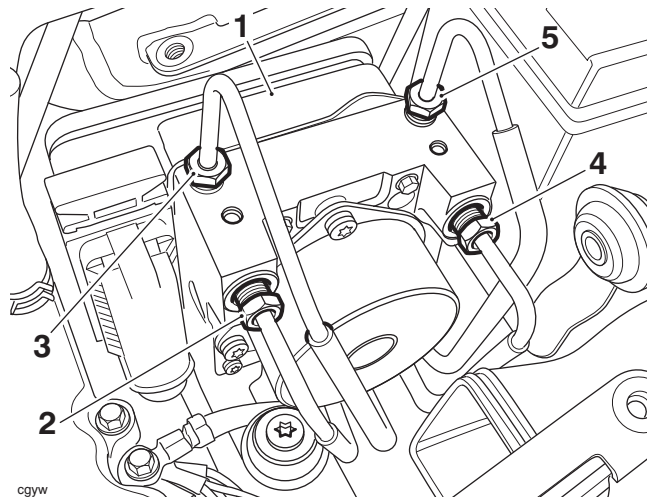

- 1. ABS modulator
- 2. Front brake master cylinder hard line
- 3. Front brake caliper hard line
- 4. Rear brake master cylinder hard line
- 5. Rear brake caliper hard line

Please mark your copy of the Service Manual with this information.

Item 2.

Description: Neutral Light Switch Parts Kits

Models affected: Speed Triple 1050, Speed Triple 1050 R, Sprint GT, Tiger 1050 ABS and Tiger Sport from VIN 596697

If for any reason the neutral light switch requires replacing on the above models from VIN 596697, a parts kit containing a neutral light switch and a 1.5 mm washer is available. For models up to VIN 596696 refer to Technical News 148, dated August 2013. When ordering replacement parts, always refer to the EPC.

Note:

- Parts kit T1190904 is for use when the neutral light switch is replaced on motorcycles from VIN 596697.

Parts Kit Contents

Kit Part Number	Kit Contents	Part Numbers
T1190904	Neutral light switch Washer 1.5 mm (silver)	T1190905 T3555044

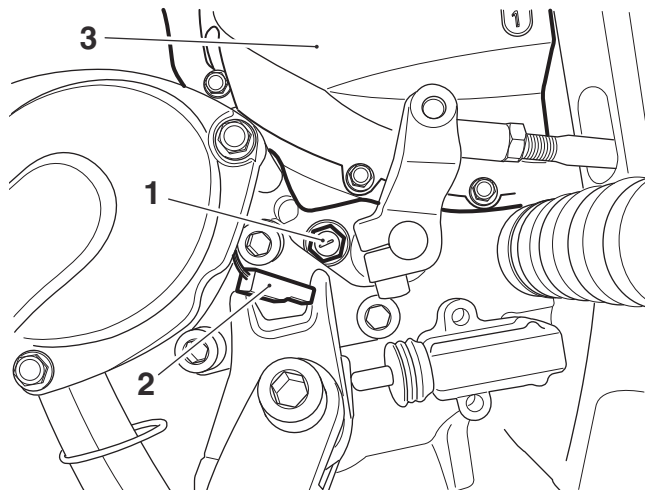

1. Neutral light switch - Speed Triple shown
2. Neutral light switch connection
3. Sprocket cover

Please mark your copy of the Service Manual with this information.

Item 3.

Description: Dry Fill Oil Quantity

Models affected: Thunderbird, Thunderbird with ABS, Thunderbird SE with ABS, Thunderbird Storm and Thunderbird Storm with ABS

The oil capacity (including filter, dry fill), as described in the lubrication specification table in the Service Manual, has changed to 4.8 litres for the above models.

Always use the engine oil dipstick (or sight glass on some models) when checking/adjusting the engine oil level.

Please mark your copy of the Service Manual with this information.

Item 4.

Description: Camshaft Cover Fixings

Models affected: Street Triple and Street Triple R from VIN 560477

The torque figure for the camshaft cover fixings has changed to **10 Nm** on the above models.

Note:

- **Models already in service need not be re-tightened unless the fixings have been loosened or removed.**

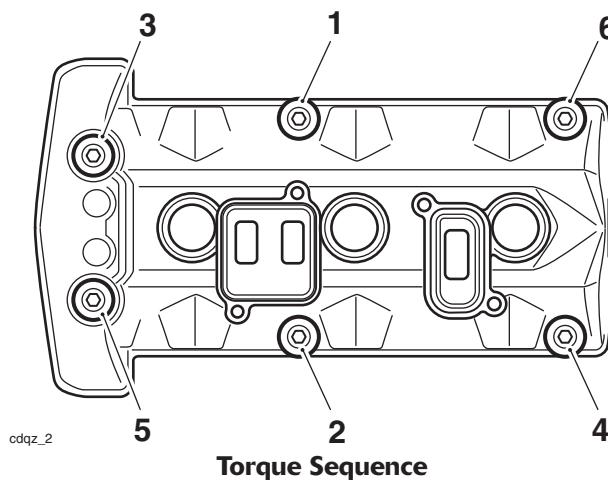

Please mark your copy of the Service Manual with this information.

Item 5.

Description: Breather Cover

Models affected: Tiger Explorer, Tiger Explorer XC, Trophy and Trophy SE

The fixings securing the breather cover to the crankcase are pre-encapsulated on the above models and therefore must be replaced if removed for any reason. The **11 Nm** torque figure remains unchanged.

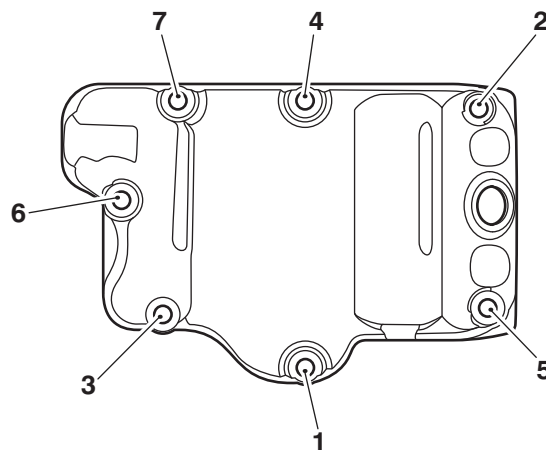

Please mark your copy of the Service Manual with this information.

Item 6.

Description: Heated Grips Fuse Rating Change

Models affected: Tiger Sport

The heated grips fuse rating has changed to 5 Amps on the above model from VIN 632831.

Warning

Always replace blown fuses with new ones of the correct rating (as specified on the fuse box cover) and never use a fuse of higher rating. Use of an incorrect fuse could lead to an electrical problem, resulting in motorcycle damage, loss of motorcycle control and an accident.

When replacing a fuse, refer to the Service Manual.

Right hand fuse box		
Circuit protected	Position	Rating (Amps)
Empty	1	-
Cooling fan	2	10
Tail light, brake light, horn	3	10
Heated grips	4	5
Accessory	5	10
Empty	6	-

Left hand fuse box		
Circuit protected	Position	Rating (Amps)
ABS braking	1	20
ABS braking	2	20
Ignition	3	10
Engine management	4	15
Alarm, Instrument lights	5	10
Headlight	6	20

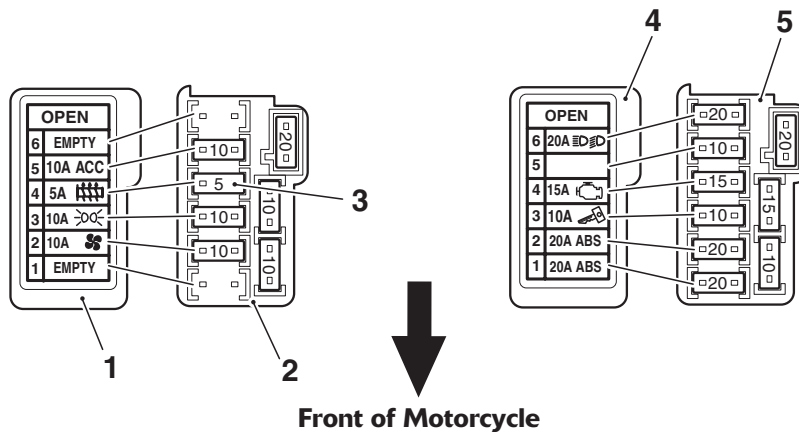

1. Right hand fuse box cover
2. Right hand fuse box
3. Heated grips 5 Amp fuse
4. Left hand fuse box cover
5. Left hand fuse box

Please mark your copy of the Service Manual with this information.

Item 7.

Description: **Constant Tension Coolant Hose Clamps**

Models affected: **All Water Cooled Models Currently in Production**

Triumph has introduced constant tension coolant hose clamps to all water cooled models currently in production from November 2013. The constant tension clamps have been introduced to each model at various VINs and will replace all existing screw type coolant hose clamps.



Caution

Screw type hose clamps fitted to models prior to this change must NOT be replaced with constant tension hose clamps. When replacing coolant hose clamps, always replace with clamps of the same size and type. Failure to replace the clamps on a like for like basis may result in a coolant leak. Loss of coolant may cause the engine to overheat and suffer severe damage.

Service Tool T3880207

Service tool T3880207 has been released for use with the constant tension hose clamps.



Warning

Always wear suitable eye protection when fitting, removing or adjusting constant tension hose clamps. Service tool T3880207 should be used when fitting, removing or adjusting constant tension hose clamps. Tools that are not designed for use with constant tension clamps, such as standard pliers, will not securely engage with the clamp's opening tangs and may allow the clamp to suddenly release, resulting in personal injury.



Caution

Service tool T3880207 should be used when fitting, removing or adjusting constant tension hose clamps. The use of tools that are not designed for use with constant tension clamps, such as standard pliers, will cause damage to the clamp's finish.

Operation

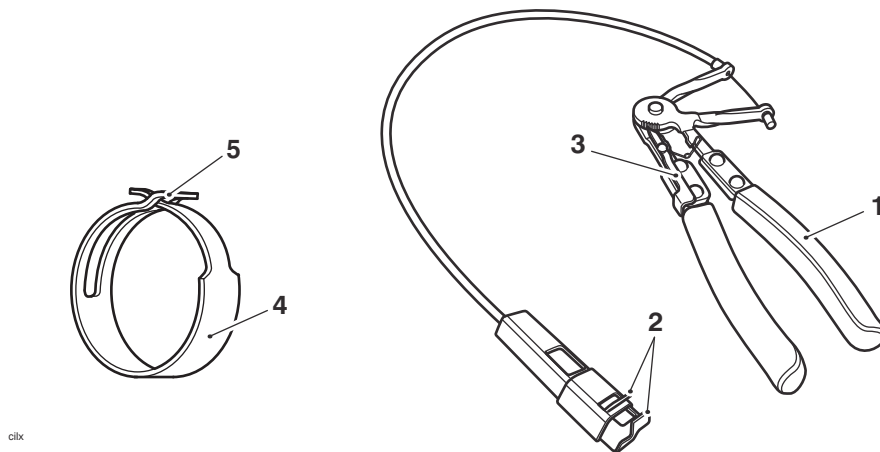

- 1. Service Tool T3880207
- 2. Jaws
- 3. Ratchet
- 4. Hose clamp
- 5. Tangs

To Remove a Hose Clamp:

1. Note the position of the hose clamp on the coolant hose.
2. Position the jaws of the service tool to the tangs of the hose clamp, ensuring the jaws are securely engaged on the clamp.
3. Squeeze the handles of the service tool and open the hose clamp until the ratchet on the tool engages to hold the clamp open.
4. Slide the hose clamp along the hose and release the ratchet to release the clamp.
5. Remove and refit the coolant hose as required.

To Refit a Hose Clamp:

1. Position the hose clamp to the service tool as described above.
2. Position the hose clamp as noted during disassembly.
3. Release the ratchet on the service tool to release the hose clamp.

When ordering replacement parts, always refer to the EPC.

Please mark your copy of the Service Manual with this information.

Item 8.

Description: **Unpacking the Motorcycle**
Models affected: **Sprint GT 1050, Trophy and Trophy SE**

We would like to remind dealers that the following motorcycles are to be removed from their packing crate in a forward direction:

- Sprint GT 1050
- Trophy and Trophy SE.

All other models are removed in a rearward direction.

 Caution
Failure to remove a motorcycle from its packing crate as described in the Unpacking and Pre-delivery Inspection Guide will result in damage to the motorcycle.

Please mark your copy of the Service Manual with this information.

Item 9.

Description: **Unpacking the Motorcycle**
Models affected: **All Models**

For motorcycles that have their handlebars lowered or removed when the motorcycle is packed in the packing crate, ensure that the handlebars are repositioned to their correct position as described in the relevant Motorcycle Assembly Guide. Failure to correctly position the handlebars may cause damage to the fuel tank on full steering lock or during removal from the packing crate. Warranty claims for damage caused by incorrectly adjusted handlebars will not be accepted.

Please mark your copy of the Service Manual with this information.

Item 10.

Description: **Service Manual Issue Level and Part Numbers**
Models affected: **All Models Currently in Production**

Dealers are required to hold current and up-to-date Service Manuals. Use the list attached as Appendix A to review your holding and ensure the current manuals replace the out-dated ones as necessary.

Service Manuals are available from the parts department.

For information relating to non-current motorcycles refer to technical news issue 99 or the EPC.

Please mark your copy of the Service Manual with this information.

Initial and date when read and return to central file holder

Service Manager	Parts Manager	Sales Manager	Workshop Supervisor	Technician 1	Technician 2

All Current Model, Service Manual Part Numbers and Issue Levels							
Model	English	French	German	Italian	Japanese	Spanish	Brazilian
America, Speedmaster	T3856095 Issue 1	T3856097 Issue 1	T3856096 Issue 1	T3856098 Issue 1	Not Available	T3856099 Issue 1	Not Available
Bonneville, Bonneville SE, Bonneville T100 (including Steve McQueen™ and Bonneville T100 110 th Editions), Scrambler, Thruxton	T3856666 Issue 1	T3856662 Issue 1	T3856661 Issue 1	T3856663 Issue 1	T3856665 Issue 1	T3856664 Issue 1	T3856667 Issue 1
Daytona 675, Daytona 675R - up to VIN 564947 Street Triple, Street Triple R - up to VIN 560476	T3856771 Issue 1	T3856773 Issue 1	T3856772 Issue 1	T3856774 Issue 1	Not Available	Not Available	Not Available
Daytona 675, Daytona 675R - from VIN 564948 Street Triple, Street Triple R - from VIN 560477	T3856909 Issue 1	T3856912 Issue 1	T3856911 Issue 1	T3856913 Issue 1	T3856916 Issue 1 (supplement not required)	T3856914 Issue 1	T3856915 Issue 1
Supplement to bring Service Manual up to issue 2	T3856920	T3856923	T3856921	T3856924		T3856922	T3856925
Rocket III, Rocket III Classic, Rocket III Touring, Rocket III Roadster	T3851580 Issue 1	T3851581 Issue 1	T3851582 Issue 1	T3851583 Issue 1	Not Available	Not Available	Not Available
Speed Triple 1050, Speed Triple R 1050 from VIN 461332	T3856544 Issue 1	T3856545 Issue 1	T3856546 Issue 1	T3856547 Issue 1	Not Available	T3856549 Issue 1	T3856548 Issue 1
Sprint GT 1050 ABS, Sprint ST 1050, Sprint ST 1050 ABS	T3856075 Issue 1	T3856076 Issue 1	T3856077 Issue 1	T3856078 Issue 1	T3856079 Issue 1	Not Available	Not Available
Thunderbird, Thunderbird SE, Thunderbird Storm, Thunderbird Commander, Thunderbird LT	T3850890 Issue 1	T3850892 Issue 1	T3850891 Issue 1	T3850893 Issue 1	Not Available	T3850894 Issue 1	Not Available
Tiger 800, Tiger 800 ABS, Tiger 800XC, Tiger 800XC ABS	T3856760 Issue 1	T3856762 Issue 1	T3856761 Issue 1	T3856763 Issue 1	T3856766 Issue 1	T3856765 Issue 1	T3856764 Issue 1
Tiger 1050, Tiger 1050 ABS, Tiger Sport	T3857375 Issue 1	T3857376 Issue 1	T3857377 Issue 1	T3857378 Issue 1	Not Available	T3857379 Issue 1	Not Available
Tiger Explorer, Tiger Explorer XC	T3852795 Issue 1	T3852796 Issue 1	T3852797 issue 1	T3852798 Issue 1	T3852799 Issue 1 (Available March 2014)	T3852788 Issue 1	T3852787 Issue 1
Trophy, Trophy SE	T3852790 Issue 1	T3852791 Issue 1	T3852792 Issue 1	T3852793 Issue 1	Not Available	T3852794 Issue 1	Not Available