



NUMBER: 23-002-13

GROUP: Body

DATE: January 17, 2013

This bulletin is supplied as technical information only and is not an authorization for repair. No part of this publication may be reproduced, stored in a retrieval system, or transmitted, in any form or by any means, electronic, mechanical, photocopying, or otherwise, without written permission of Chrysler Group LLC.

SUBJECT:

Rattle And/Or Clunking Sound From Convertible Top

OVERVIEW:

This bulletin involves inspecting the forward most down capture receiver rod on each of the down capture latch assemblies and if necessary replacing the receiver rod along with installing a revised down capture hook assembly.

MODELS:

2011-2012 (JS) Chrysler 200

NOTE: This bulletin applies to Chrysler 200 hard top convertible models only (sales code VRO).

SYMPTOM/CONDITION:

The customer may experience a rattle or clunking sound coming from the convertible top while driving.

DIAGNOSIS:

The hard top assembly is equipped with a down capture mechanism which locks it into the stowed position when lowered. If the hook assembly (2) does not fully engage the down capture mechanism (1) the roof assembly may produce a rattle or clunk due to insufficient retention of the hard top at the hook assembly (Fig. 1). If the customer describes the symptom, perform the Repair Procedure.

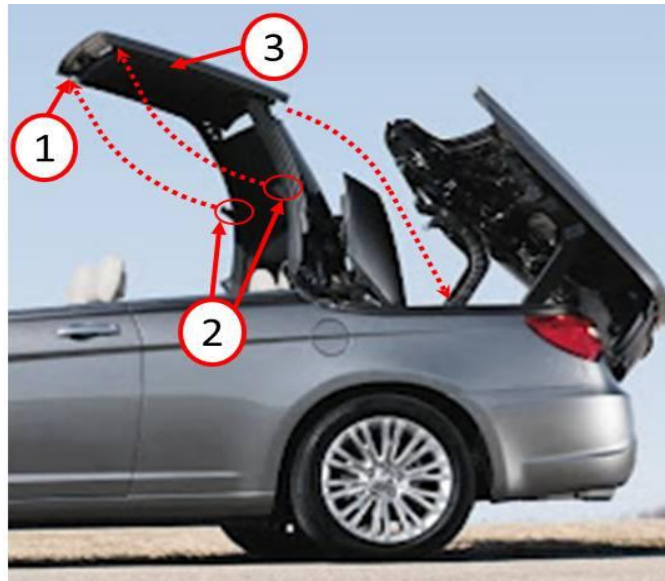

Fig. 1 Hard Top Down Capture System

- 1 - Front Down Capture Mechanism (Latches to C-Pillar Hook Assembly)
 2 - Down Capture Hook Assembly (Retracts From Upper C-Pillar)
 3 - Down Capture Receiver Rod/Latch Assembly (Located Under Headliner)

PARTS REQUIRED:

Qty.	Part No.	Description
2 (AR)	68028492AA	Rod, Bellcrank to Reciever
2 (AR)	68029393AA	Bolt, Shoulder Torx
2 (AR)	68028366AA	Pin Clevis
2 (AR)	68028461AA	J-Clip
1 (AR)	68028570AA	Hook Asm - Side Rail RH (Pearl / DW1)
1 (AR)	68028571AA	Hook Asm - Side Rail LH (Pearl / DW1)
1 (AR)	68028570AB	Hook Asm - Side Rail RH (Black / DX9)
1 (AR)	68028571AB	Hook Asm - Side Rail LH (Black / DX9)

REPAIR PROCEDURE:

1. Pull the headliner back at the side weatherstrip seal on each side of the forward most hard top roof panel and inspect the forward most down capture receiver rod on each of the down capture latch assemblies.
2. Were either of the right and/or left side receiver rods bent and/or damaged?

- a. Yes >>> Proceed to [Step #3](#).
 - b. No >>> Proceed to [Step #4](#).
3. Replace the damaged or bent receiver rod(s) by swinging the retaining clips open and pulling the rod out of the clips ([Fig. 2](#)).

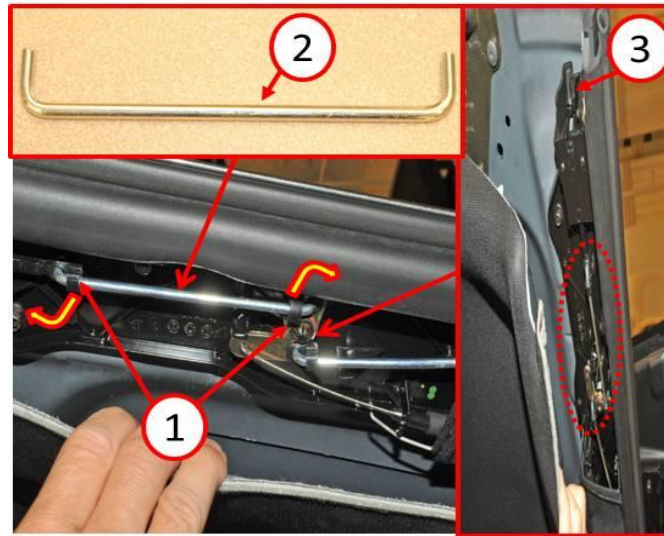

Fig. 2 Down Capture Receiver Rod Replacement

- 1 - Retaining Clips (Secure Receiver Rod)
- 2 - Receiver Rod (Actuates Down Capture Latch)
- 3 - Down Capture Mechanism (Located Under Headliner / Latch Protrudes Out Forward Edge)

-
4. Remove the upper C-pillar trim (2) from both the left and right side of the hard top assembly to gain access to the down capture hook assembly (4) ([Fig. 3](#)).

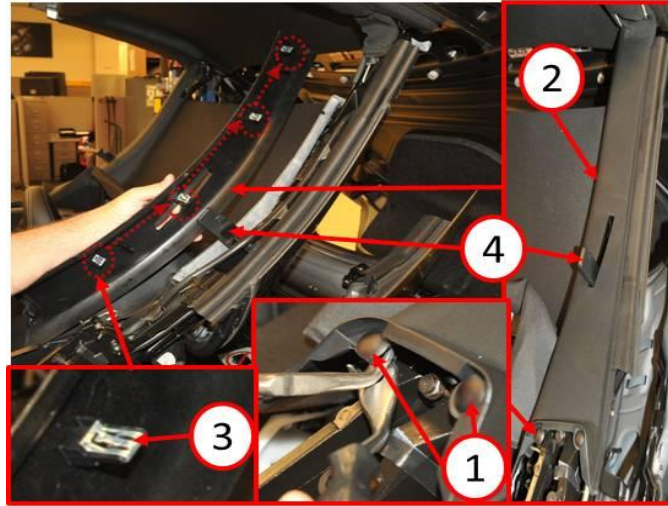

Fig. 3 Upper C-Pillar Trim Removal

- 1 - Plastic Push Clips (2 Retain End of C-Pillar Trim)
- 2 - C-Pillar Trim (Covers Down Capture Hook Assembly)
- 3 - Metal Push Clips (4 Retain C-Pillar Trim)

-
5. Remove the push clip retainer and pin clevis (1) along with the torx shoulder bolt (2) (Fig. 4) to replace the side rail down capture hook assembly with the appropriate side/color specific revised part indicated in the parts section.

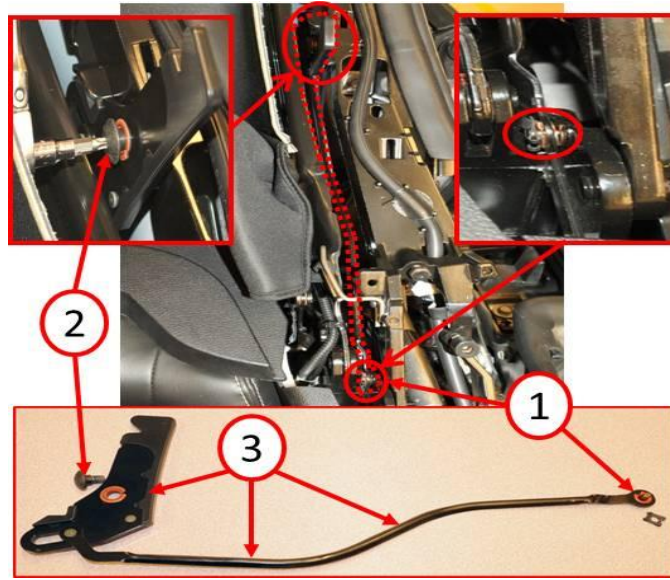

Fig. 4 Side Rail Down Capture Hook Replacement

- 1 - Push Clip Retainer and Pin Clevis
- 2 - Torx Shoulder Bolt
- 3 - Side Rail Down Capture Hook Assembly

6. Reverse the procedures for reinstallation.

POLICY:

Reimbursable within the provisions of the warranty.

TIME ALLOWANCE:

Labor Operation No:	Description	Amount
23-44-18-90	Inspect Receiver Linkage Rods and Replace Down Capture Hook Assemblies (2 - Skilled)	0.4 Hrs.
23-44-18-91	Replace Receiver Linkage Rods and Down Capture Hook Assemblies (2 - Skilled)	0.6 Hrs.

FAILURE CODE:

ZZ	Service Action
----	----------------