



Technical Service Bulletin

SUBJECT:			No: TSB-13-51-002
FRONT LICENSE PLATE HARDWARE ELIMINATED – SERVICE MANUAL REVISION			DATE: February, 2013
			MODEL: See below
CIRCULATE TO:	<input type="checkbox"/> GENERAL MANAGER	<input checked="" type="checkbox"/> PARTS MANAGER	<input checked="" type="checkbox"/> TECHNICIAN
<input checked="" type="checkbox"/> SERVICE ADVISOR	<input checked="" type="checkbox"/> SERVICE MANAGER	<input type="checkbox"/> WARRANTY PROCESSOR	<input checked="" type="checkbox"/> SALES MANAGER

PURPOSE

Front license plate attaching hardware has been eliminated from production. This TSB updates the service manuals of affected vehicles.

AFFECTED VEHICLES

2013 Outlander – vehicles built from December, 2012

AFFECTED SERVICE MANUALS

2013 Outlander – Group 51 – Exterior > Front Bumper Assembly > Removal and Installation

Continued

Copyright 2013, Mitsubishi Motors North America, Inc.

(3953)

The information contained in this bulletin is subject to change. For the latest version of this document, go to the Mitsubishi Dealer Link, MEDIC, or the Mitsubishi Service Information website (www.mitsubishitechinfo.com).

Please add the following new information to the 2013 Outlander Service Manual: Group 51 — Exterior
> Front Bumper Assembly > Removal and Installation

51-4

EXTERIOR
FRONT BUMPER ASSEMBLY

FRONT BUMPER ASSEMBLY

REMOVAL AND INSTALLATION

M1511001401942

Pre-removal and post-installation operation

- Headlight support panel cover removal and installation (Refer to P.51-10.)
- Engine room under cover front removal and installation (Refer to P.51-23.)
- Splash shield removal and installation (Refer to GROUP 42A, Splash Shield P.42A-10.)

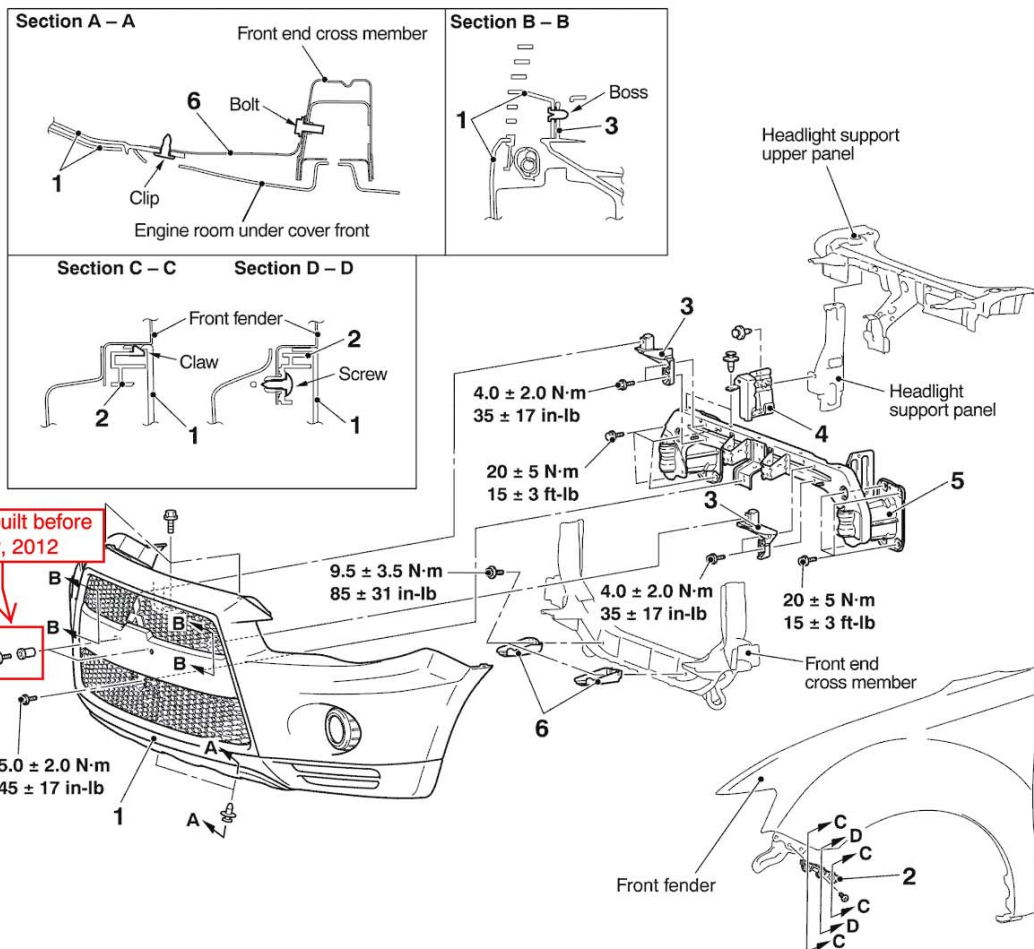

<<Added>>

Vehicles built before
December, 2012**Removal steps**

- Fog light connector connection
<Vehicles with fog light>
1. Front bumper assembly
 2. Front bumper side bracket

Removal steps (Continued)

- Ambient temperature sensor (Refer to Group 55A, Ambient Temperature Sensor P.55A-122)
3. Headlight bracket
 4. Front end panel guide

AC901081AC