



SI B64 01 13
Heating and Air Conditioning

April 2013
Technical Service

This Service Information bulletin supersedes SI B64 01 13 **dated February 2013.**

NEW designates changes to this revision

SUBJECT

IHKA Operating Panel Buttons Are Peeling

MODEL

F01

F02

F04

F06

F07

F10

F12

F13

SITUATION

The surface is peeling off one or more of the IHKA operating panel buttons, and the button symbol may become unreadable.

CAUSE

Ingredients in certain skin care products, including sunscreens and hand lotions, causes the button surface to peel.

In the picture below, you can clearly see how the low fan speed button is just starting to peel. Two of the four fan blades are missing from the button symbol, and soon the entire symbol will be gone.



NEW PROCEDURE

Improved replacement buttons for the IHKA panel are now available as a kit.

Refer to ETK for the correct part number for your model. Replace **ALL** the buttons included in the kit.

Note: The repair procedure can be performed inside the car without removing the console or control panel.



1. Use two narrow picks to carefully pry off the button caps. Since the button will be replaced, pay special attention not to damage the switch. Note: There are two types of button switches; a rocker type for the fan speed adjustment, and a regular push-button type for the others.



2. In this picture, the fan speed button cap has been removed. The cap is attached to the two individual square openings of the switch.



3. In this picture, the driver's side seat heating button is being removed. The cap is attached by four retaining tabs; two on the top, and two on the bottom. Remove the two top tabs, and then the two bottom tabs.

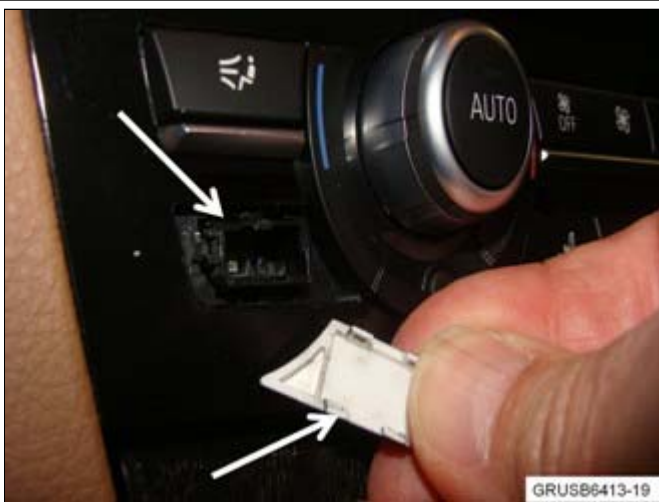

4. The cap has been removed, and the four retaining tabs can be seen.

5. After all button caps have been removed, install the new caps by aligning them squarely to the switch, and then pushing in firmly. Working from the center outward will simplify the installation. After the first cap is installed, check for functionality and smooth operation **before** installing the next cap. Continue installing

the remaining caps in the same fashion.

NEW PARTS INFORMATION

Refer to ETK.

NEW WARRANTY INFORMATION

Covered under the terms of the BMW New Vehicle/SAV Limited Warranty.

Defect Code:	64 11 64 78 00	
Labor Operation:	Labor Allowance:	Description:
64 99 000	5 FRU	Work time to complete the repair procedure (Main work)
or		
64 99 000	3 FRU	Work time to complete the repair procedure (Plus work – vehicle is already in the workshop)

[Copyright ©2013 BMW of North America, Inc.]