

1 4 14-13



## Service Information Bulletin

SUBJECT	DATE
Removal and Installation of the GHG14 13 and 23 Gallon Diesel Exhaust Fluid Tank Header Unit	May 2013

### Additions, Revisions, or Updates

Publication Number / Title	Platform	Section Title	Change
DDC-SVC-MAN-0083	DD Platform	Removal of the GHG14 13 and 23 Gallon Diesel Exhaust Fluid Tank Header Unit	Added DEF header description and removed 2 notices.
		Installation of the GHG14 13 and 23 Gallon Diesel Exhaust Fluid Tank Header Unit	Added step 2.



13400 Outer Drive, West, Detroit, Michigan 48239-4001  
 Telephone: 313-592-5000  
[www.demanddetroit.com](http://www.demanddetroit.com)

## 2 Removal of the GHG14 13 and 23 Gallon Diesel Exhaust Fluid Tank Header Unit

Remove as follows:

The Diesel Exhaust Fluid (DEF) header on vehicles with a 13 or 23 gallon DEF tank is secured to the top of the tank, and contains the engine coolant lines that run through the tank, the coolant valve, the DEF level sensor, and the DEF temperature sensor. See figure below.

**NOTICE:** Discard contaminated DEF and coolant in accordance with Environmental Protection Agency (EPA) regulations.

1. Shut off engine and apply the parking brake, chock the wheels.
2. Disconnect the batteries.
3. Remove the tank from the vehicle. Refer to section "Removal of the GHG14 13 and 23 Gallon Diesel Exhaust Fluid Tank".
4. Using tool W001589000700, rotate the header lock ring counter-clockwise to loosen it, and then remove the lockring from the tank.

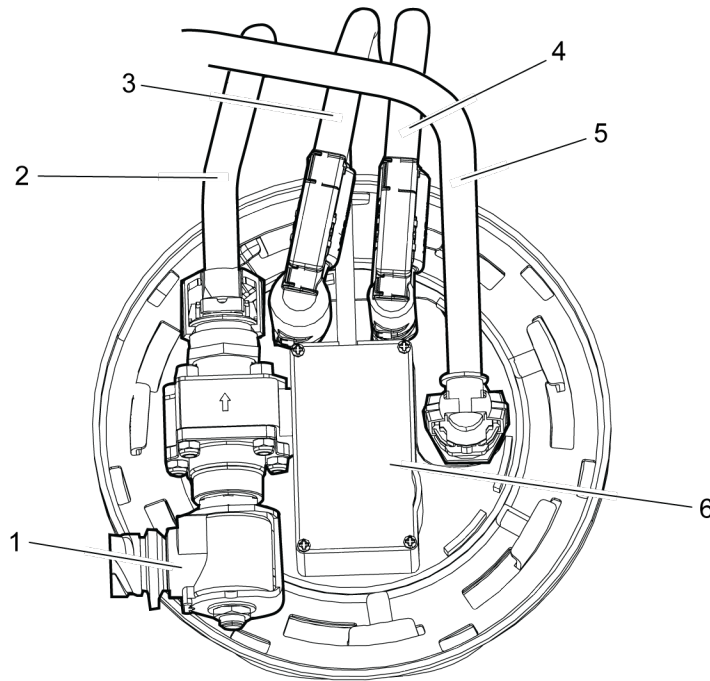

d140228a

5. Remove the header unit from the tank by pulling the assembly straight up, then tilting it to pull the horizontal end clear of the tank.

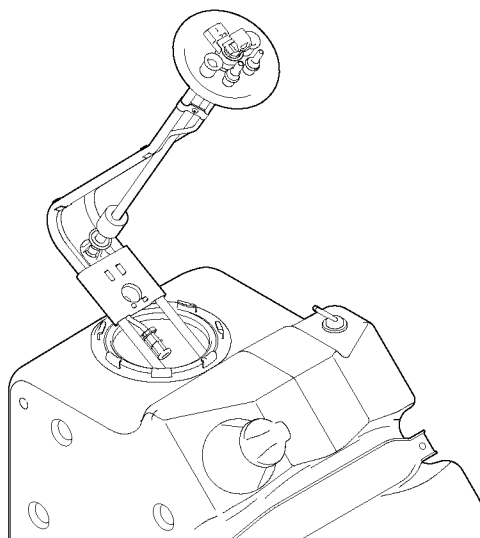

d140233

### 3 Installation of the GHG14 13 and 23 Gallon Diesel Exhaust Fluid Tank Header Unit

Install as follows:

1. Install a new header unit by tilting it to insert the horizontal end into the tank. Once the horizontal segment is inside the tank, tilt the header unit back to vertical to settle the bracket on top of the tank.

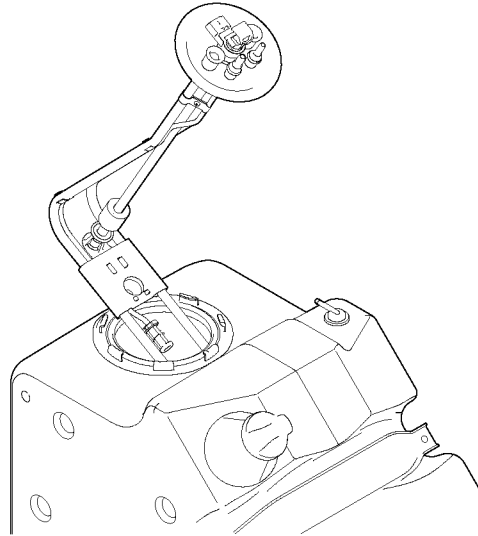

d140233

2. Ensure that the header is situated securely on the raised lip of the tank, and not tilted to the side.
3. Using tool W001589000700, install the header lock ring on the tank and rotate it clockwise to secure it to the tank.
4. Remove any white Diesel Exhaust Fluid (DEF) crystals from the DEF ports on the header unit and the DEF line couplings.
5. Install the DEF tank. Refer to section "Installation of the GHG14 13 and 23 Gallon Diesel Exhaust Fluid Tank".
6. Connect to DDDL/DDRS 7.08-SP2 or higher.
7. Run the SCR ADS Self-Check routine to verify there are no DEF leaks at the connections.