

1 413-13



Service Information Bulletin

Table 1.

SUBJECT	DATE
GHG14 13 and 23 Gallon Diesel Exhaust Fluid Tank	April 2013

Additions, Revisions, or Updates

Table 2.

Publication Number / Title	Platform	Section Title	Change
DDC-SVC-MAN-0083	DD Platform	Removal and Installation of the GHG14 13 and 23 Gallon Diesel Exhaust Fluid Tank	Added step 9 in removal procedure. Added step 5 in installation procedure.



13400 Outer Drive, West, Detroit, Michigan 48239-4001
 Telephone: 313-592-5000
www.demanddetroit.com

2 Removal of the GHG14 13 and 23 Gallon Diesel Exhaust Fluid Tank

Remove as follows:

NOTICE: Discard contaminated Diesel Exhaust Fluid (DEF) and coolant in accordance with Environmental Protection Agency (EPA) regulations.

1. Shut off engine, apply the parking brake, and chock the wheels.
2. Disconnect the batteries.
3. Drain the coolant from the cooling system. Refer to section "Cooling System Drain Procedure".
4. Remove the beauty cover, if equipped.
5. Using a siphon, empty the Diesel Exhaust Fluid (DEF) from the tank into a clean container. Uncontaminated DEF can be used again.
6. Place a drain pan underneath the tank to catch any DEF or coolant that drains out.
7. Disconnect the coolant valve harnesses (1) and DEF level and temperature sensor wiring harness (6) from the DEF tank header unit.

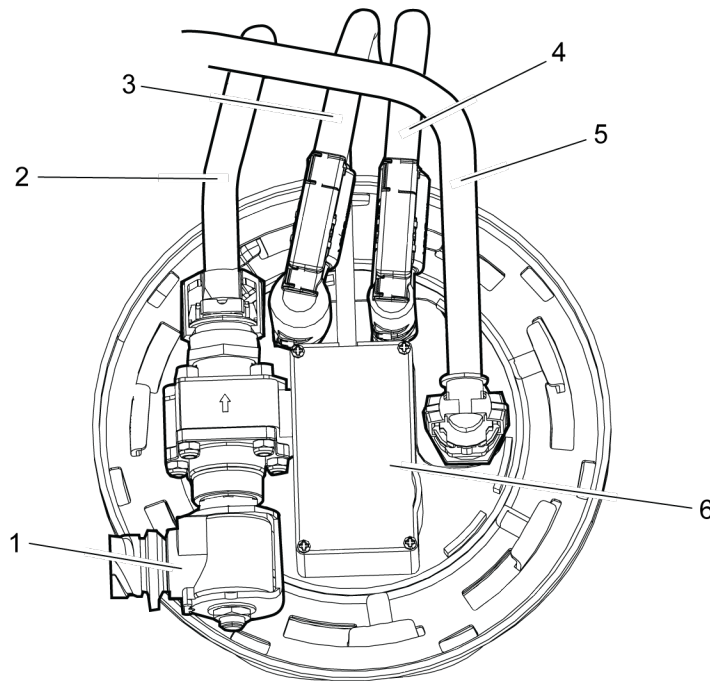

d140228a

NOTICE: To disconnect a DEF line, push the line coupling in towards the male connector to move the holding clip to the unlocked position, then compress the prongs of the holding clip and pull the line off of the male connector. Failure to properly remove a DEF line can result in damage to a line coupling or DEF port.

8. Disconnect the coolant line (2, 5) from the tank header unit.
9. Disconnect the DEF line heater wiring harnesses from the DEF lines at the tank.
10. Disconnect the DEF lines (3, 4 from above graphic) from the tank header unit.
11. Remove the two nuts that secure the tank retaining bracket (5) to the tank mounting cage (1) and remove the retaining bracket.

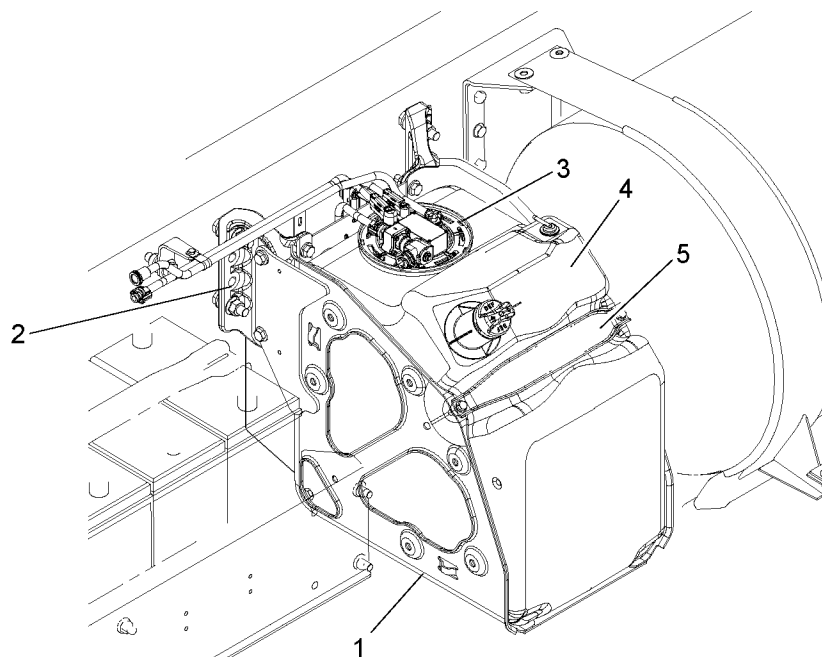

d140229a

12. Remove the tank (4) from the mounting cage (1).

3 Installation of the GHG14 13 and 23 Gallon Diesel Exhaust Fluid Tank

Install as follows:

1. Install the Diesel Exhaust Fluid (DEF) tank (4) into the mounting cage (1).

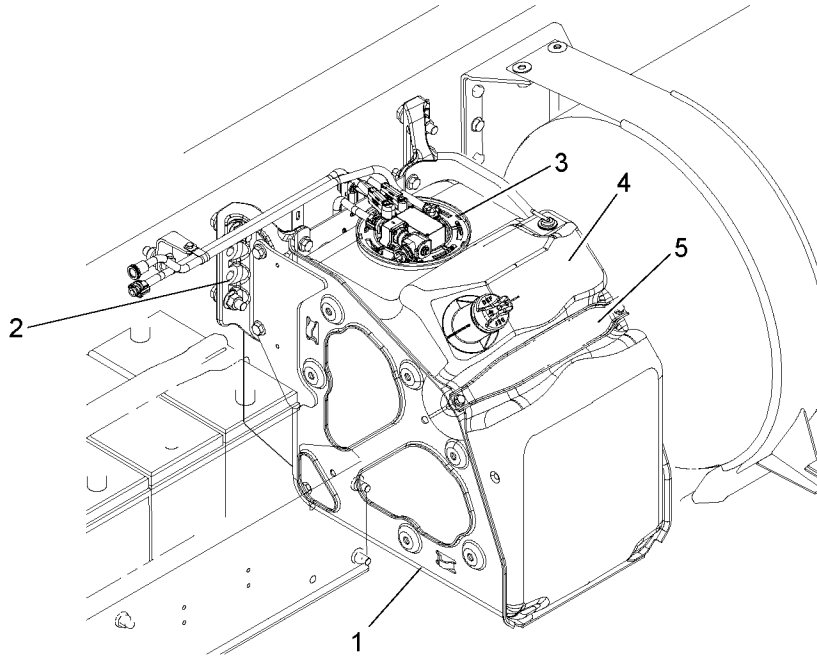

d140229a

2. Install the tank retaining bracket (5) on the tank mounting cage studs. Install two nuts on the tank retaining bracket and tighten the nuts to 16 N·m (12 lb·ft).
3. Remove any white DEF crystals from the DEF ports on the header unit and the DEF line couplings.

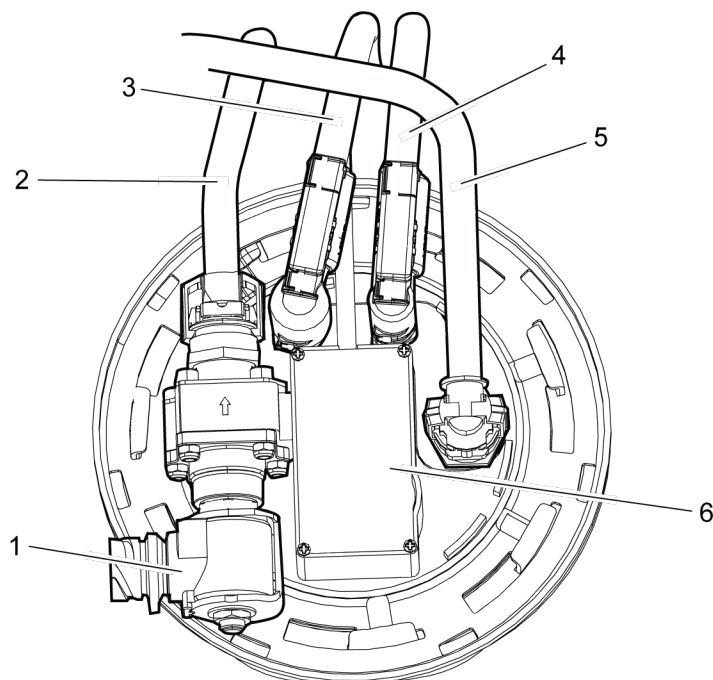

d140228a

NOTICE: To connect a DEF line, push the line coupling onto the DEF port male connector, then pull back gently on the coupling to engage the holding clip in the locked position.

4. Connect the DEF supply line (4) and return line (3) to the tank header unit.
5. Connect the DEF line heater wiring harnesses to the DEF lines at the tank.
6. Connect the coolant lines (2, 5) to the tank header unit.
7. Connect the coolant valve (1) and DEF level and temperature sensor wiring harness (6) to the tank header unit.
8. Fill the DEF tank.
9. Install the beauty cover, if equipped.
10. Fill the cooling system and check for leaks. Refer to section "Cooling System Fill Procedure".
11. Connect the batteries.