



Service Bulletin

PRELIMINARY INFORMATION

Subject: Pop or Clunk Noise When Turning Steering Wheel at a Stop or Low Speeds

Models: 2010-2013 Chevrolet Impala

Condition/Concern

Some customers may comment on a clunk or pop type noise when turning the steering wheel at a stop or at low speeds.

Recommendation/Instructions

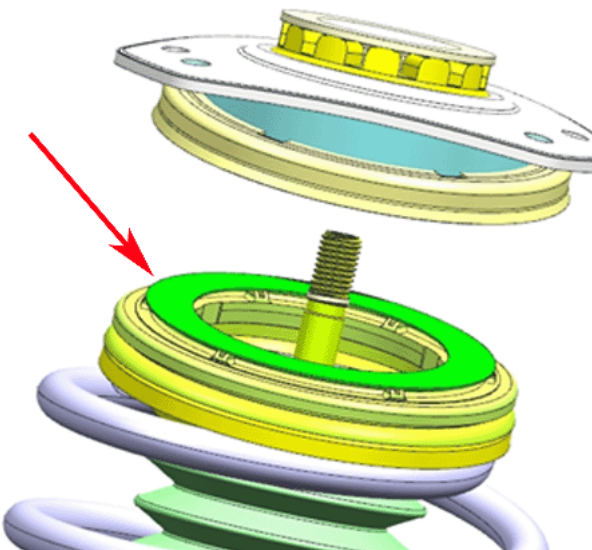

Install the strut spacer as shown above. Refer to Strut, Strut Component, or Spring Replacement in SI.

Parts Information

Part Number	Description
23119610	Strut Spacer

Warranty Information

For vehicles repaired under warranty, use:

Labor Operation	Description	Labor Time
8033790	Strut, Strut Component, or Spring Replacement	Use Published Labor Operation Time

8033791	Strut, Strut Component, or Spring Replacement – Both Sides	Use Published Labor Operation Time
---------	--	------------------------------------

GM bulletins are intended for use by professional technicians, NOT a "do-it-yourselfer". They are written to inform these technicians of conditions that may occur on some vehicles, or to provide information that could assist in the proper service of a vehicle. Properly trained technicians have the equipment, tools, safety instructions, and know-how to do a job properly and safely. If a condition is described, DO NOT assume that the bulletin applies to your vehicle, or that your vehicle will have that condition. See your GM dealer for information on whether your vehicle may benefit from the information.



WE SUPPORT VOLUNTARY TECHNICIAN CERTIFICATION