

# Antenna Installation During PDS

**Service Category** General

**Section** Pre-Delivery Service

**Market** USA

Toyota Supports  
 ASE Certification 

## Applicability

YEAR(S)	MODEL(S)	ADDITIONAL INFORMATION
2014	4Runner, FJ Cruiser, Highlander, Sienna, Tacoma, Tundra	

## Introduction

The radio antenna pole on some models is designed with a hex-cut base and requires installation using a wrench. When performing PDS or installing the antenna pole for any other reason, inspect the antenna base for a hex-cut to determine if the following procedure is required.

## Warranty Information

OP CODE	DESCRIPTION	TIME	OFP	T1	T2
N/A	Not Applicable to Warranty	–	–	–	–

## Installation Procedure

The radio antenna pole and wrench are loaded inside the vehicle at the assembly plant to avoid damage in transit. Install the antenna during PDS according to the instructions below and place the wrench in the glove box for the customer.

1. Remove the protective shipping plug from the antenna base of the fender.
2. Screw the antenna pole into the antenna base and tighten by hand until fully seated.

## Antenna Installation During PDS

### Installation Procedure (Continued)

- Using an 8 mm wrench, fully tighten the antenna pole by rotating the base 1/8 of a turn (20 to 45 degrees) clockwise.

**Torque: 3.3 N\*m (34 kgf\*cm, 29 in\*lbf)**

**NOTICE**

- Do NOT over-tighten.
- Do NOT use pliers to tighten the antenna pole as damage can occur to the antenna pole surface.

**NOTE**

The antenna pole cannot be tightened by hand to the proper specification.

**Figure 1.**

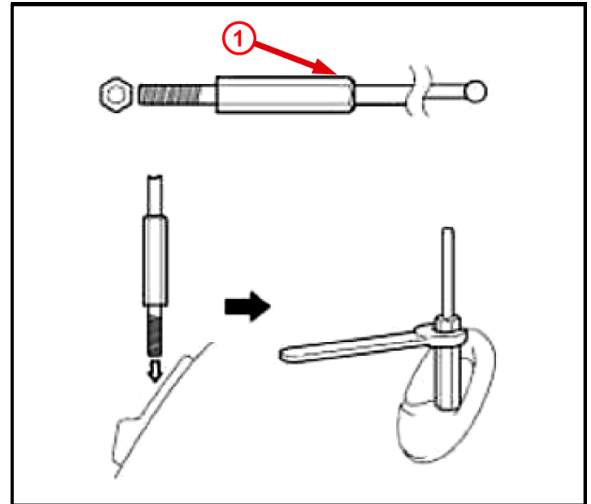

<b>1</b>	<b>Hex-cut Type Antenna</b>
----------	-----------------------------