

Coolant Pipe, Radiator (Lower)
 VAH
 D11H, D13H

FSB 261-036, Coolant Pipe, Radiator (Lower)

(January 2013)

Some VOLVO VAH trucks built with lower coolant pipe 21783978 or 21585759 may experience contact between the engine coolant service nipple and the steer axle under heavy load and braking conditions. Insufficient clearance between the engine coolant service nipple and the steer axle may cause a minor coolant leak at the service nipple. A new engine coolant pipe has been designed with the service nipple relocated for increased clearance. If this condition is encountered, install new pipe (22013490), service nipple (1676622), o-ring (975675), and gasket (979099).

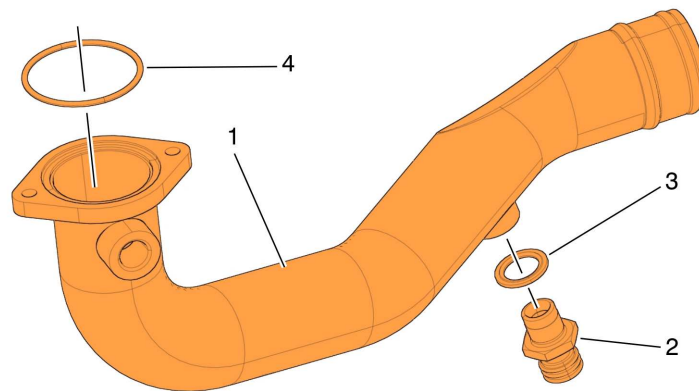

W2076923

Required Parts

Coolant Pipe, Radiator (Lower) Parts			
Item	Description	Part Number	Qty
1	Coolant Pipe, Lower	22013490	1
2	Service Nipple	1676622	1
3	Gasket	979099	1
4	O-ring	975675	1

Procedure

You must read and understand the precautions and guidelines in Service Information, group 20, "General Safety Practices, Engines" before performing this procedure. If you are not properly trained and certified in this procedure, ask your supervisor for training before you perform it.

- 1 Secure the vehicle for service by parking it on a flat level surface, applying the parking brake, chocking the rear wheels, and placing the transmission in neutral or park.
- 2 Disconnect all battery cables from the negative (ground) battery terminals to prevent personal injury from electrical shock and prevent damage to electrical components.
- 3 Raise hood.
- 4 Connect coolant injector/extraction tool 85112740 to lower coolant pipe service nipple and drain coolant.

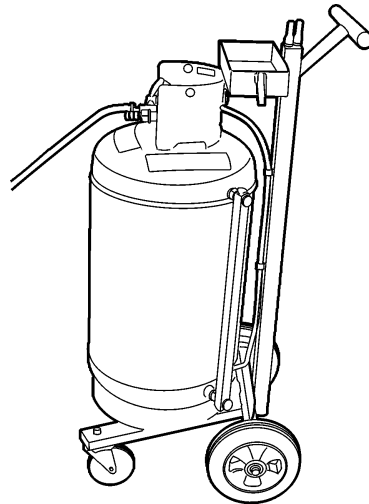

W2004191

- 5 Disconnect coolant injector/extractor quick connect from lower coolant pipe and move line out of the way.
- 6 Remove fasteners and clamp securing lower coolant pipe to stand off bracket.

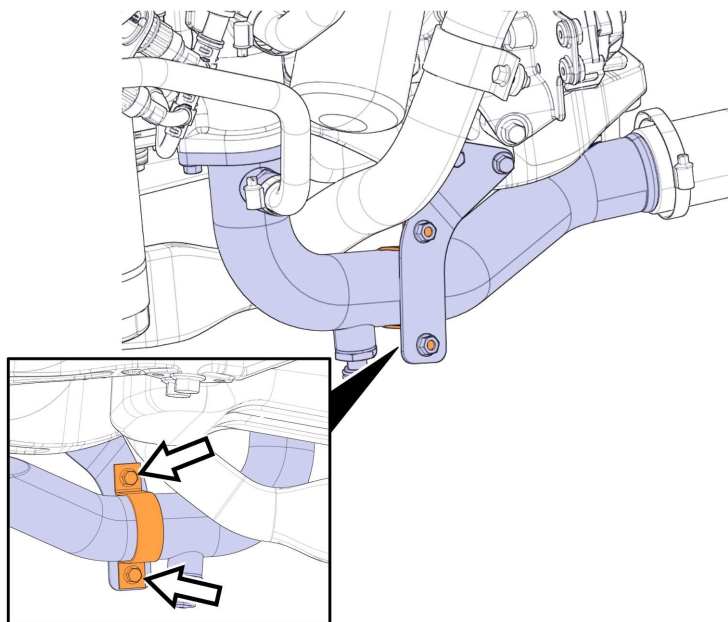

W2076924

- 7 Loosen hose clamp securing lower coolant pipe to lower radiator hose.

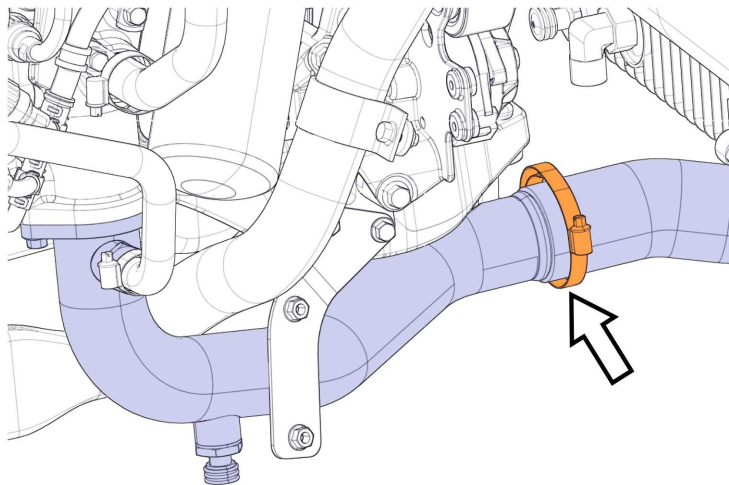

W2076925

- 8 Loosen hose clamp and remove power steering cooler line from nipple.

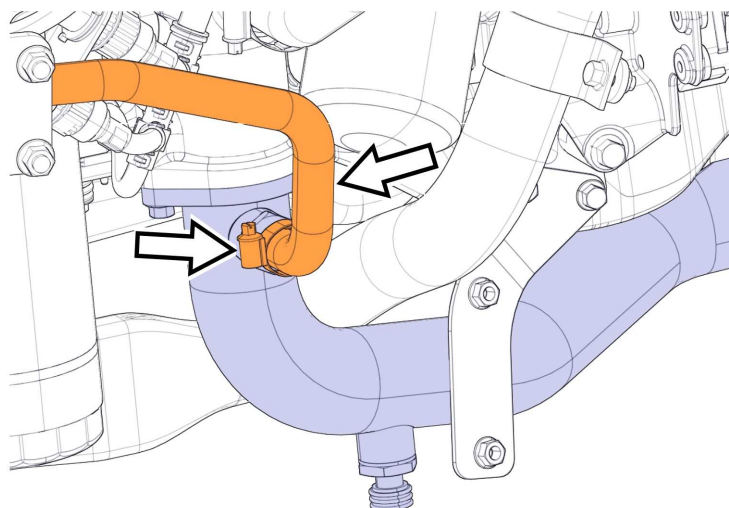

W2076926

9 Remove fasteners securing lower coolant pipe to distribution pipe.

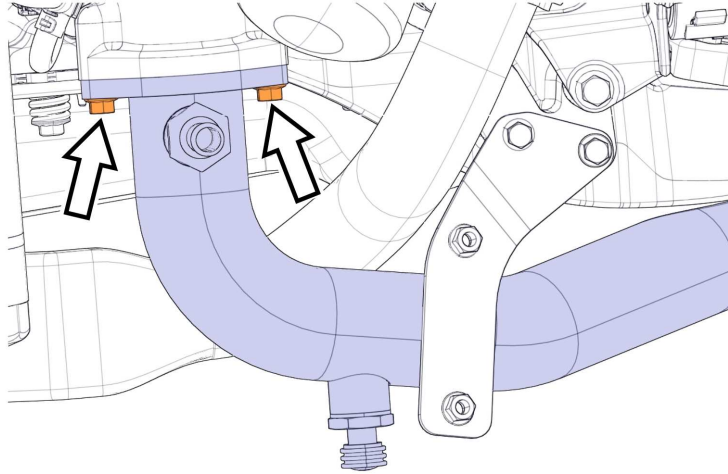

W2076927

10 Remove lower coolant pipe.

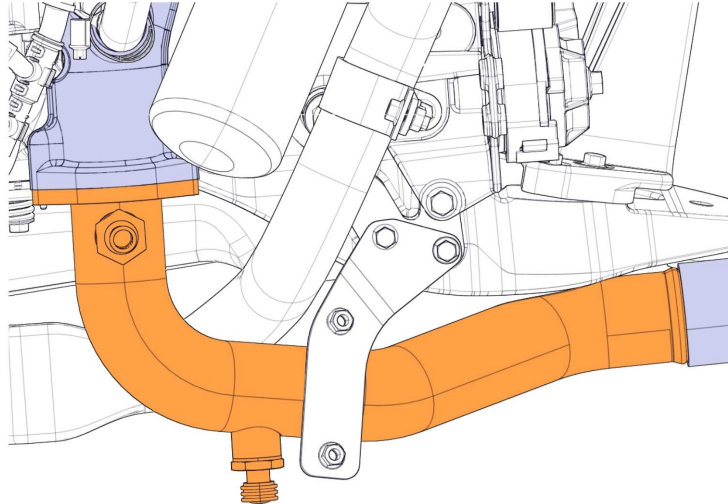

W2076928

11 Transfer the power steering cooler line nipple from the existing lower coolant pipe to new pipe (22013490). Tighten cooler line nipple to 34 ± 4 Nm (25 ± 3 ft-lb).

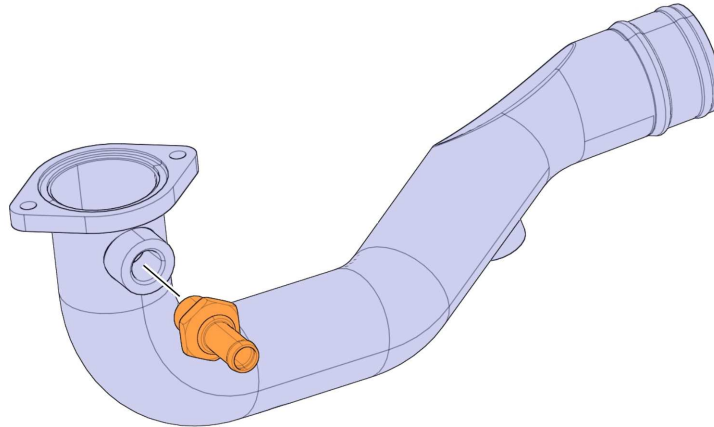

W2076929

12 Install replacement o-ring (975675), service nipple (1676622), and gasket (979099) on new lower coolant pipe. Tighten service nipple to 34 ± 4 Nm (25 ± 3 ft-lb).

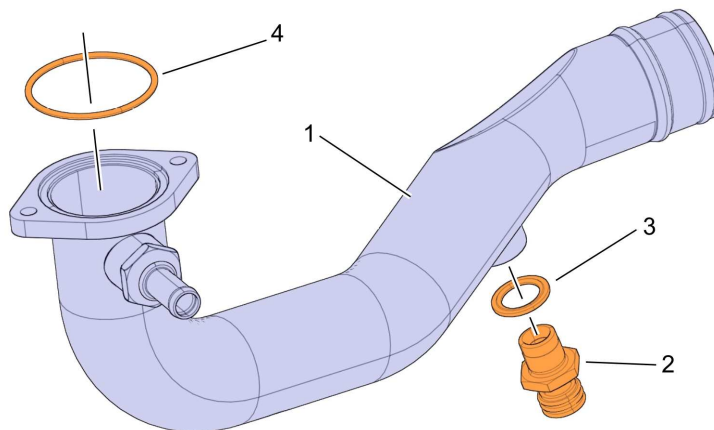

W2076930

13 Assemble lower coolant pipe, hose clamp and lower radiator hose.

14 Tighten hose clamp to 4 ± 0.6 Nm (35 ± 5 in-lb).

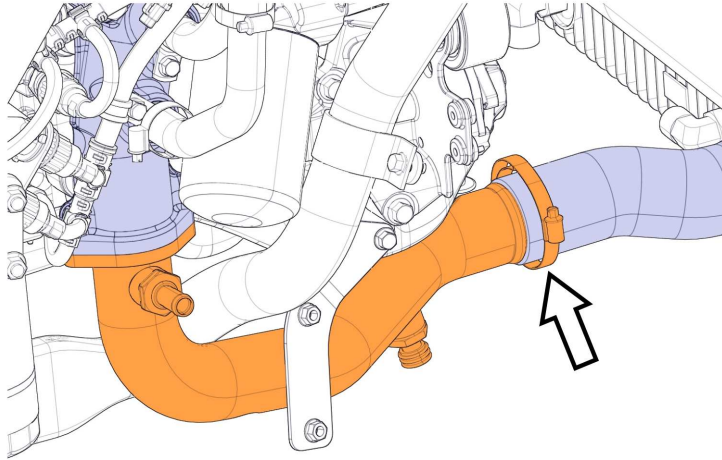

W2076931

15 Install fasteners securing lower coolant pipe to distribution pipe.

16 Tighten fasteners to 24 ± 4 Nm (18 ± 3 ft-lb).

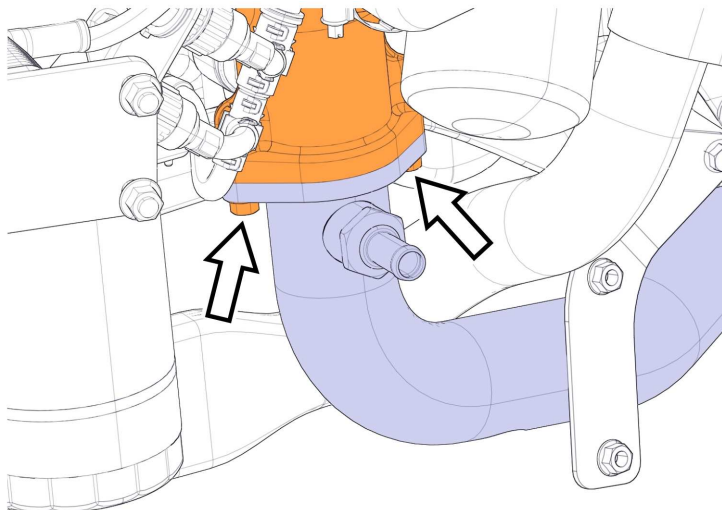

W2076932

17 Assemble power steering cooler line, and hose clamp to the lower coolant pipe nipple.

18 Tighten hose clamp to 4 ± 0.6 Nm (35 ± 5 in-lb).

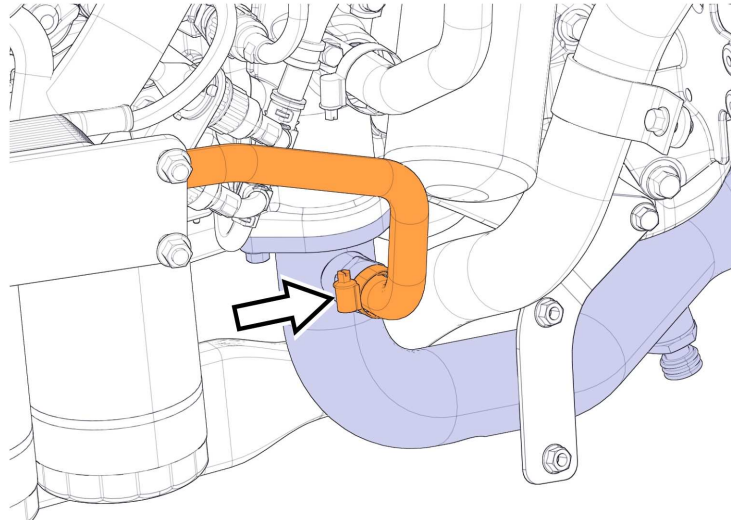

W2076933

19 Install clamp and fasteners securing lower coolant pipe to stand-off bracket.

20 Tighten fasteners to 24 ± 4 Nm (18 ± 3 ft-lb).

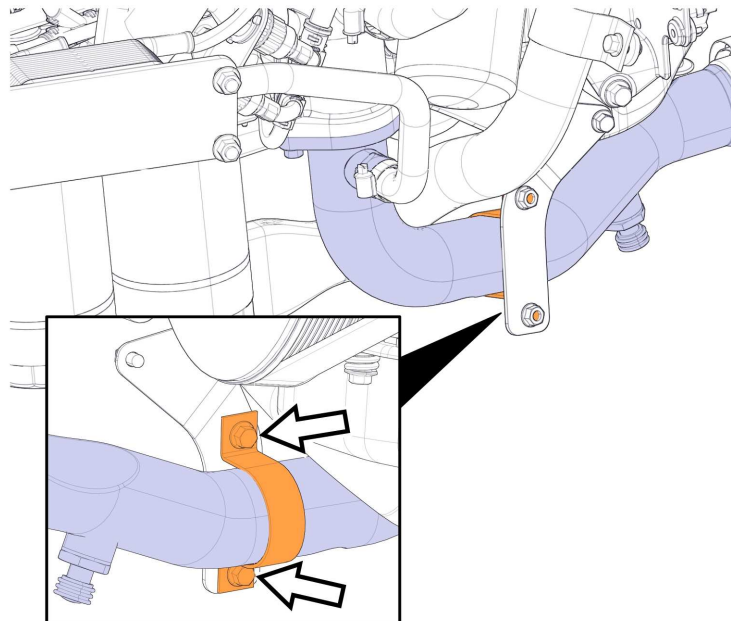

W2076934

- 21 Connect coolant injector/extraction tool 85112740 to the lower coolant pipe nipple and refill coolant to proper level.

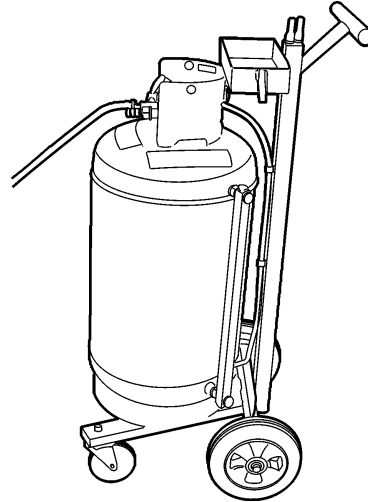

W2004191

- 22 Disconnect coolant injector/extractor quick connect from lower coolant pipe and move line out of the way.
- 23 Reconnect all previously removed cable to the negative (ground) battery terminals.
- 24 Start engine, check for proper operation and leaks.
- 25 Close hood.
- 26 Remove wheel chocks.

Reimbursement

This repair may be eligible for reimbursement if a product failure was experienced within time and mileage limits of the applicable Warranty coverage. Reimbursement is obtained via the normal claim handling process.	
Claim Type (used only when uploading from the Dealer Bus. Sys.)	W
Labor Code	
Primary Labor Code	26150-2-00 0.8 hrs.
Causal Part	21783978

VOLVO Trucks North America engages in a continuous program of testing and evaluating to provide the best possible product. VOLVO Trucks North America, however, is not committed to, or liable for updating existing chassis.