

Technical Bulletin

Model(s)	Year	Eng. Code	Trans. Code	VIN Range From	VIN Range To
Jetta, Jetta Wagon	2009	2.0L TDI (CBEA, CJAA)	All	All	All
Jetta Sedan, Golf, Jetta SportWagen	2010-2012	2.0L TDI (CJAA)	All	All	All
Passat	2012	2.0L TDI (CKRA)	All	All	All

Condition

26 13 01 February 22, 2013 2031583 Supersedes T.B. V261208 dated December 11, 2012 to update Passat vendor code in warranty table.

MIL ON - DTC's P047F, P0477, P048A, P048B, P048C or P0401 Stored in ECM Fault Memory

MIL ON, DTCs related to exhaust flap. One or more of the following fault codes stored in the ECM:

DTC	Description
P047F	Exhaust Pressure Control Valve "A" Stuck Open
P0477	Exhaust Pressure Control Valve "A" Low
P048A	Exhaust Pressure Control Valve "A" Stuck Closed
P048B	Exhaust Pressure Control Valve Position Sensor/Switch Circuit
P048C	Exhaust Pressure Control Valve Pos. Sensor/Switch Circuit Range/Performance
P0401	Exhaust Gas Recirculation Flow Insufficient Detected

Technical Background



Tip:

Water and road salt can corrode the exhaust flap shaft causing it to stick in open / closed position.

Technical Bulletin

Production Solution

Improved parts introduced into production.

Service



WARNING:

To avoid possible injury:

When attempting to move the exhaust flap by hand, the ignition key should be in the OFF position.

If you are attempting to control the exhaust flap electronically using the scan tool, keep your hands away from the flap during the activation.

1. If one or more of the following faults are stored in the ECM fault memory, remove the exhaust flap to check for a sticking condition. (Item 4).

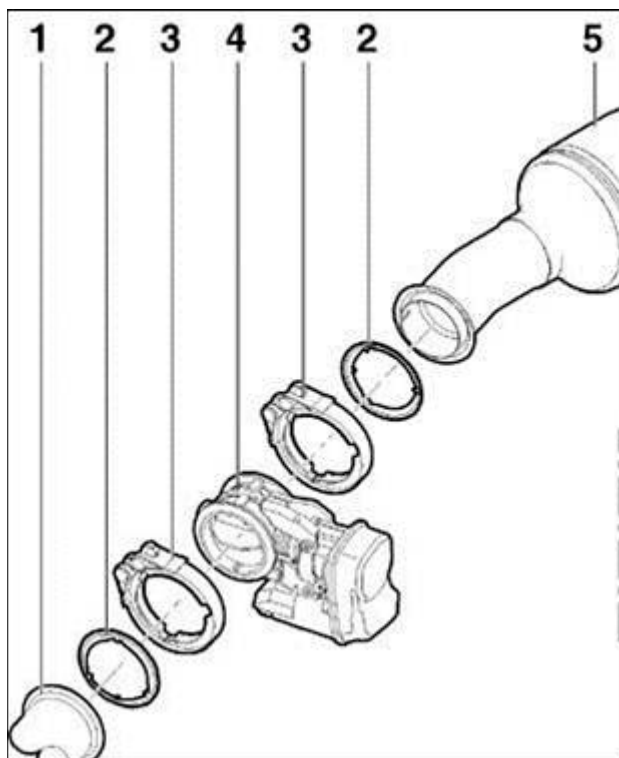

If the flap cannot be moved or does not move freely, the exhaust flap must be replaced.



Technical Bulletin

Warranty

To determine if this procedure is covered under Warranty, always refer to the Warranty Policies and Procedures Manual ¹⁾					
Model(s)	Year(s)	Eng. Code(s)	Trans. Code(s)	VIN Range From	VIN Range To
Jetta, Jetta Wagon	2009	2.0L TDI (CBEA, CJAA)	All	All	All
Jetta Sedan, Golf, Jetta SportWagen	2010-2012	2.0L TDI (CJAA)	All	All	All
Passat	2012	2.0L TDI (CKRA)	All	All	All
SAGA Coding					
Claim Type:			Use applicable Claim Type ¹⁾		
Service Number:	Damage Code	HST	Damage Location (Depends on Service No.)		
2671	0017	--	Use applicable when indicated in ElsaWeb (L/R)		
Parts Manufacturer	Golf		WWO ²⁾		
	Jetta, Jetta Wagon, Jetta Sedan, Jetta SportWagen		3ME ²⁾		
	Passat		TX6 ²⁾		
2009 Jetta, Jetta Wagon					
Labor Operation ³⁾: Remove and Install Exhaust Flap		26711931 = 70 TU			
2010-2012 Jetta Sedan, Golf, Jetta SportWagen					
Labor Operation ³⁾: Remove and Install Exhaust Flap		26711931 = 70 TU			
2012 Passat					
Labor Operation ³⁾: Remove and Install Exhaust Flap		26711933 = 40 TU			



Technical Bulletin

Causal Part:	1K0 253 691 F	
Diagnostic Time ⁴⁾		
GFF Time expenditure	01500000 = 20 TU max.	YES
Road Test	01210002 01210004	NO
Technical Diagnosis	0132xxxx = 00 TU max.	NO
Claim Comment: Input "As per Technical Bulletin 2031583" in comment section of Warranty Claim.		
1) Vehicle may be outside any Warranty in which case this Technical Bulletin is informational only		
2) Code per warranty vendor code policy.		
3) Labor Time Units (TUs) are subject to change with ELSA updates.		
4) Documentation required per Warranty Policies and Procedures Manual.		

Required Parts and Tools

Part Description	Part No:	Quantity
Exhaust Regulator Flap	1K0 253 691 F	1
Clamp	1K0 253 725 B	2

No special tools required.

Additional Information

All part and service references provided in this Technical Bulletin are subject to change and/or removal. Always check with your Parts Dept. and Repair Manuals for the latest information.