



Pre-delivery & Scheduled Maintenance Checklists
 Models: M.Y. 2013 Hypermotard (Standard and SP) and Hyperstrada
 Service Bulletin SVC-13-011

Date: April 16, 2013
 To: Dealer Principal, General Manager, Service Manager, and Service Technician
 From: Austin Gray, Technical Director; Jonathan LaForte, Technical Manager

Dear Ducati Dealer,

Ducati is pleased to announce the new Pre-delivery and Scheduled Maintenance Check List forms for the M.Y. 2013 Hypermotard (Standard and SP) and Hyperstrada. These communication tools are an integral part of Ducati Service minimum requirements.

This document serves as a complement to the information you already received through Ducati's Technical Training courses. Herein you will find important information concerning the following:

- Pre-delivery vehicle preparation
- Information for delivering the motorcycle to the Customer
- Servicing instructions

As previously communicated, the key new feature of the M.Y. 2013 Hypermotard and Hyperstrada models is the longer service interval, which is now 9,000 miles, with Desmo Service scheduled every 18,000 miles.

• **VERSIONS**

The M.Y. 2013 Hypermotard and Hyperstrada family are available in 3 different versions:

<u>VERSION</u>	<u>STANDARD EQUIPMENT</u>
<p>HYPERMOTARD</p> 	<ul style="list-style-type: none"> • Riding Modes • Ducati Safety Pack (ABS + DTC) • Ride by Wire • Ready for: anti-theft system, heated grips, satellite navigator



Pre-delivery & Scheduled Maintenance Checklists
 Models: M.Y. 2013 Hypermotard (Standard and SP) and Hyperstrada
 Service Bulletin SVC-13-011

HYPERMOTARD SP



- Riding Modes
- Ducati Safety Pack (ABS + DTC)
- Ride by Wire
- Marchesini forged rims, tapered aluminum handlebar, carbon parts (front mudguard, engine covers)
- Ready for: anti-theft system, heated grips, satellite navigator

HYPERSTRADA



CAUTION: Please be reminded that the Hyperstrada model is sold with three possible seat heights from ground, obtained by mixing two different seats and two different types of suspension.

For the standard and lowered versions you will then find different part numbers for the front suspension (standard has 150 mm travel, while lowered has 130 mm travel) and rear suspension (standard has 61.5 mm travel, while lowered has 55.5 mm travel) and hence side stand length (2 different part numbers) and central stand length (2 different part numbers) will be different as well.

- Riding Modes
- Ducati Safety Pack (ABS + DTC)
- Ride by Wire
- Semi-rigid side panniers (50 litres) with integrated supports, touring windscreen, touring seat, passenger grab rail, centre stand, oversized front and rear mudguards, engine belly pan, no. 2 12V power outlets
- Ready for: anti-theft system, heated grips, satellite navigator
- Hyperstrada OEM seat height:

HYPERSTRADA OE SEAT HEIGHT	
850 mm EUR/AUS/CAL/CDN	Suspensions – STANDARD
	Seat – STANDARD
830 mm EUR/AUS/CAL/CDN (ON REQUEST ONLY)	Suspensions – LOWERED
	Seat – STANDARD
810 mm ONLY JAP and APAC	Suspensions – LOWERED
	Seat – LOWERED

The lowered seat (-20 mm) by Ducati Performance is available for all country versions as an accessory.



Pre-delivery & Scheduled Maintenance Checklists
Models: M.Y. 2013 Hypermotard (Standard and SP) and Hyperstrada
Service Bulletin SVC-13-011

VEHICLE PRE-DELIVERY

Below is a list of the tasks to be carried out during pre-delivery.

As an attachment to this Service Bulletin you will find the printable version of the **Check List of Pre-delivery interventions** for the M.Y. 2013 Hypermotard and Hyperstrada. We ask that you print this form and fill out all of its parts during pre-delivery inspections. Provide it to the Customer while filing a copy of it with the repair order.

DUCATI SERVICE PRE-DELIVERY - Check List



The checks related to pre-delivery are the following:

- 1) Transport packaging integrity visual check (if required).
- 2) Transport packaging removal (if required).
- 3) Check of the supplied kit completeness (use the list included in the supplied kit).
- 4) Motorcycle integrity visual check.
- 5) Assembly of hand guards (where applicable) - **SEE INSTRUCTIONS on Page 5**
- 6) Rear-view mirrors assembly - **SEE INSTRUCTIONS on Page 8**
- 7) Plexiglas assembly (Hyperstrada only) - **SEE INSTRUCTIONS on Page 9**
- 8) Assembly of latches on side panniers (Hyperstrada only) - **SEE INSTRUCTIONS on Page 13**
- 9) Battery service and installation on the vehicle - **SEE INSTRUCTIONS on Page 10**
- 10) Final drive correct tensioning check;
- 11) Tire pressure check - **SEE INSTRUCTIONS on Page 20**
- 12) Brake fluid and coolant check (top-up if necessary).
- 13) Engine oil level check (top-up if necessary).
- 14) Lights, turn indicators, horn and controls operation check. Check of the adjustment of the headlight beam height. Check of handlebar free movement and any interference.
- 15) Check keys operation; check proper operation of steering lock to the right and left.
- 16) Check of the front and rear wheel shaft tightening
(Front: 63 Nm \pm 5% - Rear: 176 Nm \pm 5%);



Pre-delivery & Scheduled Maintenance Checklists
Models: M.Y. 2013 Hypermotard (Standard and SP) and Hyperstrada
Service Bulletin SVC-13-011

- 17) Check tightening of brake caliper retaining screws
(Front: 45 Nm \pm 5% - Rear: 25 Nm \pm 5%).
- 18) Fuel service until the reserve warning light turn off.
- 19) Engine stop switch, side stand switch and clutch lever switch operation check.
- 20) Check for available technical updates (if any) and recall campaigns in DCS.
- 21) Assembly of Ducati Performance accessories (if applicable)
- 22) Final inspection and road test (safety devices and electric fans operation check).
- 23) ECU trouble code reading with DDS 2.0 and software update check (use the Global Scan function).
- 24) Clean of the motorcycle
- 25) Motorbike warranty activation (warranty terms and conditions).
- 26) Illustrate to the Customer how the motorcycle works.
- 27) Deliver to the Customer the documentation included in the supply and the Service Manual (duly filled out).

CHECKING THE SUPPLIED KIT

Check that the kit supplied with the motorcycle is complete; this also applies to the side panniers kit, only for Hyperstrada. All motorcycles come with 2 keys associated to 3 latches for side panniers and top case locks, which can be found inside the kit located under the seat.



Please be reminded (as explained in Tips&Tricks # 70) that you will no longer find any CODE CARD with the motorcycles. However, on the first batch of motorcycles delivered, dealers may find a CODE CARD. If this is the case we ask you to remove the CODE CARD and NOT deliver it to the final Customer.



Pre-delivery & Scheduled Maintenance Checklists
Models: M.Y. 2013 Hypermotard (Standard and SP) and Hyperstrada
Service Bulletin SVC-13-011



NOTE – HYPERSTRADA ONLY

Inform the Customer how to properly use the **two screws (1)** available in the kit located in the under-seat compartment, together with the side pannier lock tumblers.

The screws are used in case it is necessary to restore the front fixture of the **number plate holder (A)**, if the side pannier support is removed. In this case, tighten the screws (1) to a torque of 20 Nm ± 10%.



• **INSTALLING THE HAND GUARDS**

If the hand guards are already installed on the motorcycle, it will be necessary to change the two GREY service screws with the two BLACK screws supplied in the kit, start them with pre-applied threadlocker. Tighten the screws to a torque of 5 Nm ± 10%.





Pre-delivery & Scheduled Maintenance Checklists
Models: M.Y. 2013 Hypermotard (Standard and SP) and Hyperstrada
Service Bulletin SVC-13-011



NOTE

This document describes the procedure for installing the RH hand guard; follow the same procedure for installing the LH one.

- 1) Remove the **hand guard (1)** assembly from the packaging.



NOTE - HYPERMOTARD SP ONLY

While removing the packaging, ensure **weight (2)** is positioned correctly on **hand guard (1)**.

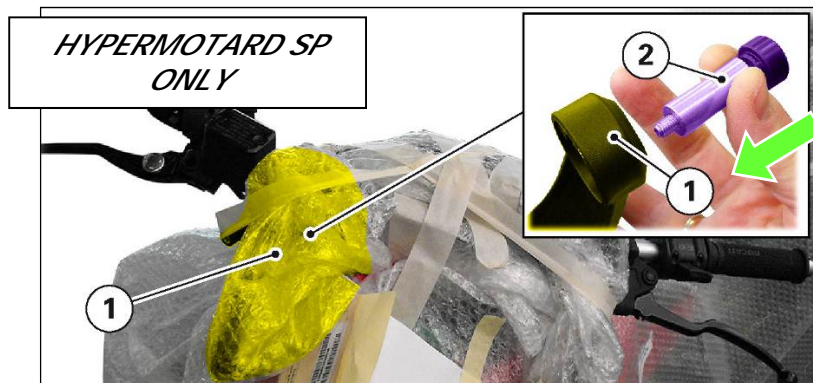

- 2) Position **hand guard (1)** on handlebar, engaging the **reference notch (A)** of hand guard on **slot (B)** on handlebar.

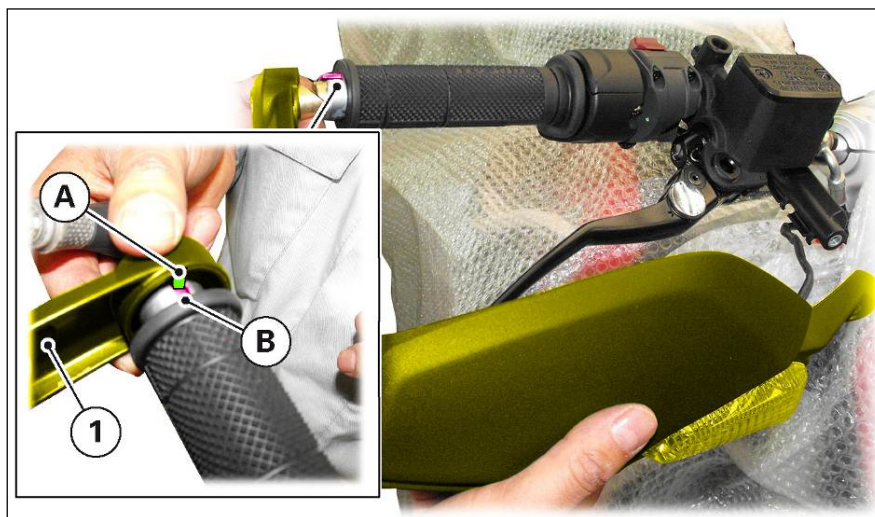



Pre-delivery & Scheduled Maintenance Checklists
Models: M.Y. 2013 Hypermotard (Standard and SP) and Hyperstrada
Service Bulletin SVC-13-011

- 3) Take the BLACK *screw (4)* with pre-applied threadlocker from the supplied kit. Start the *screw (4)* and tighten it to a torque of 5 Nm ± 10%.



- 4) Tighten the *counterweight screw (5)* as follows:
- hold the end of *hand guard (1)* turned down;
 - hold the *counterweight screw (5)* pressed toward the inside of the handlebar;
 - tighten the *counterweight screw (5)* to a torque of 10 Nm ± 10%.

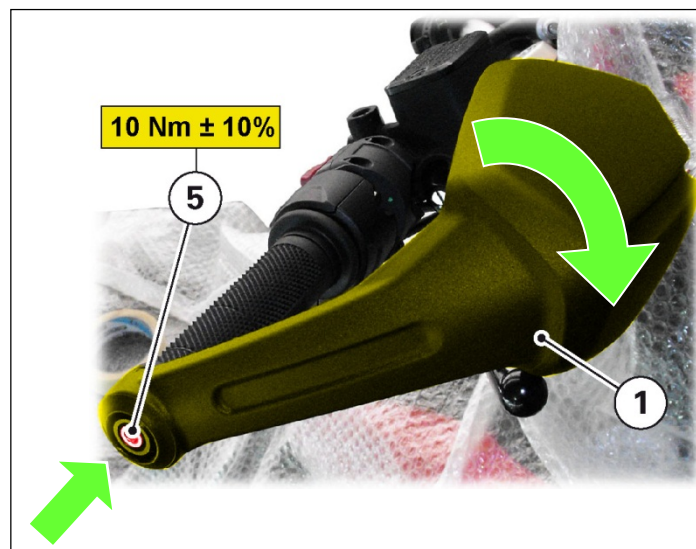



Pre-delivery & Scheduled Maintenance Checklists
Models: M.Y. 2013 Hypermotard (Standard and SP) and Hyperstrada
Service Bulletin SVC-13-011

- 5) Insert *wiring (3)* of *hand guard (1)*, in *cable guides (C)*.

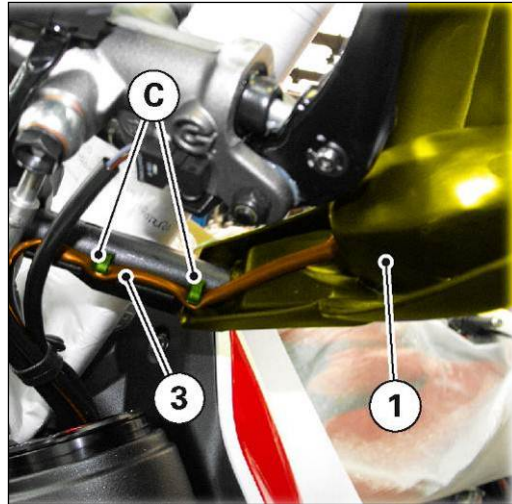

• **INSTALLING THE REAR-VIEW MIRRORS**

Fasten rear-view mirrors by tightening *nuts (1)* to a torque of **40 Nm ± 10%**.

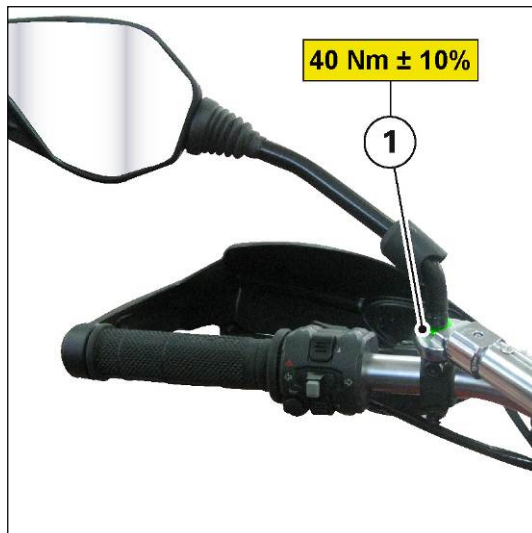



Pre-delivery & Scheduled Maintenance Checklists
Models: M.Y. 2013 Hypermotard (Standard and SP) and Hyperstrada
Service Bulletin SVC-13-011

INSTALLING THE PLEXIGLAS – HYPERSTRADA ONLY

Take the components from the supplied kit. Install the four **grommets (2)** onto the **windscreen (1)** holes by using water and soap.

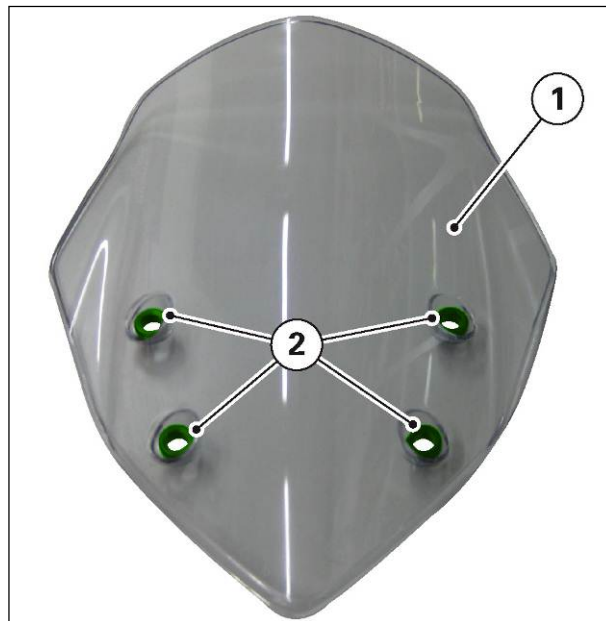

Fit windscreen to motorcycle support; start the four **screws (3)** and tighten to a torque of **3 Nm ± 10%**.

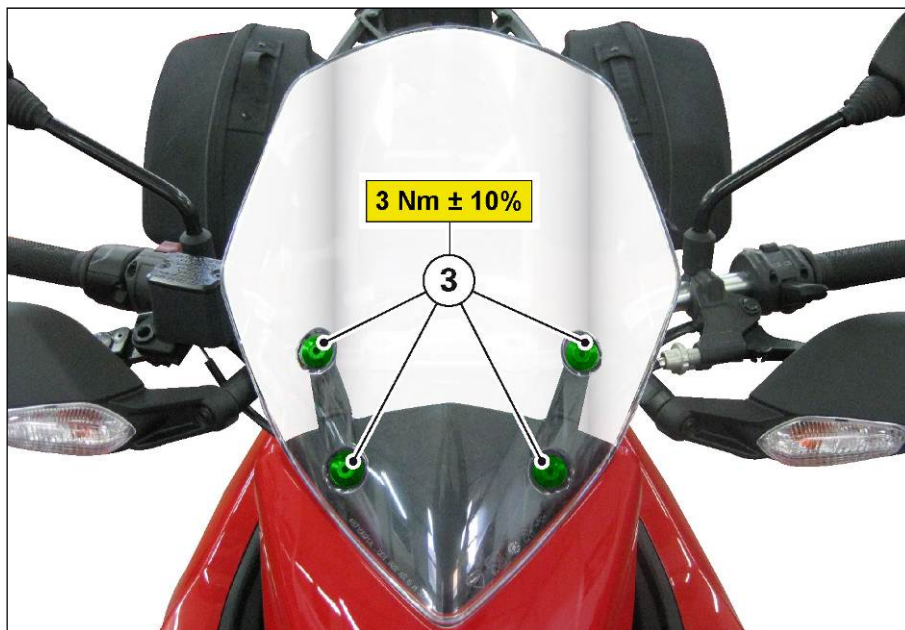



Pre-delivery & Scheduled Maintenance Checklists
Models: M.Y. 2013 Hypermotard (Standard and SP) and Hyperstrada
Service Bulletin SVC-13-011

CHARGING THE BATTERY AND FITTING IT ON THE VEHICLE



WARNING

Before performing any task on the battery, you must first carefully read the instructions on its fill, recharge and installation.

After the electrolyte service, the battery must be left to rest for at least 30 minutes. Always charge the battery before the first use and especially after long storage periods (such as before selling the vehicle). Leaving the battery discharged for more than one month could damage it.

Use only constant-voltage battery chargers. Check that the battery terminals are properly connected and that the battery charger is the correct one. To recharge the battery, follow the instructions indicated on the battery; for further details refer to the table.

Type of charging	Volt (V)	Ampere (A)	Time (Hours)
Normal	12	1.2	5 to 10

- 1) Remove the rider seat.
- 2) Release **metal ring (B)** and rubber band **(A)**.

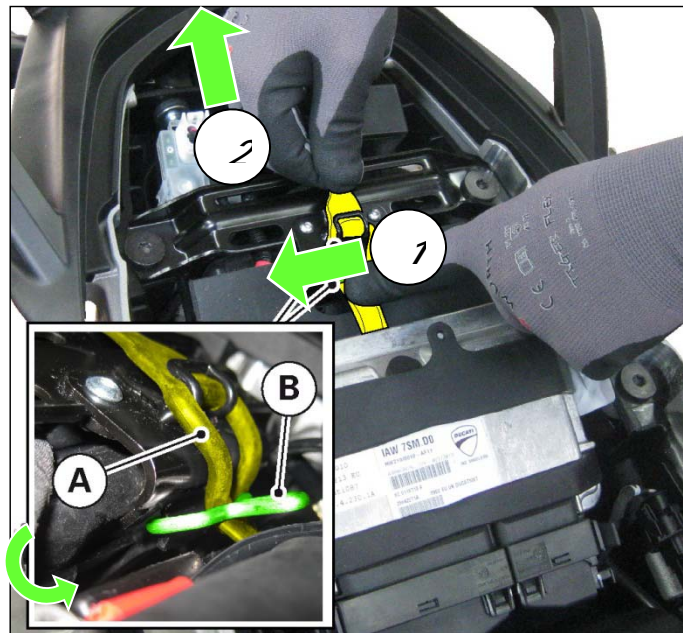



Pre-delivery & Scheduled Maintenance Checklists
Models: M.Y. 2013 Hypermotard (Standard and SP) and Hyperstrada
Service Bulletin SVC-13-011

- 3) Raise the battery mount assembly without disconnecting the electric components.
- 4) Fit battery in its mount; it is recommended to lubricate the battery side surfaces with some water and soap to help the rubber slide.

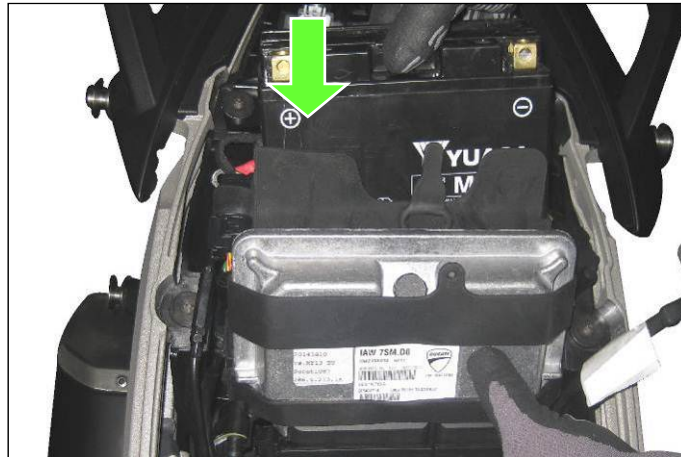

- 5) Restore assembly of battery mount in its seat.
- 6) Connect motorcycle terminals to battery.



WARNING

Carefully comply with orientation of cables **(1)**, **(2)** and **(3)** as shown in the figure.



Pre-delivery & Scheduled Maintenance Checklists
Models: M.Y. 2013 Hypermotard (Standard and SP) and Hyperstrada
Service Bulletin SVC-13-011

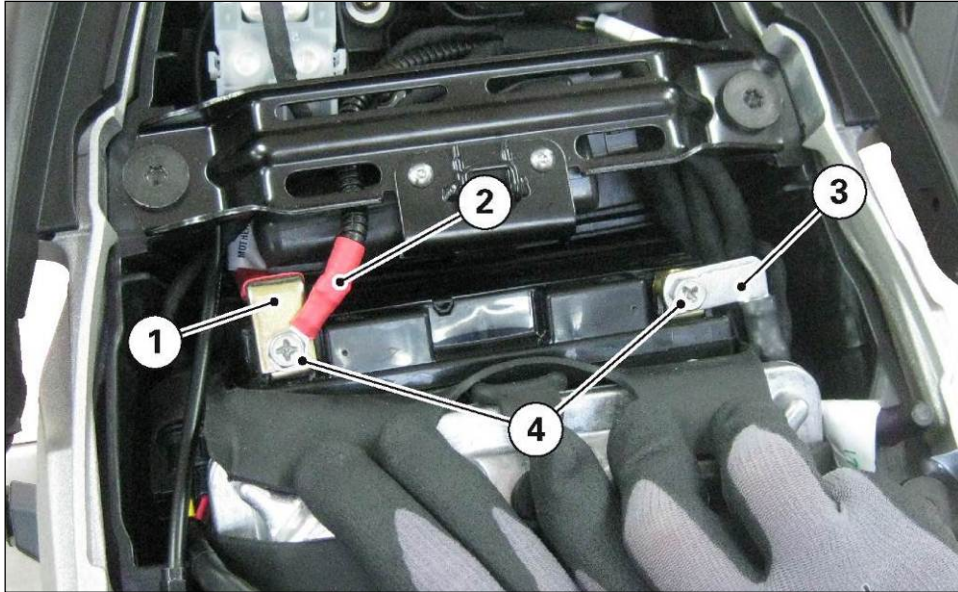

WARNING

Connect the vehicle red positive cable **(1)** and the positive cable of the ABS system **(2)** to the positive terminal of the battery and the black negative cable **(3)** to the battery's negative terminal.

- 7) Start the two **screws (4)** on the terminals, starting with the positive cables and tighten the screws.
- 8) Apply grease around the battery terminal clamps to prevent oxidation.
- 9) Hook in this sequence the end of rubber band **(A)**, and **metal ring (B)**.



Pre-delivery & Scheduled Maintenance Checklists
Models: M.Y. 2013 Hypermotard (Standard and SP) and Hyperstrada
Service Bulletin SVC-13-011

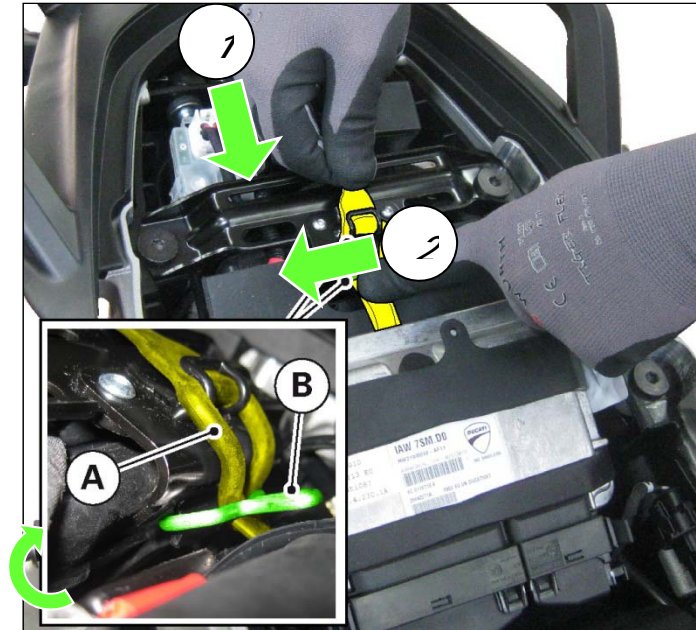

10) Refit the rider seat.

- **INSTALLING THE LOCKS TO SIDE PANNIERS** (Hyperstrada only);



NOTE

This document describes the procedure for installing the LH side pannier lock; follow the same procedure for installing the RH one.

- 1) Take the **lock tumblers (1)** from the unde-rseat compartment kit.
- 2) Take lock kit from inside the side panniers.
- 3) Make sure side pannier kit is complete, before installing it.



Pre-delivery & Scheduled Maintenance Checklists
 Models: M.Y. 2013 Hypermotard (Standard and SP) and Hyperstrada
 Service Bulletin SVC-13-011

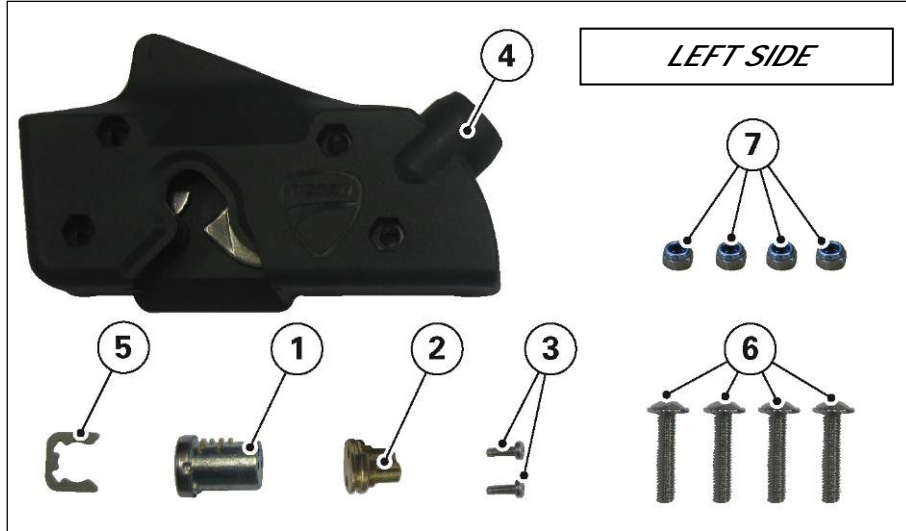

<i>Pos.</i>	<i>Description</i>	<i>Q.ty</i>
1	Lock revolving plug	1
2	Lock cam	1
3	Self-tapping screws retaining cam to lock revolving plug	2
4	Upper pannier support	1
5	Lock revolving plug assembly clip	1
6	Upper pannier support screws	4
7	Upper pannier support nuts	4

4) Fasten *cam (2)* to *lock revolving plug (1)* using the two *self-tapping screws (3)*.



WARNING

Holes on lock revolving plug are NOT threaded, use self-tapping screws (3). Fasten with care.

Tighten the *self-tapping screws (3)* to a torque of **0.6 Nm ± 10%**.



Pre-delivery & Scheduled Maintenance Checklists
Models: M.Y. 2013 Hypermotard (Standard and SP) and Hyperstrada
Service Bulletin SVC-13-011

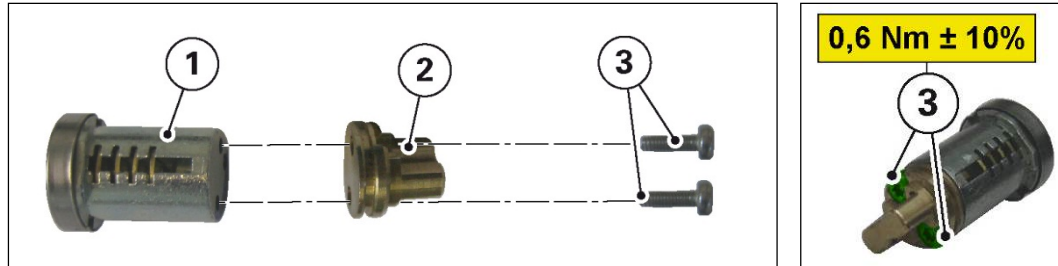

5) Pre-apply high-viscosity grease on revolving plug assembly.



6) Fit the lock tumbler in the hole on *upper pannier support (4)*;



WARNING

Ensure the correct positioning of tumbler as indicated in the figure below; its protruding part must be facing up.





Pre-delivery & Scheduled Maintenance Checklists
Models: M.Y. 2013 Hypermotard (Standard and SP) and Hyperstrada
Service Bulletin SVC-13-011

- 7) Insert **clip (5)** retaining the revolving plug assembly to **upper pannier support (4)**.

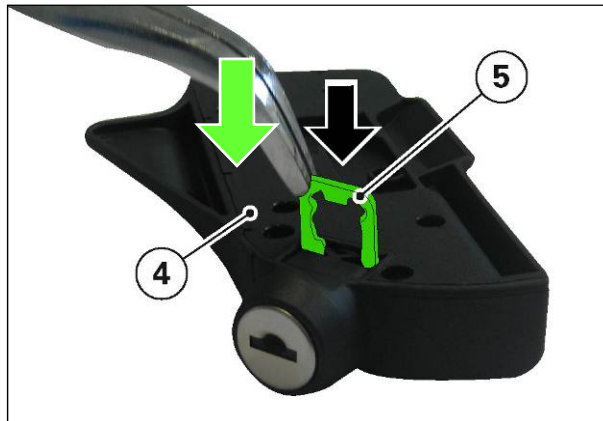

- 8) Open the **left-hand side pannier (8)**, and the internal zip on support-side shell.
- 9) Remove the four screws and the four service nuts from pannier, at the upper pannier support fixture.
- 10) Fit the four **retaining screws (6)** in the corresponding holes, from inside out.
- 11) Fit the upper pannier support (4) to the retaining screws (6) and start nuts (7). Tighten the **screws (6)** to a torque of **2.2 Nm ± 10%**.

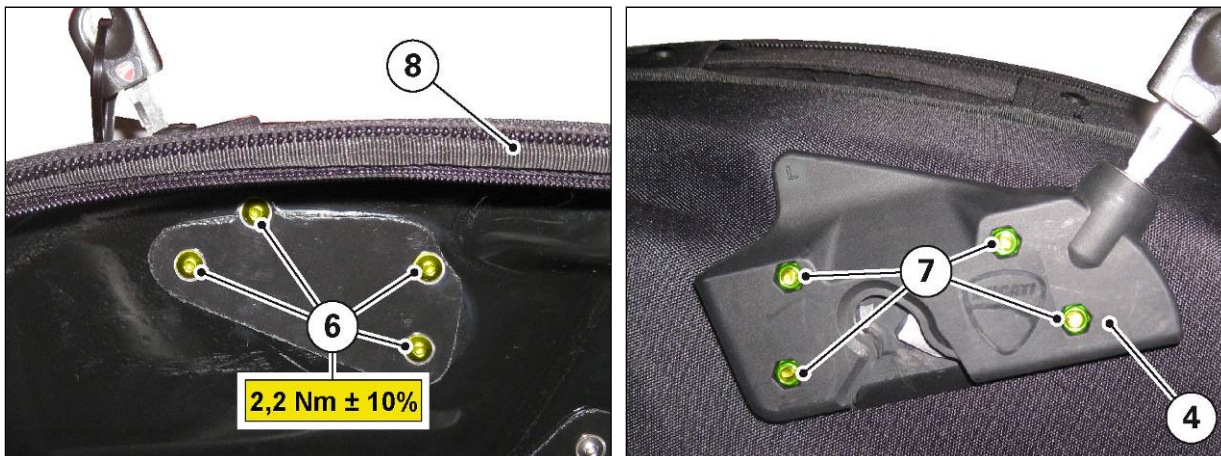

- 12) Close the internal zip on support-side shell.
- 13) Ensure the lock operates correctly.



Pre-delivery & Scheduled Maintenance Checklists
Models: M.Y. 2013 Hypermotard (Standard and SP) and Hyperstrada
Service Bulletin SVC-13-011

14) If it rains, protect side pannier content using the waterproof covers (1) found inside the panniers.

To avoid water ingress, cover edge must be folded THREE times, then close hook (2) on the opposite side (as indicated in the figure).

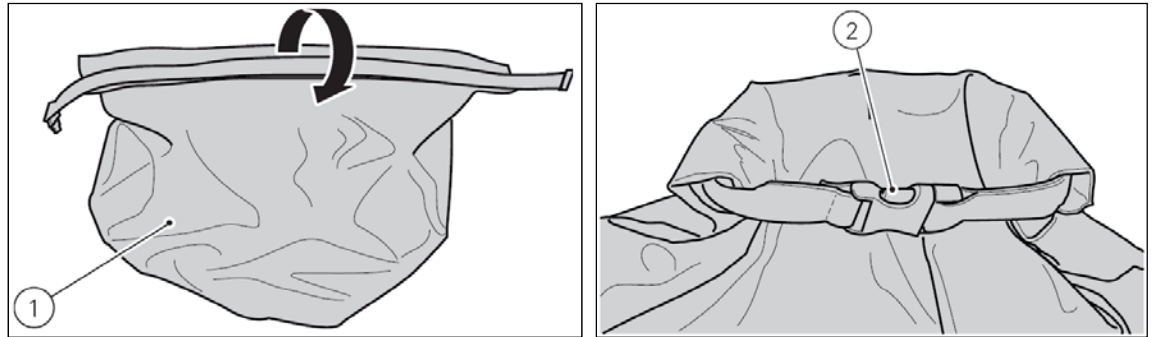

ALWAYS put cover (1) inside pannier with the folded side upward.

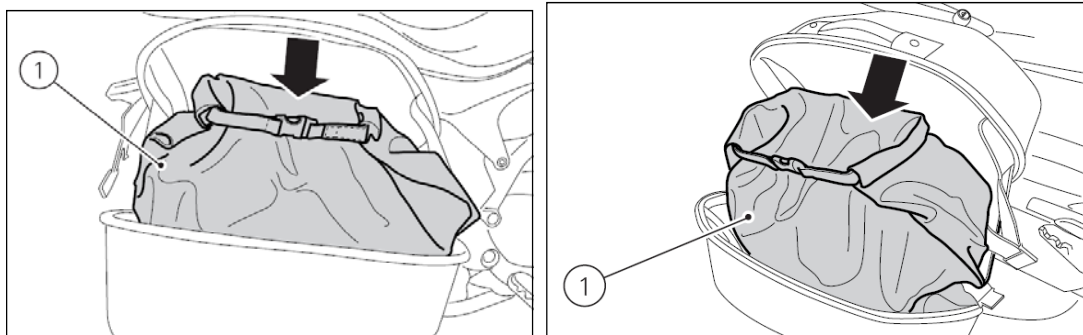

SCHEDULED MAINTENANCE CHART

Below you will find a description of the scheduled maintenance chart of the M.Y. 2013 Hypermotard and Hyperstrada; this chart is the one that will be announced to Customers through Ducati's communication channels; we therefore trust you will cooperate to ensure compliance with the deadlines and operations indicated for the various scheduled maintenance service coupons.

Annexed to this Service Bulletin you will find the NEW **Check List of Scheduled Maintenance tasks for motorcycles equipped with Testastretta 11° 821 cc engine**. This document complements the check lists for Scheduled Maintenance you already received attached to bulletin SVC-13-010 Transparent Maintenance and Scheduled Maintenance Checklist Forms.



Pre-delivery & Scheduled Maintenance Checklists
 Models: M.Y. 2013 Hypermotard (Standard and SP) and Hyperstrada
 Service Bulletin SVC-13-011

DUCATI
SERVICE
Scheduled Maintenance



Please print this form and fill out all of its parts during servicing to hand it over to the Customer (filing a copy of it with the repair order).

The types of service coupons for M.Y. 2013 Hypermotard and Hyperstrada and the relevant flat rate times are as follows:

<i>TYPE OF SCHEDULED MAINTENANCE</i>	<i>TIME (hours)</i>	<i>TIME (minutes)</i>
<i>OIL SERVICE 1000</i>	1.5 h	90 minutes
<i>ANNUAL SERVICE</i>	1.4 h	84 minutes
<i>OIL SERVICE</i>	1.9 h	114 minutes
<i>DESMO SERVICE</i>	6.0 h	360 minutes

The flat rate times of the maintenance tasks that are not part of specific service operations are listed below:

<i>TYPE OF SERVICE</i>	<i>TIME (hours)</i>	<i>TIME (minutes)</i>
Change brake fluid <i>(Every 36 months)</i>	0.4 h	36 minutes
Change front fork fluid <i>(Every 45,000 km/27,000 mi)</i>	0.8 h	48 minutes
Change coolant <i>(Every 45,000 km/27,000 mi or 48 months)</i>	0.6 h	36 minutes

Please be reminded that the instrument panel of Hypermotard and Hyperstrada MY2013 indicates when vehicle mileage is close to or reached the scheduled service threshold. Upon each key-On, the system indicates the type of service due and mileage to set threshold, if any.





Pre-delivery & Scheduled Maintenance Checklists
 Models: M.Y. 2013 Hypermotard (Standard and SP) and Hyperstrada
 Service Bulletin SVC-13-011

USEFUL TIPS FOR SCHEDULED MAINTENANCE

1) Spare part numbers divided by type of service:

<i>SERVICE TYPE</i>	<i>SPARE PART</i>	<i>PART NO.</i>	<i>Q.ty</i>
OIL SERVICE 1000 and ANNUAL SERVICE	Oil filter	444.4.003.5A	1
	Oil drain plug seal	852.5.042.1A	1
OIL SERVICE	Oil filter	444.4.003.5A	1
	Oil drain plug seal	852.5.042.1A	1
	Spark plug	670.4.045.1A	2
DESMO SERVICE	Oil filter	444.4.003.5A	1
	Oil drain plug seal	852.5.042.1A	1
	Valve closing shims	-	4
	Valve opening shims	-	4
	Spark plug	670.4.045.1A	2
	Timing belts	737.4.031.1A	2
	Air filter	426.1.019.1A	1

2) Tightening torques for checking tightening of the safety components:

- RH and LH front brake disc screws 30 Nm ± 5%
- rear brake disc screws 25 Nm ± 5%
- front brake caliper screws 45 Nm ± 5%
- rear brake caliper screws 25 Nm ± 5%
- front wheel nut 63 Nm ± 5%
- rear wheel nut 176 Nm ± 5%
- secondary drive front sprocket nut 186 Nm ± 5%
- secondary drive rear sprocket nut 156 Nm ± 5%

3) Chain tension values:

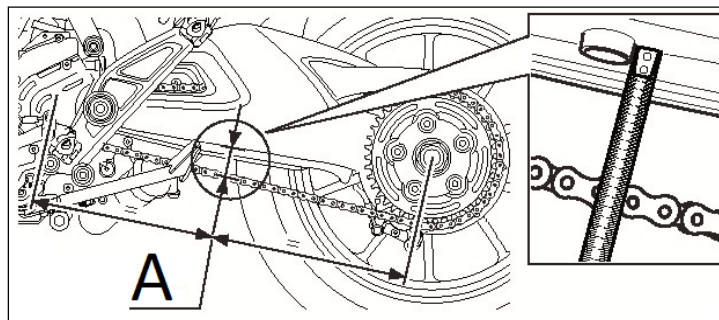



Pre-delivery & Scheduled Maintenance Checklists
Models: M.Y. 2013 Hypermotard (Standard and SP) and Hyperstrada
Service Bulletin SVC-13-011

<i>Reference model version</i>	<i>Tension value – A (mm)</i>
Hypermotard	72 to 74
Hypermotard SP	72 to 74
Hyperstrada (STANDARD Suspension)	59 to 61
Hyperstrada (STANDARD Suspension)	57 to 59

- 4) Valve clearance assembly values and inspection values (all valves shall be adjusted in time, and cost includes purchase of 4 closing shims and 4 opening shims, since we estimated that the shims changed could be reused by the dealer):

		<i>Assembly value</i>	<i>Inspection value</i>
Opening rocker arm	Intake	0.13 to 0.18 mm	0.10 to 0.25 mm
	Exhaust	0.13 to 0.18 mm	0.10 to 0.25 mm
Closing rocker arm	Intake	0.05 to 0.10 mm	0.05 to 0.15 mm
	Exhaust	0.05 to 0.10 mm	0.05 to 0.15 mm

- 5) Tire pressure:

	<i>FRONT</i>	<i>REAR</i>
Hypermotard – Hyperstrada (<i> rider only</i>)	2.5 bar	2.5 bar
Hypermotard – Hyperstrada (<i> full load</i>)	2.5 bar	2.9 bar
Hypermotard SP (<i> rider only</i>)	2.3 bar	2.1 bar
Hypermotard SP (<i> full load</i>)	2.5 bar	2.9 bar



Pre-delivery & Scheduled Maintenance Checklists
Models: M.Y. 2013 Hypermotard (Standard and SP) and Hyperstrada
Service Bulletin SVC-13-011

CONTENT OF THE VARIOUS SERVICE TYPES

OIL SERVICE

The **OIL SERVICE 1000** must be performed within the first 1000 kilometres/600 miles and, at any rate, within six (6) months from when the motorcycle was delivered to the Customer. The service includes the following tasks:

- Vehicle preparation for OIL SERVICE 1000 (removal of seat and sump guard for Hyperstrada only).
- Reading of the error memory with DDS and check of software version update on control units.
- Check the presence of any technical updates and recall campaigns.
- Change engine oil and filter.
- Clean the engine oil intake filter.
- Check brake fluid level.
- Check pad wear and brake discs. Change, if necessary.
- Check tightening of the safety components (brake disc flange screws, brake calliper screws, front/rear wheel nut, sprocket and final drive sprocket nuts).
- Check the drive chain tension and lubrication.
- Visually check front fork and rear shock absorber seals.
- Check the freedom of movement and tightening of side and central stand (if installed).
- Check rubbing points, clearance, freedom of movement and positioning of hoses and electric wiring in view.
- Check coolant level.
- Check electric fan operation.
- Check tyre pressure and wear.
- Check the battery charge level.
- Check idling.
- Check the operation of the safety electrical devices (side stand sensor, front and rear brake switches, engine stop switch, gear/neutral sensor).
- Check the indicators and lighting.
- Reset the Service indication through the DDS.
- Road test of the motorcycle, testing the safety devices (ex. ABS and DTC).
- Softly clean the motorcycle.
- Fill out that the service was performed in the Service Manual.
- Fill in the Scheduled Maintenance Check List.



Pre-delivery & Scheduled Maintenance Checklists
Models: M.Y. 2013 Hypermotard (Standard and SP) and Hyperstrada
Service Bulletin SVC-13-011



The **OIL SERVICE** must be performed when the motorcycle reaches a mileage of 15000 kilometres / 9000 miles, 45000 km/27000 mi and then every 30000 km. **ANNUAL SERVICE** perform every 12 months.
The services include the following tasks:

- Vehicle preparation for OIL SERVICE (removal of tank cover, seat and fuel tank, and sump guard for Hyperstrada only).
- Vehicle preparation for ANNUAL SERVICE (removal of seat and sump guard for Hyperstrada only).
- **Reading of the error memory with DDS and check of Software version update on control units**
- Check the presence of any technical updates and recall campaigns.
- Change engine oil and filter.
- Change the timing belts (**every 30,000 km/18,000 mi; or 60 months**).
- Change the spark plugs (**only every 15,000 km/9,000 mi**).
- Check brake fluid level.
- Change brake fluid (**only every 36 months**).
- Check pad wear and brake discs. Change if necessary.
- Check tightening of the safety components (brake disc flange screws, brake calliper screws, front/rear wheel nut, sprocket and final drive sprocket nuts).
- Check the drive chain tension and lubrication.
- Check final drive wear (chain, front/rear sprocket) and chain sliders.
- Visually check front fork and rear shock absorber seals.
- Change the front fork fluid (**only every 45,000 km/27,000 mi**).
- Check the freedom of movement and tightening of the side and central stand (if installed).
- Check rubbing points, clearance, freedom of movement and positioning of hoses and electric wiring in view
- Check coolant level.
- Change coolant (**every 45,000 km/27,000 mi; or 48 months**).
- Check electric fan operation.
- Check tyre pressure and wear.
- Check the battery charge level.
- Check idling.
- Check the operation of the safety electrical devices (side stand sensor, front and rear brake switches, engine stop switch, gear/neutral sensor).
- Check the indicators and lighting.
- Reset the Service indication through the DDS.
- Road test of the motorcycle, testing the safety devices (ex. ABS and DTC).
- Softly clean the motorcycle.
- Fill out that the service was performed in the Service Manual.
- Fill in the Scheduled Maintenance Check List.



Pre-delivery & Scheduled Maintenance Checklists
Models: M.Y. 2013 Hypermotard (Standard and SP) and Hyperstrada
Service Bulletin SVC-13-011



The **DESMO SERVICE** must be performed every 30000 km/18000 mi.

The service includes the following tasks:

- Vehicle preparation for DESMO SERVICE (removal of tank cover, seat and fuel tank, and sump guard for Hyperstrada only).
- Reading of the error memory with DDS and check of Software version update on control units.
- Check the presence of any technical updates and recall campaigns.
- Change engine oil and filter.
- Check and/or adjust valve clearance.
- Change the timing belts (**every 30,000 km/18,000 mi; or 60 months**).
- Change the spark plugs (**only every 15,000 km**).
- Changing air filter.
- Check brake fluid level.
- Change brake fluid (**only every 36 months**).
- Check pad wear and brake discs. Change if necessary.
- Check tightening of the safety components (brake disc flange screws, brake calliper screws, front/rear wheel nut, sprocket and final drive sprocket nuts).
- Check and lubricate rear wheel shaft.
- Check the drive chain tension and lubrication.
- Check final drive wear (chain, front/rear sprocket) and chain sliders.
- Visually check front fork and rear shock absorber seals.
- Change the front fork fluid (**only every 45,000 km/27,000 mi**).
- Check the freedom of movement and tightening of side and central stand (if installed).
- Check rubbing points, clearance, freedom of movement and positioning of hoses and electric wiring in view
- Check coolant level.
- Change coolant (**every 45,000 km/27,000 mi; or 48 months**).
- Check electric fan operation.
- Check tyre pressure and wear.
- Check battery charge level.
- Check idling.
- Check the operation of the safety electrical devices (side stand sensor, front and rear brake switches, engine stop switch, gear/neutral sensor).
- Check the indicators and lighting.
- Reset the Service indication through the DDS.
- Road test of the motorcycle, testing the safety devices (ex. ABS and DTC).
- Softly clean the motorcycle.
- Fill out that the service was performed in the Service Manual.
- Fill in the Scheduled Maintenance Check List.



Pre-delivery & Scheduled Maintenance Checklists
Models: M.Y. 2013 Hypermotard (Standard and SP) and Hyperstrada
Service Bulletin SVC-13-011

Please forward any comments you may have regarding the data contained in the Pre-delivery and Scheduled Maintenance Check list forms to your Area Manager.

We feel confident that these new tools will help improve transparency towards our Customers, and consequently their loyalty toward both Ducati and your Dealership's Service.

We thank you in advance for your attention and cooperation.

Ducati North America
Service Department