

© 2013 Mazda Motor of America, Inc.

Subject: INFORMATION DISPLAY SHOWS "FOW INSPECTION REQUIRED" AND DTC C1A67:78 IS STORED	Bulletin No: 01-029/13
	Last Issued: 11/27/2013

APPLICABLE MODEL(S)/VINS

2014 Mazda6 vehicles with VINs lower than JM1 GJ ***** 149082 (produced before October 01, 2013)

DESCRIPTION

Some customers may experience a MRCC malfunction when driving long distances with MRCC set. Instrument cluster information display shows "FOW INSPECTION REQUIRED" and DTC C1A67:78 (Radar sensor axis is deviated) is stored. This is caused by MRCC no obstacle detection during a long drive.

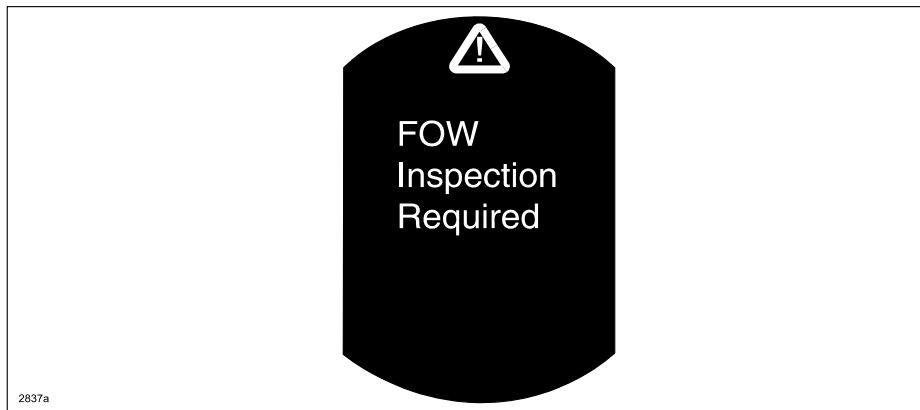

Customers having this concern should have their vehicle repaired using the following repair procedure.

REPAIR PROCEDURE

1. Verify customer concern.
2. Replace the vehicle control module (A) and radar sensor (B). Refer to MS3 online or Workshop Manual section 01-20:
 - VEHICLE CONTROL MODULE (V/C-MODULE) REMOVAL/INSTALLATION [MAZDA RADAR CRUISE CONTROL (MRCC) SYSTEM]

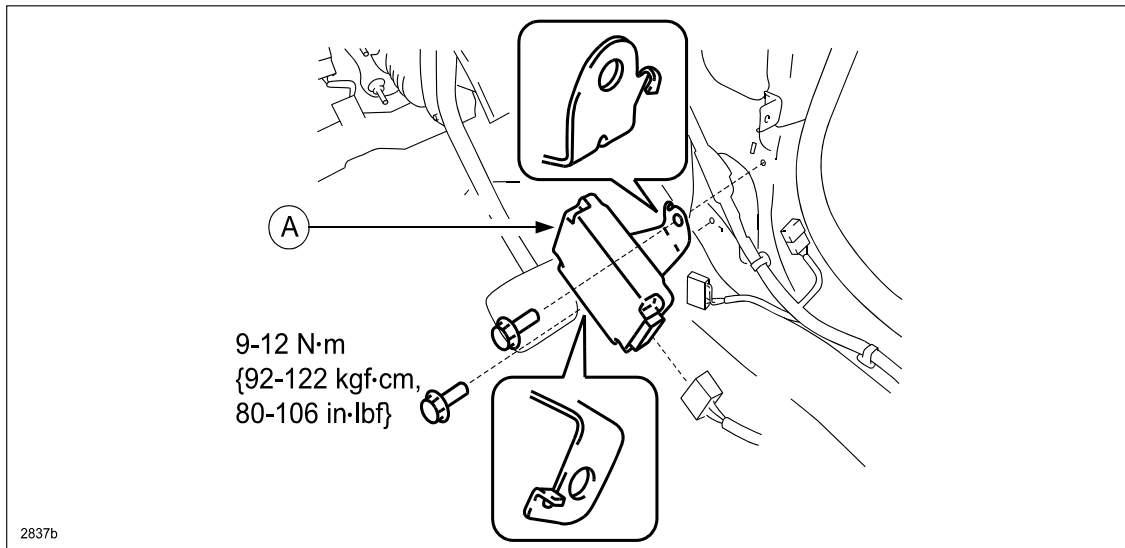

- RADAR SENSOR REMOVAL/INSTALLATION [MAZDA RADAR CRUISE CONTROL (MRCC) SYSTEM]

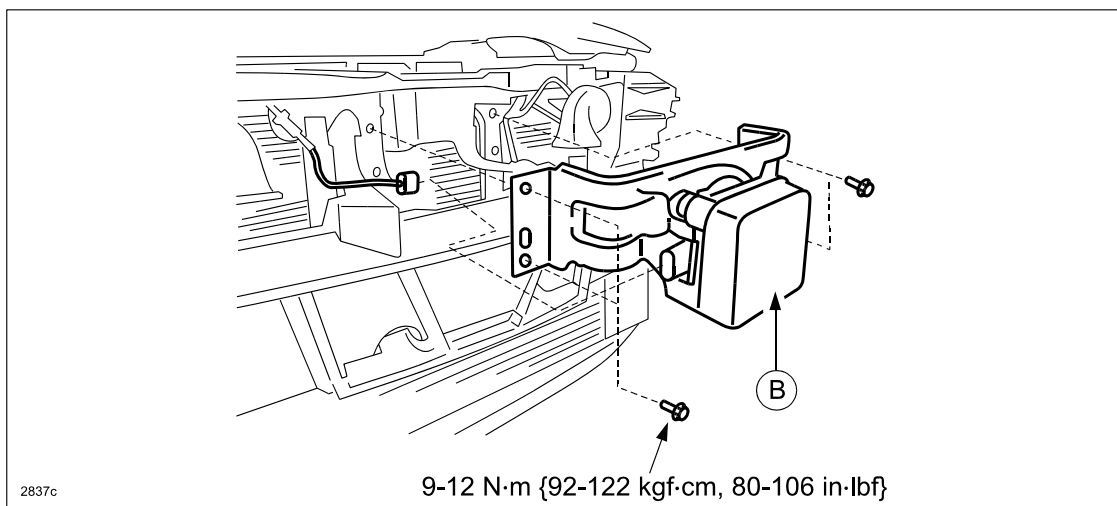

3. Perform the radar sensor aiming adjustment. Refer to MS3 online or Workshop Manual (section 01-20 RADAR SENSOR AIMING [MAZDA RADAR CRUISE CONTROL (MRCC) SYSTEM]).
4. Verify repair.

PART(S) INFORMATION

Part Number	Description	Qty.
GHP9-67-Y1XJ	Vehicle Control Module	1
GHP9-67-XA1D	Radar Sensor	1

WARRANTY INFORMATION

NOTE:

- This warranty information applies only to verified customer complaints on vehicles eligible for warranty repair.
- This repair will be covered under Mazda's New Vehicle Limited Warranty term.
- Additional diagnostic time cannot be claimed for this repair.

Warranty Type	A
Symptom Code	62
Damage Code	9W
DTC Code	C1A67
Part Number Main Cause	GHP9-67-Y1XJ
Quantity	1
Operation Number / Labor Hours:	XXJCGXRX / 0.8 Hrs.