



INSTRUCTION TO SERVICE

ITS: 5324	
SECTION:	203 Front Suspension System
WRITTEN BY:	Iman Fatemi
SUBJECT:	Shock Absorber Adjustment

ITS5324

THIS DOCUMENT AND THE CONTENTS DISCUSSED HEREIN ARE THE CONFIDENTIAL AND PROPRIETARY INFORMATION OF NEW FLYER INDUSTRIES CANADA ULC AND NEW FLYER OF AMERICA INC. AND ARE DISCLOSED BY NEW FLYER IN CONFIDENCE. THIS DOCUMENT AND THE CONTENTS HEREIN ARE NOT TO BE DISCLOSED BY THE INTENDED RECIPIENT WITHOUT THE PRIOR WRITTEN AUTHORIZATION OF NEW FLYER. ANY UNAUTHOIZED DISCLOSURE, REPRODUCTION OR OTHER DISTRIBUTION OF THIS DOCUMENT OR INFORMATION IS STRICTLY PROHIBITED AND MAY RESULT IN ACTION BEING TAKEN AGAINST THE PARTY MAKING THE UNAUTHORIZED DISCLOSURE. THIS DOCUMENT AND ALL COPIES HEREOF MUST BE RETURNED TO NEW FLYER UPON REQUEST.

PROCEDURE:

1. Turn the main battery disconnect switch to the “OFF” position.
2. Raise coach using wheel lifts in accordance with the New Flyer Service Manual.
3. Locate the front shock absorbers as shown in Figure 1.

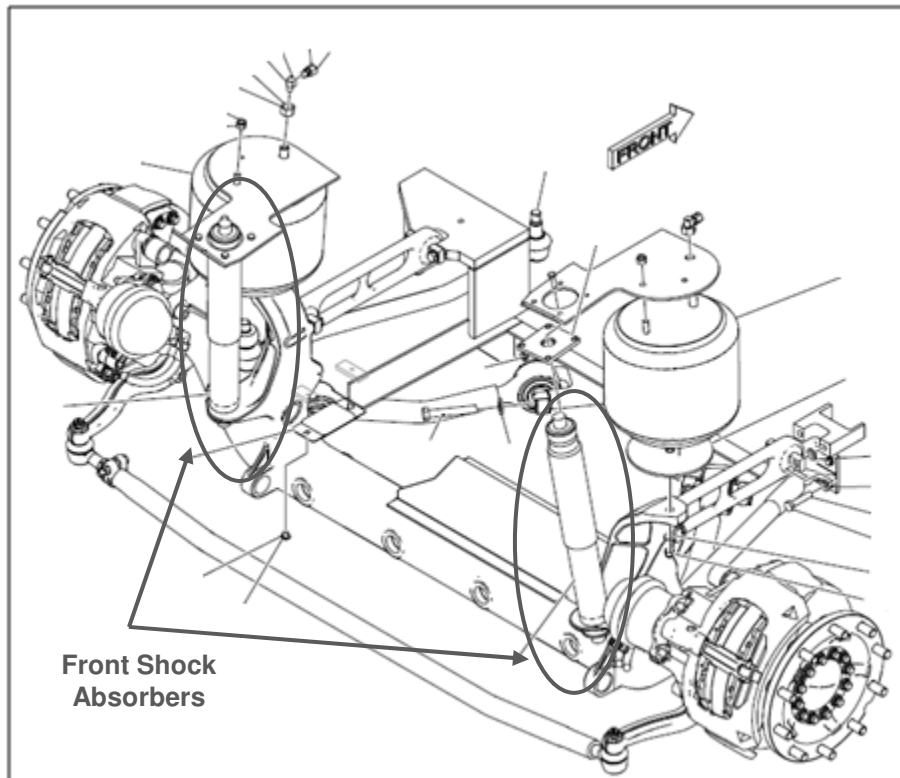

Figure 1: Front shock absorbers

4. Remove the front shock absorbers in accordance with the New Flyer Service Manual.
5. Clamp the lower end of the shock absorber in a vise, being careful not to damage the threaded end of the stud. Use clamp plates to prevent damage.
6. Fully collapse the shock absorber while slowly rotating the dust cap counterclockwise, until the cams on the internal adjusting nut should engage the recesses of the footvalve and a slightly increased resistance to rotation should be felt, see Figure 2.
7. Keeping the shock absorber collapsed, apply a mark along the dust cap and piston rod, see Figure 3. This mark helps counting turns in the next step.
8. Maintain slight pressure on the shock absorber in the fully collapsed position while rotating it counterclockwise and recording the number of turns until the internal stop is reached, see Figure 4.
9. Keeping the shock absorber collapsed, return the shock absorber to its original setting and add an additional full turn to provide increased damping.

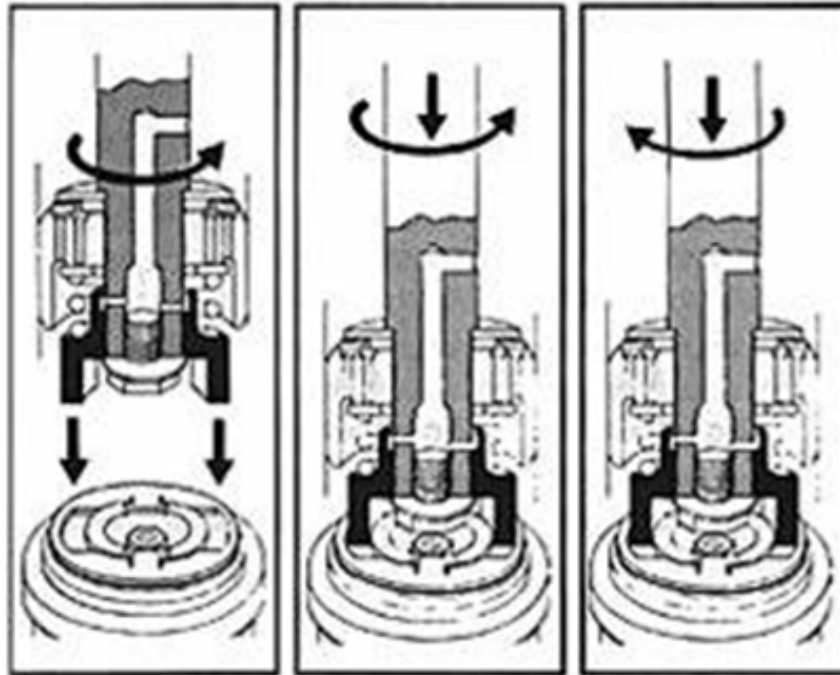

Figure 2: Engagement of the Cams on the Internal Adjusting Nut and the Recesses of the Foot Valve

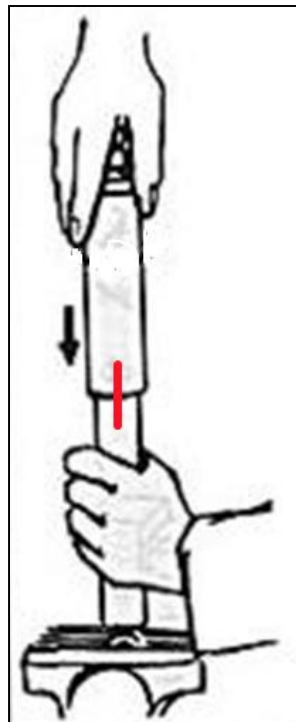

Figure 3: Drawing a Mark Line along the Dust Cap and Piston Rod

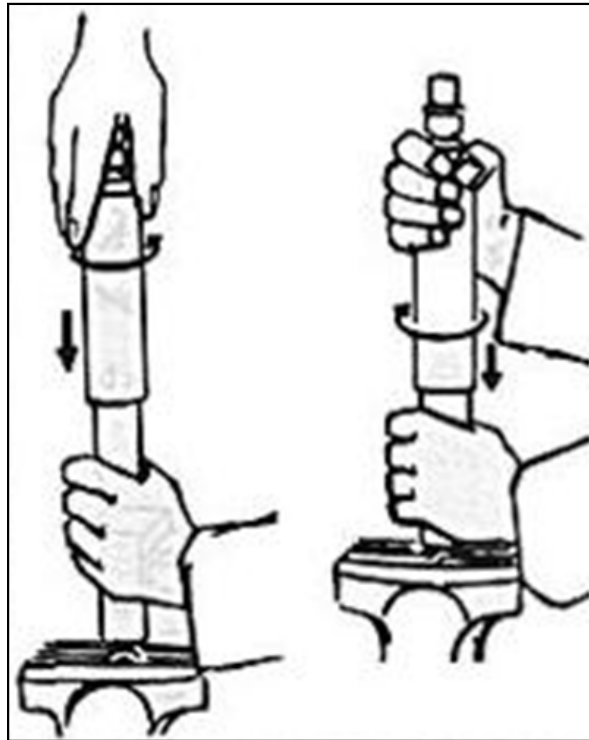

Figure 4: Adjustment of Shock Absorber

10. Pull the piston rod straight out approximately 1/2", without rotating the shaft, until the internal adjusting nut disengages the footvalve.
11. Install the front shock absorbers in accordance with the New Flyer Service Manual.
12. Locate the rear shock absorbers as shown in Figure 5.
13. Repeat steps 4 – 8 for the rear shock absorbers.
14. Keeping the shock absorber collapsed, return the shock absorber to its original setting and add additional 1.5 turns to provide increased damping.
15. Repeat steps 10 – 11 for the rear shock absorbers.
16. Lower coach in accordance with the New Flyer Service Manual.
17. Turn the main battery disconnect switch to the "ON" position.
18. Drive the vehicle at moderate speeds for at least 15 minutes to bring shock absorbers up to normal operating temperature. Perform a road test to confirm smooth and controlled suspension movement.

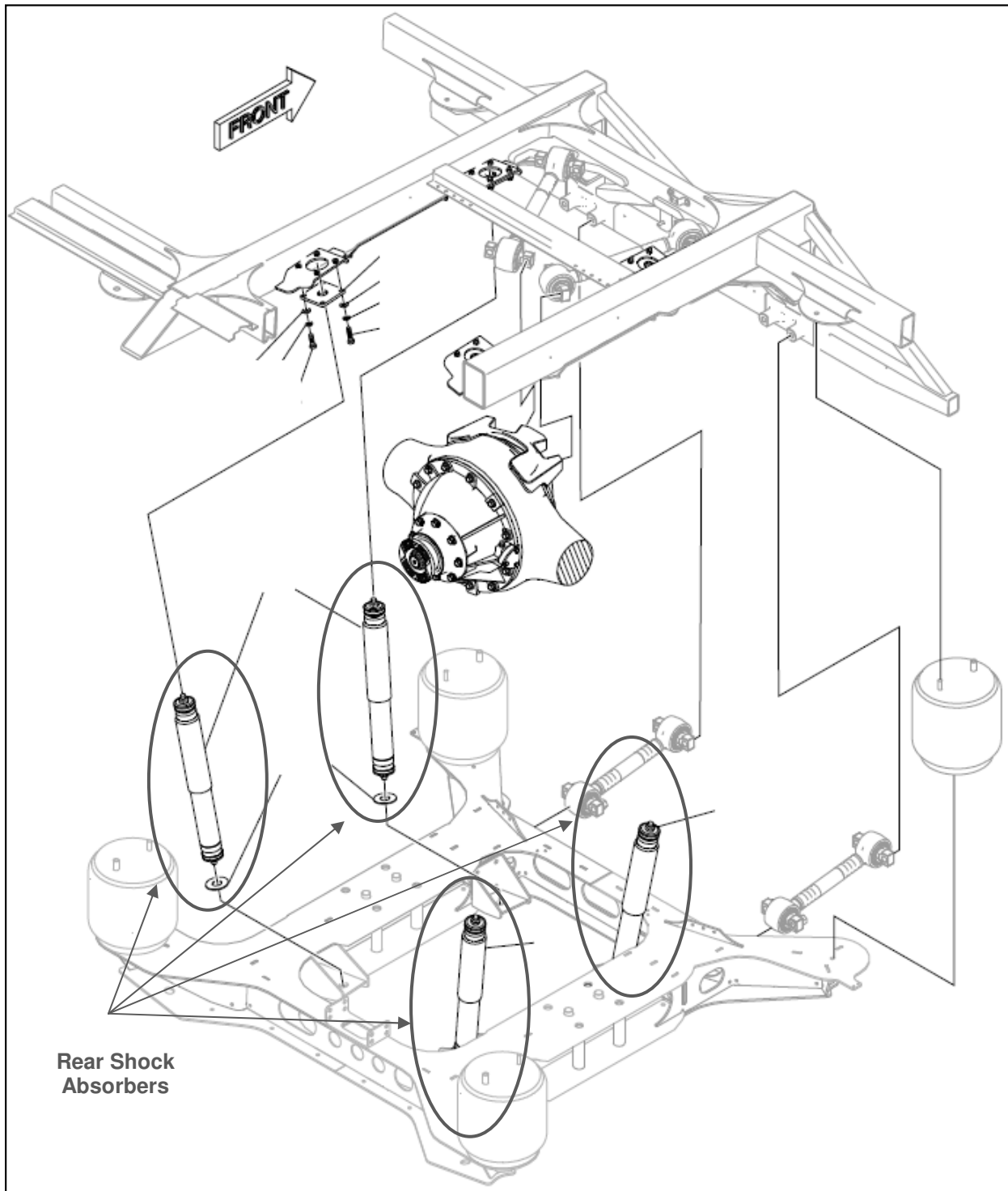

Figure 5: Rear shock absorbers



LABOUR ESTIMATE				
	Operation	Men	Hours	Labour Time M X HR
1	Shock Absorber Adjustment	1	2.5	2.5

PARTS REQUIRED					
Item	Part Number	Description	Qty. per Coach	Units	Notes
1	6323609	SHOCK ABSORBER HARDWARE KIT	6	EA	
2	5928660	NEVER-SEEZ	0.01	EA	

SPECIAL TOOLS REQUIRED					
Item	Part Number	Description	Qty. per Coach	Units	Notes
		NO SPECIAL TOOLS REQUIRED			