

Service Bulletin

Mazda North American Operations
Irvine, CA 92618-2922



© 2012 Mazda Motor of America, Inc.

Subject: DRIVER SEAT RATTLE NOISE WHEN STOPPING OR STARTING THE VEHICLE	Bulletin No: 09-043/12
	Last Issued: 11/16/2012

APPLICABLE MODEL(S)/VINS

2011-2013 Mazda2 (with manual seat lifter)

2004-2009 Mazda3 (with manual seat lifter)

DESCRIPTION

Some customer's may complain about a rattle noise in the driver's seat (A) when stopping or starting the vehicle. This rattle noise is caused by a gap between the seat frame and the link bracket. To correct the problem, a bracket and seat spring are attached to the inner and outer seat frames.

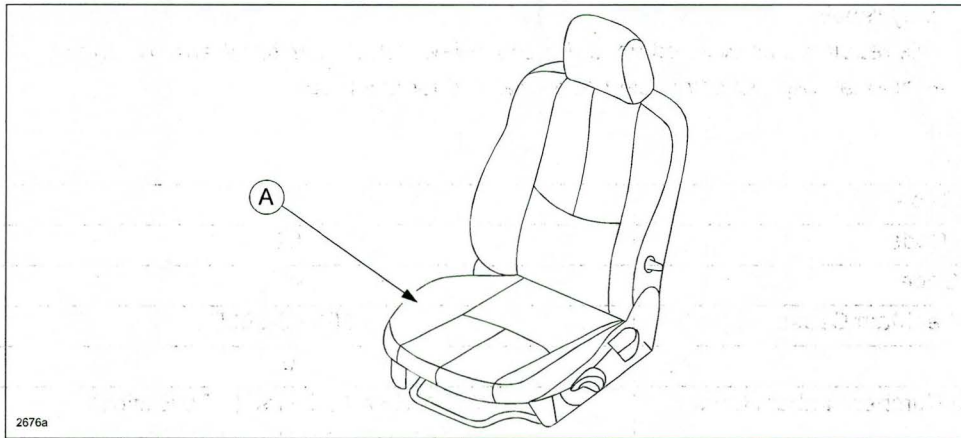

Customers having this concern should have their vehicle repaired using the following repair procedure.

CONSUMER NOTICE: The information and instructions in this bulletin are intended for use by skilled technicians. Mazda technicians utilize the proper tools/equipment and take training to correctly and safely maintain Mazda vehicles. These instructions should not be performed by "do-it-yourselfers." Customers should not assume this bulletin applies to their vehicle or that their vehicle will develop the described concern. To determine if the information applies, customers should contact their nearest authorized Mazda dealership. Mazda North American Operations reserves the right to alter the specifications and contents of this bulletin without obligation or advance notice. All rights reserved. No part of this bulletin may be reproduced in any form or by any means, electronic or mechanical---including photocopying and recording and the use of any kind of information storage and retrieval system ---without permission in writing.

REPAIR PROCEDURE

1. Verify customer concern.
2. Remove the driver's seat. Refer to MS3 online instructions or Workshop Manual section 09-13 FRONT SEAT REMOVAL/INSTALLATION.
3. Remove the connector(s) (A) from the original bracket (B).
Mazda2:

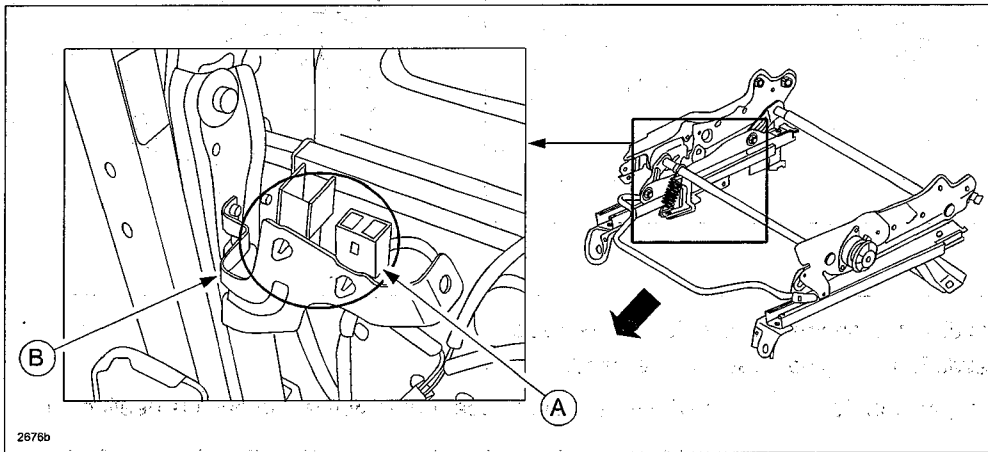

Mazda3:

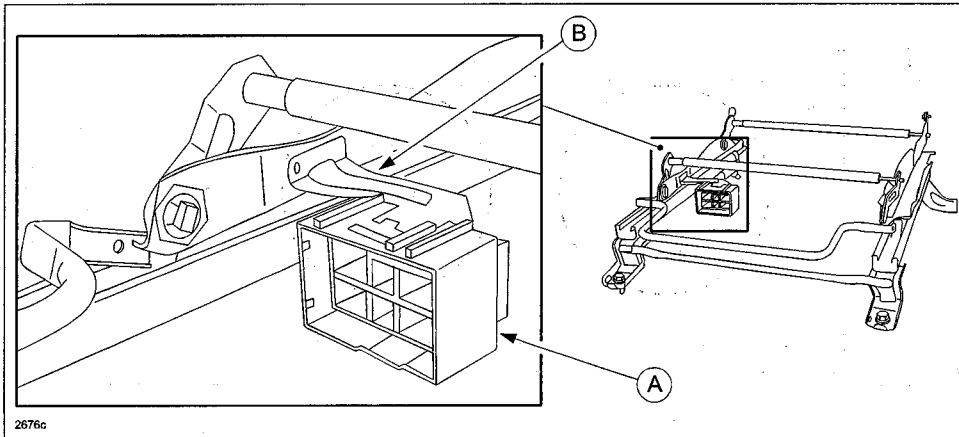

4. Remove the current original bracket from the seat frame.

NOTE: Remove the rivot by drilling the head of the rivot (A) off.

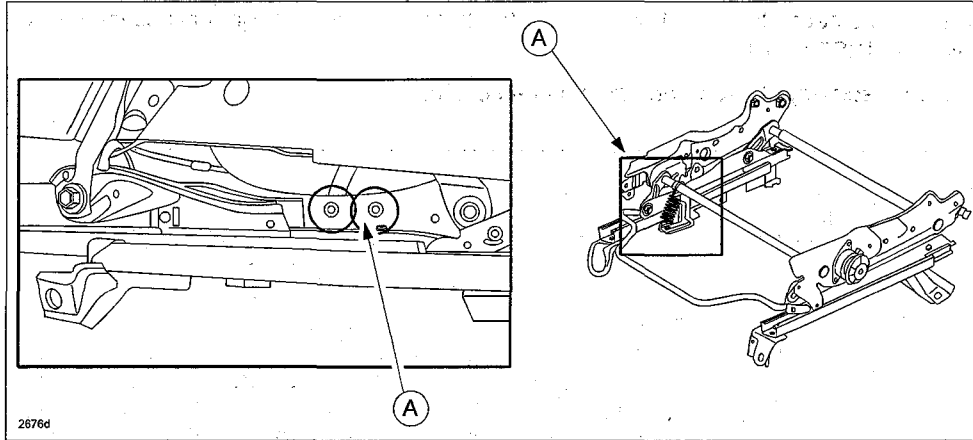

- For Mazda2, the original bracket is NOT re-used.
- For Mazda3, the original bracket is re-used.

NOTE: Apply paint to the scratched area (A) of the seat frame where the paint is peeling off.

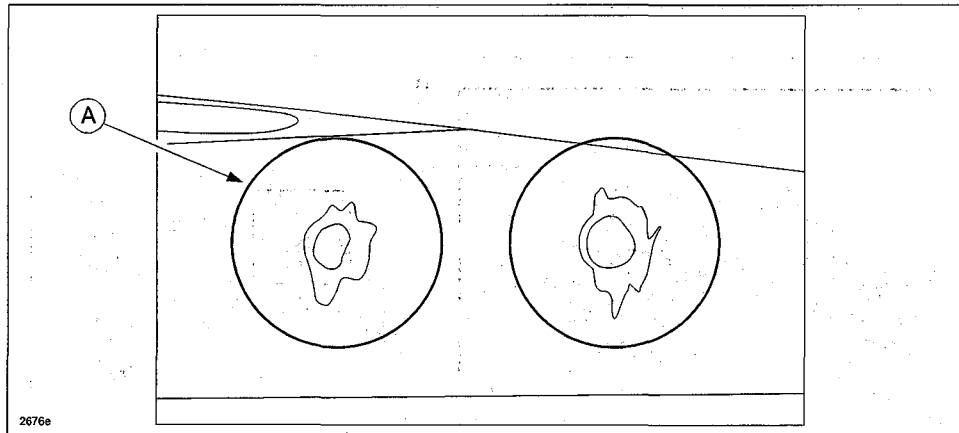

5. Mazda2: Attached the spring bracket (A) to the seat frame (B) with the two screws (C) and nuts (D).

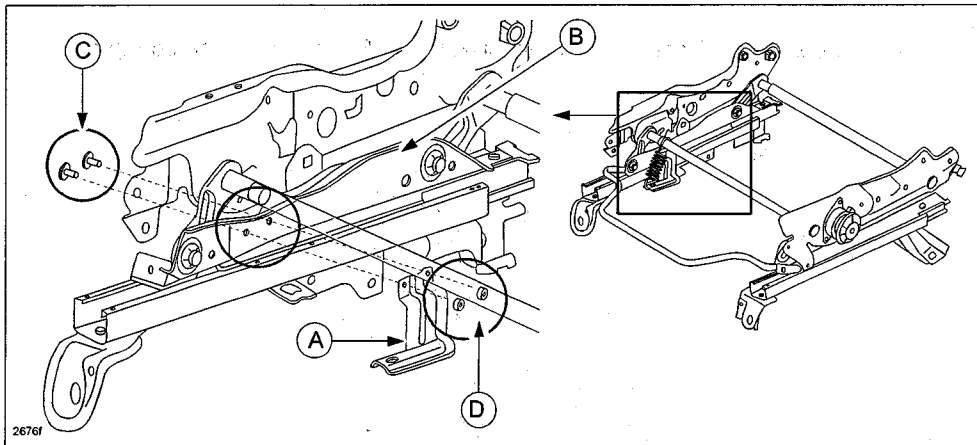

- Mazda3: Attach the spring bracket (A) and the original bracket (B) together to the seat frame (C) with the two screws (D) and nuts (E) as shown.

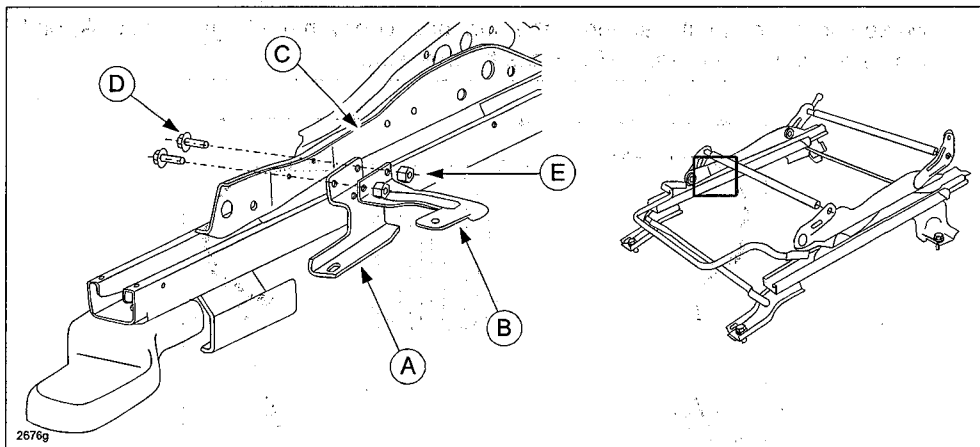

6. Move the lifter down to the lowest position.

7. Install a spring between the spring bracket and the seat stabilizer.

NOTE:

- Hook the spring (A) onto the seat stabilizer first (B), then onto the spring bracket (C).

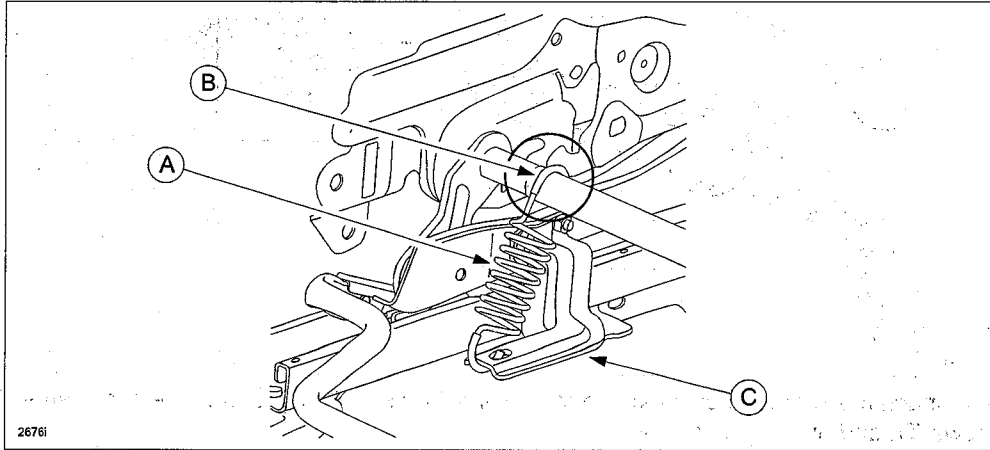

- Make sure to mount the spring in the right direction with the larger radius (A) on the stabilizer side and the smaller radius (B) on the bracket side.

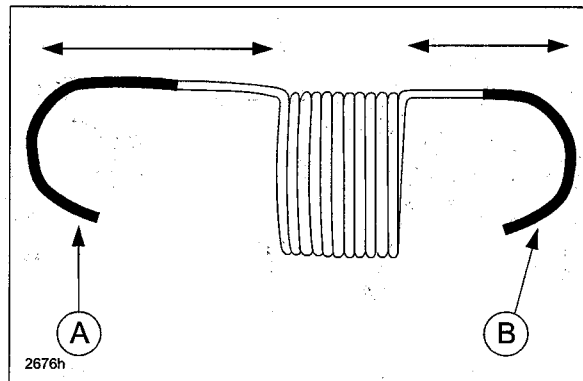

Mazda2:

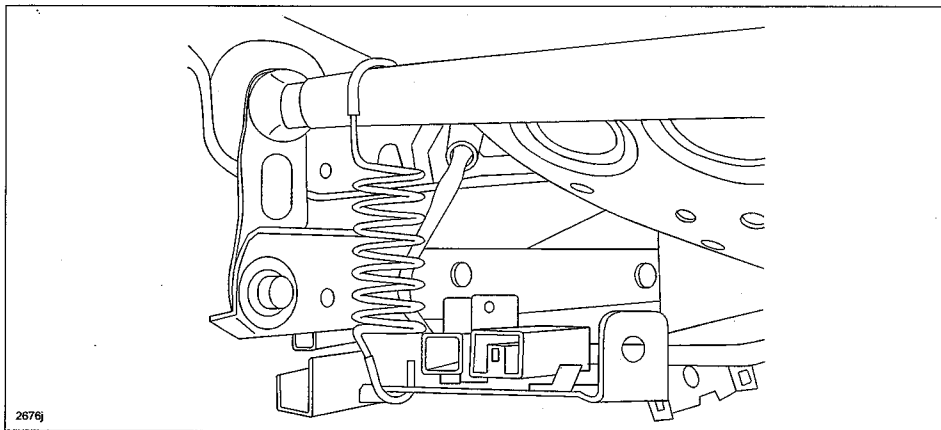

Mazda3:

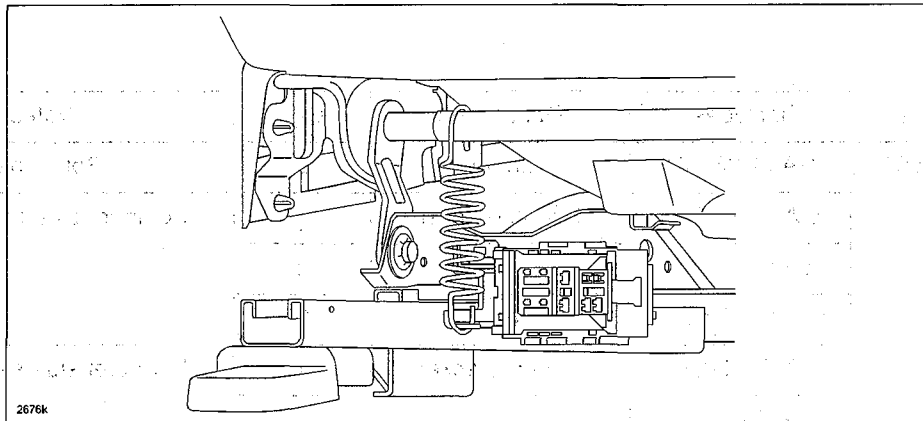

8. Install the new spring bracket and spring to the outer side seat frame the same way as the inner side frame.

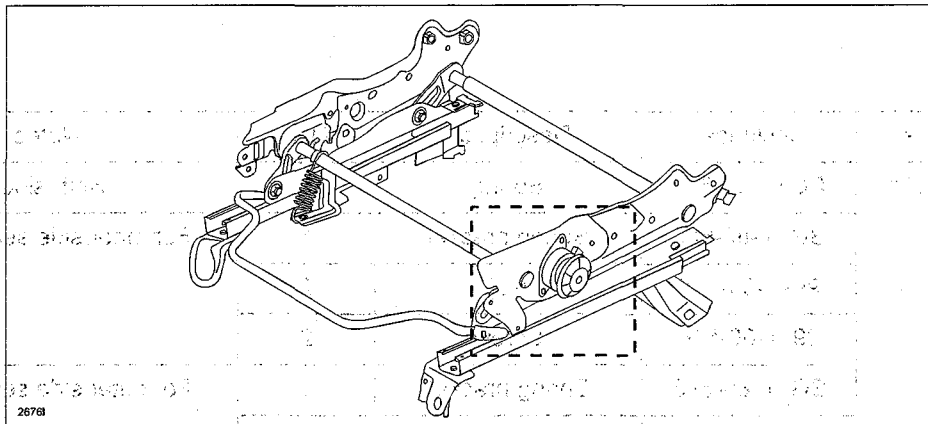

9. Install the seat in the vehicle.

NOTE:... The lifter position should be in the most downward position before installation of the seat in the vehicle.

10. Verify repair.

PART(S) INFORMATION

Mazda2

Part Number	Includes	Description	Qty.	Notes
GATT-88-001	GAY1-88-601	Spring	2	Both sides
	GAY1-88-C50	Spring bracket	1	For inner side seat frame.
	9990-60-500	Nut	2	
	9983-00-510	Screw	2	
	D0YT-88-C50	Spring bracket	1	For outer side seat frame.
	9994-00-400	Nut	2	
	9983-40-412B	Screw	2	

Mazda3

Part Number	Includes	Description	Qty.	Notes
BGTT-88-001	BGY4-88-601	Spring	2	Both sides
	BGY4-88-685	Spring bracket	1	For inner side seat frame.
	9990-60-500	Nut	2	
	9974-00-516	Screw	2	
	BGY4-88-686	Spring bracket	1	For outer side seat frame.
	9994-00-400	Nut	2	
	9974-00-412	Screw	2	

Bulletin No: 09-043/12 © 2012 Mazda Motor of America, Inc.	Last Issued: 11/16/2012
--	--------------------------------

WARRANTY INFORMATION

NOTE:

- This warranty information applies only to verified customer complaints on vehicles eligible for warranty repair.
- This repair will be covered under Mazda's New Vehicle Limited Warranty term.
- Additional diagnostic time cannot be claimed for this repair.

	Mazda2	Mazda3
Warranty Type	A	A
Symptom Code	82	82
Damage Code	97	97
Part Number Main Cause	GAY1-88-C50	BGY4-88-685
Quantity	1	1
Operation Number / Labor Hours:	XXH3LXRX / 0.5 Hrs.	XXH75XRX / 0.5 Hrs.