

Power-Steering Return Line Hose Clamp (81/12)

Vehicle Type: **Panamera/Panamera S/Panamera Turbo**

Model Year: **As of 2013**

Concerns: **Power-steering return line**

Information: **Different setups for securing the power-steering return line.**

One or two hose clamps may have been used for the power-steering return line on the cooler connection.



Information

Only if a complaint is received or in the event of repairs:

When **installing the power-steering return line (970.347.23X.XX)** on the cooler connection, **always observe the following points:**

- Irrespective of the existing setup (one or two clamps), two new clamps must be installed as follows:
- Use **one new** hose clamp (⇒ *Figure 1 -item B-*, 999.512.652.09) on the inside and
- **also fit a second new hose clamp** (⇒ *Figure 1 -item A-*, 999.512.489.00).
- Before installing the return line, clean the area close to the cooler connection (inner) using a clean, dry, lint-free cloth and fit it "dry".

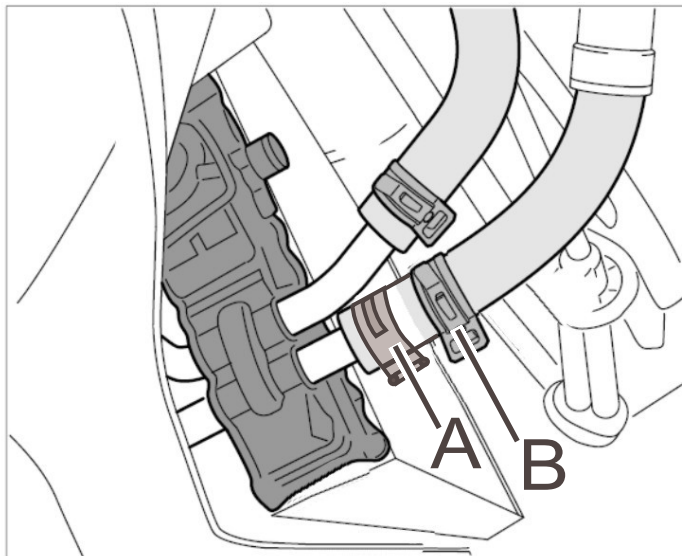

Figure 1

Parts Info: 999.512.489.00 ⇒ Hose clamp (⇒ *Figure 2*)
999.512.652.09 ⇒ Hose clamp

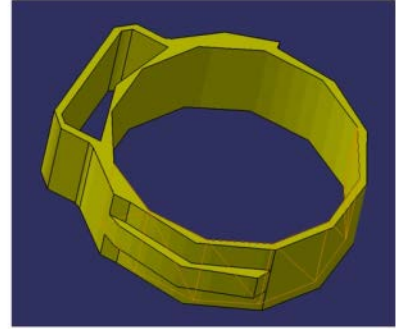

Figure 2

Tools: **Nr. 74 - Pliers**
Nr. 74-1 - VAS 6199 pliers
- Clean, dry, lint-free cloth

Working Time: 48950900: Loosening and securing return hose
Includes: Replacing two clamps
Removing and installing front cover
Draining and filling hydraulic fluid
Checking fluid level

Labor time: **55 TU**

Important Notice: Technical Bulletins issued by Porsche Cars North America, Inc. are intended only for use by professional automotive technicians who have attended Porsche service training courses. They are written to inform those technicians of conditions that may occur on some Porsche vehicles, or to provide information that could assist in the proper servicing of a vehicle. Porsche special tools may be necessary in order to perform certain operations identified in these bulletins. Use of tools and procedures other than those Porsche recommends in these bulletins may be detrimental to the safe operation of your vehicle, and may endanger the people working on it. Properly trained Porsche technicians have the equipment, tools, safety instructions, and know-how to do the job properly and safely. If a particular condition is described, do not assume that the bulletin applies to your vehicle, or that your vehicle will have that condition. See your authorized Porsche Dealer for the latest information about whether a particular technical bulletin applies to your vehicle. Part numbers listed in these bulletins are for reference only. Always check with your authorized Porsche dealer to verify the current and correct part numbers. The work procedures updated electronically in the Porsche PIWIS diagnostic and testing device take precedence and, in the event of a discrepancy, the work procedures in the PIWIS Tester are the ones that must be followed.

© Porsche Cars North America, Inc.

Dealership	Service Manager	Shop Foreman	Service Technician
Distribution	Asst. Manager	Warranty Admin.	Service Technician
Routing			

Dr. Ing. h.c. F. Porsche AG is the owner of numerous trademarks, both registered and unregistered, including without limitation the Porsche Crest®, Porsche®, Boxster®, Carrera®, Cayenne®, Cayman®, Panamera®, Speedster®, Spyder®, 918 Spyder®, Tiptronic®, VarioCam®, PCM®, PDK®, 911®, 4S®, FOUR, UNCOMPROMISED.® and the model numbers and the distinctive shapes of the Porsche automobiles such as, the federally registered 911 and Boxster automobiles. The third party trademarks contained herein are the properties of their respective owners. Porsche Cars North America, Inc. believes the specifications to be correct at the time of printing. Specifications, performance standards, standard equipment, options, and other elements shown are subject to change without notice. Some options may be unavailable when a car is built. Some vehicles may be shown with non-U.S. equipment. The information contained herein is for internal use only by authorized Porsche dealers and authorized users and cannot be copied or distributed. Porsche recommends seat belt usage and observance of traffic laws at all times.

Printed in the USA