

Constellation  
Heritage  
4700 Models

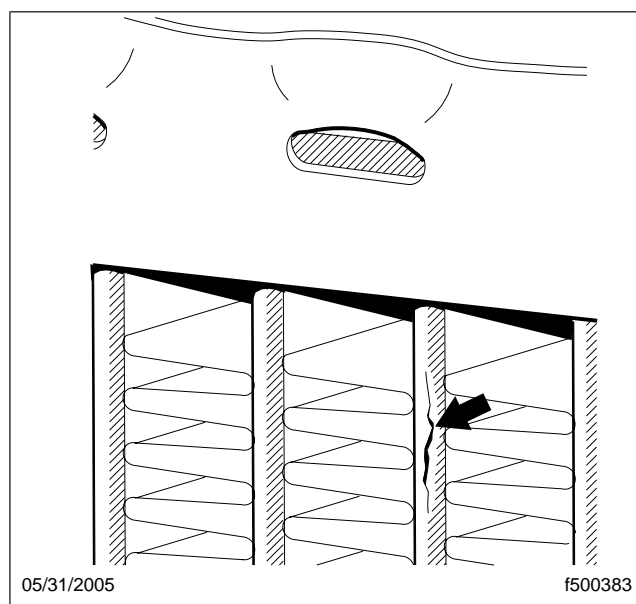
4800 Models  
> 4900 Models

5900 Models  
6900 Models

Western Star  
Service Bulletin

## General Information

Some EPA10 compliant Western Star 4900 vehicles equipped with 1700 sq in aluminum radiators, manufactured March 2010 and later, with specific combination of engine operating parameters, may have radiator failures resulting in a coolant leak due to a crack in the coolant tube. See [Fig. 1](#). Leaks in other places (at the end tank, header, fittings, or any place other than the coolant tubes) do not apply for this bulletin. If leaks occur in the coolant tubes, Western Star recommends a radiator update to an isolated engine-mounted radiator. Isolated engine-mounted radiators were production installed in 4900 models beginning in August, 2012. This procedure is to replace a standard 1700 sq in aluminum engine-mounted radiator with an isolated 1700 sq in aluminum engine-mounted radiator.



**Fig. 1, Crack in Coolant Tube**

**IMPORTANT:** The required parts for this procedure will vary depending on the type of engine installed. See [Table 1](#) under "Parts" for the list of required parts for the vehicle being serviced.

## Radiator Mount Replacement

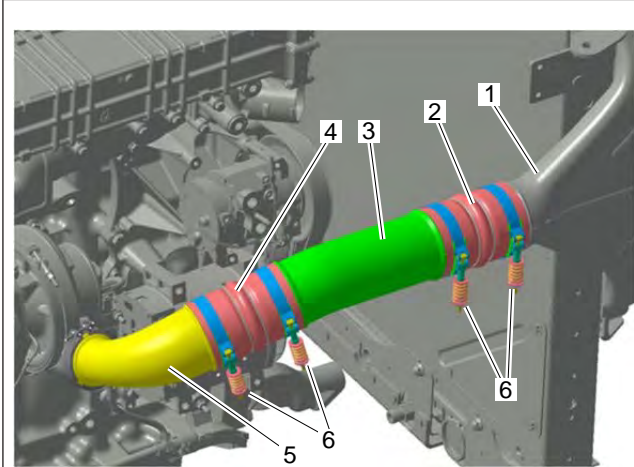
1. Park the vehicle on a level surface, shut down the engine, and set the parking brake. Chock the tires.
2. Remove the hood. For instructions, see **Group 88** in the *Western Star Workshop Manual*.
3. Remove the bumper. For instructions, refer to **Group 31** of the *Western Star Workshop Manual*.
4. Drain the coolant from the radiator and engine block.
5. Remove the charge air cooler (CAC) plumbing at the turbocharger outlet and the CAC inlet. See [Fig. 2](#).
6. Remove the CAC plumbing at the CAC outlet and the engine inlet. See [Fig. 3](#).
7. Remove the upper radiator hose. See [Fig. 4](#).
8. Disconnect the surge tank vent line. See [Fig. 5](#).
9. Remove the grille from the radiator.

### Western Star Service Bulletin

Constellation  
Heritage  
4700 Models

4800 Models  
> 4900 Models

5900 Models  
6900 Models

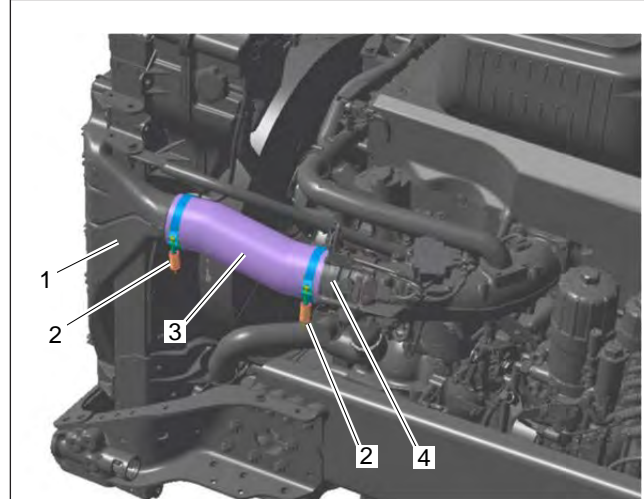


10/16/2012

f200767

- |              |                               |
|--------------|-------------------------------|
| 1. CAC Inlet | 5. Turbocharger Inlet<br>Pipe |
| 2. Hose      | 6. Clamp                      |
| 3. Tube      |                               |
| 4. Hose      |                               |

**Fig. 2, CAC Plumbing, Turbocharger-to-CAC**

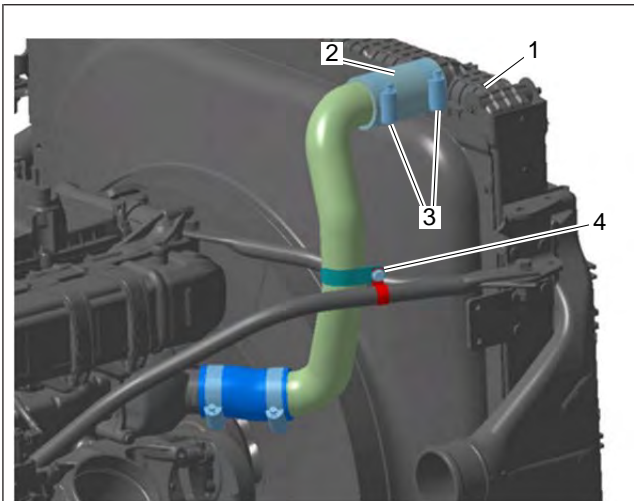


10/16/2012

f200768

- |               |                 |
|---------------|-----------------|
| 1. CAC Outlet | 3. Hose         |
| 2. Clamp      | 4. Engine Inlet |

**Fig. 3, CAC Plumbing, CAC-to-Engine Inlet**

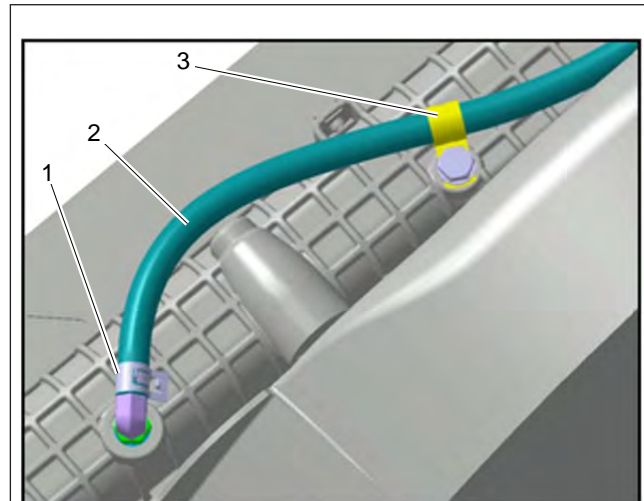


10/16/2012

f200771

- |                        |                   |
|------------------------|-------------------|
| 1. Radiator            | 3. Clamp          |
| 2. Upper Radiator Hose | 4. Clamp Fastener |

**Fig. 4, Upper Radiator Hose Installation**



10/16/2012

f200769

- |          |            |
|----------|------------|
| 1. Clamp | 3. P-Clamp |
| 2. Line  |            |

**Fig. 5, Surge Tank Vent Line**

10. Loosen the A/C condenser and move it out of the way as follows.

- 10.1 Remove the receiver-drier and upper A/C hose mounting nuts, then free the receiver-drier. See [Fig. 6](#).

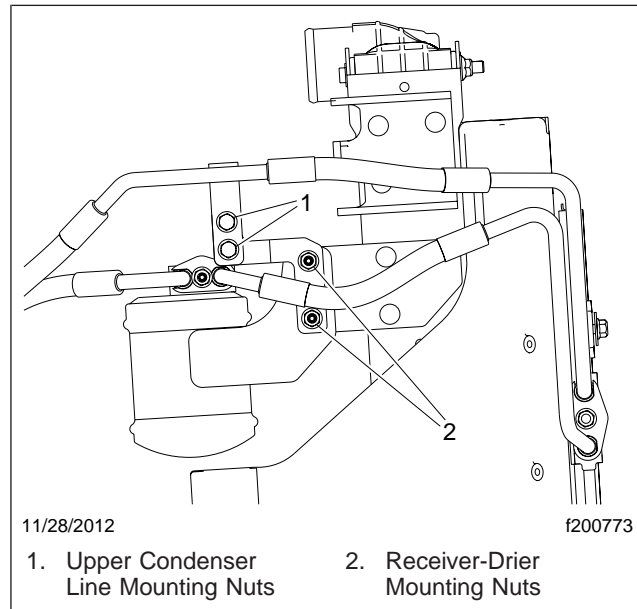
Constellation  
Heritage  
4700 Models

4800 Models  
> 4900 Models

5900 Models  
6900 Models

Western Star  
Service Bulletin

10.2 Remove the radiator baffle from the right side of the radiator.



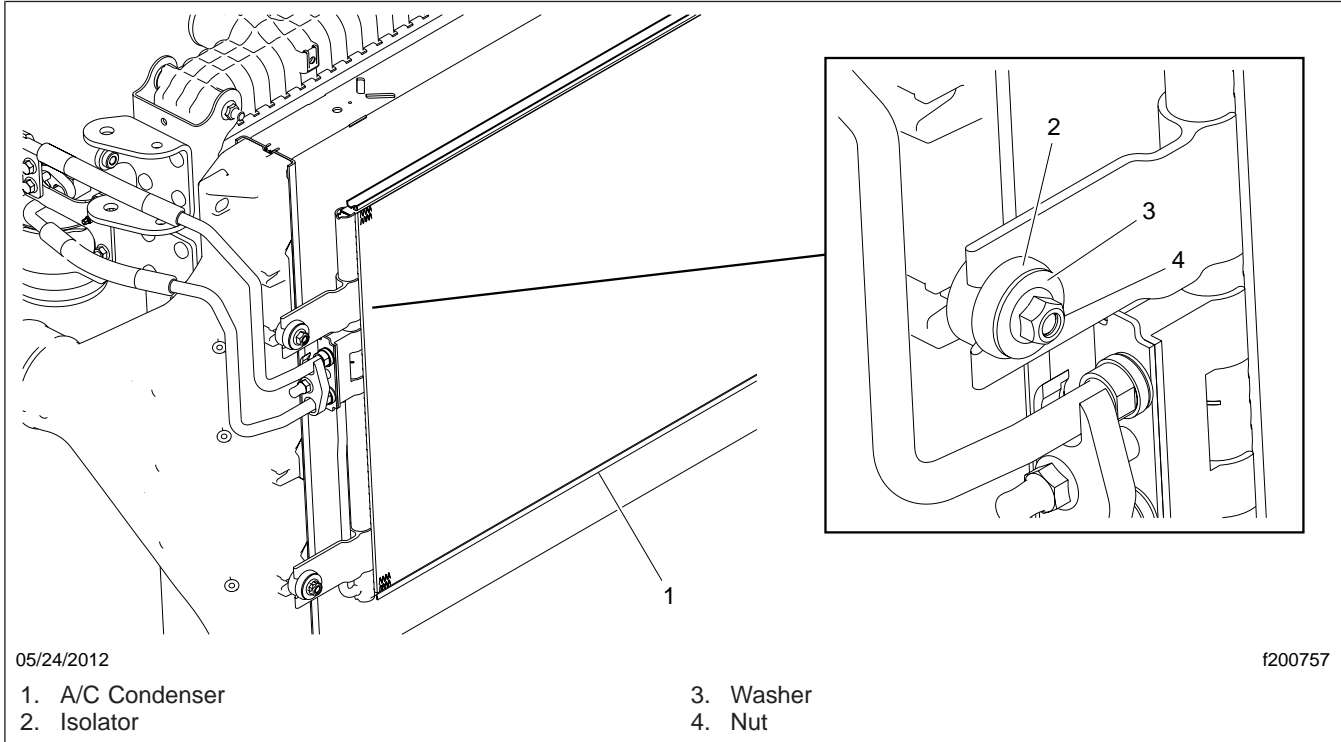
**Fig. 6, Receiver-Drier Installation (typical)**

10.3 Unbolt the A/C condenser from the CAC. See [Fig. 7](#).

NOTE: Wrap the condenser in cardboard to protect it while it is moved.

10.4 Carefully move the condenser around and set it on the right front tire. Secure it as needed. See [Fig.8](#).

11. Remove the three radiator strut rods and discard them.
12. Remove the upper and left-side radiator baffles.
13. Remove the upper fan shroud. See [Fig. 9](#).
14. Remove the fan. For instructions, refer to **Group 20** of the *Western Star Workshop Manual*.
15. Remove the lower radiator hose. See [Fig. 10](#).
16. Disconnect the transmission cooler lines from the radiator. Cap and/or plug the fittings to prevent spills.
17. Unbolt the radiator from the lower mounts.
18. Using an appropriate lifting device, remove the radiator assembly from vehicle. See [Fig. 11](#).
19. Remove the lower fan shroud from the radiator. See [Fig. 9](#).
20. Remove the CAC from the radiator.
21. Install the CAC on the new radiator.
22. Install the lower fan shroud on the new radiator.
23. Remove the lower radiator mounting brackets from the engine.
24. Install the new lower radiator mounting brackets. See [Fig. 12](#). Tighten 191 to 234 lbf·ft (260 to 317 N·m).
25. Install the lower radiator isolators on the mounting brackets. See [Fig. 13](#).



**Fig. 7, A/C Condenser Installation**

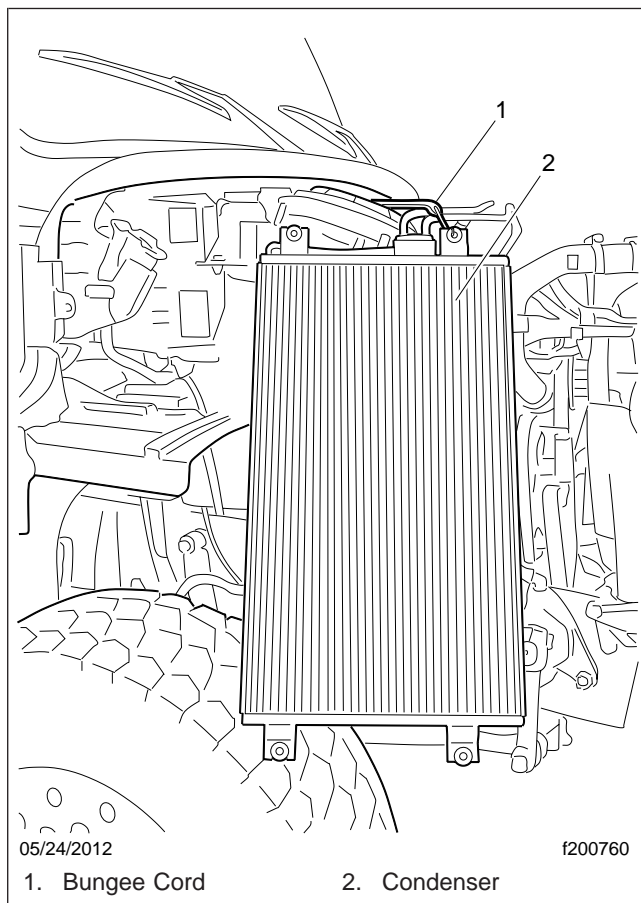
26. Using an appropriate lifting device, position the new radiator assembly in the vehicle. Install the mounting nuts, but do not tighten them at this time. See [Fig. 13](#).
27. Install the new upper radiator hose. See [Fig. 4](#).
28. Connect the transmission cooler lines.
29. Apply sealant (48-00094-141) to the threads of the fasteners, then install the fan. Tighten 30 lbf-ft (41 N-m).
30. Install the new lower radiator hose assembly. See [Fig. 10](#).
31. Install the upper fan shroud. See [Fig. 9](#).
32. Install the new radiator strut rods. See [Fig. 14](#). Tighten the radiator strut rod fasteners at the radiator 55 to 65 lbf-ft (75 to 90 N-m), and at the engine block 125 to 139 lbf-ft (171 to 188 N-m).
33. Tighten the radiator mounting nuts 140 to 170 lbf-ft (190 to 230 N-m).
34. Install the CAC plumbing at the turbocharger outlet and the CAC inlet. See [Fig. 2](#).
35. Install the CAC plumbing at the CAC outlet and the engine inlet. See [Fig. 3](#).
36. Install the A/C condenser as follows.
  - 36.1 Move the condenser into position and secure it temporarily. See [Fig. 7](#).
  - 36.2 Position the receiver-drier and upper A/C line on their respective brackets and install the mounting nuts. See [Fig. 6](#). Tighten the nuts 14 to 16 lbf-ft (19 to 22 N-m).
  - 36.3 Tighten the condenser mounting bolts 112 to 144 lbf-in (1266 to 1627 N-cm).

Constellation  
Heritage  
4700 Models

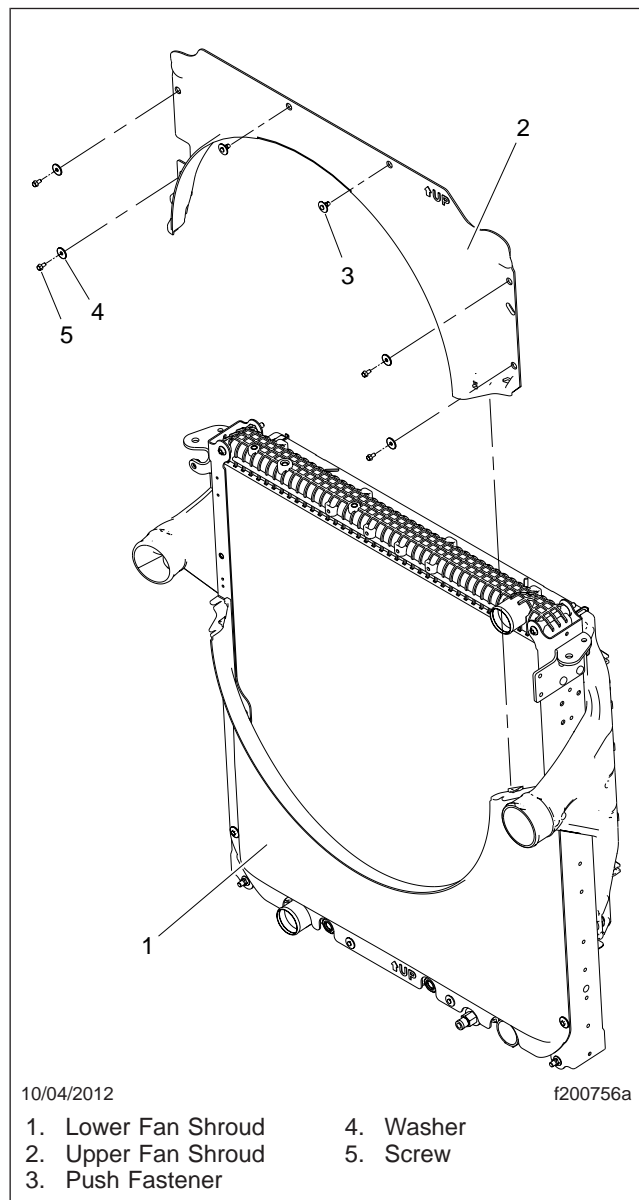
4800 Models  
> 4900 Models

5900 Models  
6900 Models

Western Star  
Service Bulletin

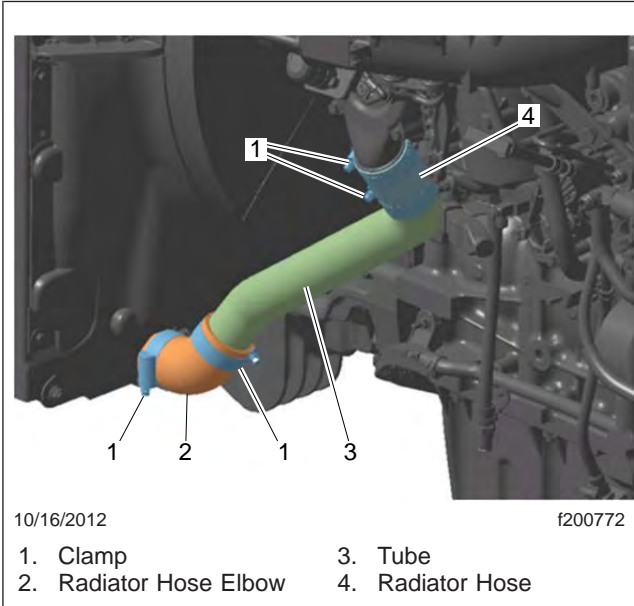


**Fig. 8, Securing the A/C Condenser**

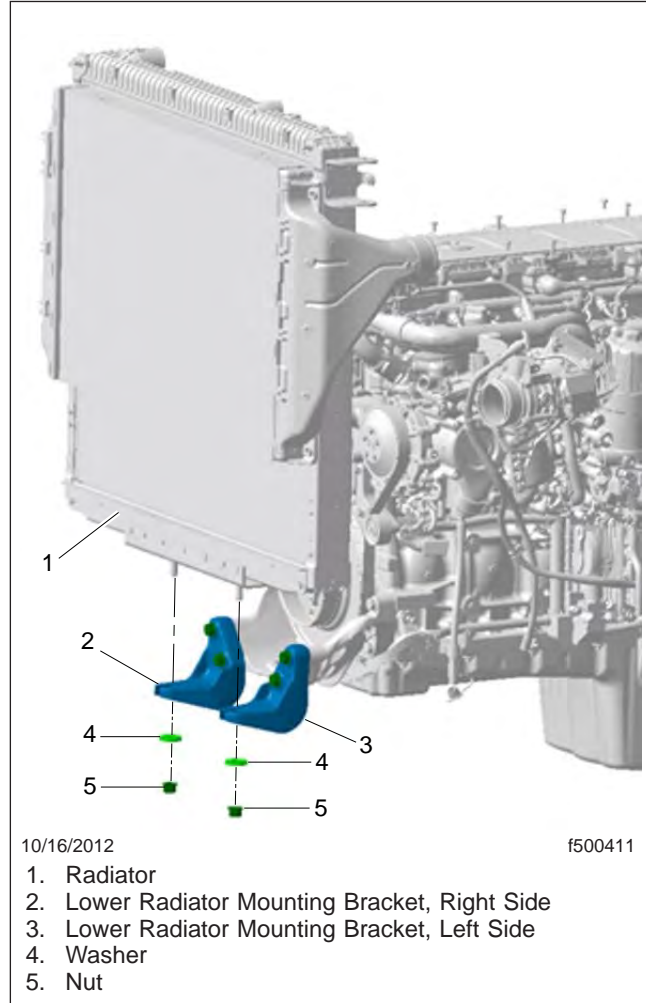


**Fig. 9, Fan Shroud Installation**

37. Install the radiator baffles.
38. Install the grille.
39. Fill the cooling system.
40. Start the engine and check for coolant and transmission fluid leaks. Repair as needed.
41. Check the transmission fluid level, and add fluid as needed.
42. Install the hood. For instructions, see **Group 88** of the *Western Star Workshop Manual*.



**Fig. 10, Lower Radiator Hose Installation**



**Fig. 11, Radiator Removal**

43. Install the bumper. For instructions, refer to **Group 31** of the *Western Star Workshop Manual*.

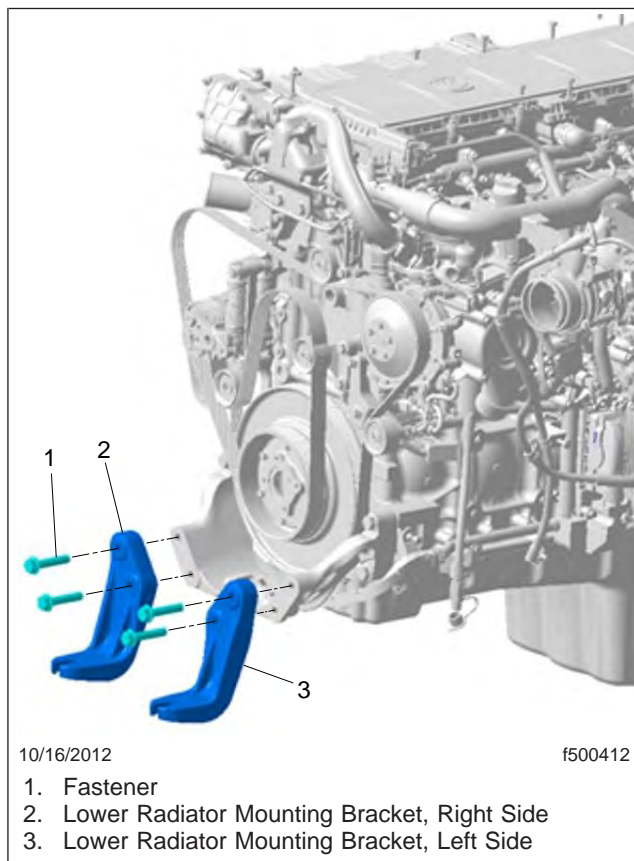


Constellation  
Heritage  
4700 Models

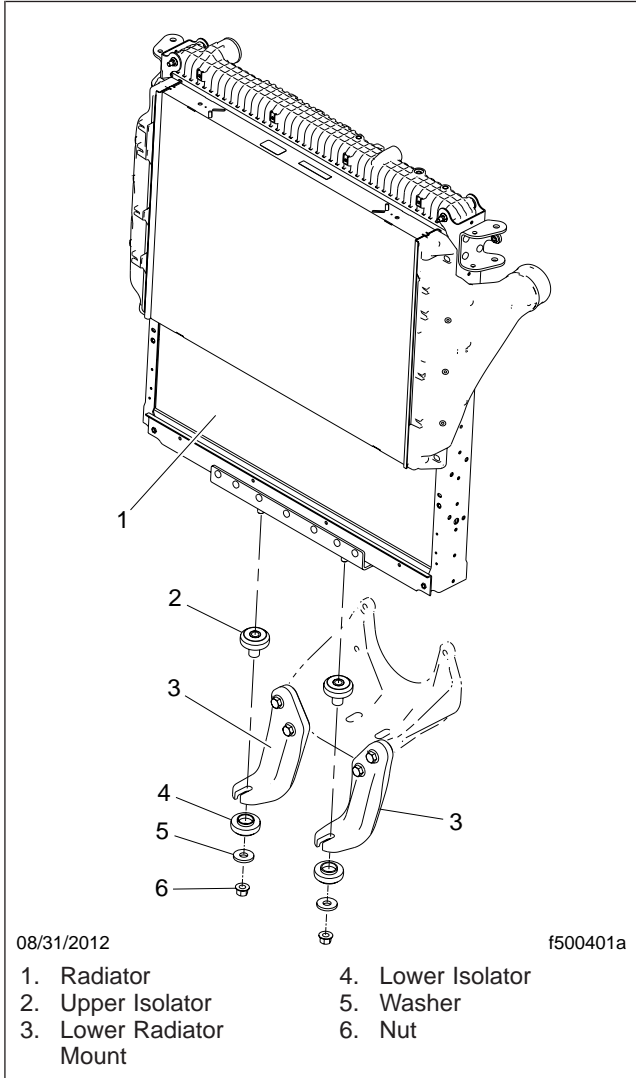
4800 Models  
> 4900 Models

5900 Models  
6900 Models

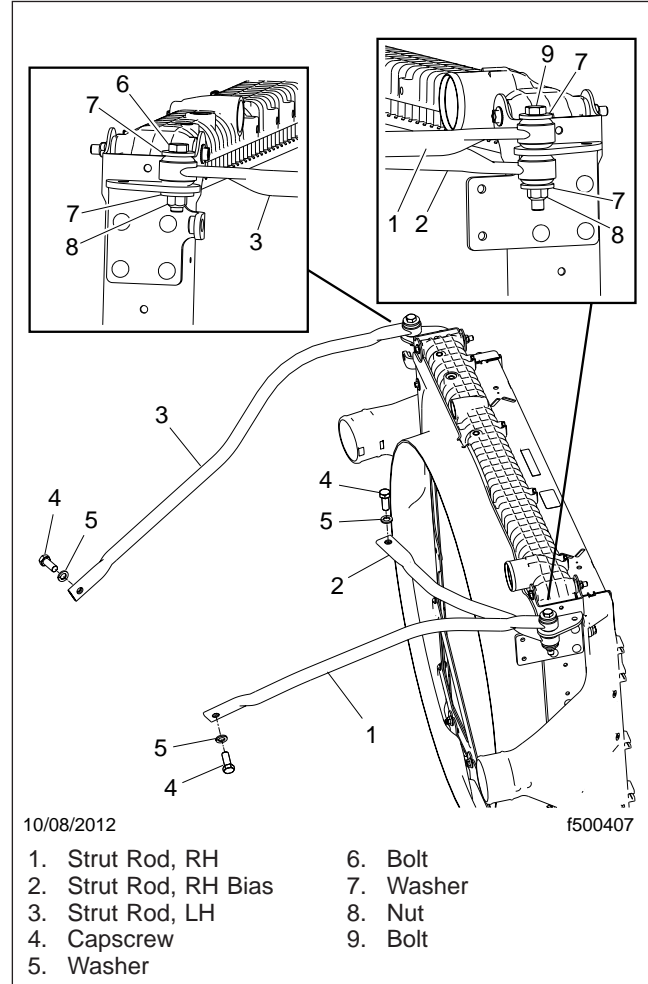
**Western Star  
Service Bulletin**



**Fig. 12, Lower Isolated Radiator Mounting Bracket Installation**



**Fig. 13, Radiator Installation**



**Fig. 14, Isolated Radiator Strut Rod Installation**



Constellation  
Heritage  
4700 Models

4800 Models  
> 4900 Models

5900 Models  
6900 Models

Western Star  
Service Bulletin

## Parts

Parts are available through the PDC. See to [Table 1](#) for the required changeover parts for the vehicle being serviced.

Western Star 4900FA 1700AL Radiator, Required Parts				
Part	DD13	DD15	ISX	Quantity
RAD	05-30350-007	05-30350-007	05-30350-006	1
LH UPPER SUPPORT	A05-30480-000	A05-30303-000	A05-30373-000	1
RH UPPER SUPPORT	A05-30481-000	A05-30304-000	A05-30374-000	1
UPPER SUPPORT(BIAS)	A05-30482-000	A05-30305-000	A05-30375-000	1
LH LOWER SUPPORT	05-30368-000	05-30368-000	05-30368-000	1
RH LOWER SUPPORT	05-30368-001	05-30368-001	05-30368-001	1
FAN	KYS 010024426	KYS 010024426	KYS 010024426	1
ISOLATORS(kit)	BCD 27463 14	BCD 27463 14	BCD 27463 14	2
SCREW-CAP,HEX,1/2-13,GR8,ZNDI	23-11751-250	23-11751-250	23-11751-250	1
SCREW-CAP,HEX,1/2-13,GR8,ZN	23-11751-400	23-11751-400	23-11751-400	1
NUT-HEX,PT,1/2-13,C,ZN/AL,.448	23-13833-108	23-13833-108	23-13833-108	2
WASHER-HRDND,STL,.66X2.75"	01-20963-000	01-20963-000	01-20963-000	2

Table 1, Required Parts by Vehicle Configuration

## PartsPro Global Annotation

It is highly recommended that a Global Annotation regarding this modification be entered in PartsPro. Global annotations give users a way to record and check after-factory installations and modifications for a particular vehicle. It is connected to a specific VIN, and is visible to anyone who views that serial number in PartsPro. Create and view Global Annotation as follows.

1. In PartsPro, enter the serial number (the last six characters of the VIN) in the "Vehicle" tab and press "Enter," or click the "Retrieve Design Group" button.
2. In the "Design Group" tab, click the Add Annotation icon. See [Fig. 15](#).

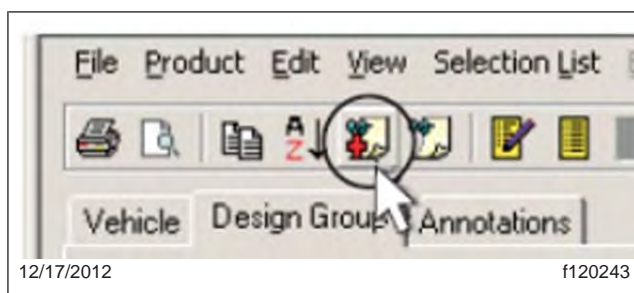


Fig. 15, Add Annotation Icon

3. In the "Add Annotation" window, mark the annotation as "Global" and enter text for the annotation.  
Suggested annotation text: The cooling system has been modified to an isolated mount type radiator. See Service Bulletin 20-18 for radiator, radiator mounting, and fan part numbers.

- Click the "OK" button to submit.

Daimler Trucks North America will review the content for publication.

For additional information, click the "Help" button or Help → Contents in the top menu bar, and view the "Annotations" topic in PartsPro help, or refer to Freightliner or Western Star Parts Technical Bulletin: 00-009 for instructions.

## Warranty

This procedure is warrantable only if the described condition exists and the repair is performed within the applicable base or extended coverage warranty period. If a failure is not found, this procedure is considered preventive and warranty does not apply.

Normal warranty applies. See [Table 2](#) for QuickClaim damage code and labor allowance information. Refer to this service bulletin by number at the beginning of the claim comments. See [Table 3](#) for OWL VMRS codes and labor allowance information. Enter this service bulletin number in the *Service Bulletin #* field.

QuickClaim Damage Code and Labor Allowance			
Damage Code	SRT Code	Description	Time: Hours
266-000A05609	266-5035A	Western Star Isolated Radiator Update	3.7

**Table 2, QuickClaim Damage Code and Labor Allowance**

OWL VMRS Codes and Labor Allowance					
Primary Failed Part	Component Code	Cause Code	SRT Code	Description	Time: Hours
05-30352-003	042-002-001	12	266-5035A	Western Star Isolated Radiator Update	3.7

**Table 3, OWL VMRS Codes and Labor Allowance**