



DEALER SERVICE ACTION

Date: June 7, 2012

2013 ALTIMA STEERING COLUMN NUT TORQUE

Check Service COMM to confirm service action eligibility.

ID #: PC158

APPLIED VEHICLES: 2013 Nissan Altima

INTRODUCTION

Nissan North America is conducting a service action on certain specific 2013 Nissan Altima vehicles identified in Service Comm that are located at dealers and are "Early Release Consignment Units". The Service Action will involve checking to ensure the correct torque has been applied to the steering column mounting nuts.

IDENTIFICATION NUMBER

Nissan has assigned identification number PC158 to this service action. This number must appear on all communications and documentation of any nature dealing with this service action.

DEALER RESPONSIBILITY

It is the dealer's responsibility to check Service Comm for the status of each vehicle falling into the range of this service action that is currently located at the dealer. Dealers are required to perform this service action on the affected units identified by SERVICE COMM.

SERVICE PROCEDURE

1. Remove top steering column finisher.
 - Turn steering wheel 90 degrees to the left and remove 1 Phillips screw.
 - Turn steering wheel 90 degrees to the right and remove 1 Phillips screw.

Remove screw.



Remove screw.



- Using hand pressure remove the 6 dust cover tabs from the steering column top finisher and set finisher aside.



2. For units with paddle shifters, use hand pressure and remove left and right trim finisher.
 - If unit does not have paddle shifters on steering column go to step 3.



3. Remove bottom steering column finisher.
 - Turn steering wheel 180 degrees and remove 2 Phillip screws.



- Remove 1 Phillips screw on bottom and remove lower steering column finisher.



4. Inspect Steering column clip location.
 - Locate steering column clips.



- Inspect to ensure clips are fully seated to bracket.

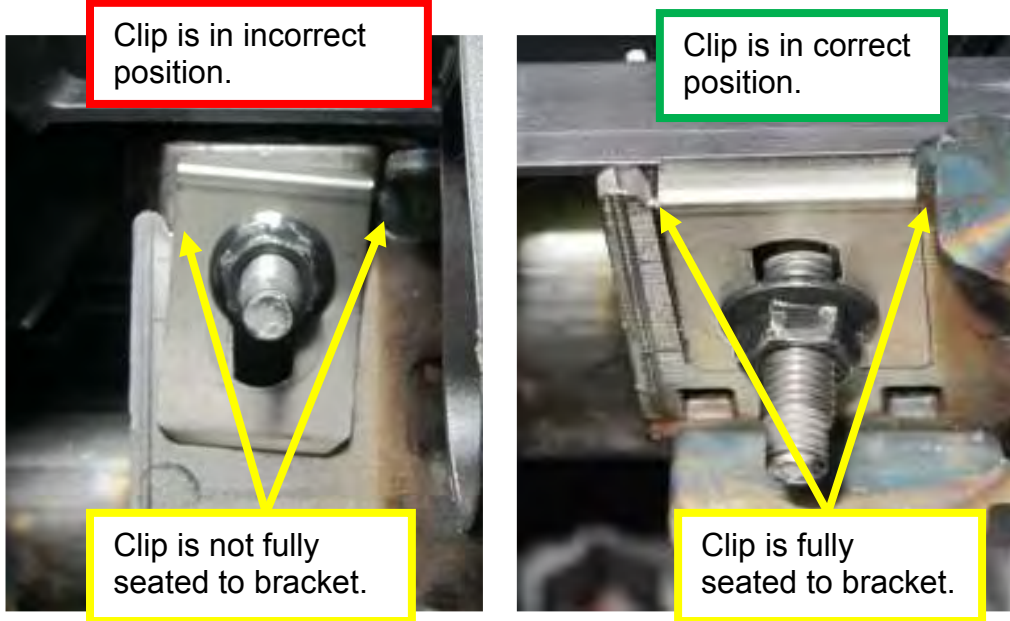

- If clips is in correct position and is fully seated to bracket go to step 6.
- If clips is in incorrect position and is '**NOT**' fully seated go to step 5.

5. Relocate clips on bracket.

- Loosen 2 nuts securing steering column.
- Release steering column lock.
- Pull back on steering wheel to relocate clips on bracket.
- Ensure both clips are fully seated against bracket.
- Go to step 6.

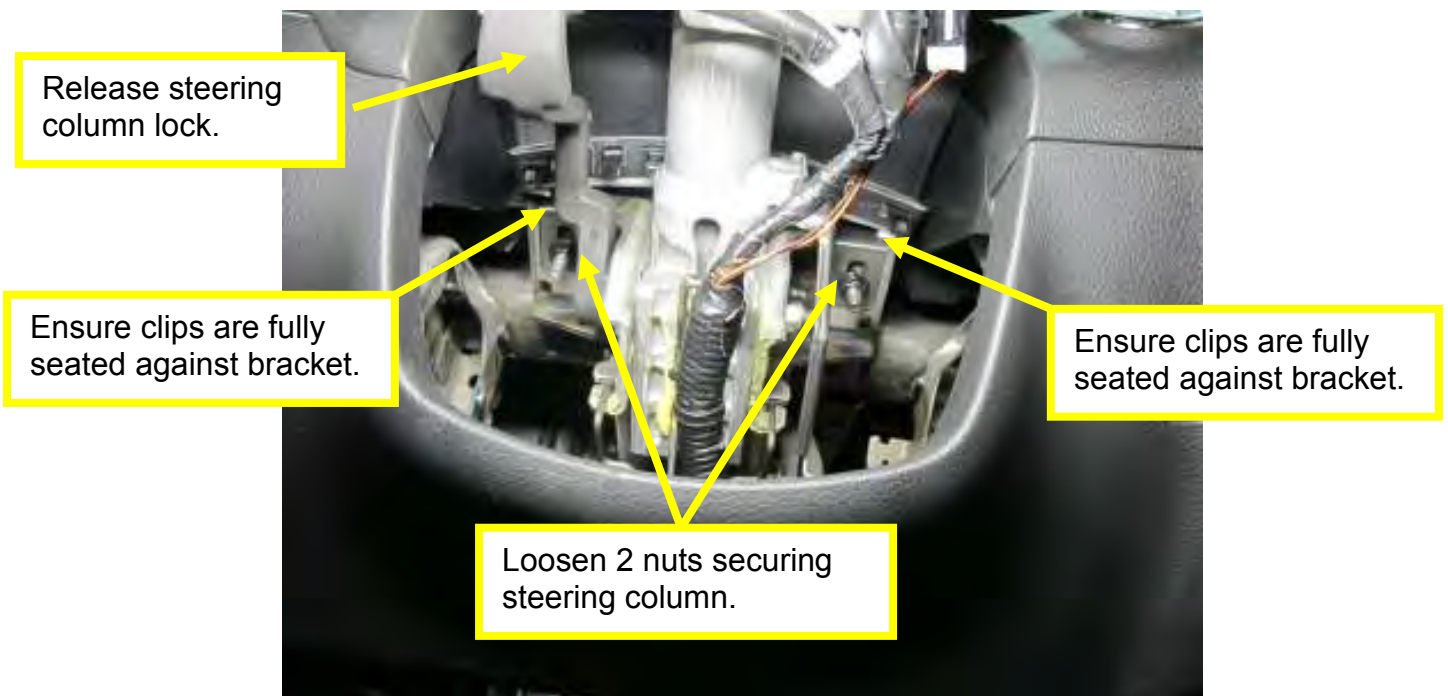

6. Torque 2 nuts securing steering column.
 - Torque to 18.6 NM (14 ft-lb)
 - Use cloth protection to prevent scratching finisher.

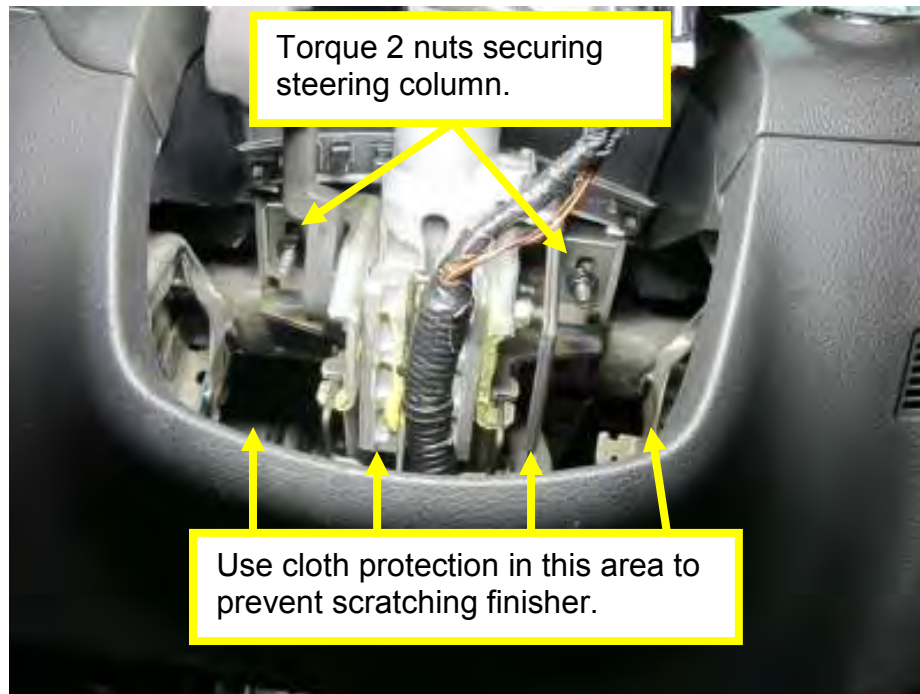

7. Install bottom steering column finisher.
 - Turn steering wheel 180 degrees and install 2 Phillip screws.



- Install 1 Phillip screw on bottom and to secure finisher to steering column.



8. On units with paddle shifter on steering column, use hand pressure and Install driver and passenger side trim finisher.
 - If unit does not have paddle shifter on steering column, go to step 9.



9. Install dust cover to top steering column finisher.
- Using hand pressure Install 6 tabs to Steering column top finisher and align finisher on steering column.



10. Install top steering column finisher.
- Turn steering wheel 90 degrees to the left and install 1 Phillip screw.
 - Turn steering wheel 90 degrees to the right and install 1 Phillip screw.



11. Ensure all finishers are aligned and secure.

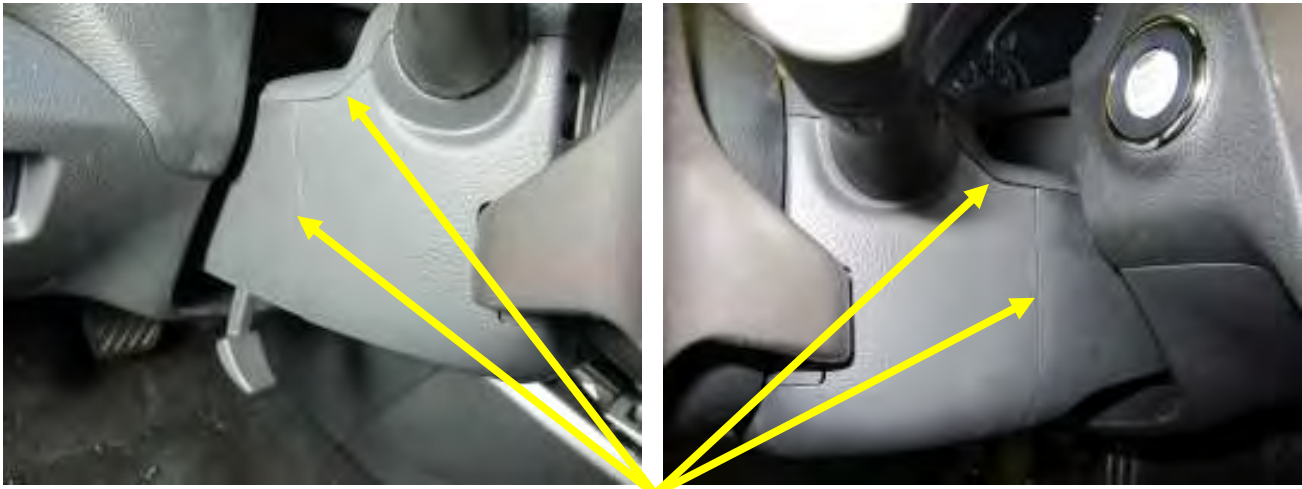

Ensure all finishers are aligned and secure.

CLAIMS INFORMATION

Submit claim using the following claims coding:

Work Order Line Type: "CM" Campaign

Campaign: PC158

Claim Type:	CM			
PNC:	PC158			
Symptom:	ZZ			
Diagnosis:	99			
Description:	Op Codes	Flat Rate Time	Parts Required on claim	Expense Code Required
Torque steering column mounting nuts.	PC1580	0.3H	No	No