

SB-10045285-1455

SI B51 25 12
Body Equipment

July 2012
Technical Service

SUBJECT

ActiveE: Interior Water Ingress

MODEL

E82E

SITUATION

The customer complains about wet carpet in the center tunnel area. Water may penetrate into the passenger compartment when the vehicle is driven through deep puddles.

CAUSE

Insufficient sealing of the service openings in the transmission tunnel.

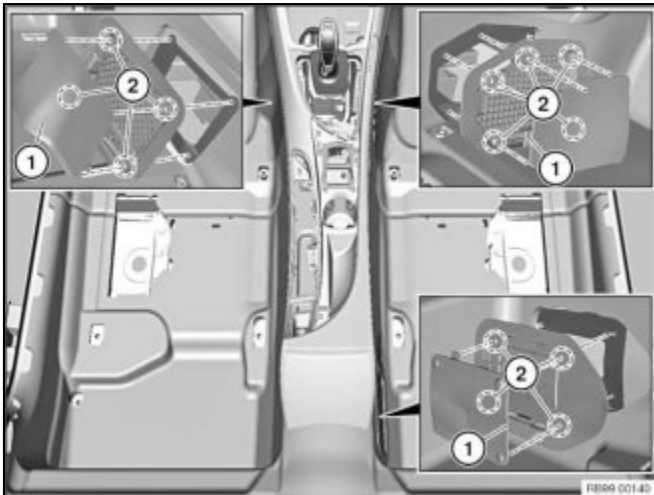
CORRECTION

1. After verifying the complaint, unclip the tunnel trim (1) at the marked points using a suitable tool, and remove the covers (1).
2. Release the screws (2) and remove the tunnel frame.

Note: The illustration shows the area of the transmission tunnel with the front seats removed only for picture clarity. It is not necessary to remove the front seats for this repair procedure.

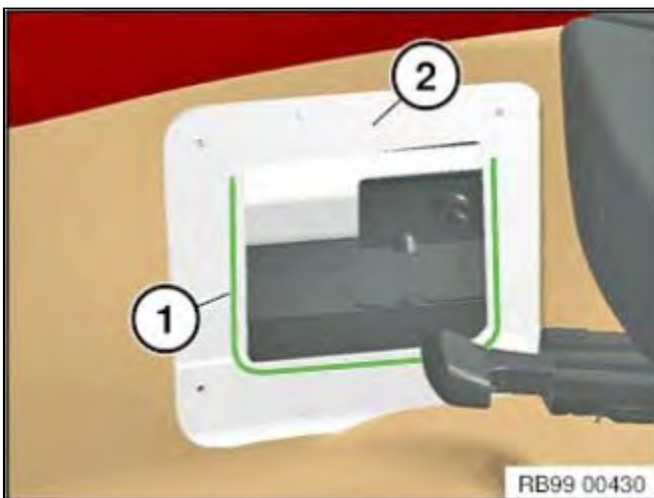

3. Apply butyl rope P/N 83 19 0 000 537 in a U-shaped area (1) on the tunnel plate (2).

Note: The illustration shows a driver's side transmission tunnel. The procedure must be carried out on all service openings in the tunnel frame.

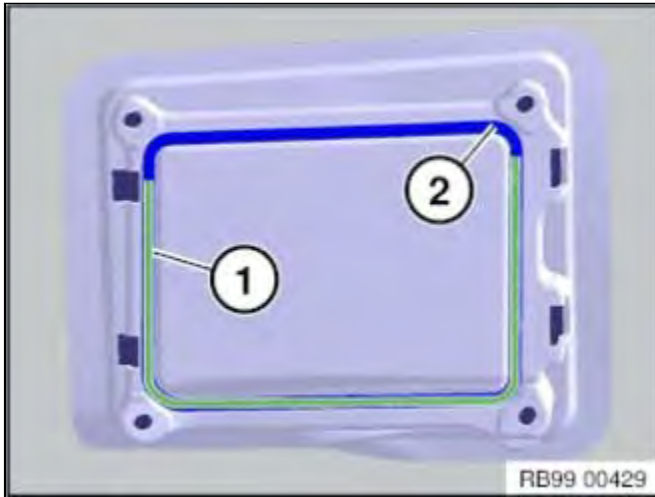

4. Smooth the ends of the butyl rope (1) to the sealing surface.

Note: The top side of the sealing surface (2) remains free of butyl.

5. Reinstall all tunnel frames and tunnel trims.
6. Replace the screws for the front left and right tunnel frame covers.

Tightening torque (front left/right tunnel cover): 4.6 Nm

Tightening torque (rear tunnel cover): 8 Nm

PARTS INFORMATION

Part Number	Description	Quantity
51 11 7 707 528	Replacement M5x10 screws	9
83 19 0 000 537	Butyl Rope 6mm x 20m	1

WARRANTY INFORMATION

Covered under the terms of the BMW New Vehicle/SAV Limited Warranty.

Defect Code: 85 99 01 73 EE

Labor Operation:	Labor Allowance:	Description:
51 99 000	10 FRU	Work Time to apply butyl rope on tunnel plate (Main work)

or

51 99 000	8 FRU	Work Time to apply butyl rope on tunnel plate (Plus work – vehicle already in the workshop)
-----------	-------	---

and

Sublet Code 4	Sublet amount	Reimbursement for the used quantity of Butyl Rope (Bulk container reference P/N 83 19 0 000 537, 6mm x 20m. Do not use this part number for claim submission)
---------------	---------------	---

Sublet calculation: Reimbursement for used quantity of Butyl Rope ((Bulk container reference P/N 83 19 0 000 537, 6mm x 20m) at dealer net plus handling. Enter this material cost in sublet and itemize the amount in the claim comment section.

[Copyright © 2012 BMW of North America, LLC]