



2013 PRE-DELIVERY SERVICE CHECK SHEET

October 2012

| BEFORE INSPECTION | OK | Adjust/Repair |
|---|--------------------------|--------------------------|
| 01 Install short pin - see page 2 | <input type="checkbox"/> | <input type="checkbox"/> |
| 02 Install radio antenna | <input type="checkbox"/> | <input type="checkbox"/> |
| 03 Initialize Advanced Parking Guidance System* | <input type="checkbox"/> | <input type="checkbox"/> |
| FUNCTIONAL OPERATION | | |
| <i>Apply parking brake and cycle ignition "IG-ON"; place gear selector in reverse; turn on lights and rear defogger. Unlock doors; release fuel door.</i> | | |
| 01 Check dome, courtesy, map, and sun visor lights* | <input type="checkbox"/> | <input type="checkbox"/> |
| 02 Check warning/indicator lights, gauges, and horn | <input type="checkbox"/> | <input type="checkbox"/> |
| 03 Check windshield wipers and washers | <input type="checkbox"/> | <input type="checkbox"/> |
| 04 Check headlights, instrument lights, turn signals, emergency flashers, and brake lights | <input type="checkbox"/> | <input type="checkbox"/> |
| 05 Check inside/outside rear view mirror operation/adjustment | <input type="checkbox"/> | <input type="checkbox"/> |
| 06 Check cigarette lighter* and power outlets | <input type="checkbox"/> | <input type="checkbox"/> |
| 07 Check audio/navigation*/backup camera* systems and set clock | <input type="checkbox"/> | <input type="checkbox"/> |
| 08 Verify Entune/Navigation software version (Display Audio, Non-HDD Type only)* | <input type="checkbox"/> | <input type="checkbox"/> |
| 09 Check multi-information display and trip information on center display* | <input type="checkbox"/> | <input type="checkbox"/> |
| 10 Install shift-lock override button cover* | <input type="checkbox"/> | <input type="checkbox"/> |
| 11 Check sliding roof* | <input type="checkbox"/> | <input type="checkbox"/> |
| WALKAROUND INSPECTION | | |
| <i>Start at left front door. Check window and door lock operation (from master power switch, if equipped). Continue around vehicle in a counterclockwise direction checking each door and window operation, child door locks, seat belts, interior condition, all lights, luggage compartment contents. Finish by checking headlight aim and continue into UNDER HOOD checks.</i> | | |
| 01 Check Smart Key system | <input type="checkbox"/> | <input type="checkbox"/> |
| 02 Check window operation | <input type="checkbox"/> | <input type="checkbox"/> |
| 03 Check that engine starts with all keys | <input type="checkbox"/> | <input type="checkbox"/> |
| 04 Check that child safety door locks are in normal (unlocked) position* | <input type="checkbox"/> | <input type="checkbox"/> |
| 05 Check seats and seat belt operation | <input type="checkbox"/> | <input type="checkbox"/> |
| 06 Check rear defogger/rear view mirror defogger* | <input type="checkbox"/> | <input type="checkbox"/> |
| 07 Check side marker, tail, backup, cargo*, and license plate lights | <input type="checkbox"/> | <input type="checkbox"/> |
| 08 Check luggage compartment light* and trim appearance | <input type="checkbox"/> | <input type="checkbox"/> |
| 09 Adjust spare tire pressure, inspect for damage, and check jack and tool installation | <input type="checkbox"/> | <input type="checkbox"/> |
| 10 Check headlight aim | <input type="checkbox"/> | <input type="checkbox"/> |
| 11 Check battery state-of-charge using Digital Battery System Analyzer (SOC Reading: _____%) | <input type="checkbox"/> | <input type="checkbox"/> |
| UNDER HOOD | | |
| 01 Check engine oil and ATM* fluid levels | <input type="checkbox"/> | <input type="checkbox"/> |
| 02 Check brake and power steering fluid levels | <input type="checkbox"/> | <input type="checkbox"/> |
| 03 Check engine coolant level | <input type="checkbox"/> | <input type="checkbox"/> |
| 04 Check inverter coolant level | <input type="checkbox"/> | <input type="checkbox"/> |
| 05 Check windshield washer fluid level | <input type="checkbox"/> | <input type="checkbox"/> |
| 06 Inspect for fuel, oil, coolant, and other fluid leaks | <input type="checkbox"/> | <input type="checkbox"/> |
| BATTERY MAINTENANCE | | |
| 01 Perform HV battery check and maintenance | <input type="checkbox"/> | <input type="checkbox"/> |

| UNDER VEHICLE (ON HOIST) | OK | Adjust/Repair |
|--|--------------------------|--------------------------|
| 01 Remove disc brake anti-rust covers/anti-corrosion wheel film* | <input type="checkbox"/> | <input type="checkbox"/> |
| 02 Inspect tires for defects/damage | <input type="checkbox"/> | <input type="checkbox"/> |
| 03 Activate and Initialize Tire Pressure Warning System (TPWS) - see page 2 | <input type="checkbox"/> | <input type="checkbox"/> |
| 04 Install wheel covers/caps/spare tire wheel covers* | <input type="checkbox"/> | <input type="checkbox"/> |
| 05 Inspect for fuel, oil, coolant, and other fluid leaks | <input type="checkbox"/> | <input type="checkbox"/> |
| 06 Inspect under the vehicle for damage, rust, etc. | <input type="checkbox"/> | <input type="checkbox"/> |
| 07 Visually check bolts and nuts on chassis and powertrain for looseness | <input type="checkbox"/> | <input type="checkbox"/> |
| 08 Install rubber body plugs* | <input type="checkbox"/> | <input type="checkbox"/> |
| 09 Check hybrid transaxle fluid | <input type="checkbox"/> | <input type="checkbox"/> |
| ROAD TEST | | |
| <i>A complete road test helps assure customer satisfaction. Drive vehicle over a variety of road surfaces and driving conditions. Check for unusual noise and driving performance.</i> | | |
| Enter Odometer Reading | | |
| Reading Before Test: _____ Reading After Test: _____ | | |
| 01 Check cold engine operation | <input type="checkbox"/> | <input type="checkbox"/> |
| 02 Check engine operation during warm up | <input type="checkbox"/> | <input type="checkbox"/> |
| 03 Check engine at normal operating temperature | <input type="checkbox"/> | <input type="checkbox"/> |
| 04 Check hybrid transmission operation | <input type="checkbox"/> | <input type="checkbox"/> |
| 05 Check brake and parking brake operation | <input type="checkbox"/> | <input type="checkbox"/> |
| 06 Check steering operation and off-center/vehicle pull/flutter | <input type="checkbox"/> | <input type="checkbox"/> |
| 07 Inspect for abnormal noise and vibration | <input type="checkbox"/> | <input type="checkbox"/> |
| 08 Inspect for squeaks and rattles | <input type="checkbox"/> | <input type="checkbox"/> |
| 09 Check front and rear* heater and A/C operation | <input type="checkbox"/> | <input type="checkbox"/> |
| 10 Check cruise control operation* | <input type="checkbox"/> | <input type="checkbox"/> |
| 11 Check front seat heater/ventilation operation* | <input type="checkbox"/> | <input type="checkbox"/> |
| FINAL INSPECTION AND CLEANING | | |
| 01 Remove interior protective covers, unnecessary labels, tags, etc. (Remove just before delivery to customer) | <input type="checkbox"/> | <input type="checkbox"/> |
| 02 Visually inspect all interior parts for installation, damage, fit, dirt, etc. | <input type="checkbox"/> | <input type="checkbox"/> |
| 03 Verify floor mat application and install using retaining clips* | <input type="checkbox"/> | <input type="checkbox"/> |
| 04 Verify green light is illuminated on SOS (Safety Connect) button* | <input type="checkbox"/> | <input type="checkbox"/> |
| 05 Remove Rapgard™ and clear protective bumper film* | <input type="checkbox"/> | <input type="checkbox"/> |
| 06 Wash and clean vehicle | <input type="checkbox"/> | <input type="checkbox"/> |
| 07 Inspect paint finish for scratches, chips, rust, dents, damage, etc. | <input type="checkbox"/> | <input type="checkbox"/> |
| 08 Inspect exterior body parts for proper installation, damage, rust, etc. | <input type="checkbox"/> | <input type="checkbox"/> |
| 09 Place oil change sticker on inside of windshield, top left corner | <input type="checkbox"/> | <input type="checkbox"/> |
| 10 Install front license plate and mounting bracket* - see page 2 | <input type="checkbox"/> | <input type="checkbox"/> |
| 11 Place Owner's Guide and first aid kit portfolio* in glove box | <input type="checkbox"/> | <input type="checkbox"/> |
| 12 Perform Techstream Health Check | <input type="checkbox"/> | <input type="checkbox"/> |
| * Inspect or install when equipped/required. | | |

Completion and retention of this form is required to comply with Toyota's Warranty Policy.

TECHNICIAN'S SIGNATURE _____

SERVICE MANAGER'S SIGNATURE _____

NAME (PLEASE PRINT) _____

NAME (PLEASE PRINT) _____

We hereby certify that all items on this form have been checked and corrected for proper operation as required.

Date

Dealer Name

Dealer Code

Vehicle Identification Number (Sticker)

SHORT PIN INSTALLATION

To minimize battery discharge the Short Pin has been removed and is stored in the engine compartment Relay Block. Install the Short Pin and confirm all related DTCs are cleared.

DTC Clearing Procedure

1. Connect Techstream to DLC3.
2. Cycle the ignition switch to the "IG-ON" position.
3. Using Techstream, check any other codes being output.
4. Erase DTCs (B1650, B1794, U0142, and U0155) and freeze frame data.

NOTE

If any DTCs besides B1650 & B1794 remain, repair the applicable system according to the Repair Manual.

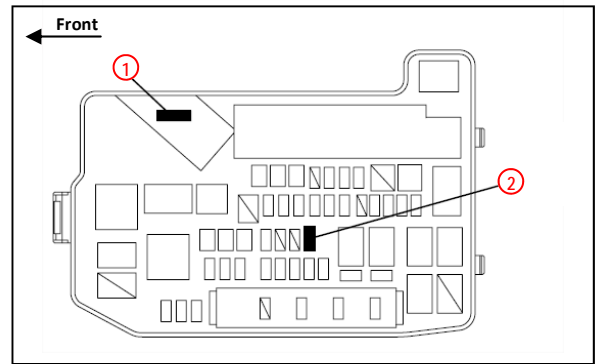

- 1 Storage Location
2 Installation Location

TPWS ACTIVATION AND INITIALIZATION

Activation Procedure

1. Connect Techstream to DLC3.
2. Cycle the IG switch to the "IG-ON" position and check that the Low Tire Pressure Warning Light blinks for 1 minute and then remains illuminated.
3. Press or remove the valve core to reduce the tire inflation pressure rapidly by 6 psi (0.4 kgf/cm², 40 kPA), or more, within 30 seconds.
4. Using Techstream, check for DTCs (C2111-C2114). If no DTCs are stored, continue to step 5. If these DTCs are stored, repeat step 3.
5. Adjust all tires to the standard tire inflation pressure, as indicated on the Tire and Loading information label inside the driver's door jamb.
6. Check the tire pressure values of all the tires using Techstream. **TPWS ECU / Datalist / TIREPRESS 1-4**

NOTE

If DTCs C2111-C2114 are present after repeating step 3, lift the vehicle and rotate each tire so that the tire pressure warning valve/sensor is at the top of the wheel well. Then repeat step 3.

Initialization Procedure

Refer to the Repair Manual for the [Initialization procedure](#).

NOTE

If performing this procedure in areas with temperatures significantly colder or warmer than shop temperatures, follow the instructions in [\(T-SB-0020-12\)](#).

FRONT LICENSE PLATE AND MOUNTING BRACKET INSTALLATION

1. Align holes "A" of the mounting bracket with the dimples on the front bumper cover. Mark the location of holes "B" in the front bumper cover.

NOTE

- Holes "A" are used for installation of the mounting bracket to the bumper cover.
- Holes "B" are used for installation of the front license plate to the mounting bracket.

2. Drill two relief holes with a diameter of 11 mm (0.43 in.) at the hole "B" marks on the front bumper cover to prevent the license plate retaining bolt from contacting the cover.
3. Install the mounting bracket to the front bumper cover by attaching the two self-tapping screws into the dimples.
4. Install the front license plate to the mounting bracket using bolts with the following dimensions.

Length: 20.0—25.0 mm (0.79—0.98 in.)

Diameter: 6.0 mm (0.24 in.)

Pitch: 1.0 mm (0.04 in.)

NOTICE

- Do NOT pre-drill holes into the bumper.
- Do NOT over-tighten the self-tapping screws.

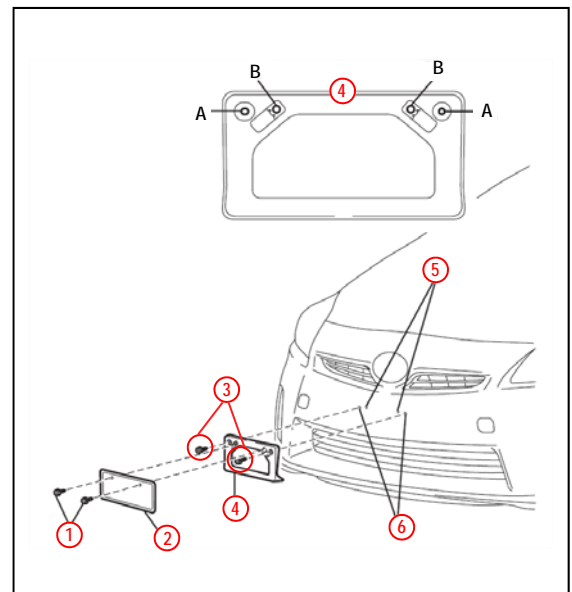

- 1 Bolts
2 License Plate
3 Self-tapping Screws
4 Mounting Bracket
5 Mark and Drill Holes
6 Dimples