

1 8 07-12



Service Information Bulletin

| SUBJECT | DATE |
|---|-------------|
| Removal and Installation of the GHG14 Diesel Exhaust Fluid Dosing Unit Inlet Screen | August 2012 |

Additions, Revisions, or Updates

| Publication Number / Title | Platform | Section Title | Change |
|----------------------------|-------------|---|------------------------|
| DDC-SVC-MAN-0083 | DD Platform | Removal of the GHG14 Diesel Exhaust Fluid Dosing Unit Inlet Screen | These are new sections |
| | | Installation of the GHG14 Diesel Exhaust Fluid Dosing Unit Inlet Screen | |



13400 Outer Drive, West, Detroit, Michigan 48239-4001
 Telephone: 313-592-5000
www.demanddetroit.com

2 Removal of the GHG14 Diesel Exhaust Fluid Dosing Unit Inlet Screen

Remove as follows:

1. Remove fairings to gain access to the dosing unit if present.
2. Disconnect the Diesel Exhaust Fluid (DEF) inlet and outlet lines from the dosing unit.
3. Remove the two bolts (1) fastening the DEF flange (2) to the dosing unit (5) and remove DEF flange (2).

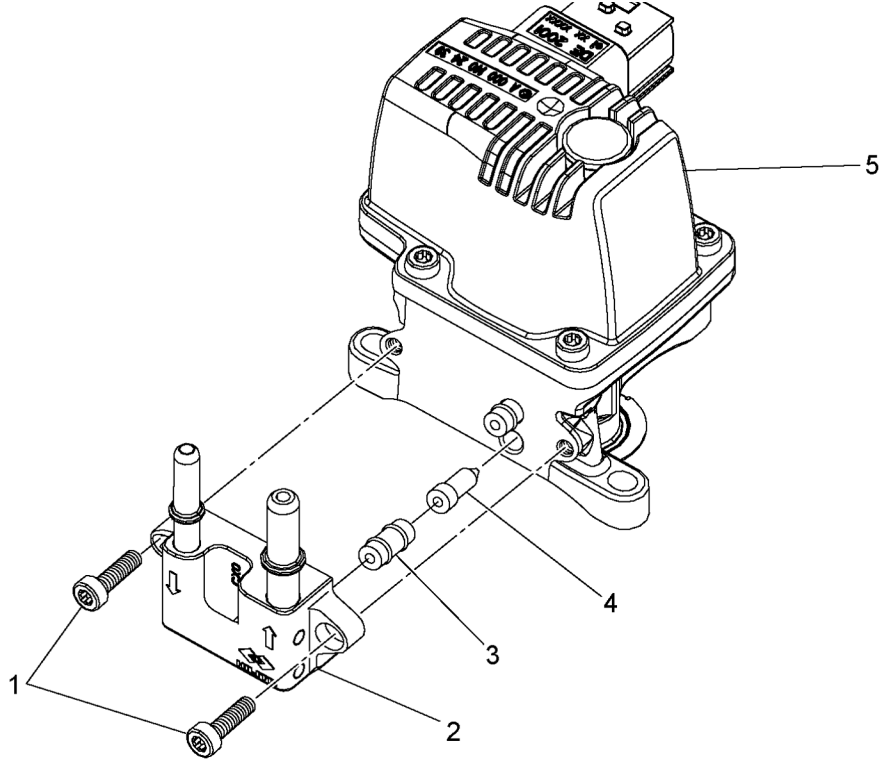

d140407

4. Remove the DEF flange seal (3).

NOTE: DEF doser inlet screen (4) is pressed into bore, not screwed.

5. Remove the DEF doser inlet screen (4).

3 Installation of the GHG14 Diesel Exhaust Fluid Dosing Unit Inlet Screen

Install as follows:

1. Install the Diesel Exhaust Fluid (DEF) doser inlet screen (4).
2. Install the DEF flange seal (3).
3. Install the DEF flange (2) to the DEF dosing unit and torque the two bolts (1) to 7-8 N·m (5-6 lb·ft).

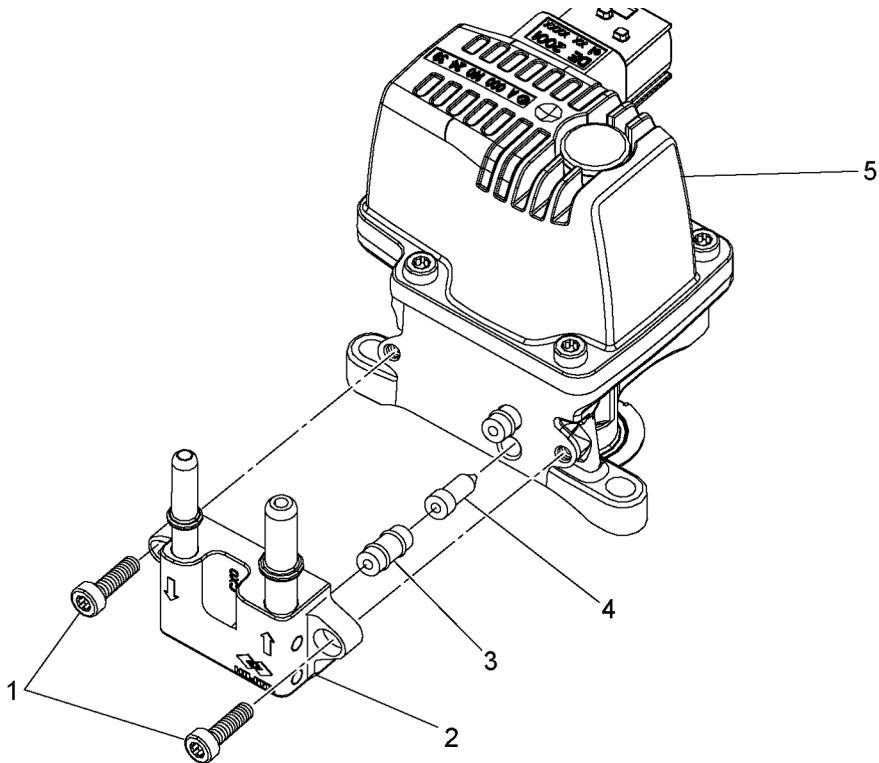

d140407

4. Connect the DEF supply line to the DEF dosing unit.