

REFERENCE:	Nova Bus Manuals
SECTION:	10 Allison Electric Drive EP-40 System
RS N°:	MQR 7621-479
EFFECTIVE IN PROD.:	–

APPLICATION DEADLINE: 2013NO14

SUBJECT:	Removable roof panels on the hybrid vehicle
JUSTIFICATION:	The bolts on the removable roof could become loose, which could allow the wind to lift the roof.

LEVEL	DESCRIPTION	DIRECT CHARGES		TIME
		LABOUR	MATERIAL	
1	Modification to the closure system of the removable roof canopy.	Nova Bus	Nova Bus	45 min
2	–	–	–	–

MATERIAL

QTY	PART N°	REV.	DESCRIPTION	REPLACES PART N°
LEVEL 1				
6	N69892	–	Safety support for the HEV removable roof	–
LEVEL 2				
–	–	–	–	–

Materials will be available within 21 days. To order, please contact Prevost Parts by phone at 1-800-771-6682, by fax at 1-888-668-2555 or by email at prevostparts.commandes@volvo.com. Specify document number, quantity of parts required and shipping address.

DISPOSAL OF PARTS

REMOVED PARTS ARE:	DISCARDED	RETAINED	–
	–	–	

REVISION HISTORY

REV.	DATE	CHANGE DESCRIPTION	WRITTEN BY
NR	2012AU17	Initial release	Danielle Lacroix

CLIENT	ORDER	ROAD NUMBER		VIN (2NVY/4RKY...)		QTY
		FROM	TO	FROM	TO	
Bow Valley Transit - Alberta	L347	1	4	L82W083000175	L82W683000178	4
Brantford - Ontario	L547	10101	10105	L82X6A3000082	L82X3A3000086	5
CMBC (TransLink) - British Columbia	L412	9401	9401	L82X993000136	L82X993000136	1
CMBC (TransLink) - British Columbia	L454	9402	9470	L82X793000359	L82XX93000453	69
CMBC (TransLink) - British Columbia	L455	9471	9491	L82X093000459	L82X993000489	21
CMBC (TransLink) - British Columbia	L482	9492	9517	L82X894000040	L82X094000064	25
CMBC (TransLink) - British Columbia	L483	9518	9542	L82X294000065	L82X594000089	25
Connecticut Transit - Connecticut	L571	1066	1075	S92YXB4000144	S92Y4B4000169	10
Duke University - North Carolina	L651	—	—	S92Y1B4000145	S92Y3B4000146	2
Grand River Transit - GRT - Ontario	L405	8022	8027	L82W683000259	L82WX83000264	6
Grand River Transit - GRT - Ontario	L599	—	—	L82X9B3000465	L82X2B3000467	3
Grand River Transit - GRT - Ontario	L631	—	—	L82X4B3000468	L82X2B3000470	3
Marketing Sales Demo - MSD 1 ISB Hybrid	L548	—	—	L82X5A3000087	L82X5A3000087	1
Marketing Sales Demo - MSD 5	L619	—	—	L82X7C3000367	L82X7C3000367	1
Marketing Sales Demo - MSD Hybrid	L596	—	—	L82X2B3000212	L82X2B3000212	1
Strathcona County Transit - Alberta	L407	940	943	L82W083000273	L82W683000276	4
Strathcona County Transit - Alberta	L524	3005	3010	L82X593000604	L82X493000609	6

**WARNING**

Follow your internal safety procedures.

PROCEDURE

1. INSTALLATION OF SAFETY SUPPORT

1.1. Locate the removable canopy at the rear of the vehicle. See Figure 1.

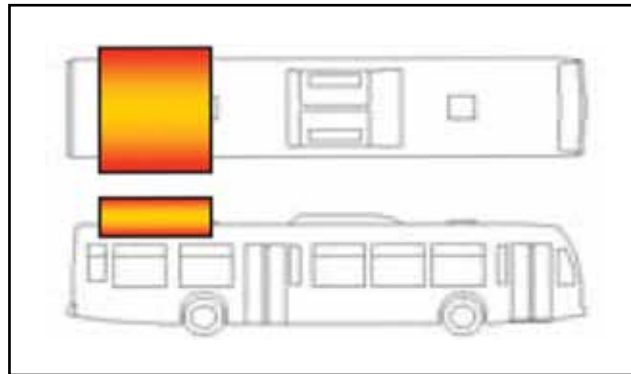

Figure 1 - Location of the Removable Canopy

1.2. Remove the air intake grill located on the streetside of the vehicle. See Figure 2.

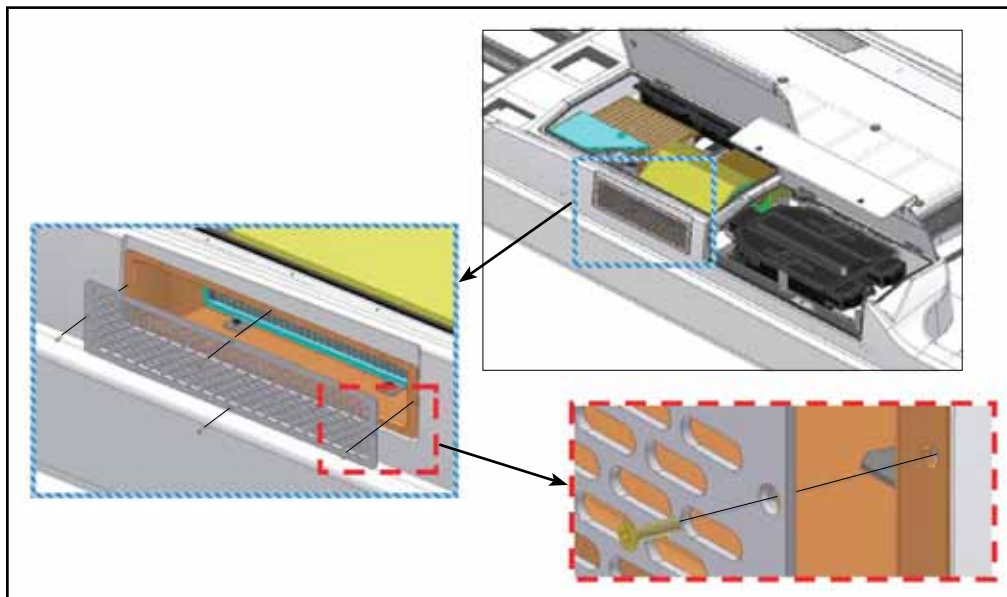

Figure 2 - Air Intake Grill (Streetside of the Vehicle)

1.3 Remove the filter. See Figure 3.

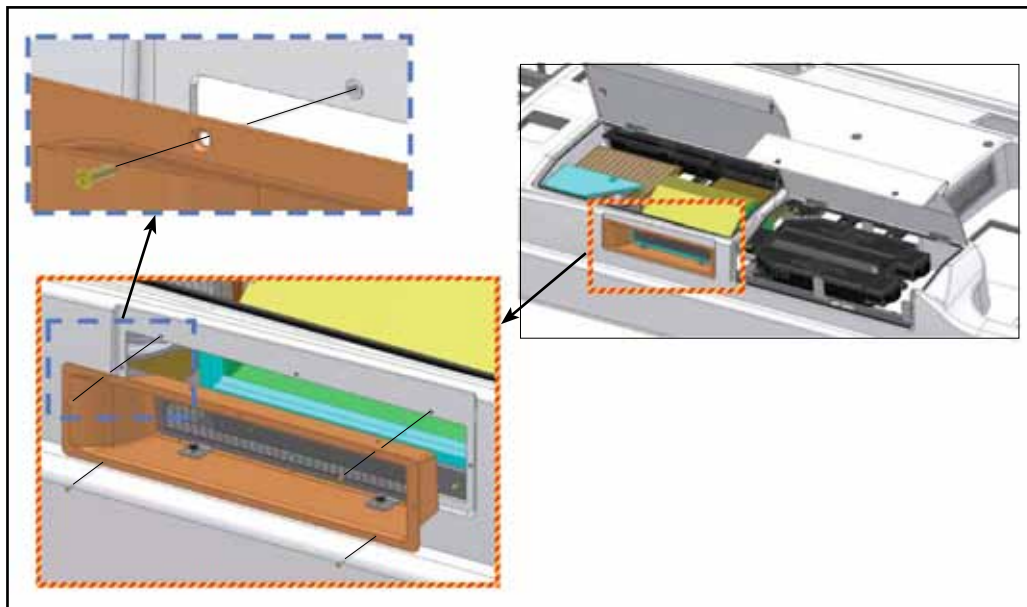

Figure 3 - Filter (Streetside of the Vehicle)

1.4 Remove the covers of the three access panels located on the curbside of the vehicle. See Figure 4.

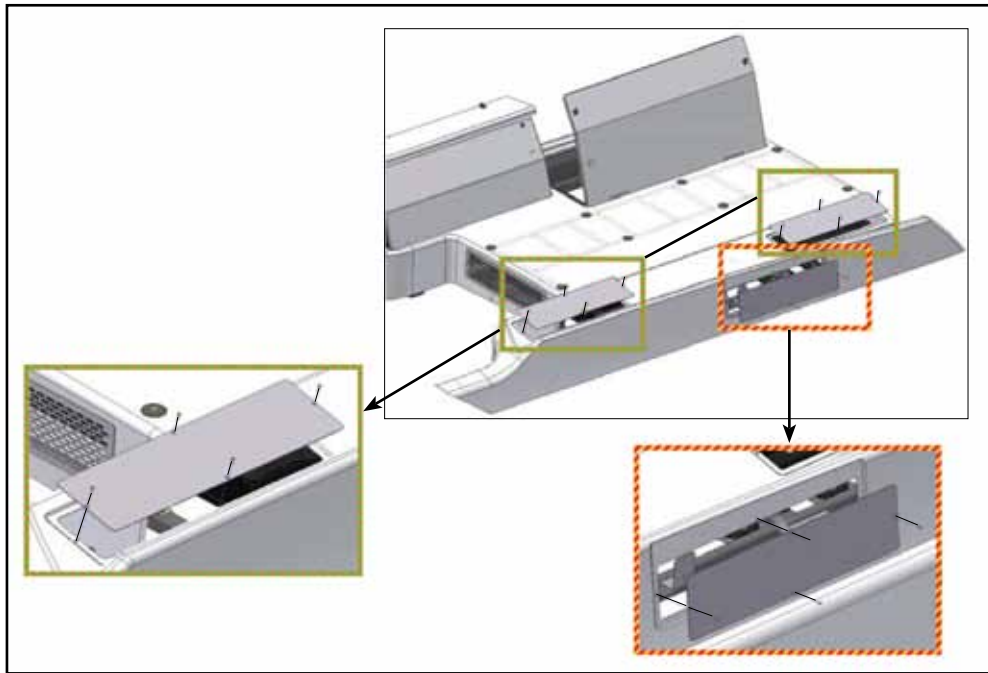

Figure 4 - Access Panels (Curbside of the Vehicle)

1.5. Loosen the nuts on the threaded rods on both sides of the vehicle (6 in total). See Figures 5 and 6.

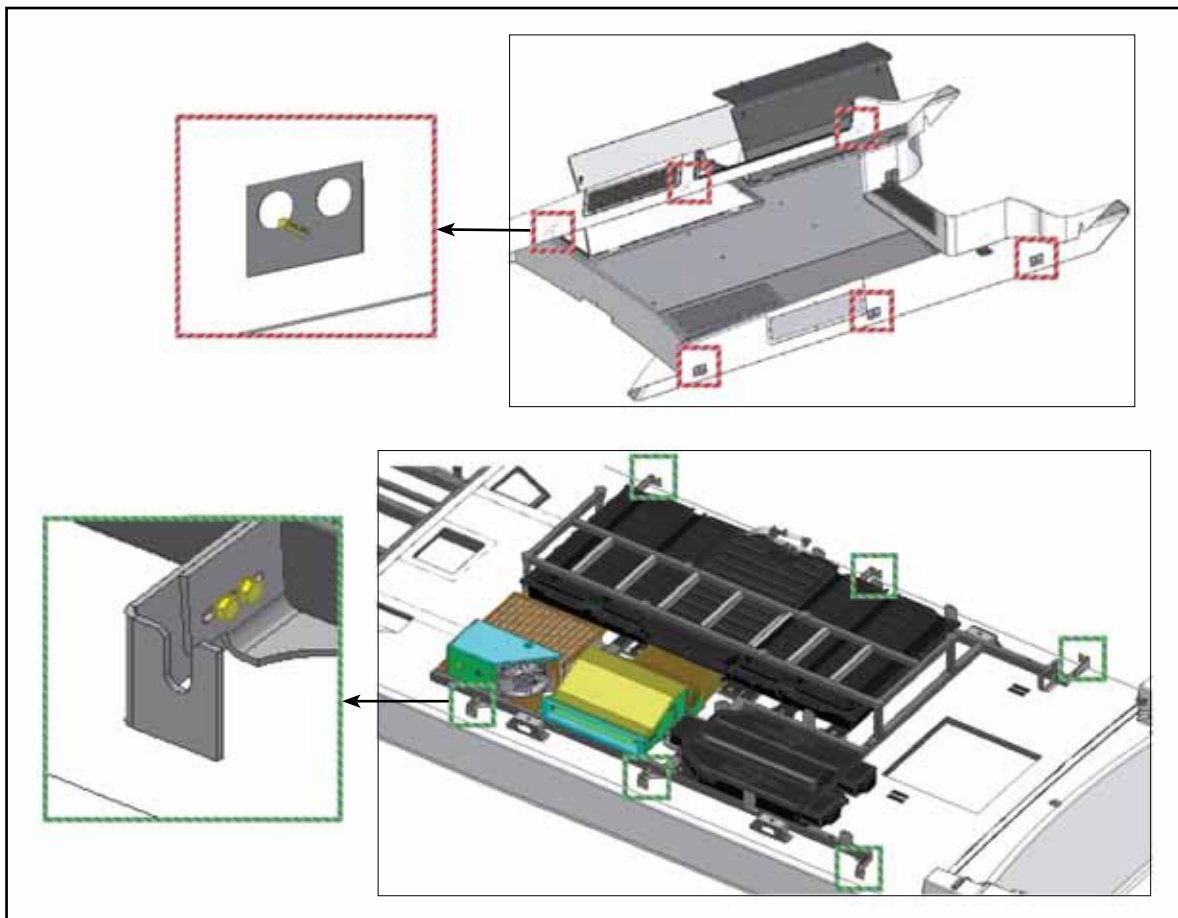

Figure 5 - Position of the Roof Restraint Supports

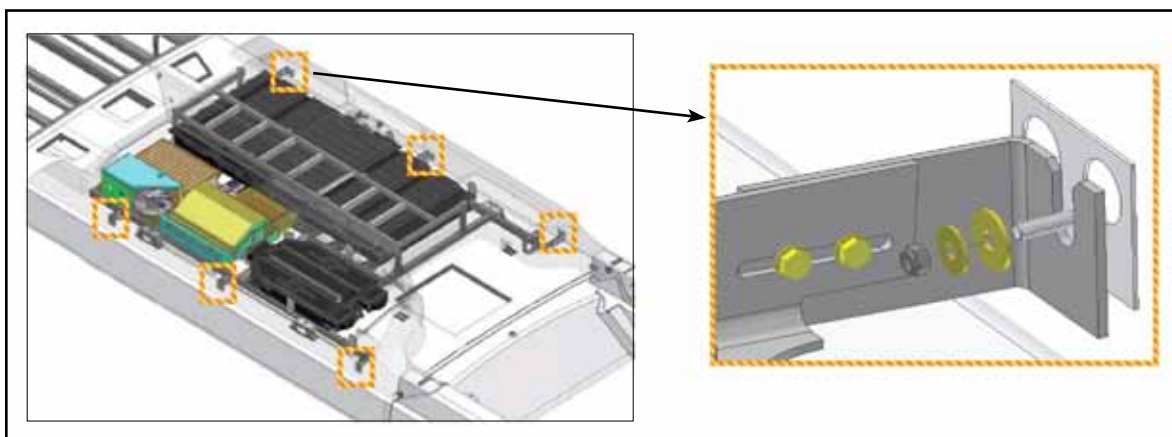

Figure 6 - Threaded Rods Fit in the Support Channel

1.6. Install the safety support by pushing lightly on the removable roof. See Figure 7.

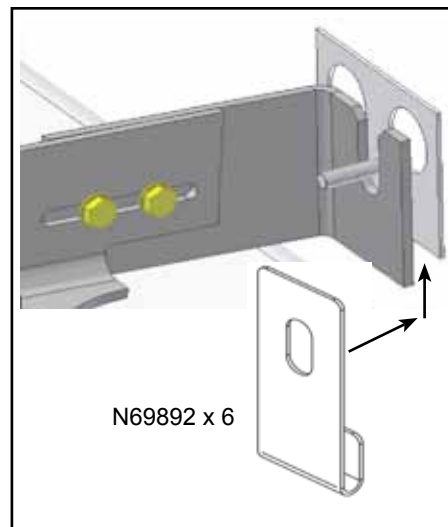

Figure 7 - Installation of the Safety Support

1.7. Replace the washers and the nut. See Figure 8.

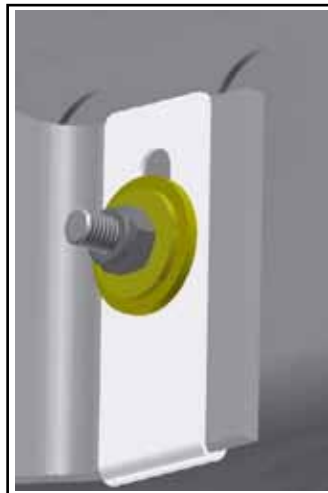

Figure 8 - Final Appearance

- 1.8. Repeat steps 1.5 to 1.7 for the five other rods.
1.9. Reinstall the retained parts and close the access panels.

❖