

# SERVICE INFORMATION BULLETIN

**Subject:**  
**INSTALLATION PROCEDURE FOR CRANKCASE BREATHER**  
**ANTI FREEZING KIT**

This document is to inform dealers and workshops on the installation procedures for a crankcase breather (ventilator) anti freezing kit.

## 1. RELEVANT MODELS

2008 J05D-TF and J08E-TV, TW engines.

## 2. CONTENTS

This anti freezing kit is to prevent water (condensation) from freezing, and keep the breather and hoses warm.

This bulletin contains information on the removal and installation procedures, and the parts needed for both engine models.

A breather cap is installed, and urethane hoses are installed around the original breather hoses and pipes.

The parts consist of urethane hoses, bands, cap, bolts, and spacers.

## 3. PARTS LIST

No.	Parts name	For J08E-TV, TW Engine		For J05D-TF Engine	
		Parts No.	Number	Parts No.	Number
	Breather & Accessory Kit	88900E0010	1	88900E0020	1
1	Urethane hose	12261E0050	1	12261E0560	1
2	Urethane hose	12261E0550	1	12261E0550	1
3	Urethane hose	12261E0090	1	12261E0570	1
4	Band	S478371230	*40	S478371230	*40
5	Cap	12272E0010	1	12272E0010	1
6	Bolt	SH55210825	3	SH55210825	4
7	Spacer	SZ91016099	3	SZ91016099	4

\* The necessary number of bands increases and decreases with the method of installation.

# SERVICE INFORMATION BULLETIN

## 4. PROCEDURE

J08E-TV  
J08E-TW

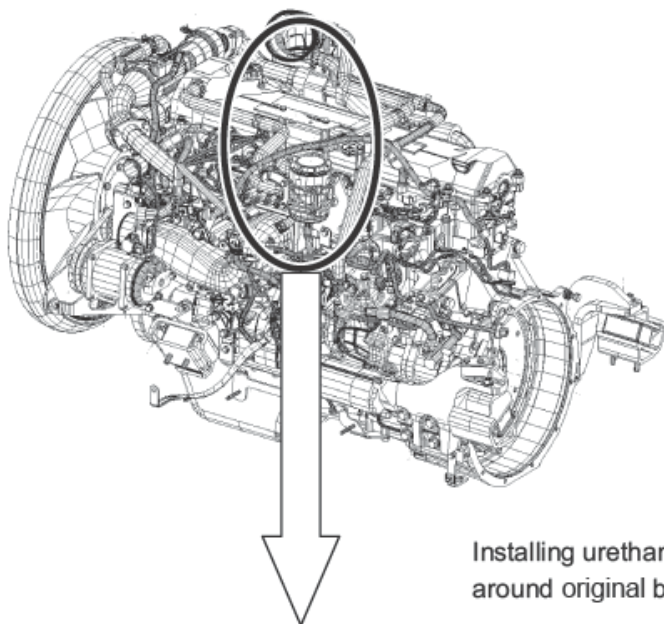

J05D-TF

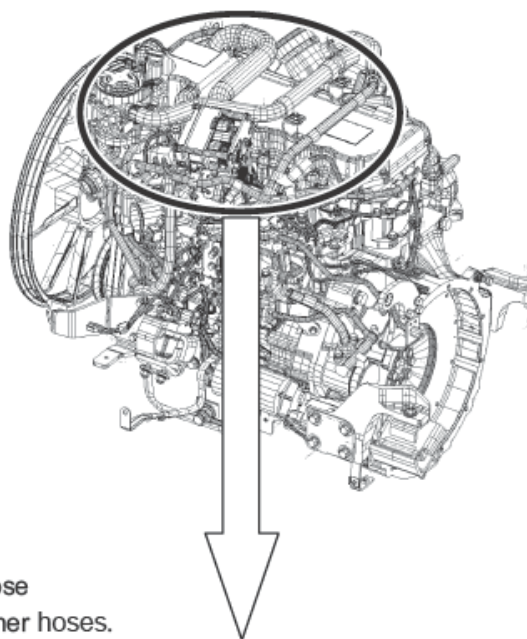

Installing urethane hose  
around original breather hoses.

Before installation

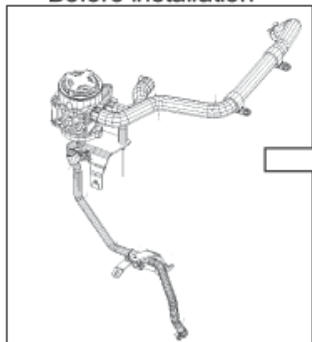

After installation

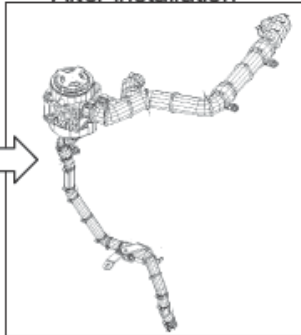

Before installation

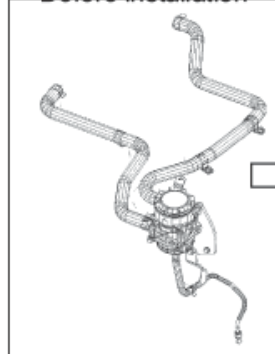

After installation

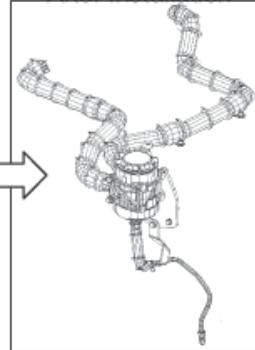

# SERVICE INFORMATION BULLETIN

## J08E-TV and J08E-TW

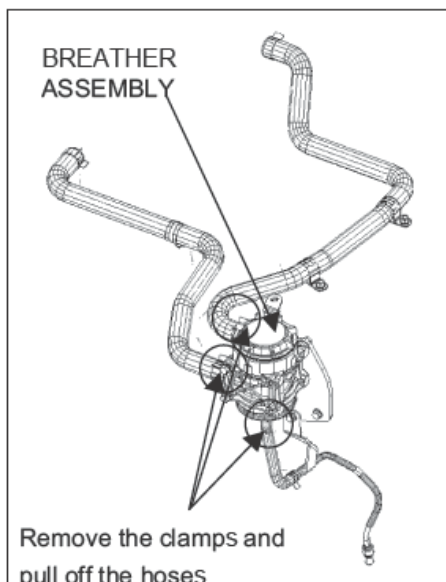
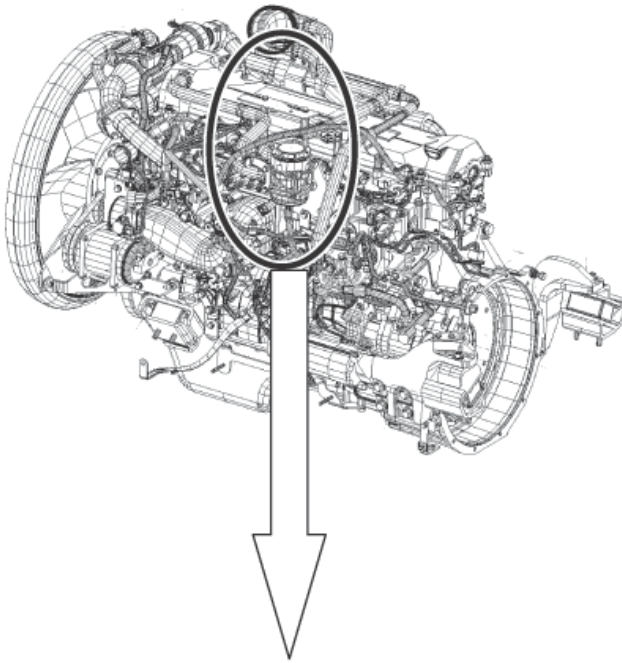

- 1) Remove the clamps from the hoses attached to the breather assembly, and remove the hoses from the breather.

**NOTE:** *The removed clamps will be reused.*

- 2) Remove the bolts securing the breather assembly, and remove the assembly from the bracket.

# SERVICE INFORMATION BULLETIN

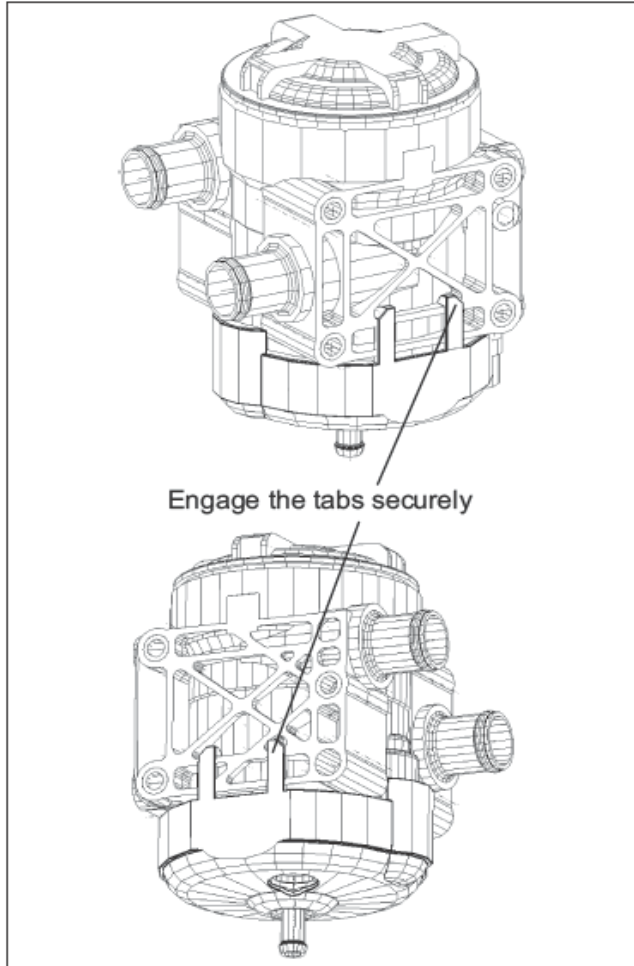

- 1) Install the breather cap onto the breather assembly.

**Cap part # 12272E0010**

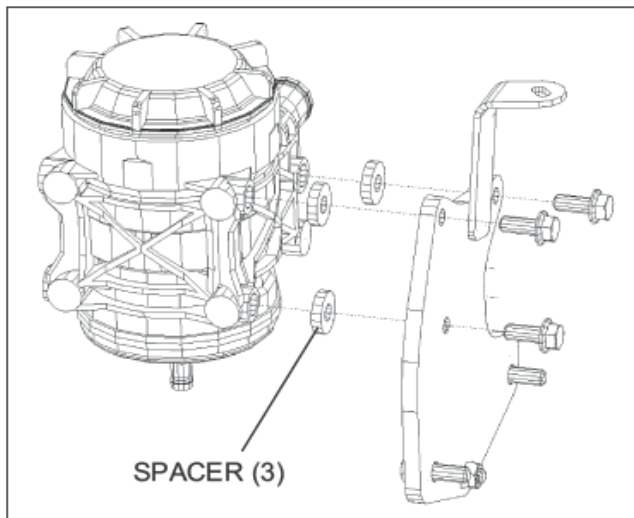

- 2) Install the spacers between the bracket and the breather. Replace the bolts and tighten the assembly.

**Bolt part # SH55210825**  
**Spacer part # SZ91016099**

**Tightening torque 21ft-lbf (28.5N-m)**

## SERVICE INFORMATION BULLETIN

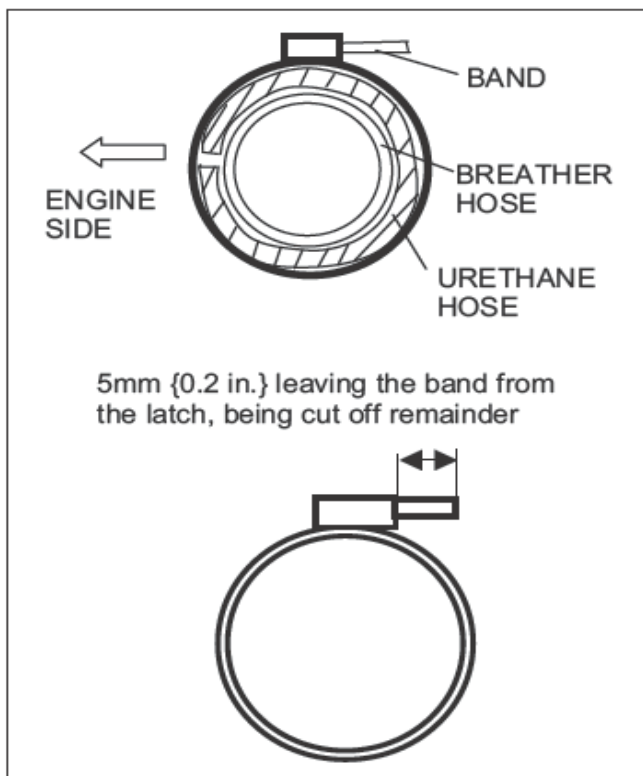
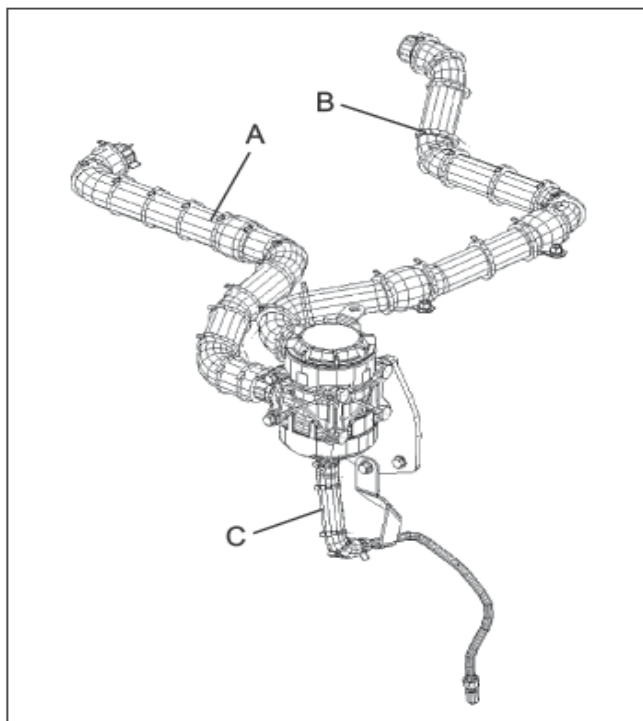

3) Install the removed breather hoses onto the breather, and clamp then in their original positions.

4) Install the urethanes hoses on top of the original breather hoses and pipe.

**Urethane hose A = Part # 12261E0050**  
**L=26.7 in. (680mm)**

**Urethane hose B = Part # 12261E0550**  
**L=34.6 in. (880mm)**

**Urethane hose C = Part # 12261E0090**  
**L=7.1 in. (180mm)**

**Band Part # S478371230**

**NOTE:** *The cut side of the urethane hoses faces the engine. Install the urethane hoses around any intermediate clamps of the breather hoses.*

Use the following guidelines for the binding positions.

- A) 0.4 (10mm) from both ends of the urethane hose.
- B) Center position of pipe and hose bends.
- C) Both ends of intermediate hose securing clips.

**CAUTION:** *When securing the urethane hoses use a suitable number of bands so that the urethane hoses do not open. Sufficient protection against cold is not obtained when the urethane hoses are open. It is also possible that dirt etc, may enter and damage the hoses and pipes. If there is any excess urethane hose at the end of installation (hose too long), trim as needed.*

# SERVICE INFORMATION BULLETIN

## J05D-TF

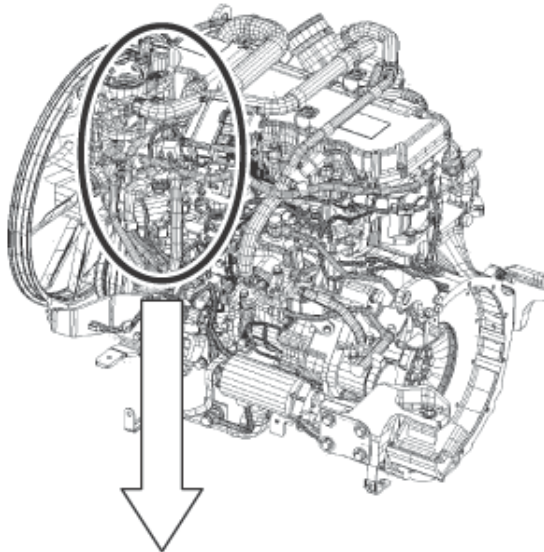

BREATHER ASSEMBLY

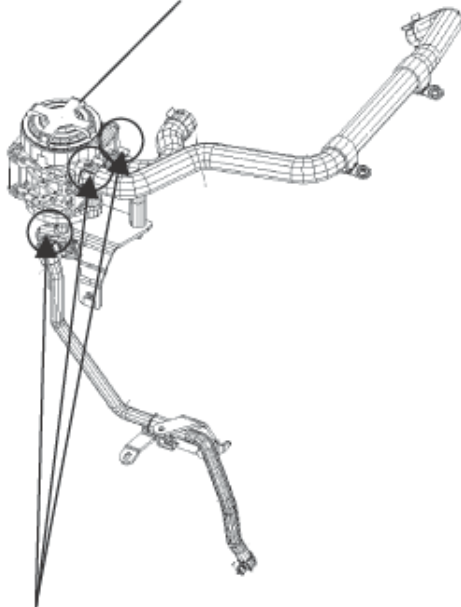

Remove the clamps  
and pull off the hoses

- 1) Remove the clamps from the hoses attached to the breather assembly, and remove the hoses from the breather.

**NOTE:** *The removed clamps will be reused.*

- 2) Remove the bolts securing the breather assembly, and remove the assembly from the bracket.

# SERVICE INFORMATION BULLETIN

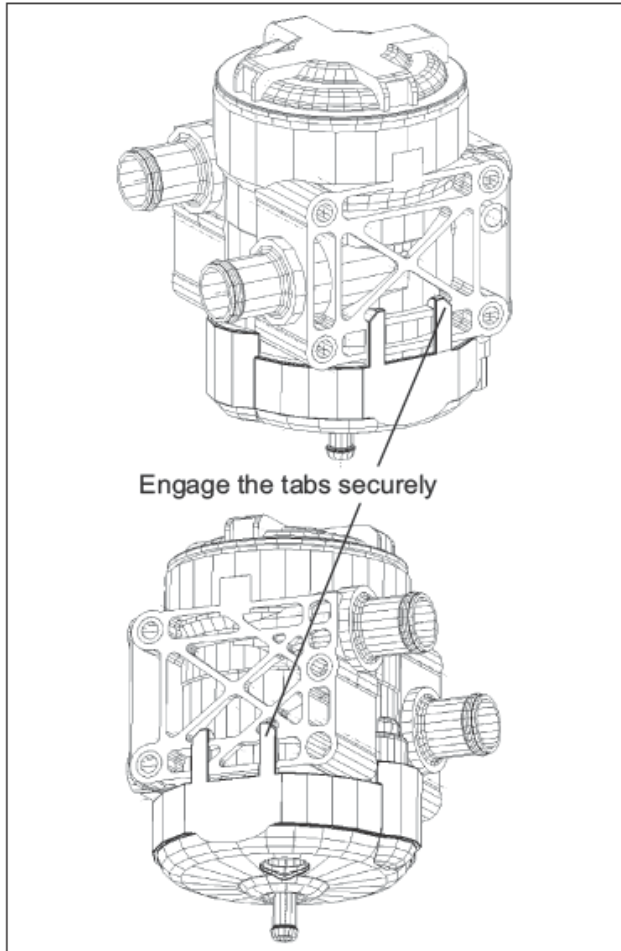

- 1) Install the breather cap onto the breather assembly.

**Cap part # 12272E0010**

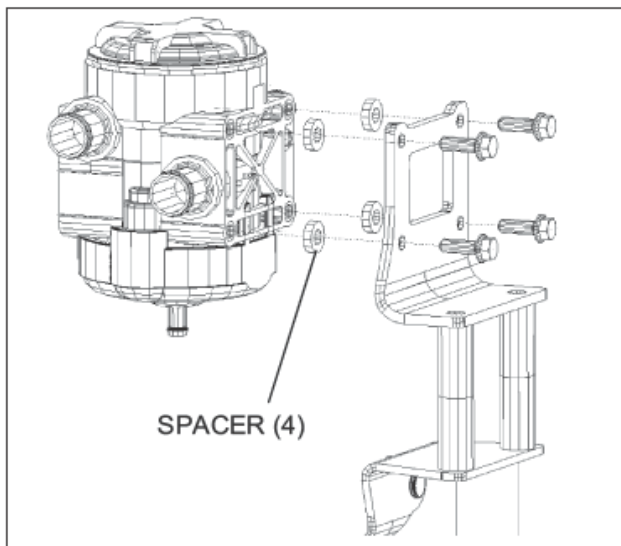

- 2) Install the spacers between the bracket and the breather. Replace the bolts and tighten the assembly.

**Bolt part # SH55210825**  
**Spacer part # SZ91016099**

**Tightening torque 21ft-lbf (28.5N-m)**

## SERVICE INFORMATION BULLETIN

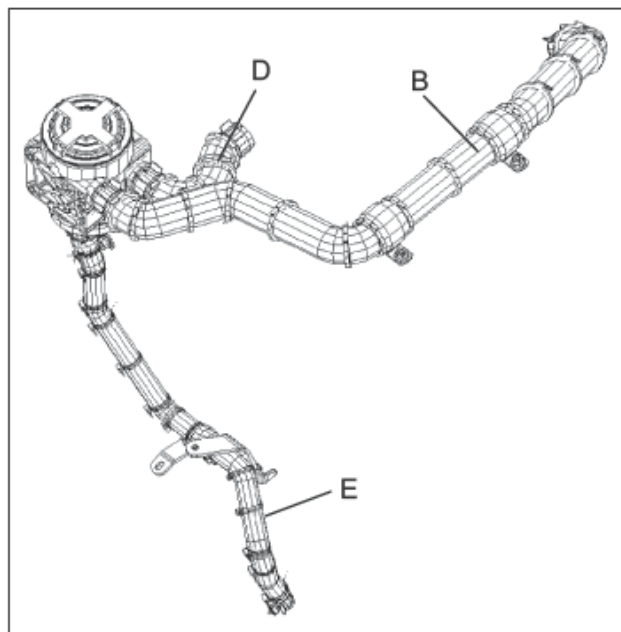

3) Install the removed breather hoses onto the breather, and clamp then in their original positions.

4) Install the urethane hoses on top of the original breather hoses and pipe.

Urethane hose B = Part # 12261E0550  
L=34.6 in. (880mm)

Urethane hose D = Part # 12261E0560  
L= 7.1 in. (180mm)

Urethane hose E = Part # 12261E0570  
L=29.5 in. (750mm)

Band Part # S478371230

**NOTE:** The cut side of the urethane hoses faces the engine. Install the urethane hoses around any intermediate clamps of the breather hoses.

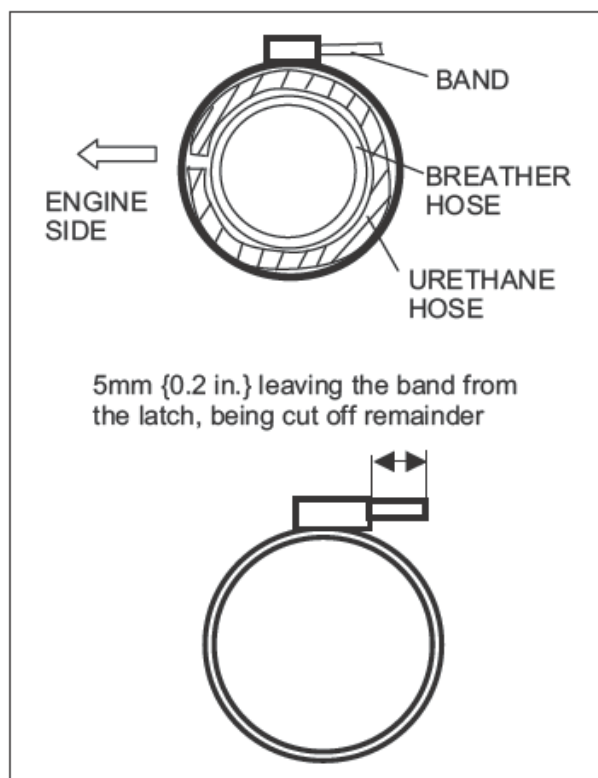

Use the following guidelines for the binding positions.

- A) 0.4 (10mm) from both ends of the urethane hose.
- B) Center position of pipe and hose bends.
- C) Both ends of intermediate hose securing clips.

**CAUTION:** When securing the urethane hoses use a suitable number of bands so that the urethane hoses do not open. Sufficient protection against cold is not obtained when the urethane hoses are open. It is also possible that dirt etc, may enter and damage the hoses and pipes. If there is any excess urethane hose at the end of installation (hose too long), trim as needed.