

CSC-10043225-9059

March 07, 2006

Dear Blue Bird Owner:

You will find enclosed Service Bulletin S06KH regarding the air operated entrance door emergency release lever.

During entry or exit on the Blue Bird "Vision" bus, passengers' jacket pockets, book bag straps etc., may snag the front dash mounted emergency release lever for air power entrance doors. A guard has been designed to prevent accidental snagging and tripping of the entrance door emergency release lever.

Service Bulletin S06KH should be performed by a qualified repair technician. You may contact your appropriate Blue Bird distributor for assistance.

Parts for Service Bulletin S06KH are available from your usual Blue Bird service parts source.

Time allowed to perform Service Bulletin S06KH is 0.2 hr. (12 minutes) per bus.

Service Bulletin S06KH expires one year from date of issue.

If you no longer own the bus (es) identified on the enclosed cover sheet, please indicate new owner in the "sold to" section of the cover sheet and return to us at the address below:

BLUE BIRD BODY COMPANY
P.O. BOX 937
FT. VALLEY GA 31030
ATTN: TECHNICAL PUBLICATIONS

Should you have any questions concerning this bulletin, please contact your Blue Bird distributor.

Sincerely,

Bill Coleman
Blue Bird Corporation



Air Door Switch Guard

MODELS AFFECTED: BBCV with Option 0022202, Emergency Release, Air Powered Doors Relocation

ISSUE

During entry or exit, passengers' jacket pockets, book bag straps, etc., may snag the front dash mounted emergency release lever for air powered entrance doors.

CORRECTIVE ACTION

This procedure describes installation of a guard to prevent accidental snagging and tripping of the emergency release lever.

PROCEDURE

- 1** Secure the bus for service: Park vehicle on level surface. Apply parking brake. Turn off ignition. Remove key.
- 2** Remove the two 10-16 x 3/4" screws which secure the Air Entrance Door Emergency Release plate. Remove the plate.
- 3** Position the slot of the provided guard (part number 0101720) over the emergency release lever and align the two mounting holes. Position the slot of the Air Entrance Door Emergency Release Plate over the emergency release lever and align the mounting holes. Reinstall the two screws removed in step 2.
- 4** Operate the switch to inspect for proper operation. This procedure is complete, and the bus may be returned to service.

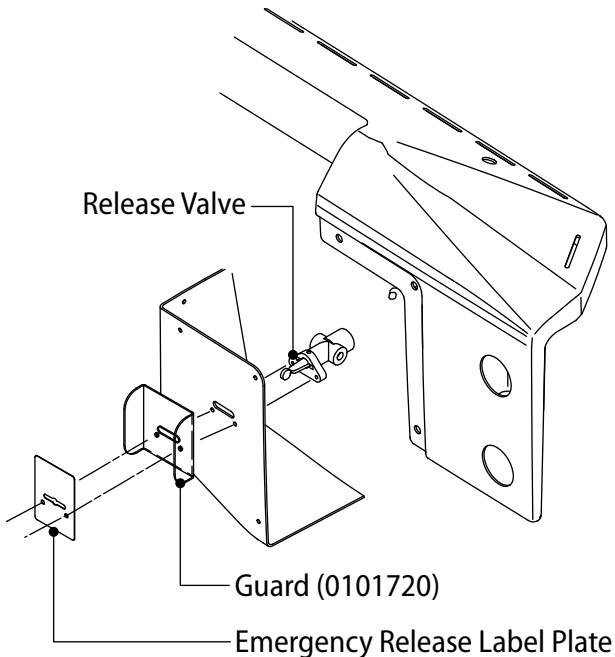

Finished installation

PART NUMBER	QUANTITY	DESCRIPTION
0101720	1	Guard, Emergency, Release, Entrance Door, BBCV