

RECALL 26V130 & 2026-103 REMEDY INSTRUCTIONS

 FOREST RIVER	Make(s): Impression Model(s): See Below Model Year(s): 2026	Repair Code: RC-003-09-00-004813 Allotted Time: .30 HRS Inspection Code: N/A Allotted Time: N/A
	Concern: The wire sheathing may allow conductors to not make adequate contact with the lugs in the 50AMP inlet.	Photo(s) Required: NO Prior Authorization Required: YES Part(s) Kit Number: N/A Part(s) Return: N/A

Turn off LP Gas at LPG Tank(s). Disconnect the vehicles' battery Positive and Negative, disconnect any House battery(s) Positive and Negative, if equipped with a generator ensure it is off and lastly, ensure the vehicle is disconnected from shore power. Block any tires/wheels to prevent the vehicle from rolling. Failure to do so may result in electrocution, fire or other personal injury, property damage and/or death.

CERTAIN 2026 – IMPRESSION: MPF235RW, MPF301ML, MPF315MB, MPF318RL, MPF360MYR, MPF36BR3 & MPF44STAY

REPAIR

STEP 1: REMOVE EXTERIOR 50AMP INLET;

STEP 2: INSPECT THE HOT(S), NEUTRAL AND GROUND FOR PROPER DEPTH OF SHEATHING REMOVAL;

- IF CORRECT, REASSEMBLE AND ENSURE TO RE-TORQUE EACH LUG ACCORDING TO THE FIGURE BELOW, CLAIM INSPECTION CODE ONLY;
- IF INCORRECT, REMOVE THE PROPER AMOUNT OF SHEATHING, REASSEMBLE AND ENSURE TO RE-TORQUE ACCORDING TO THE FIGURE BELOW;
- **REFERENCE THE INCLUDED INSTALLATION INSTRUCTIONS REFERENCING THE 50AMP INLET**

STEP 3: REINSTALL THE 50AMP INLET INTO ITS OPENING;

STEP 4: TEST FUNCTIONALITY;

STEP 5: CLAIM REPAIR CODE.

FIGURES:

50AMP INLET – TORQUE SPECIFICATION
25 – 45 INCH-POUNDS

Locking 50 Amp 125/250V Easy-Pro Inlet Installation Instructions



03062024SS2EZ

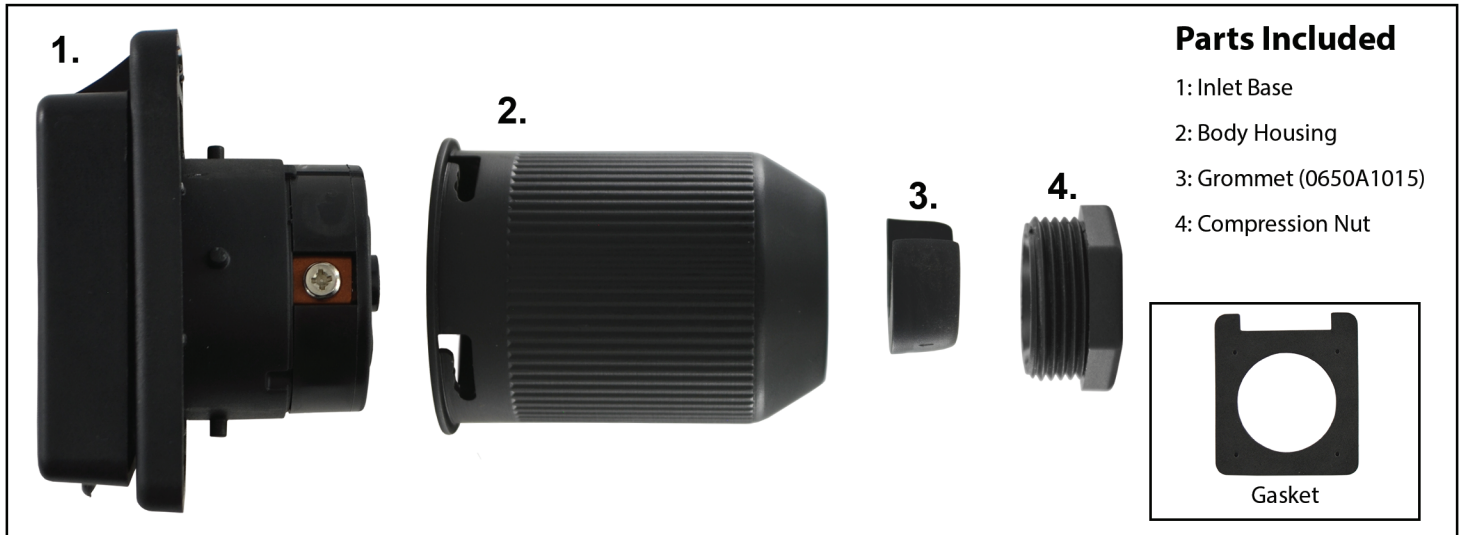

WARNING:

To prevent electrocution, make sure that the inlet is not connected to a power source before installation. Failure to comply with the following instructions could cause an electrical failure or fire.

Recommended Installation Tools

- Pencil
- Electric Drill
- 2-3/4" Hole Saw
- 1/8" Drill Bit
- (4)#8 Screws Stainless Steel (*Installer to provide*)
- Phillips Screw Bit
- SQ2 (3.0mm*3.0mm) Square Lug Screw Bit
- Wire Strippers
- 30/50A Inlet Wrench

Mounting Inlet to RV Directions

1. Determine hull mounting location. Make sure that the mounting location is clear of any plumbing, electrical wiring or other obstruction.
2. Cut an opening in the hull using a 2-3/4" diameter hole saw.
3. Set the inlet flush into the hole drilled. Using the inlet as a guide, mark the mounting hole locations. Drill mounting holes using a 1/8" drill bit.
4. Pull the internal wiring through to wire the inlet. (**See back for inlet wiring instructions**)
Please Note: Conntek 50 Amp inlet requires 6AWG wire. Using smaller gauge wire will result in overheating and could lead to a fire.
5. Once the inlet is wired correctly, position the gasket and inlet over the hull opening.
6. Align to the mounting holes. Using the #8 Screws(4) to install and mount the inlet.

Wiring Inlet Guide

03062024SS2EZ



1. Turn body housing counter clockwise to detach from inlet base.
2. Loosen compression nut to remove the grommet. Set aside for later use.

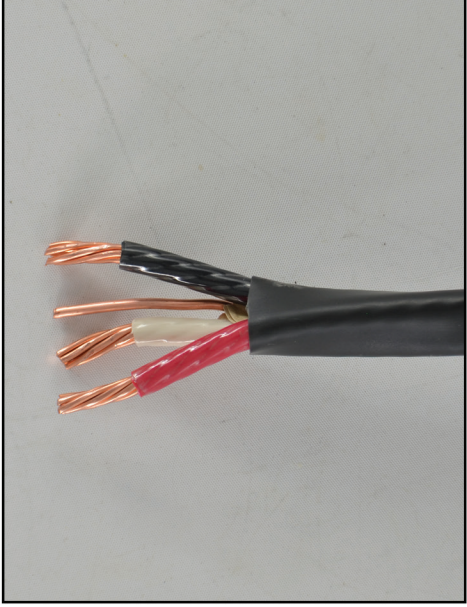

3. Using wire strippers, strip wire ends 5/8" to 3/4". Make certain that wire strands are clean and corrosion free. If they are corroded, cut the wire back until clean wire is found.



4. Slide the wire into the following items: (1) gasket, (2) compression nut, (3) grommet and (4) body housing in that order.



5. Loosen the 4 terminal screws.
6. Insert the wires into the correct terminal:
Grounding wire into the terminal identified "G".
Neutral wire into the terminal identified "W".
Hot wire into the terminal identified "X".
Hot wire into the terminal identified "Y".



7. Once the wires are in the correct terminals, tighten the 4 terminal screws making sure to use only 25-45 in-lbs.
8. Slide the grommet and the helix cone down the wire into the body housing



9. Tighten the compression nut back onto the body housing using the inlet wrench
10. Turn body housing clockwise to securely attach to the inlet base.