



IMPORTANT SAFETY RECALL

NHTSA Recall # 26V137

Dear [REDACTED]

ARBOC Specialty Vehicles, LLC (ARBOC) has decided that certain 2018-2026 Spirit of Mobility and 2018-2026 Spirit of Freedom vehicles fail to conform to Federal Motor Vehicle Safety Standard No 105, *Hydraulic and electric brake systems*. These buses may have had the rear brake lines installed incorrectly which would cause the rear ABS modulator valves to not function properly. This determination resulted in filing a recall (26V137) with the National Highway Traffic Safety Administration (NHTSA).

This notice applies to units listed on the attached.

WHAT ARBOC WILL DO

ARBOC will supply you with a procedure to inspect and if necessary, correct this noncompliance issue. ARBOC will reimburse dealers for 1.0 hours/bus for buses which need correction. For vehicles which were inspected per our instructions and deemed not to need correction, we will reimburse [0.25 hour/bus](#).

WHAT YOU SHOULD DO

Please remember it is a violation of Federal law for a dealer to deliver a new motor vehicle under a sale or lease until the defect or noncompliance is remedied. All ARBOC Spirit of Freedom and Spirit of Mobility vehicles with a Chevy chassis in your possession should be checked against the attached VIN listing and, if included in the list, checked/corrected prior to sale/lease.

If replacement of additional brake parts are required, please contact ARBOC customer service at 574-825-4880.

Sincerely,

ARBOC Specialty Vehicles, LLC

ARBOC SPECIALTY VEHICLES LLC, 51165 Greenfield Parkway, MIDDLEBURY, INDIANA 46540 574-825-4880 (PHONE) * 574-825-1750 (FAX)

www.ARBOCsv.com

ARBOC

SPECIALTY  VEHICLES

Bus No	Customer	Customer	Dealer	Model	Length	WB	Fuel Type	Serial No	Chassis No
[REDACTED]	[REDACTED]	[REDACTED]	[REDACTED]	SOF	24	165	G	1A9D05245R6925 [REDACTED]	1HA6GUB71PN [REDACTED]
[REDACTED]	[REDACTED]	[REDACTED]	[REDACTED]	SOF	24	165	G	1A9D05249P6925 [REDACTED]	1HA6GUB76PN [REDACTED]
[REDACTED]	[REDACTED]	[REDACTED]	[REDACTED]	SOF	27	191	G	1A9D05268N6925 [REDACTED]	1HA6GVC77MN [REDACTED]
[REDACTED]	[REDACTED]	[REDACTED]	[REDACTED]	SOF	27	191	G	1A9D05262S6925 [REDACTED]	1HA6GUB70SN [REDACTED]
[REDACTED]	[REDACTED]	[REDACTED]	[REDACTED]	SOM	26	191	G	1A9D06963K6925 [REDACTED]	1HA6GUBB9JN [REDACTED]

ARBOC SPECIALTY VEHICLES LLC, 51165 Greenfield Parkway, MIDDLEBURY, INDIANA 46540 574-825-4880 (PHONE) * 574-825-1750 (FAX)

www.ARBOCsv.com



26V137

INSPECTION & CORRECTION
DOCUMENT



IN PROCESS - STANDARD OPERATION WORKSHEET - " DOCUMENT UNCONTROLLED IF PRINTED"

PROCESS NAME: INSPECTION & CORRECTION DOCUMENT

STATION	PAGE	DOCUMENT	REVISION	DATE	BY:
SERVICE	1 of 8	26V137	A	3/5/26	[REDACTED]

QUALITY

SAFETY

OPERATION: [HOW TO CHECK AND FIX THE REAR BRAKE LINES ON CHEVY BUSES](#)

ATTENTION/IMPORTANT

REQUIRED PPE: SAFETY GLASSES, BUMP CAP

MATERIALS FOR SOW

ITEM #	DESCRIPTION	PART # / PHOTO	QTY	U/M
1	BRAKE FLUID			
2				
3				

EQUIPMENT/TOOLS

7/16" WRENCH	14MM WRENCH

REVISION NOTES:

STATION	PAGE	DOCUMENT	REVISION	DATE	BY:
SERVICE	2 of 8	26V137	A	3/5/26	[REDACTED]

QUALITY

SAFETY

OPERATION: [HOW TO CHECK AND FIX THE REAR BRAKE LINES ON CHEVY BUSES](#)

ATTENTION/IMPORTANT

REQUIRED PPE: SAFETY GLASSES, BUMP CAP

Checking The Brake Lines



- Step #1 Verify the brake fluid is full, then use a vehicle lift and raise the bus in the air to access the modulator valve and the brake lines under the bus. (IMG. 1)

IMG. 1

STATION	PAGE	DOCUMENT	REVISION	DATE	BY:	QUALITY	SAFETY
SERVICE	3 of 8	26V137	A	3/5/26	[REDACTED]		
OPERATION: HOW TO CHECK AND FIX THE REAR BRAKE LINES ON CHEVY BUSES						ATTENTION/IMPORTANT	
REQUIRED PPE: SAFETY GLASSES, BUMP CAP							

Step #2 Locate the modulator valve under the driver side near the front of the bus, behind the frame rail. (IMG. 2, 3, & 4)

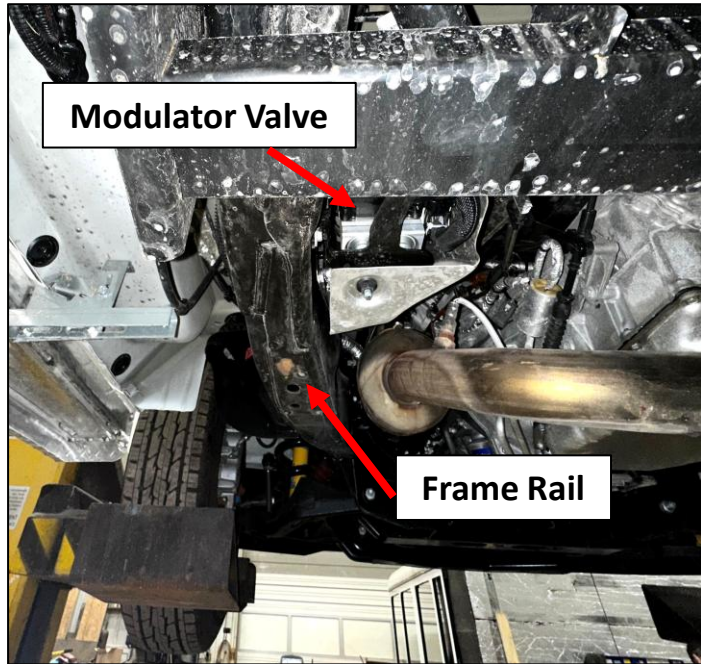

IMG. 2

Under driver side of bus looking towards the front of the bus.

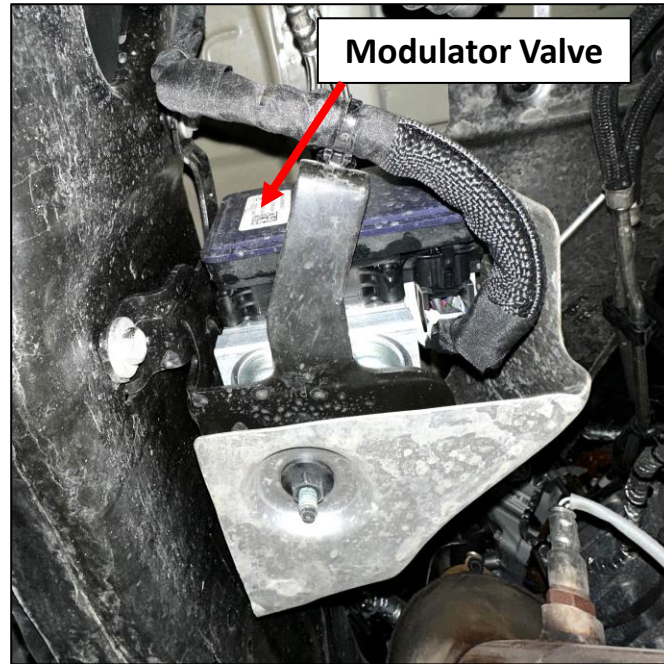

IMG. 3

Under the bus looking up at the modulator valve.



IMG. 4

Modulator Valve

STATION	PAGE	DOCUMENT	REVISION	DATE	BY:	QUALITY	SAFETY
SERVICE	4 of 8	26V137	A	3/5/26	[REDACTED]		
OPERATION: HOW TO CHECK AND FIX THE REAR BRAKE LINES ON CHEVY BUSES						ATTENTION/IMPORTANT	
REQUIRED PPE: SAFETY GLASSES, BUMP CAP							

Step #3 On top of the modulator valve there are 4 ports with brake lines. Looking towards the front of the bus, the 2 brake lines furthest to the right are the rear brake lines.



IMG. 5

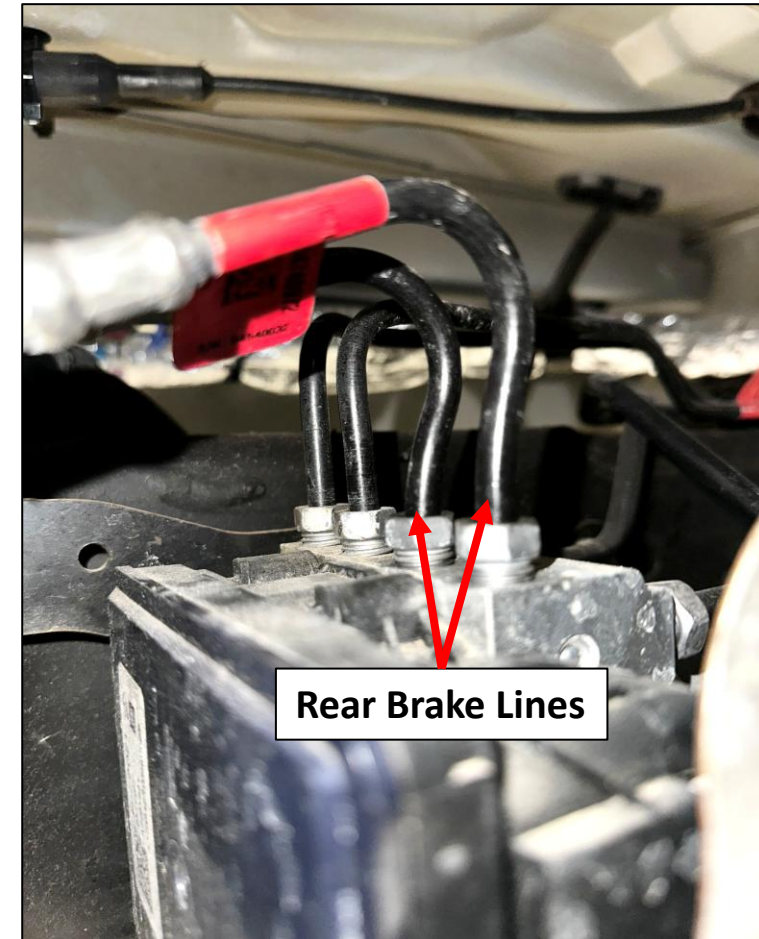

IMG. 6

STATION	PAGE	DOCUMENT	REVISION	DATE	BY:	QUALITY	SAFETY
SERVICE	5 of 8	26V137	A	3/5/26	[REDACTED]		
OPERATION: HOW TO CHECK AND FIX THE REAR BRAKE LINES ON CHEVY BUSES						ATTENTION/IMPORTANT	
REQUIRED PPE: SAFETY GLASSES, BUMP CAP							

Step #4 Follow the brake line (highlighted blue) that is attached to the port furthest to the right when facing the front of the bus, all the way to the back of the bus where it is connected to a bracket. (IMG. 7)

Step #5 This brake line should be attached to the rear roadside brake. (IMG. 8)



IMG. 7

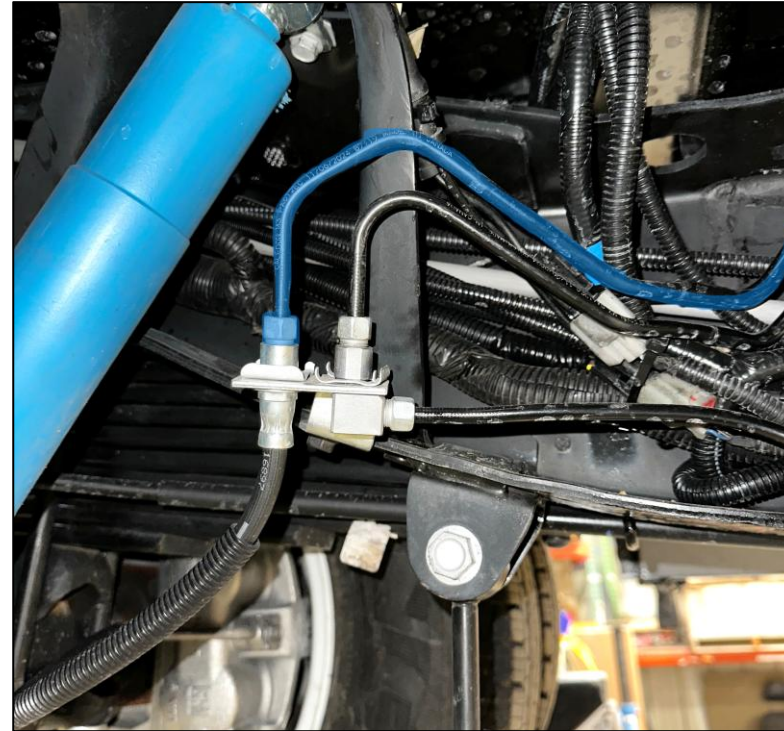

IMG. 8

STATION	PAGE	DOCUMENT	REVISION	DATE	BY:	QUALITY	SAFETY
SERVICE	6 of 8	26V137	A	3/5/26	[REDACTED]		
OPERATION: HOW TO CHECK AND FIX THE REAR BRAKE LINES ON CHEVY BUSES						ATTENTION/IMPORTANT	
REQUIRED PPE: SAFETY GLASSES, BUMP CAP							

Step #6 Follow the brake line (highlighted red) that is attached to the port 2nd furthest to the right when facing the front of the bus, all the way to the back of the bus where it is connected to a bracket. (IMG. 9)

Step #7 This brake line should be attached to the rear curbside brake. (IMG. 10)



IMG. 9

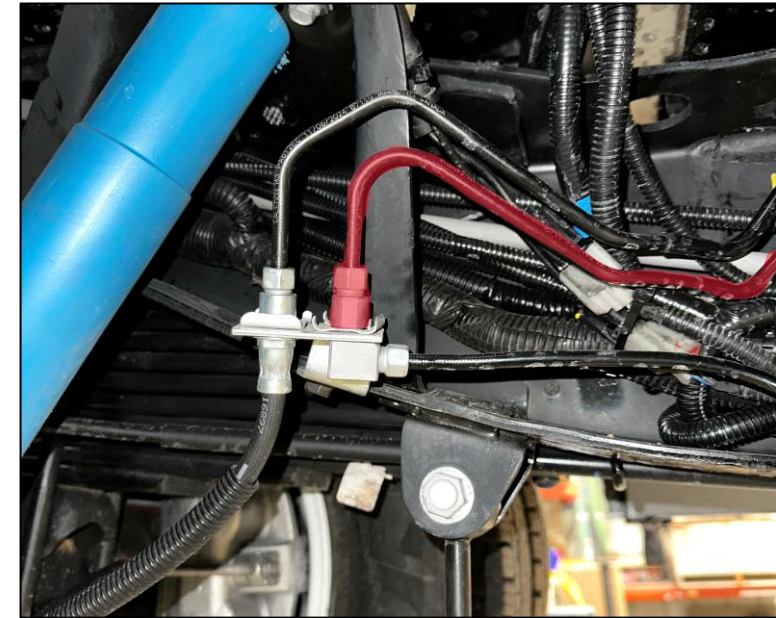

IMG. 10

If the brake lines are connected to the correct ports, no further action is required.

STATION	PAGE	DOCUMENT	REVISION	DATE	BY:
SERVICE	7 of 8	26V137	A	3/5/26	[REDACTED]

QUALITY	SAFETY
---------	--------

OPERATION: [HOW TO CHECK AND FIX THE REAR BRAKE LINES ON CHEVY BUSES](#)

REQUIRED PPE: SAFETY GLASSES, BUMP CAP

ATTENTION/IMPORTANT

Fixing The Brake Lines (Option A)

- Step #1** If the brake lines are connected to the wrong ports, they will need to be corrected.
- Step #2** Locate the brake line splice near the center of the bus. (IMG. 11)
- Step #3** Using a $\frac{7}{16}$ " wrench and a 14mm wrench, loosen and disconnect the brake line connectors. (IMG. 11)

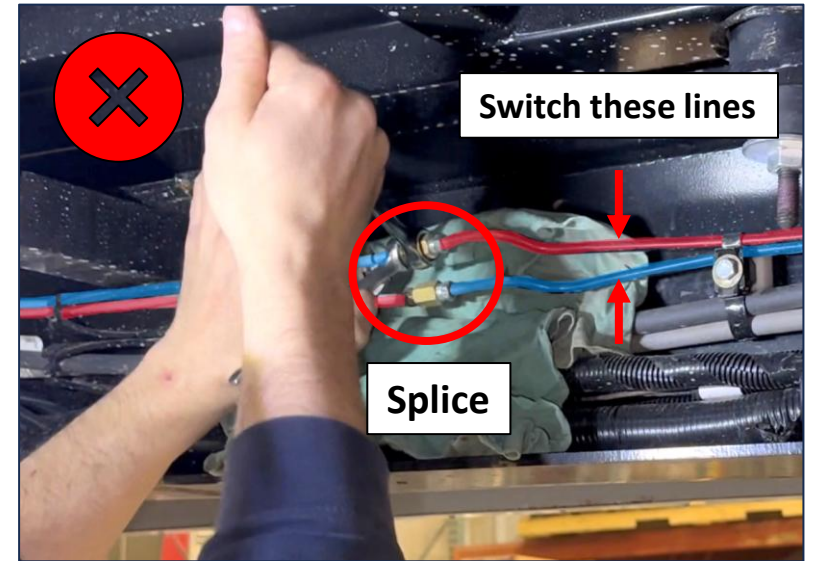

IMG. 11

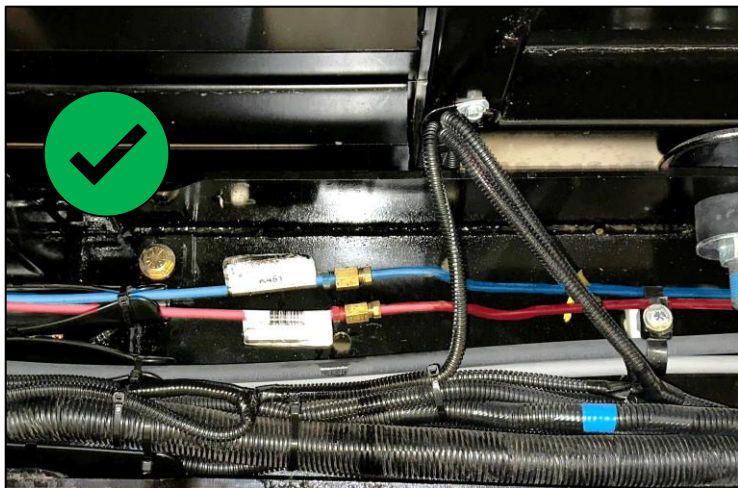

IMG. 12

- Step #4** Switch the lines around and reconnect the correct brake lines to each other. The brake line highlighted blue should go on the top and the brake line highlighted red should go on the bottom. Verify that the brake lines are not touching the frame and that the lines are not touching. (IMG. 11 & 12)
- Step #5** Bleed the rear brakes as required and refill the master cylinder to the correct level.

STATION	PAGE	DOCUMENT	REVISION	DATE	BY:	QUALITY	SAFETY
SERVICE	8 of 8	26V137	A	3/5/26	[REDACTED]		
OPERATION: HOW TO CHECK AND FIX THE REAR BRAKE LINES ON CHEVY BUSES						ATTENTION/IMPORTANT	
REQUIRED PPE: SAFETY GLASSES, BUMP CAP							

Fixing The Brake Lines (Option B)

Step #1 If the brake line splices are off set, the brake lines will need to be switched at the bracket which is located near the back driver side tire. (IMG. 13)

Step #2 Using a 7/16" wrench and a 14mm wrench, loosen and disconnect the brake line connectors.

Step #3 Switch the lines around and reconnect the correct brake lines to each other. The brake line highlighted blue should go on the left and the brake line highlighted red should go on the right. (IMG. 13 & 14)

Step #4 Bleed the rear brakes as required and refill the master cylinder to the correct level.

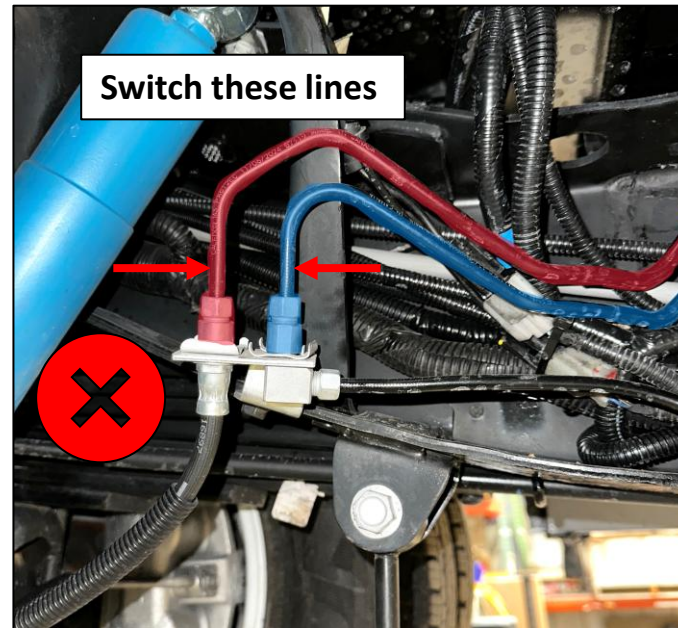

IMG. 13

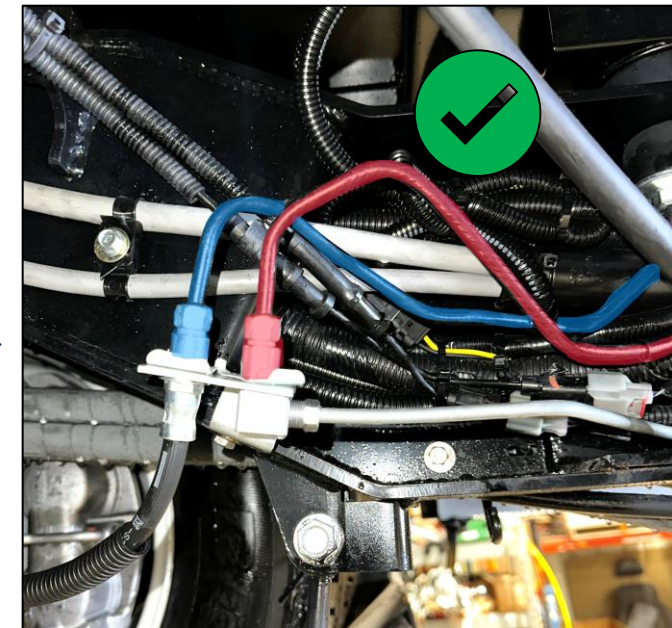

IMG. 14