



GROUP	MODEL
Noncompliance Safety Recall Campaign	2023-2025MY Sportage (NQ5a), Sportage PHEV (NQ5 PHEV) X-Line Trims Only
NUMBER	DATE
SC359 (Rev 1, 02/11/2026)	December 2025

NONCOMPLIANCE SAFETY RECALL CAMPAIGN

SUBJECT:

TRAILER HITCH HARNESS INSPECTION AND MODULE REPLACEMENT (SC359)

NOTICE

This bulletin has been revised to include additional information. New/revised sections of this bulletin are indicated by a black bar in the margin area.

This bulletin provides information to inspect certain 2024-2025MY Sportage 'X-Line' (NQ5a) vehicles produced from July 11, 2023 through April 28, 2025 and certain 2023-2025MY Sportage PHEV 'X-Line' (NQ5 PHEV) vehicles produced from May 2, 2023 through July 4, 2025 equipped with a 4.2" instrument cluster screen and to verify if the subject vehicle is equipped with a Genuine Kia Tow Hitch harness accessory. If equipped, dealers are to replace the tow hitch harness control module with one that has improved software.

Due to a software logic issue, the tow hitch harness control module may send an abnormal CAN message which can cause certain instrument clusters with a 4.2" screen to reboot while driving. During this rebooting, the cluster will not show information such as the speedometer or telltales for approximately five (5) seconds. As a result, the subject vehicles do not comply with the visibility and illumination requirements of Federal Motor Vehicle Safety Standard (FMVSS) 101, "Controls and Displays". A blank instrument cluster does not show certain information such as the speedometer or telltales, thereby increasing the risk of a crash.

Dealers can follow the procedure outlined in this publication to inspect and verify if the subject vehicle is equipped with a Genuine Kia tow hitch harness accessory, and if equipped, to replace the tow hitch harness control module with a new one. Before conducting the procedure, verify that the vehicle is included in the list of affected VINs.

NOTICE

There is no charge to the vehicle owner for this repair. Under applicable law, you may not sell or otherwise deliver any affected vehicle until it has been repaired pursuant to the procedures set forth in this bulletin.

Repair status for a VIN is provided on KDealer+ (Service → Warranty Coverage → Warranty Coverage Inquiry → Campaign Information). Not completed Recall / Service Action reports are available on KDealer+ (Consumer Affairs → Not Completed Recall → Recall VIN → Select Report), which includes a list of affected vehicles.

'Genuine Kia' Harness Claim Guidelines:

Installation Type	Claim Type	Campaign VINs
Port Installed Option (PIO)	Trailer Module Replacement	SC359A
Dealer Installed Option (DIO)	Trailer Module Replacement	SC359B
Not Installed	Inspection Only	

Inspection Procedure:

1. Inspect the rear of the vehicle (SC359B VINs).

- Vehicle is **not equipped** with a 'Genuine Kia' 4-pin tow hitch harness accessory. No further action is required.



- Vehicle is equipped with a 'Genuine Kia' 4-Pin tow hitch harness accessory.



2. **If equipped**, refer to the table above for the applicable VIN for either SC359A or SC359B to replace the trailer control module by referring to the 'Replacement Procedure' outlined on pages 3-4.



SUBJECT: TRAILER TOW HITCH HARNESS INSPECTION & MODULE REPLACEMENT (SC359)

Replacement Procedure:

1. Open the hood and disconnect the 12V battery negative (-) terminal.
2. Open the tailgate door.
3. Partially, detach the weatherstrip (A) along the left side of the area shown.



3. Remove the cargo floor luggage covering board (B) and left side trim.



4. Remove the luggage center tray (C).

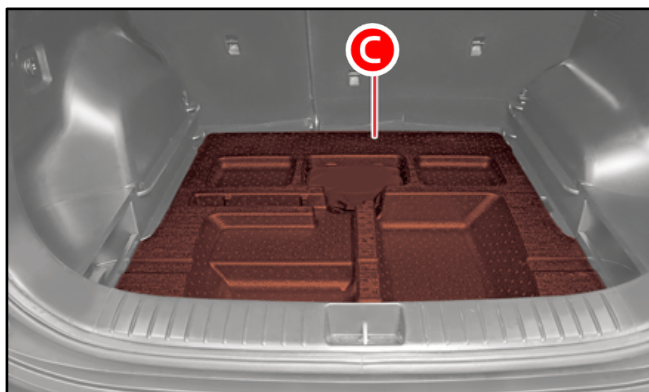

5. Remove the rear transverse trim (D).

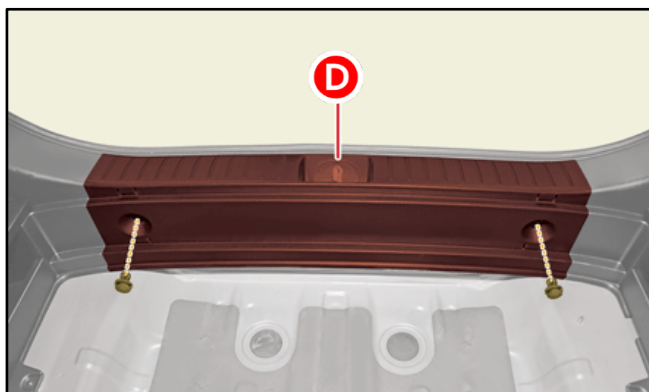

SUBJECT TRAILER TOW HITCH HARNESS INSPECTION & MODULE REPLACEMENT (SC359)

6a. Remove the rear left luggage side trim (E) retaining hardware.

6b. Partially detach the rear of the left luggage side trim to access inside the left rear corner of the body side panel.

Note: Complete removal of the side trim is not required.

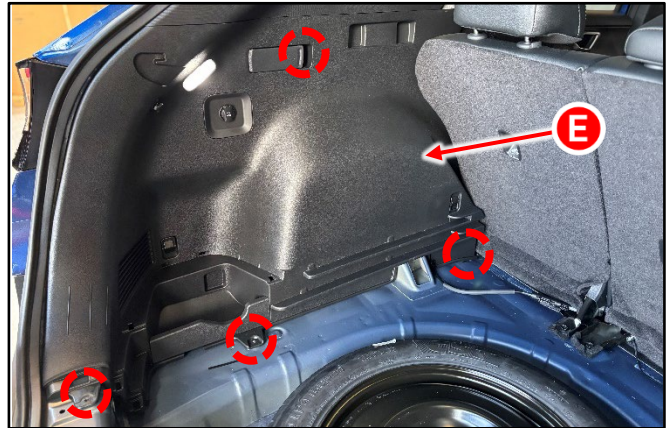

7. Locate the trailer control module (F).

8. Cut-off the control module retaining zip-ties.

9. Disconnect the two (2) trailer control module (F) connectors (1 & 2) and discard the existing control module.

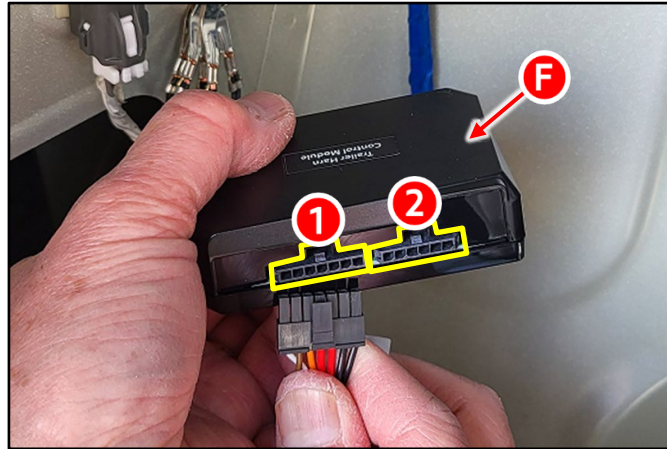

10. Connect the new trailer module (F) to the existing trailer wiring connectors.

Note: Removal of the existing trailer wiring harness is not required.



11. Secure the new trailer module using the supplied zip-ties (X) to the two outlined circled areas shown.

12. Reinstall all removed parts in the reverse order of removal.

13. Verify normal operation of the vehicle.



SUBJECT: TRAILER TOW HITCH HARNESS INSPECTION & MODULE REPLACEMENT (SC359)

AFFECTED VEHICLE RANGE:

Model	Production Date Range
Sportage (NQ5a)	July 11, 2023 to April 28, 2025
Sportage PHEV (NQ5 PHEV)	May 2, 2023 to July 4, 2025

Applicable to 'X-Line' model trim only.

REQUIRED PART:

Part Name	Part Number	Figure	Qty.	Comments
Trailer Module Kit	GIF67 AC021QQK		1	Includes two (2) zip-ties.

WARRANTY INFORMATION:

N Code: N99 C Code: C99

Model	Claim Type	Causal P/N	Qty.	Repair Description	Labor Op Code	Op Time	Replacement P/N	Qty.
NQ5a, NQ5 PHEV	R	DWF67 AC001	0	(SC359A) Tow Hitch Harness Replacement (PIO Equipped)	A52602R1	0.3 M/H	GIF67 AC021QQK	1
				(SC359B) Tow Hitch Harness Replacement (DIO Equipped)	A52602R2			
NQ5a, NQ5 PHEV	R	DWF67 AC001		(SC359B) Tow Hitch Harness Inspection Only (DIO Not Equipped)	A52512I0	0.1 M/H	N/A	0

Refer to Warranty Bulletin 2025-36 for claim submission procedures. When substitute transportation is provided, manually enter sublet code 'X2' for rental expense reimbursement or one roundtrip rideshare expense.

NOTICE

VIN inquiry data for this repair is provided for tracking purposes only. Kia retailers should reference SC359 when accessing the KDealer+ system.

