



HYUNDAI Technical Service Bulletin

GROUP

RECALL

NUMBER

25-01-091H

DATE

DECEMBER 2025

MODEL(S)

SEE BELOW

SUBJECT: SIDE CURTAIN AIRBAG (SCAB) INSPECTION & CORRECTION
(RECALL 289)

* IMPORTANT

Vehicle repairs related to safety recalls are critically important and must be performed properly in accordance with TSB procedures. Review this bulletin in its entirety prior to beginning any repair work.

As required by federal law, dealers must not deliver new vehicles for sale or for lease to customers until all open recalls have been performed. Dealers must also perform all open recalls on used vehicles, demo, and rental vehicles prior to placing them into customer use and whenever an affected vehicle is in the shop for any maintenance or repair.

Access the "Vehicle Information" screen via WebDCS to identify open recalls.

Description: Certain Santa Cruz (NXT), Santa Fe (MX5A), Santa Fe Hybrid (MX5A HEV), and Tucson (NX4A) vehicles equipped with Side Curtain Airbags (SCAB) may have been improperly installed, which can potentially result in abnormal airbag deployment during a crash, increasing the risk of injury to occupants. An abnormal airbag deployment could increase the risk of injury to occupants during a crash. Follow the information in this TSB to reinstall the SCAB in the correct orientation.



Applicable Vehicles (Certain):

Model Year	Model	Production Dates
2025 – 2026	Santa Cruz (NXT)	09/10/2024 – 07/28/2025
	Santa Fe (MX5A)	12/11/2024 – 07/23/2025
	Santa Fe Hybrid (MX5A HEV)	12/12/2024 – 07/30/2025
2025	Tucson (NX4A)	09/25/2024 – 07/17/2025

Circulate To: General Manager, Service Manager, Parts Manager, Warranty Manager, Service Advisors, Technicians, Body Shop Manager, Fleet Repair

Parts Information:

Model	Part Name	Part Number	Figure	Remarks
	CLIP-TRIM MTG	85815-P1000		Qty: 2 A-pillar (one time use clips)
Santa Cruz (NXT) Santa Fe (MX5A) Santa Fe Hybrid (MX5A HEV) Tucson (NX4A)	FASTENER- DR TRIM	82315-2P000		Lower B-Pillar Trim Fastener (Replace only if damaged)
	CLIP-TRIM MTG	85858-3S100		Upper B-Pillar Trim (Replace only if damaged)

NOTE 1: Dealers will be reimbursed via sublet as noted for any clips, regardless of replacement.

Warranty Information:

Model	Op. Code	Operation	Op. Time	Causal Part	Nature Code	Cause Code
Santa Fe (MX5A)	51DA47R0	Side Curtain Airbags (SCAB) Inspection & Correction	2.3 M/H	80410-R6000	B14	ZZ7
Santa Fe Hybrid (MX5A HEV)				80410-CW000		
Tucson (NX4A)			80410-K5000			
Santa Cruz (NXT)	51DA47R1		2.8 M/H	80410-K5000		

NOTE 1: Submit claim on Claim Entry Screen as “Campaign” type.

NOTE 2: If any part(s) not subject to this TSB are found in need of replacement while performing the repair procedure, and the affected part(s) are still under warranty, the dealer may submit a separate claim using the same repair order. If the part(s) not subject to this TSB are out of warranty coverage, the dealer has the option to submit a PA Request for goodwill consideration on a case-by-case basis.

NOTE 3: This TSB includes repair validation photos. Op times include VIN, mileage, and repair validation photo(s) as outlined in the Digital Documentation Policy.

NOTE 4: The incident parts are subject to callback through the normal Warranty Technical Center (WTC) parts return process. **Claim is subject to debit if the part is not returned.**

NOTE 5: Op codes will reimburse \$2.50 in sublet for any damaged fasteners during the service procedure.

Service Procedure:**DIGITAL DOCUMENTATION**

This TSB includes repair validation photos. Refer to the latest Warranty Digital Documentation Policy for requirements.

NOTICE

Applying the recommended torque to all fasteners is essential to reduce potential issues from occurring after the service procedure.

i Information

Refer to the QR code or link below for guided video information:

[Recall 289 – Side Curtain Airbag \(SCAB\) Inspection & Correction](#)



Side Curtain Airbags Inspection & Correction

1. Remove the front row seats by referring to the shop manual:
 - **Body (Interior / Exterior / Electrical) > Front Seat > Front Seat Assembly > Removal**



2. Disconnect the negative (-) battery terminal (A).

Tightening Torque:

lb-ft	6.5
lb-in	78
N.m	8.8



3. Remove the front pillars (B) on both sides by referring to the shop manual:
- **Body (Interior / Exterior / Electrical) > Interior Trim > Front Pillar Trim > Removal and Installation**

i Information

Top clip (P/N: **85815-P1000**) for A-pillar trims must be replaced (one-time use).

NOTICE

Use a plastic trim removal tool to prevent damage to parts.

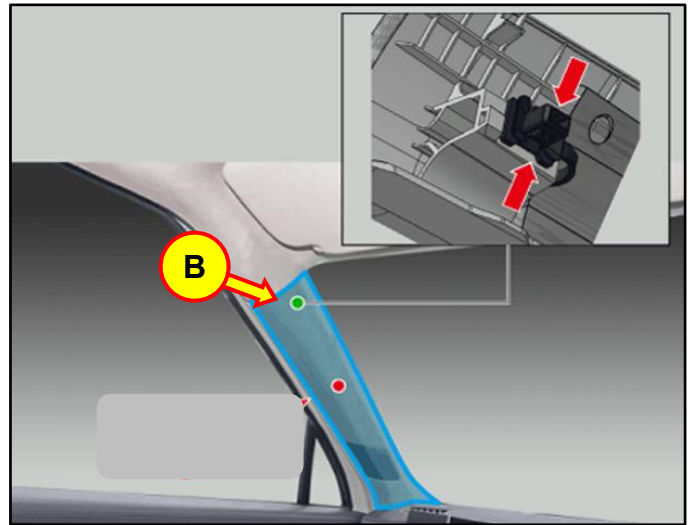

4. Remove the upper & lower center pillar trims (C & D) on both sides by referring to the shop manual:
- **Body (Interior / Exterior / Electrical) > Interior Trim > Center Pillar Trim > Removal and Installation**

i Information

Replace any damaged clips.

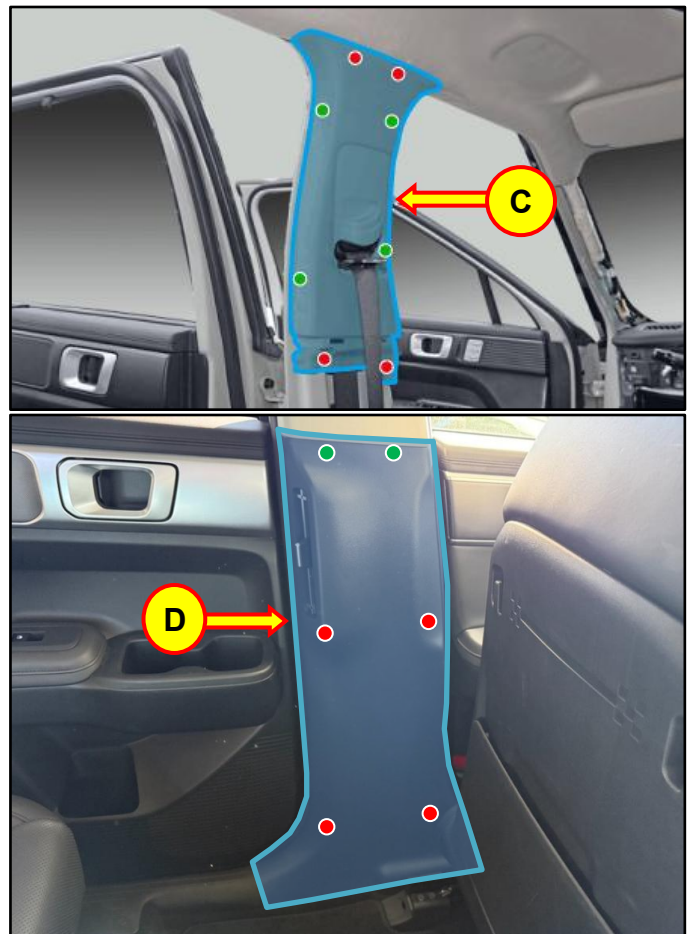

5. Remove the 2nd row seats by referring to the shop manual:
- **Body (Interior / Exterior / Electrical) > Rear Seat > Rear Seat Assembly > Removal**

Santa Fe & Santa Fe Hybrid: Proceed to **step 6**.

Tucson: Proceed to **step 7**.

Santa Cruz: Proceed to **step 8B**.



6. **i Information**

This step is **ONLY** for Santa Fe & Santa Fe Hybrid.

Remove the 3rd row seats and luggage trim by referring to the shop manual:

- **Body (Interior / Exterior / Electrical) > Rear Seat > Rear Seat Assembly > Removal and Installation**



7. **i Information**

This step is **ONLY** for Santa Fe, Santa Fe Hybrid & Tucson.

Remove the luggage side trims (E) by referring to the shop manual:

- **Body (Interior / Exterior / Electrical) > Interior Trim > Luggage Trim > Luggage Side Trim > Removal and Installation**

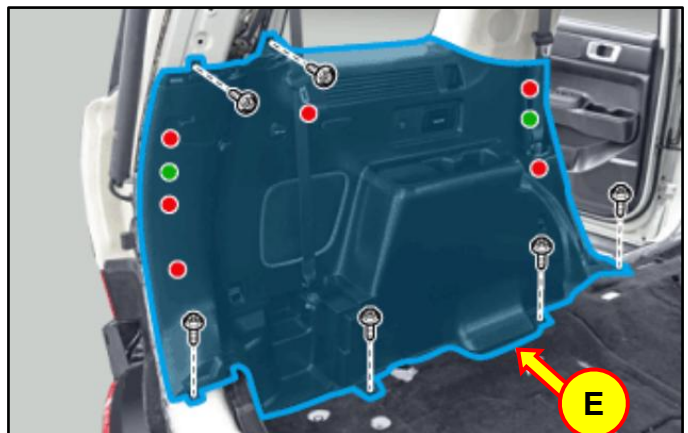

8A.

i **Information**

This step is **ONLY** for Santa Fe, Santa Fe Hybrid & Tucson.

Remove the rear pillar trim (F) and the gate pillar trim (G) by referring to the shop manual:

- **Body (Interior / Exterior / Electrical) > Interior Trim > Rear Pillar Trim > Removal and Installation**

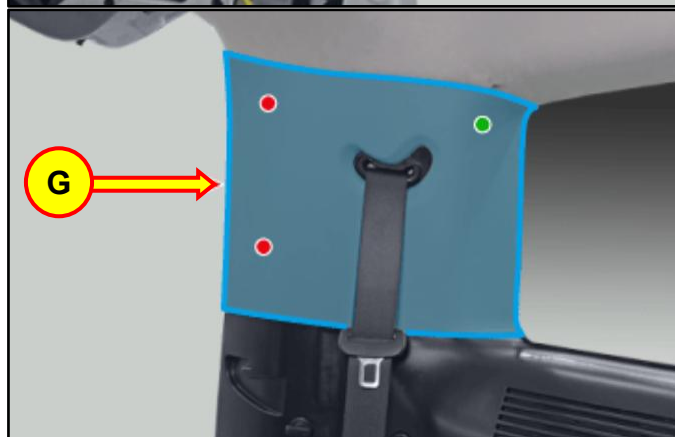
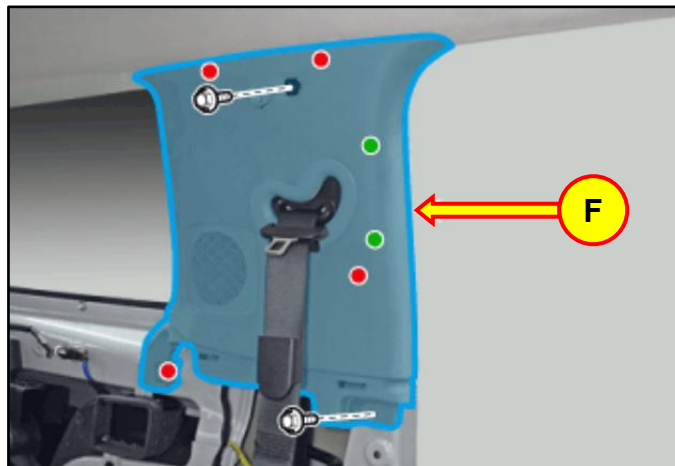

8B.

i **Information**

This step is **ONLY** for Santa Cruz.

Remove the rear pillar trims (H & I) by referring to the shop manual:

- **Body (Interior / Exterior / Electrical) > Interior Trim > Rear Pillar Trim > Removal and Installation**

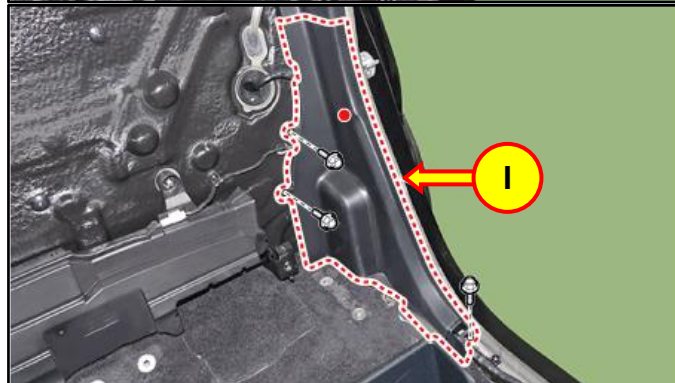
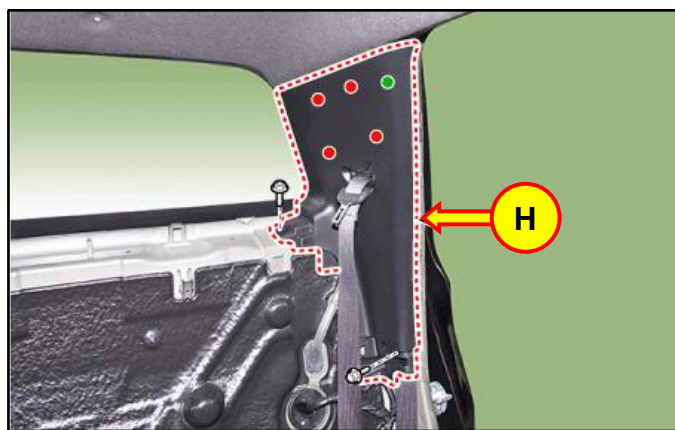

9. Remove the sun visors (J) and retainers (K) on both sides by referring to the shop manual:
- **Body (Interior / Exterior / Electrical) > Roof Trim > Sunvisor > Removal and Installation**

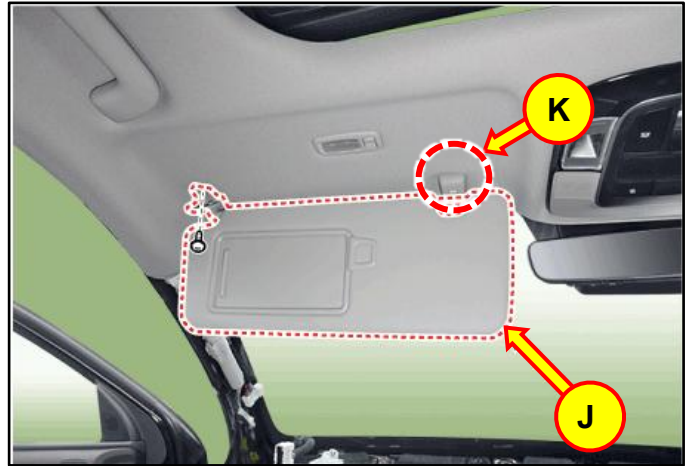

10. Remove the overhead console assembly (L) by referring to the shop manual:
- **Body (Interior / Exterior / Electrical) > Roof Trim > Overhead Console Assembly > Removal and Installation**

Disconnect the overhead console connectors (M).

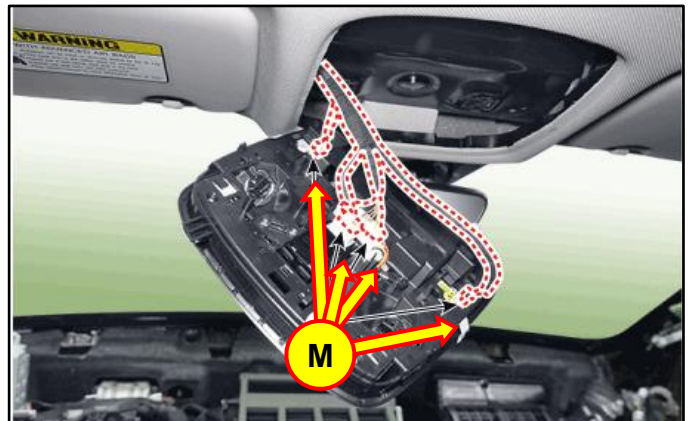
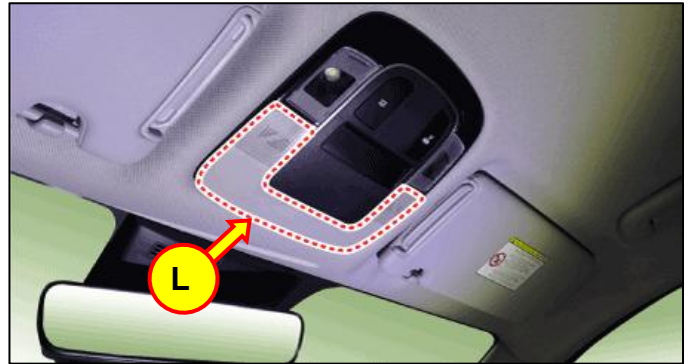

11. Remove the inside mirror cover and multi sensor cover (N).
- **Body (Interior / Exterior / Electrical) > Mirror > Inside Mirror Assembly > Removal**

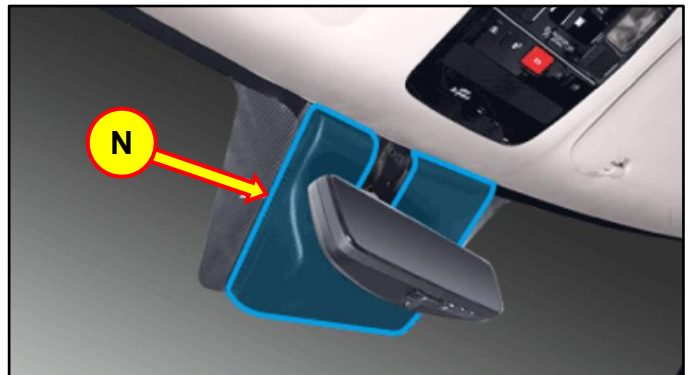

12. Disconnect the connectors (O) from the windshield.

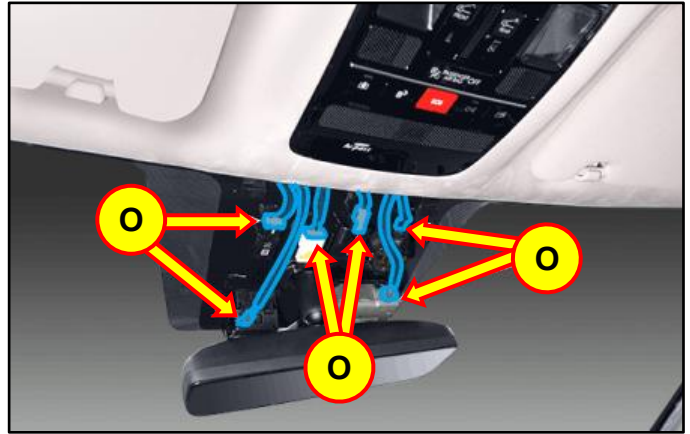

13. Remove the assist handles (P) on both sides by referring to the shop manual:
- **Body (Interior / Exterior / Electrical) > Roof Trim > Assist Handle > Removal and Installation**

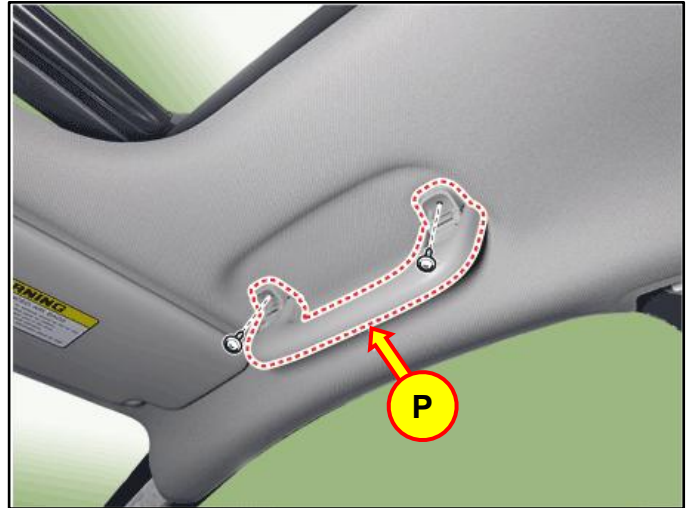

14. Remove the rear cargo room lamp (Q).
- **Body (Interior / Exterior / Electrical) > Light & Vision System > Room Lamp > Removal and Installation**

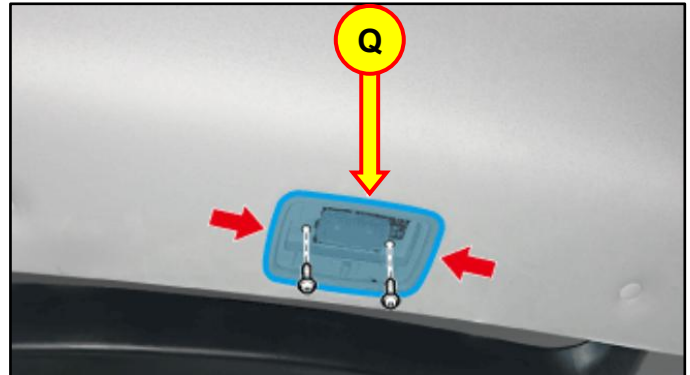

15. Disconnect the roof trim main connectors (R) from the front pillars section on both sides.

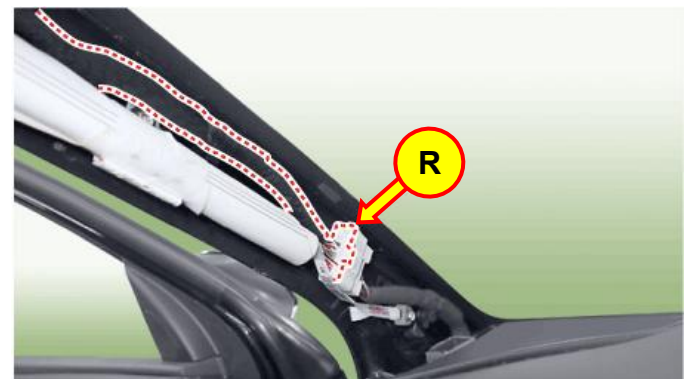

16. Carefully lower the headliner (S) to get access to both Side Curtain Airbags (SCAB).

NOTICE

Exercise caution when lowering the headliner as to not crease or damage it. Assistance from another tech or support tool to hold headliner may be required.

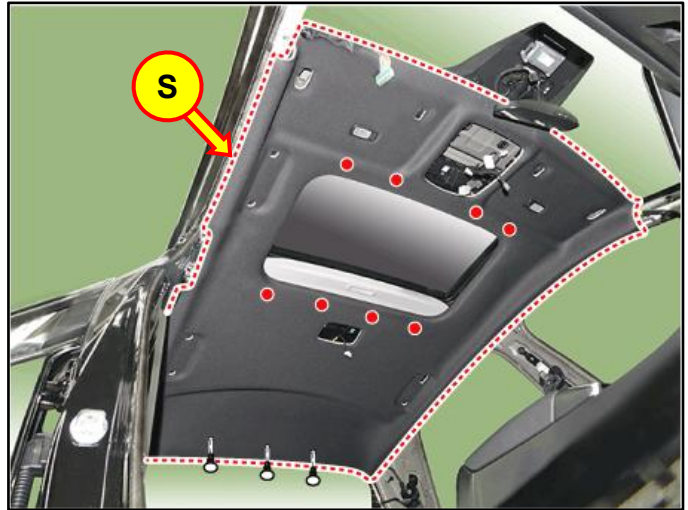

17. Visually inspect curtain airbag for twisting on both sides:

- **NOT TWISTED:** Proceed to **step 20**.
- **TWISTED:** Proceed to **step 18**.

NOT TWISTED



TWISTED



18. Remove the nuts and bolts (T, U, V, W) in alphabetical order to untwist the airbag.

i Information

Number of nuts and bolts will vary by model:

- Santa Fe and Santa Fe Hybrid: **4** nut washers and **7** bolts.
- Santa Cruz and Tucson: **2** nut washers and **8** bolts.

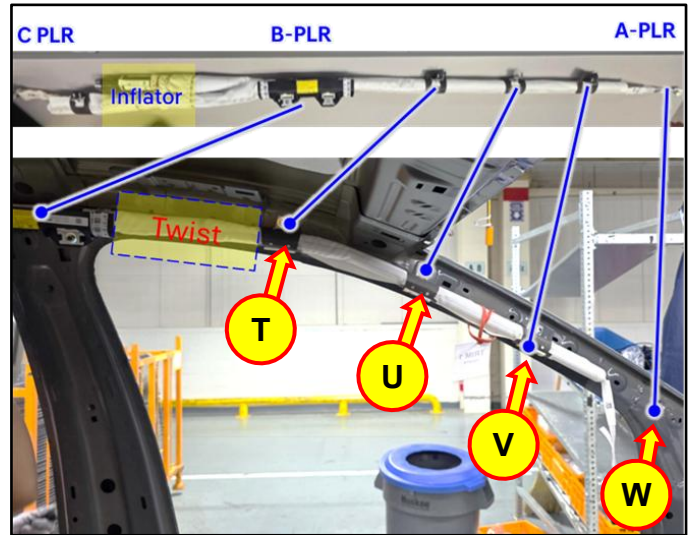

19. Untwist the curtain airbag(s) then reinstall the nuts and bolts in the reverse order of the removal process, ensuring no twists are present.

Tightening Torque:

Bolt:

lb-ft	7.25
lb-in	87
N.m	9.8

Nut:

lb-ft	3.65
lb-in	44
N.m	4.9

20.

**DIGITAL
DOCUMENTATION**



Using the STUI camera function, take a photo of both RH and LH Side Curtain Airbags (SCAB) correctly installed.

Upload the photos to STUI.

NOTE: If the STUI camera function is **NOT** used, write the last 6 digits of the VIN and date of repair on a piece of paper to include in the photo.



21. Reassemble parts in reverse order of the removal process.
22. The service procedure is now complete.