

IMPORTANT SAFETY RECALL



FOREST RIVER

DEPARTMENT OF COMPLIANCE
VEHICLE SAFETY AND RECALL MANAGEMENT
PO Box 30
MIDDLEBURY, INDIANA 46540-9218

NHTSA RECALL: 25V610
FOREST RIVER ID: 53-1974
SERVICE CAMPAIGN: 001241

<<DEALERTNAME>>
<<ADDRESS>>
<<CITY>>, <<ST>> <<ZIP-XXX>>

- o Integrity
- o Safety
- o Quality
- o Customer Service

September 2025

Pursuant to USC49CFR §577.13 – Notification to Dealerships and Distributors – Paragraph B

“It is a violation of Federal Law for a dealer to deliver a new motor vehicle or any new or used item of motor vehicle equipment (including a tire) covered by the notification under a sale or lease until the defect or noncompliance is remedied. Substantial civil penalties apply to violations of this law.”

–Forest River motorized and towable products are contained in this section-

Forest River has decided that a safety defect exists in certain 2025-2026 Shasta Oasis and Coachmen Spirit Travel Trailer Recreational Vehicles. Forest River is recalling the defect model(s) to ensure the safety of our future retail consumers and your dealership. Forest River apologizes for any inconvenience this action may cause your dealership; however, safety, continued satisfaction, and our commitment to building great products are of the utmost importance to Forest River.

The designated Date range of production is:

Shasta Oasis – 3/17/2025 through 9/5/2025

Coachmen Spirit – 3/20/2025 through 9/4/2025

WHAT IS THE DEFECT?

The wire sheathing to the 30AMP or 50AMP inlet may have been stripped inconsistently.

EVALUATION OF THE RISK TO THE VEHICLE AND OPERATOR(S) RELATED TO THE RECALL.

Inconsistent sheathing removal may allow for arcing, which may lead to fire and property damage.

SERVICE PROCEDURE:

Dealership Service Department procedures can be found on Dealer Connect

DEALER REPAIR CODES: Dealer Connect

Prior Authorization Required

UNITED STATES	REPAIR CODE	DESCRIPTION	ALLOWABLE HOUR(S)
25V610	RC-003-15-00-004747	INSPECTION AND PERFORM REMEDY	.25 HRS

HELPFUL CONTACT INFORMATION:

CONTACT	PHONE
CUSTOMER SERVICE	(574) 825-0856

The Recall shall be considered the utmost priority to remedy the 2025-2026 Shasta Oasis and Coachmen Spirit Travel Trailer in question. **The retail consumer shall not be charged** any amount of monies for remedy to their 2025-2026 Shasta Oasis and Coachmen Spirit Travel Trailer listed under this Recall.

If your dealership has already performed the remedy to 2025-2026 Shasta Oasis and Coachmen Spirit Travel Trailer, your dealership is entitled to the reimbursement as stated above by filing a claim using the indicated repair code(s). If the remedy needs to be performed on an out of warranty 2025-2026 Shasta Oasis and Coachmen Spirit Travel Trailer in which the VIN falls under as stated in the identified VIN listing, your dealership is entitled to the reimbursement as stated above by filing a claim using the indicated repair code(s).

IMPORTANT SAFETY RECALL

Notice:

In no manner shall a Forest River Product Owner or Coachmen Product Owner be charged any fee(s) for scheduling, conduction or completion of the recall. Additionally, all dealership(s) that are Forest River and/or Coachmen dealership(s) are Federally Mandated to perform the recall once presented with this recall whether by the Owner or Dealership receipt of this letter, without denial of service to the Owner. Lastly, denial of a remedy for this recall is a Federal Violation punishable by law resulting substantial fines and/or civil penalties.

Federal Regulation requires that any lessor receiving this Recall must forward a copy of this notice to the lessee within ten days. If your dealership no longer owns this vehicle, please inform the Warranty Manager of the product listed above of the change of ownership.

Sincerely,
Forest River, Inc.
Office of Corporate Compliance

RECALL 25V610 & 2025-481 REMEDY INSTRUCTIONS

 FOREST RIVER	Make(s): Shasta & Spirit Model(s): Many, See Below Model Year(s): 2025 - 2026	Repair Code: RC-003-15-00-004747 Allotted Time: .25 HRS Inspection Code: N/A Allotted Time: N/A
	Concern: The wire sheathing to the 30AMP or 50AMP inlet may have been stripped inconsistently.	Photo(s) Required: NO Prior Authorization Required: YES Part(s) Kit Number: N/A Part(s) Return: N/A

Turn off LP Gas at LPG Tank(s). Disconnect the vehicles' battery Positive and Negative, disconnect any House battery(s) Positive and Negative, if equipped with a generator ensure it is off and lastly, ensure the vehicle is disconnected from shore power. Block any tires/wheels to prevent the vehicle from rolling. Failure to do so may result in electrocution, fire or other personal injury, property damage and/or death.

CERTAIN 2025 – 2026 – SHASTA OASIS: SST16BH, SST16RE, SST18DBL, SST18FQ, SST20RB, SST25RB, SST31QB, SST32DS, SST33RLTS, SST521CK, SST525BHS, SST525RS, SST526BH, SST526DB, SST526RBS, SST527BHS, SST530BQB, SST530QB, SST532BEDS & SST533BH

CERTAIN 2025 – 2026 – SPIRIT: SBT160BH, SBT160RE, SBT180DBL, SBT180FQ, SBT310QB, SBT5210CK, SBT5250BHS, SBT5260BH, SBT5260DB, SBT5260RBS, SBT5300BQB, SBT5320BEDS & SBT5330BH

REPAIR

STEP 1: REMOVE EXTERIOR 30AMP OR 50AMP INLET;

STEP 2: INSPECT THE HOT(S), NEUTRAL AND GROUND FOR PROPER DEPTH OF SHEATHING REMOVAL;

- IF CORRECT, REASSEMBLE AND ENSURE TO RE-TORQUE EACH LUG ACCORDING TO THE FIGURE BELOW, CLAIM INSPECTION CODE ONLY;
- IF INCORRECT, REMOVE THE PROPER AMOUNT OF SHEATHING, REASSEMBLE AND ENSURE TO RE-TORQUE ACCORDING TO THE FIGURE BELOW;
- **REFERENCE THE INCLUDED INSTALLATION INSTRUCTIONS REFERENCING THE 30AMP & 50AMP INLET**

STEP 3: REINSTALL THE 30AMP OR 50AMP INLET INTO ITS OPENING;

STEP 4: TEST FUNCTIONALITY;

STEP 5: CLAIM REPAIR CODE.

FIGURES:

30AMP INLET - TORQUE SPECIFICATION
18 – 25 INCH-POUNDS

50AMP INLET – TORQUE SPECIFICATION
25 – 45 INCH-POUNDS

Locking 30 Amp 125V Easy-Pro Inlet Installation Instructions



03062024L530EZ

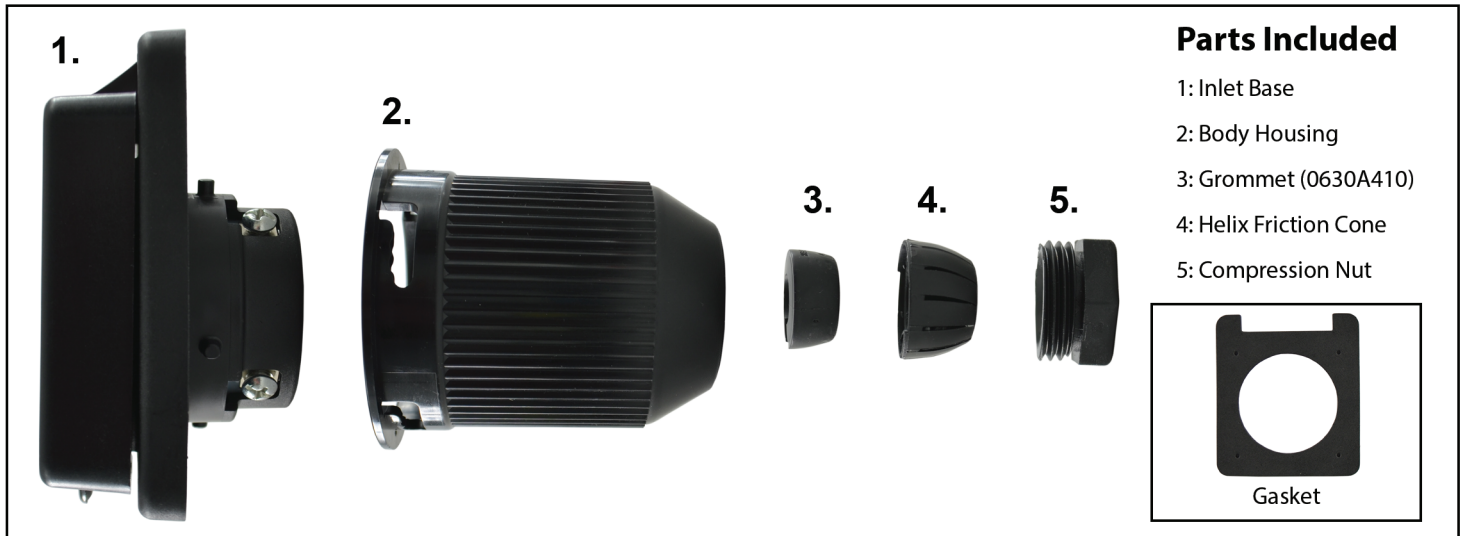

WARNING:

To prevent electrocution, make sure that the inlet is not connected to a power source before installation. Failure to comply with the following instructions could cause an electrical failure or fire.

Recommended Installation Tools

- Pencil
- Electric Drill
- 2-3/4" Hole Saw
- 1/8" Drill Bit
- (4)#8 Screws Stainless Steel (*Installer to provide*)
- Phillips Screw Bit
- S1 (2.0mm*2.0mm) Square Lug Screw Bit
- Wire Strippers
- 30/50A Inlet Wrench

Mounting Inlet to RV Directions

1. Determine hull mounting location. Make sure that the mounting location is clear of any plumbing, electrical wiring or other obstruction.
2. Cut an opening in the hull using a 2-3/4" diameter hole saw.
3. Set the inlet flush into the hole drilled. Using the inlet as a guide, mark the mounting hole locations. Drill mounting holes using a 1/8" drill bit.
4. Pull the internal wiring through to wire the inlet. (**See back for inlet wiring instructions**)
Please Note: Conntek 30 Amp inlet requires 10AWG wire. Using smaller gauge wire will result in overheating and could lead to a fire.
5. Once the inlet is wired correctly, position the gasket and inlet over the hull opening.
6. Align to the mounting holes. Using the #8 Screws(4) to install and mount the inlet.

Wiring Inlet Guide

03062024L530EZ



1. Turn body housing counter clockwise to detach from inlet base.
2. Loosen compression nut to remove the helix friction cone and the grommet. Set aside for later use.



5. Loosen the 3 terminal screws.
6. Insert the wires into the correct terminal:
Grounding wire into the terminal identified "G".
Neutral wire into the terminal identified "N".
Hot wire into the terminal not identified.

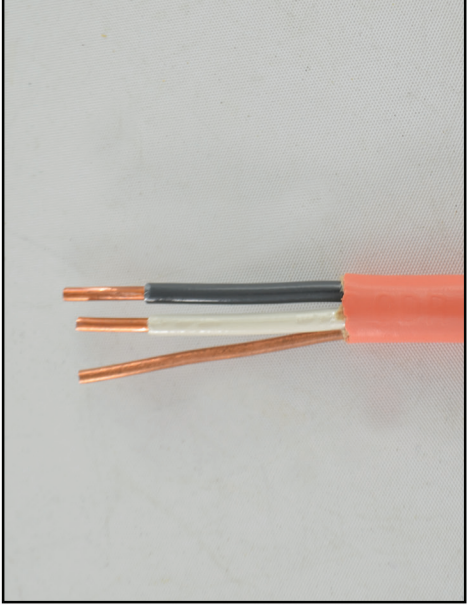

3. Using wire strippers, strip wire ends 5/8" to 3/4". Make certain that wire strands are clean and corrosion free. If they are corroded, cut the wire back until clean wire is found.



7. Once the wires are in the correct terminals, tighten the 3 terminal screws making sure to use only 18 - 25 in-lbs.
8. Slide the grommet and the helix cone down the wire into the body housing

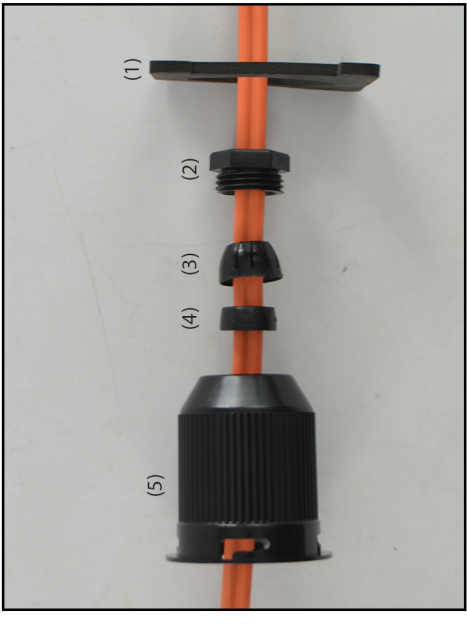

4. Slide the wire into the following items:
(1)gasket, (2)compression nut,
(3)helix friction cone, (4)grommet and
(5)body housing in that order.



9. Tighten the compression nut back onto the body housing using the inlet wrench
10. Turn body housing clockwise to securely attach to the inlet base.

Locking 50 Amp 125/250V Easy-Pro Inlet Installation Instructions



03062024SS2EZ

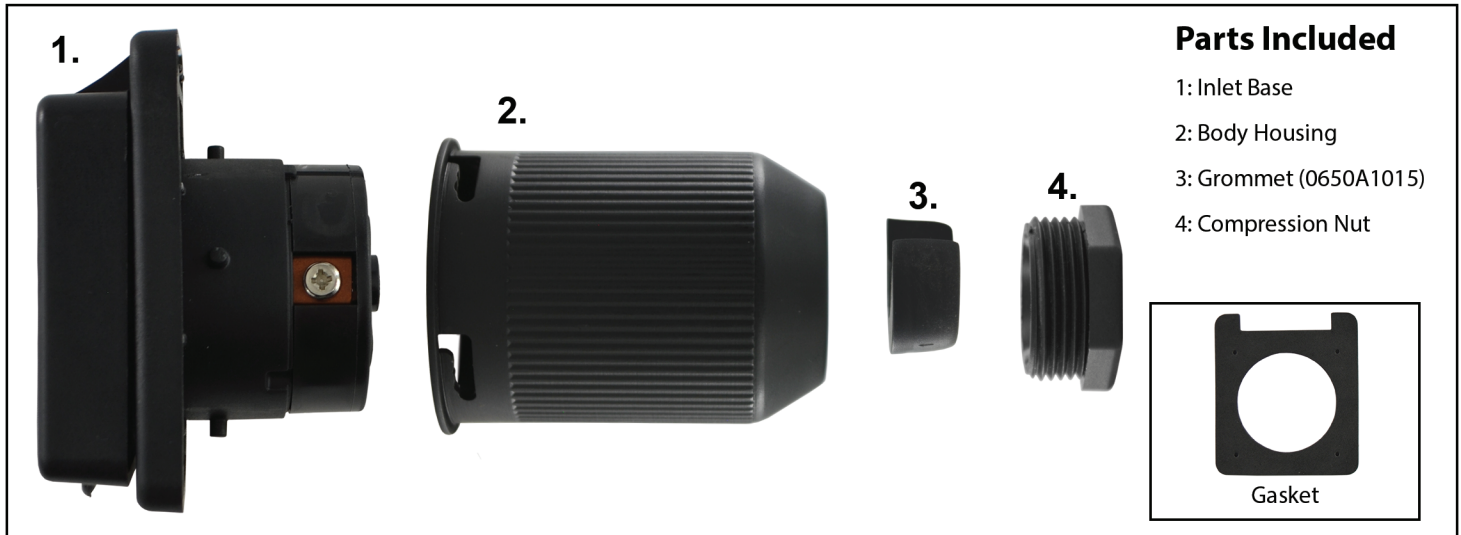

WARNING:

To prevent electrocution, make sure that the inlet is not connected to a power source before installation. Failure to comply with the following instructions could cause an electrical failure or fire.

Recommended Installation Tools

- Pencil
- Electric Drill
- 2-3/4" Hole Saw
- 1/8" Drill Bit
- (4)#8 Screws Stainless Steel (*Installer to provide*)
- Phillips Screw Bit
- SQ2 (3.0mm*3.0mm) Square Lug Screw Bit
- Wire Strippers
- 30/50A Inlet Wrench

Mounting Inlet to RV Directions

1. Determine hull mounting location. Make sure that the mounting location is clear of any plumbing, electrical wiring or other obstruction.
2. Cut an opening in the hull using a 2-3/4" diameter hole saw.
3. Set the inlet flush into the hole drilled. Using the inlet as a guide, mark the mounting hole locations. Drill mounting holes using a 1/8" drill bit.
4. Pull the internal wiring through to wire the inlet. (**See back for inlet wiring instructions**)
Please Note: Conntek 50 Amp inlet requires 6AWG wire. Using smaller gauge wire will result in overheating and could lead to a fire.
5. Once the inlet is wired correctly, position the gasket and inlet over the hull opening.
6. Align to the mounting holes. Using the #8 Screws(4) to install and mount the inlet.

Wiring Inlet Guide

03062024SS2EZ



1. Turn body housing counter clockwise to detach from inlet base.
2. Loosen compression nut to remove the grommet. Set aside for later use.

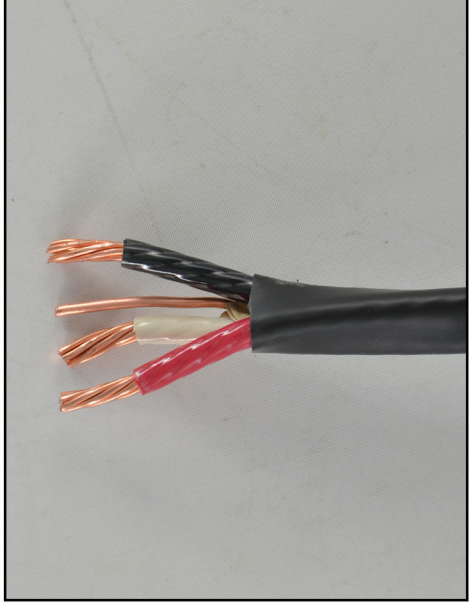

3. Using wire strippers, strip wire ends 5/8" to 3/4". Make certain that wire strands are clean and corrosion free. If they are corroded, cut the wire back until clean wire is found.



4. Slide the wire into the following items:
(1) gasket, (2) compression nut, (3) grommet and (4) body housing in that order.



5. Loosen the 4 terminal screws.
6. Insert the wires into the correct terminal:
Grounding wire into the terminal identified "G".
Neutral wire into the terminal identified "W".
Hot wire into the terminal identified "X".
Hot wire into the terminal identified "Y".



7. Once the wires are in the correct terminals, tighten the 4 terminal screws making sure to use only 25-45 in-lbs.
8. Slide the grommet and the helix cone down the wire into the body housing



9. Tighten the compression nut back onto the body housing using the inlet wrench
10. Turn body housing clockwise to securely attach to the inlet base.