

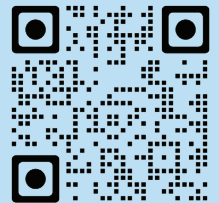

CLIP-ON BRACKET

REPLACEMENT INSTRUCTIONS FOR STP57-641

REPLACEMENT KIT | STP54-077 | ROOST 43



SCAN ME for the
Installation Video



Above. Beyond. Always.

574.293.1581
www.MORryde.com

CLIP-ON BRACKET

INSTALLATION INSTRUCTIONS

Tools Required:

- 3/8" Wrench
- Impact Driver
- Ratchet
- Drill with 3/16" Drill Bit

STEP 1

Remove the two mounting screws that secure each of the two STP57-641 mounting brackets. Once removed, discard both original mounting brackets.

Note: It is OK to use a drill/impact gun for the removal of each of the brackets.



STEP 2

Use the replacement kit (STP54-077) to attach the new mounting brackets. To install the new brackets, start by installing two mounting screws into the two innermost holes.

Note: The above mentioned innermost holes will line up with the holes from the bracket that was removed.

Note: To avoid over-torquing these screws, it is recommended that final tightening be by hand with a 3/8" wrench.

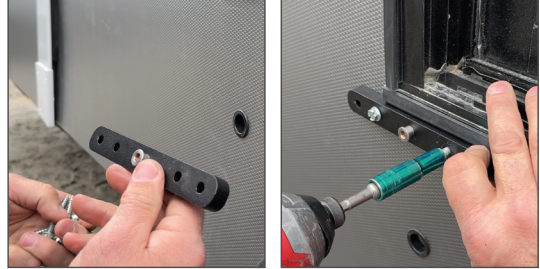

STEP 3

Use a drill and 3/16" drill bit to pre-drill pilot holes for the outermost holes.



STEP 4

Use an impact driver and 3/8" sockets to install the outer two mounting screws in each of the two mounting brackets.

Note: To avoid over-torquing these screws, it is recommended that final tightening be by hand with a 3/8" wrench.

