



Technical Service Bulletin

GROUP RECALL	NUMBER 25-01-015H
DATE FEBRUARY 2025	MODEL(S) IONIQ 5 N (NE EV N)

SUBJECT: VCU AND IEB SOFTWARE UPDATES FOR LEFT FOOT BRAKING
(RECALL 275)

* IMPORTANT

Vehicle repairs related to safety recalls are critically important and must be performed properly in accordance with TSB procedures. Review this bulletin in its entirety prior to beginning any repair work.

As required by federal law, dealers must not deliver new vehicles for sale or for lease to customers until all open recalls have been performed. Dealers must also perform all open recalls on used vehicles, demo, and rental vehicles prior to placing them into customer use and whenever an affected vehicle is in the shop for any maintenance or repair.

Access the "Vehicle Information" screen via WebDCS to identify open recalls.

Description: Certain 2025MY IONIQ 5 N (NE EV N) are equipped with a Left-Foot Braking (LFB) feature designed for use on performance roadways, such as racetracks. LFB allows operators to control vehicle speed through simultaneous operation of both the accelerator and brake pedals. During certain driving maneuvers with LFB engaged, the Integrated Electronic Brake (IEB) control software may trigger depressurization of the ABS system, resulting in reduced braking performance.

Reduced braking performance could lead to longer stopping distances than anticipated by the operator, increasing the risk of a crash. Follow the procedure in this TSB to update the software for **both** the IEB (ABSESC) **and** Vehicle Control Unit (VCU) systems.





Applicable Vehicles (Certain):

- 2025MY IONIQ 5 N (NE EV N) produced 12/18/2023 – 12/10/2024

NOTICE

To avoid any potential damage to IONIQ vehicles, this service campaign can only be performed at IONIQ certified dealers.

SST Information:

Tool Name	Tool Number	Figure	Remarks
VCI 3	G0VHNNN06		VCI 3 can be utilized to complete the software updates without additional hardware. If using VCI 2, the ECI Kit will be required to complete the software updates. Ordering information: Website: https://hyundaiesentialtools.com/ Phone: 1-855-763-9199 Email: Hyundaitools@snapon.com Hours: 7 AM – 7 PM CST
VCI 2	G1XDDMN001		
Ethernet Communication Interface (ECI) Kit	G0XDDMN052	 + 	

GDS Information:

Model	System	Event Number	Remarks	Description
IONIQ 5 N (NE EV N)	ABSESC	1219	Required Software Update #1	NE N IEB LOGIC IMPROVEMENT(LFB)
	VCU	1220	Required Software Update #2	NE N VCU LOGIC IMPROVEMENT(LFB)

(*or use a later available event as listed in the GDS **ABSESC** and **VCU** Update screen if one is available.)

NOTE 1: Both update events 1219 and 1220 **MUST** be performed to qualify for claim submission.

Warranty Information:

Model	Op. Code	Operation	Op. Time	Causal Part	Nature Code	Cause Code
IONIQ 5 N (NE EV N)	51D029R0	VCU and IEB Software Updates	0.7 M/H	58520-NI000	I14	ZZ3

NOTE 1: Submit claim on Claim Entry Screen as “Campaign” type.

NOTE 2: If a part is found in need of replacement while performing this recall and the affected part is still under warranty, submit a separate claim using the same repair order. If the affected part is out of warranty, submit a Prior Approval request for goodwill consideration prior to performing the work.

NOTE 3: Op times include VIN, Mileage, and photo capture of the “ECU update complete” screen as outlined in the Digital Documentation Policy. Required photos include “ECU update complete” screens for **both** events 1219 and 1220.

NOTE 4: Claim is subject to debit if either software (1219 and 1220) is **NOT** updated successfully. **Both** software updates are required to qualify and prevent claim rejection.

ROM ID Information:

Model	Event Number	System	ECU Part Number	ROM ID	
				Old	New
IONIQ 5 N (NE EV N)	1219	ABSESC	58520-NI000	1.00 ~ 1.04	1.05
	1220	VCU	39751-1XPN1	NE1N-45E-N03-S00	NE1N-45E-N03-S03
				NE1N-45E-N03-S01	
NE1N-45E-N03-S02					

Service Procedure:

DIGITAL DOCUMENTATION



This TSB includes Repair validation photos. Refer to the latest Warranty Digital Documentation Policy for requirements.

NOTICE

You must initially perform the GDS ECU update in Auto Mode.

- If the ECU update starts but then fails in Auto Mode, perform the update in Manual Mode to recover.

NOTICE

Ensure the vehicle's battery charge is **above 11.0V** and the tablet's battery charge is **above 30%** before performing a software update to avoid the update from failing.

***i* Information**

- Turn off all lamps (do **NOT** leave head lamp switch in auto mode) and all accessories.
- Perform update with the ignition switch in the **ON** position.
- Do **NOT** disconnect any cables connected to the vehicle or scan tool during update.
- Do **NOT** start the engine during update.
- Do **NOT** turn off the ignition switch during update.

ECU Update Procedure

1. Perform the **first** of 2 required ECU updates in **Auto Mode (ABSESC)**.

NOTICE

Both **ABSESC** and **VCU** systems **must** be updated.

Use the **ID Check** to verify the ROM ID before updating the software.



Information

Refer to **TSB # 24-GI-012H**, “**ECU Update Procedure for Tablet-Based GDS-Smart**”, for additional information.

2. Select the **ABSESC** system to scan the vehicle’s current ROM ID and then begin the update.

NOTICE

Check the current ROM ID version and compare it to the ROM ID Information table before attempting to perform the software update.

NOTICE

If the update fails, please remove the power connector or the battery (–) connector from the indoor fuse box for at least **5 seconds** and reassemble it to retry the update.

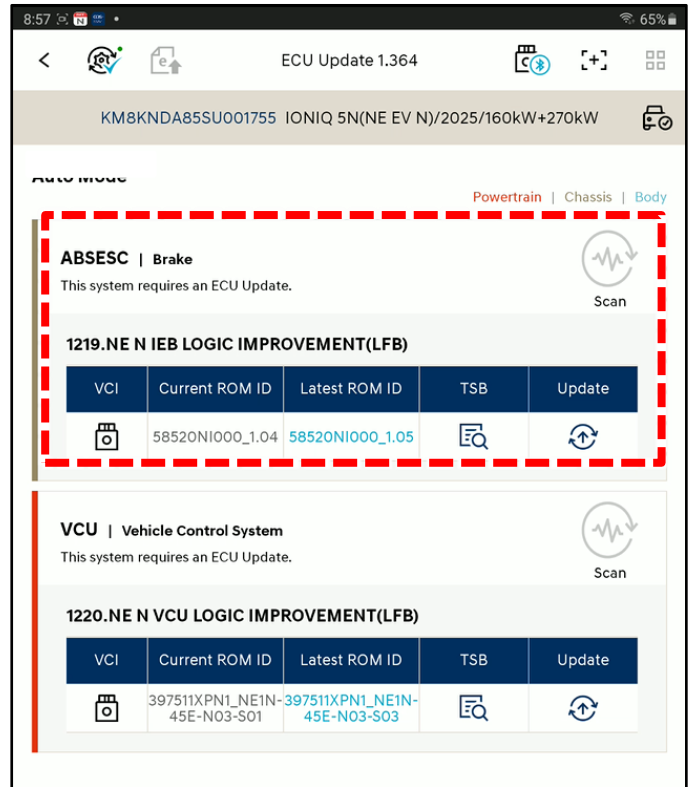
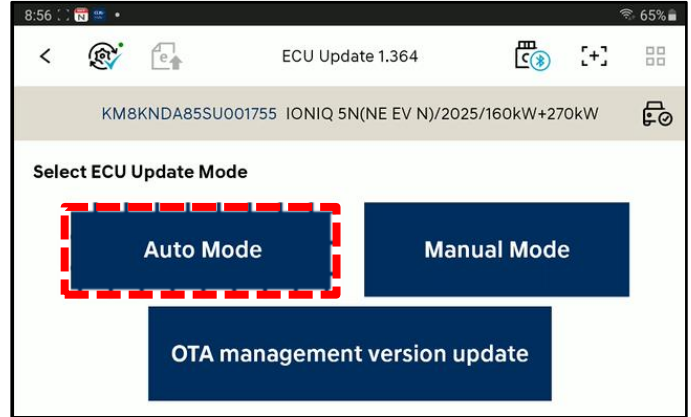

- After the ECU update process shows **100%** complete, follow the prompts on the screen to cycle the ignition for the prescribed time.



Information

Use the **Refresh** button to reset the timer.

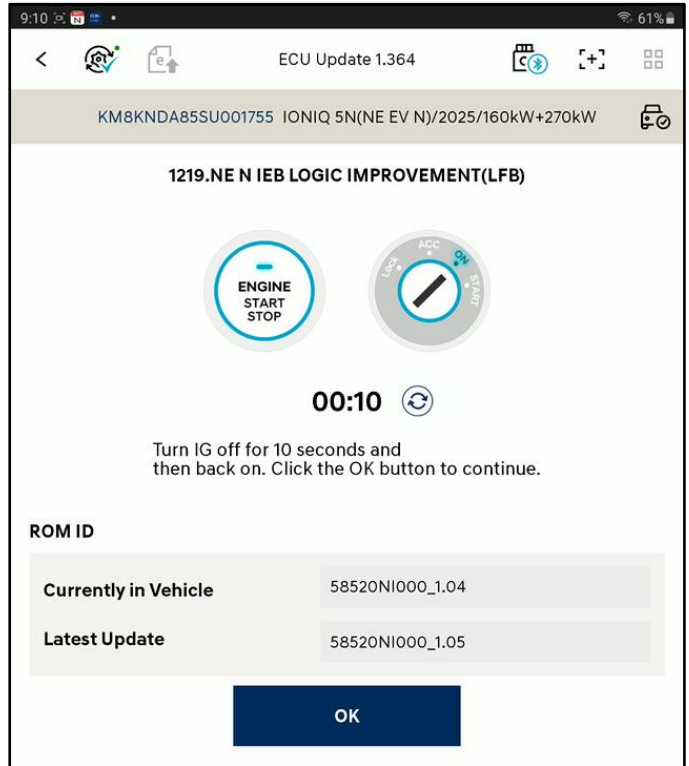

-

DIGITAL DOCUMENTATION



Take a screenshot of the ECU update complete screen using your tablet and upload to STUI (IEB, 1 of 2 required).

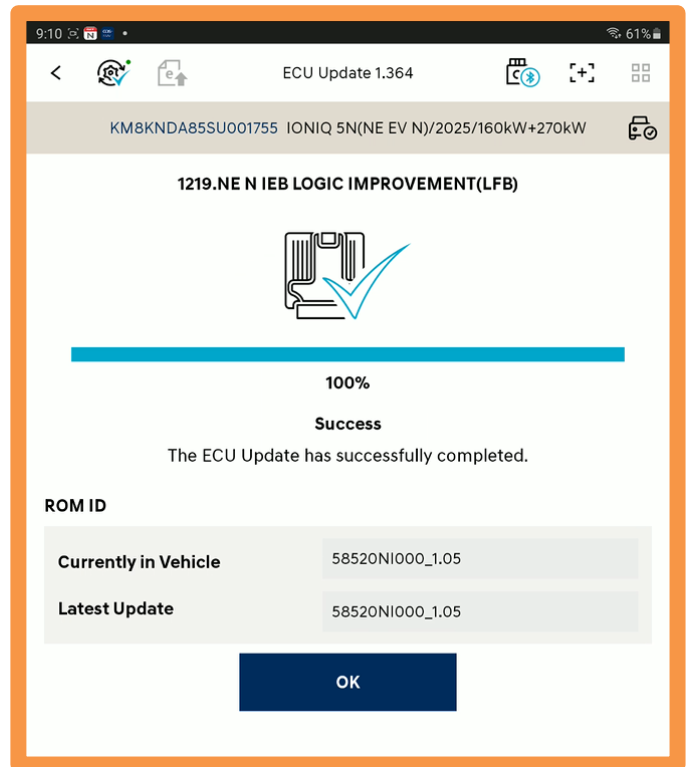

5. OTA initialization (A) should perform automatically:
- If OTA initialization performs automatically, then proceed with the service procedure.
 - If the OTA initialization process fails, complete it manually under:
S/W Management > CCU_CCNF - Central Communication Unit (CCNF) > OTA Initialization (B).

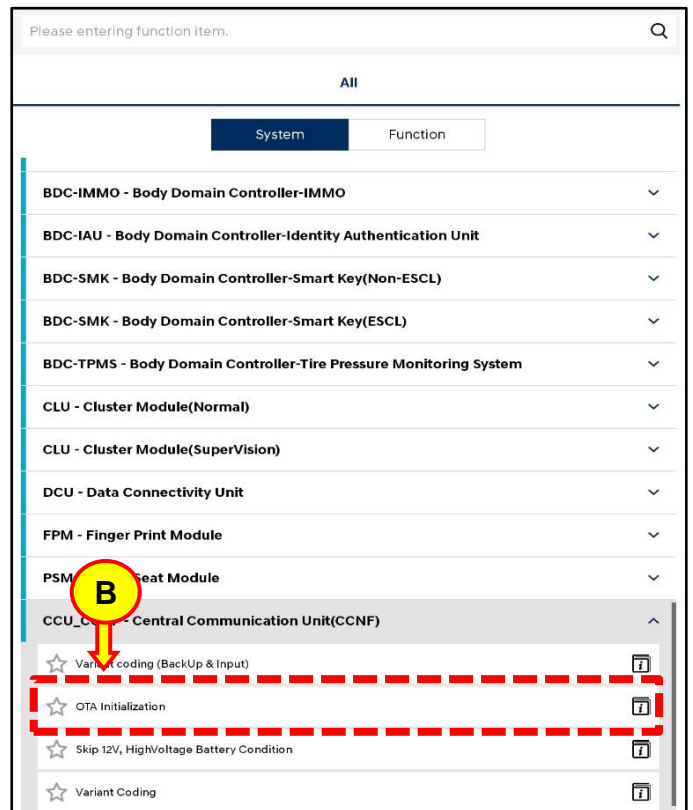
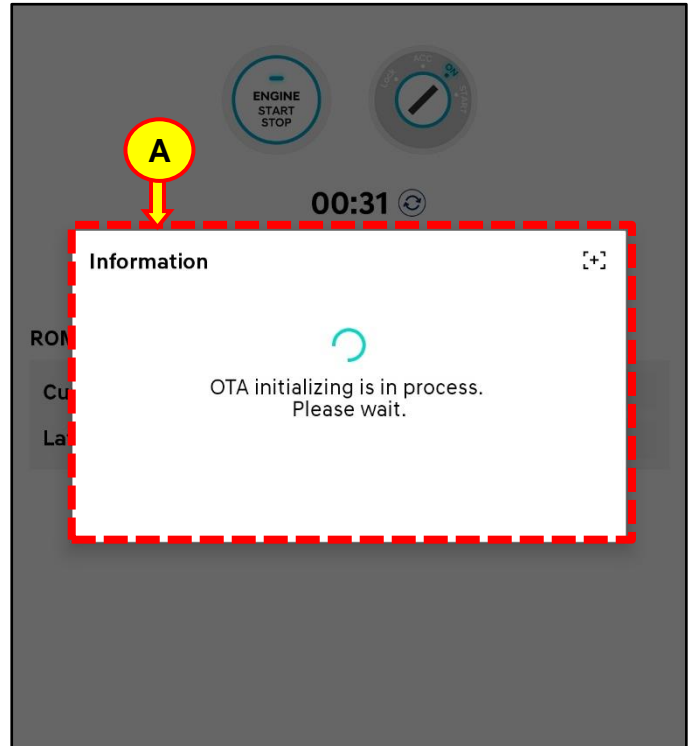

- Perform an **All Systems Fault Code** search and erase DTC history that had incidentally occurred from the ECU update.

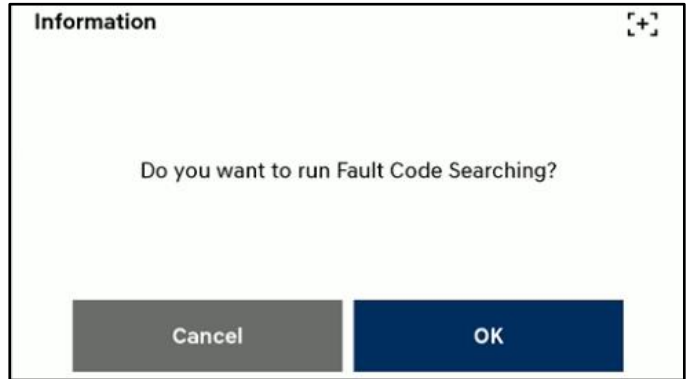

- Disconnect the power connector (C) of the indoor fuse box, wait at least **5 seconds**, then reconnect it.

i Information

Alternatively, disconnect the negative (-) **12V** battery terminal, wait **5 seconds**, then reconnect it.

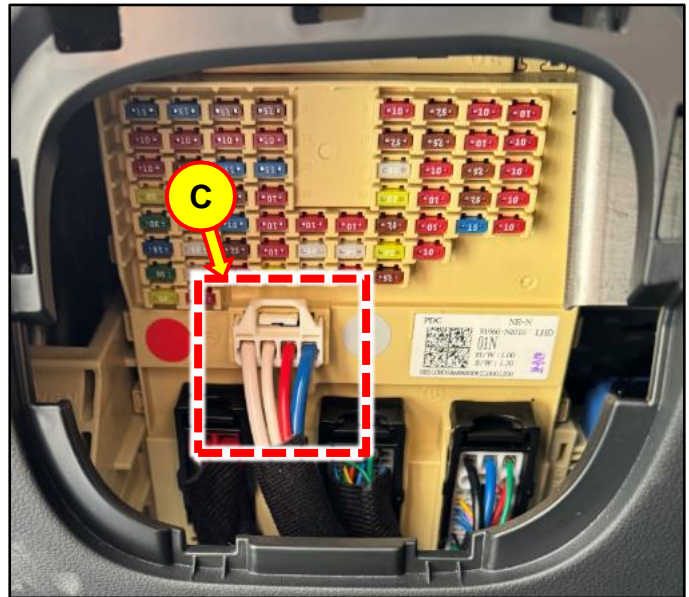

- Perform the **second** of 2 required ECU updates in **Auto Mode (VCU)**.

NOTICE

Both **ABSESC** and **VCU** systems **must** be updated.

Use the **ID Check** to verify the ROM ID before updating the software.

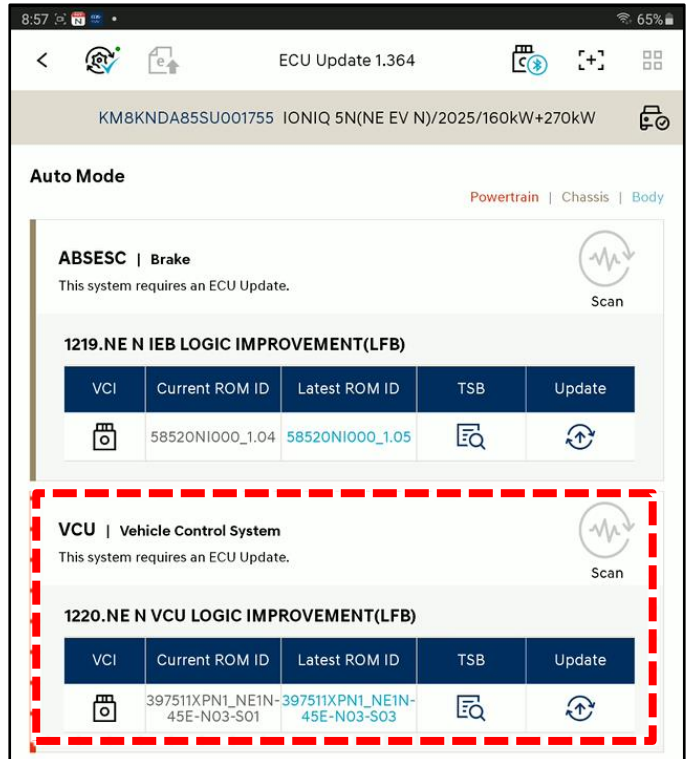

9.

DIGITAL DOCUMENTATION



Take a screenshot of the ECU update complete screen using your tablet and upload to STUI (VCU, 2 of 2 required).

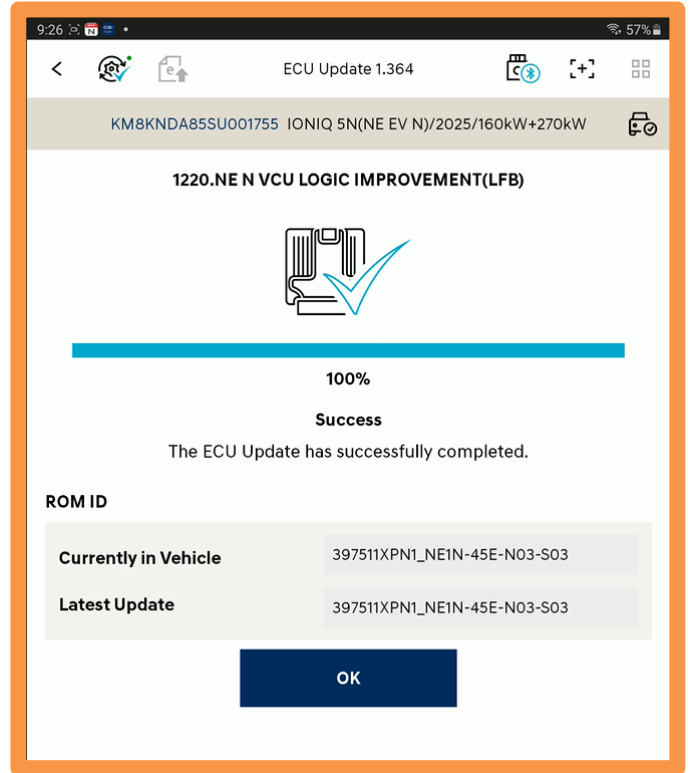

10. Perform steps 5 – 7 above to complete the update.

11. Place in **Ready** mode to confirm proper operation of the vehicle.

NOTICE

If either ECU update fails in Auto Mode, perform the update in Manual Mode using the password(s) below.

Manual Mode Password:

Event Number	ECM Menu	Password
1219	NE N IEB 58520-NI000	5420
1220	NE N VCU 39751-1XPN1	2103