



Recall Instructions

R25DH: FMVSS 108 Noncompliance - High & Low Beam Reversed Operation

Models Affected:

- Certain Model Year 2024 - 2025 Blue Bird All American School Buses
 - Manufactured from June 24, 2024 through July 30, 2024
- Certain Model Year 2025 Blue Bird All American Non-School Buses
 - Manufactured on June 26, 2024

Issue:

- Reversed headlamp operation between High & Low Beams due to improperly pinned circuit wires on the RH and LH headlamp jumper harness

Corrective Action:

- Replace jumper harness on RH and LH side headlamps

Component Code:

- 50-200-145

SRTs:

- 0.3 hour (18 minutes)

Part(s) Needed:

- Qty (2) 10081142 - HARNESS,JUMPER,HEADLAMP



Recall Instructions

R25DH: FMVSS 108 Noncompliance - High & Low Beam Reversed Operation

[WARNING] Observe all safety precautions to secure the bus from rolling and for use of ladders or scaffolds. Thoroughly read and understand all instructions before performing these procedures. Park bus on level surface, apply parking brake, turn off ignition key, and chock wheels.

Instructions Page 1:

1. Open wiper access door to gain access to headlamp area on RH and LH sides.



2. Locate headlamp jumper harness on headlamp.



3. "1" Release lock by sliding back towards wiring and press "2" release tab to remove connector from headlamp.

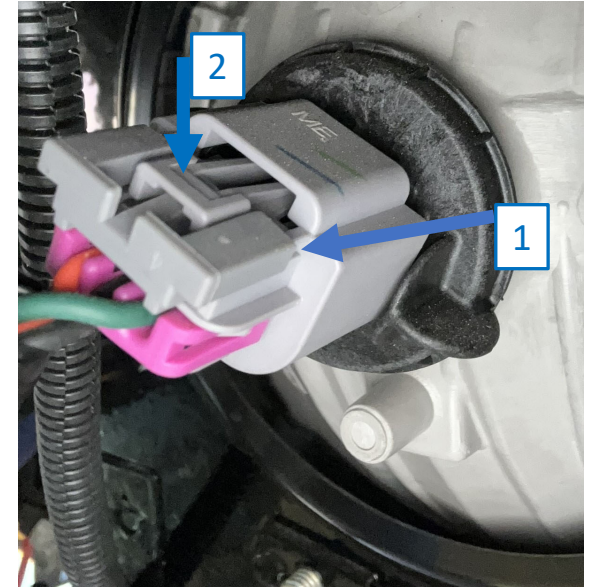



Recall Instructions

R25DH: FMVSS 108 Noncompliance - High & Low Beam Reversed Operation

Instructions Page 2:

4. Disconnect jumper harness from body electrical harness by holding both connectors and pull apart. Discard removed jumper harness.

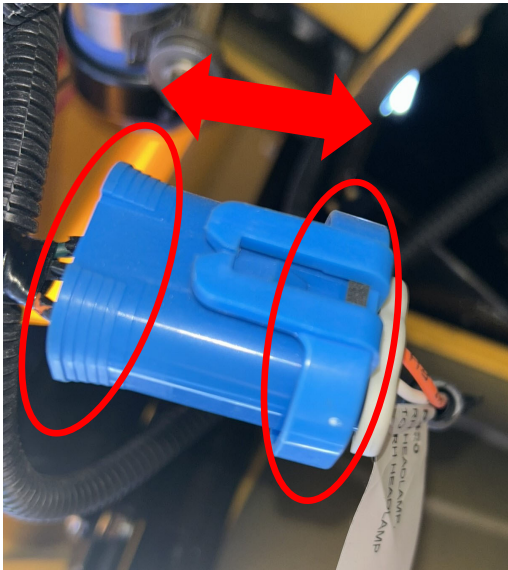

5. Install new jumper harness onto body electrical harness by pushing the connectors together.





Recall Instructions

R25DH: FMVSS 108 Noncompliance - High & Low Beam Reversed Operation

Instructions Page 3:

6. Make sure the lock is in unlock position and connect to headlamp.

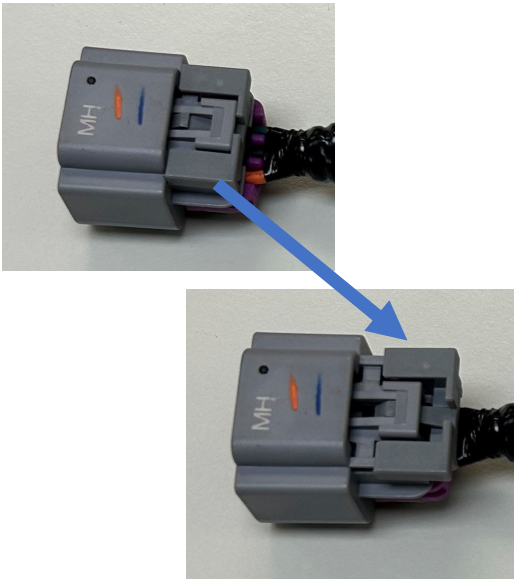

7. Slide the lock into locked position.



8. Close wiper door and secure the latches.





Recall Instructions

R25DH: FMVSS 108 Noncompliance - High & Low Beam Reversed Operation

Instructions Page 4:

Repair Verification: Test High & Low Beam headlamp operation, verifying High Beam Indicator on dash is illuminated with High Beams "ON".

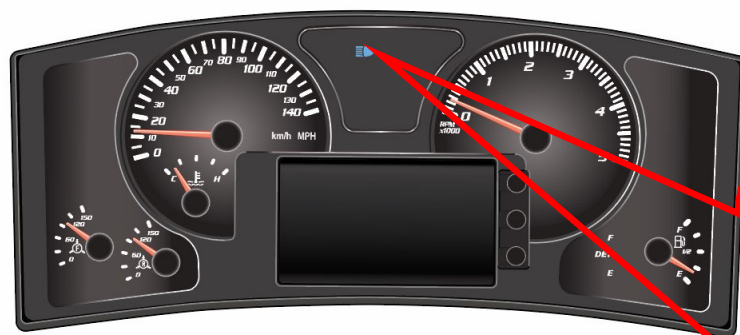

High/Low Beam



Left Switch Stalk