



Service Bulletin

American Honda Motor Co., Inc.

VFR1200 #1
Revised: September 2025

SAFETY RECALL

2010, 2012, 2013 VFR1200F/FD Fuel Pump Inspection / Replacement

(This bulletin has been updated to revise the identification label information.)

BACKGROUND

Honda is launching a **SAFETY RECALL** on **CERTAIN** 2010, 2012, 2013 VFR1200F/FD motorcycles to inspect and, if necessary, replace the fuel pump assembly. Due to a manufacturing defect, the rubber impeller inside the fuel pump can warp or swell when exposed to fuel, causing the impeller to lock in place and prevent fuel flow to the engine. A locked impeller can cause the engine to stall without warning while riding.

AFFECTED UNITS

As of November 13, 2024, **YOU MUST NOT SELL CERTAIN NEW or USED** 2010, 2012, 2013 VFR1200F/FD motorcycles until they are repaired according to this Service Bulletin.

- To search for applicable recalls on a specific unit, you **MUST** use *Unit Information* on **iN**.
- To manage your affected new inventory, use your dealer *eResponsibility Report* on **iN**.

CUSTOMER NOTIFICATION

American Honda intends to mail customer letters to all owners of affected 2010, 2012, 2013 VFR1200F/FD motorcycles in January 2025. Customers will be informed that their motorcycle may be affected by a safety related defect and will be advised to make an appointment with an authorized Honda dealer for repair.

PARTS INFORMATION

Parts are under TechLine control. You **MUST** contact TechLine to have the part released.

Description	Part Number	Qty.
Fuel Pump Kit	06160-MGE-305	1
Kit Includes:		
Description	Part Number	Qty.
Assembly, Fuel Pump Unit	16700-MGE-023	1
Packing, Fuel Pump	17574-MFJ-D00	1
Seal, Outer	17576-MFJ-D00	1
Damper, Connector	17711-MGE-003	1

DEALER REPAIR RESPONSIBILITY

- Repairs must be performed by a qualified technician.
- Performing this repair exactly as shown in Repair Procedure instructions is critical for the remedy to be effective. Carefully follow all instructions.
- Service Management should inspect and confirm the repair.
- Dealer submission of a warranty claim affirms this repair was properly performed.

WARRANTY CLAIM INFORMATION

After completing this *Service Bulletin* update, submit one warranty claim per unit with the following template number. **A photo of the defective fuel pump identification label will be required for all KR4B replacement claims. If the pump is found to be in the defective range, contact TechLine for further instructions.**

MODEL	TEMPLATE	FLAT RATE
2010 • 2012 • 2013 VFR1200F/FD	Inspection: KR4A Replacement: KR4B	1.1 1.2

DEALER SUPPORT

TECHNICAL QUESTIONS

If you have any technical questions relating to this update procedure, please contact:
Motorcycle TechLine Online:

iN > Service > TechLine > TechLine Connect
Or call (800) 421-1900, option 9

WARRANTY QUESTIONS

If you have any warranty administration questions relating to warranty claim templates, and claim filing procedures, please contact:
Motorcycle Warranty Online:

iN > Service > Warranty & HondaCare > Warranty Connect Filing
Or call (800) 421-1900, option 7

REPAIR IDENTIFICATION

Before you begin the repair procedure, verify that the unit has not already been repaired by searching *Unit Information* on ***iN***.

REPAIR OVERVIEW

Affected units must have the fuel pump inspected to determine if it has an affected LOT number by following the FUEL PUMP INSPECTION on [page 2](#).

If the fuel pump has an affected LOT number, the pump must be replaced following the FUEL PUMP REPLACEMENT procedure on [page 3](#) and then reassembled ([page 8](#)).

FUEL PUMP INSPECTION

Follow the procedure starting on [page 3](#), and then determine if the fuel pump has an affected part number and LOT number using the information below.

The fuel pump number must be inspected to determine if the fuel pump lot number is in the range to be replaced.

Inspect the identification label [1] affixed to the top of the fuel pump.

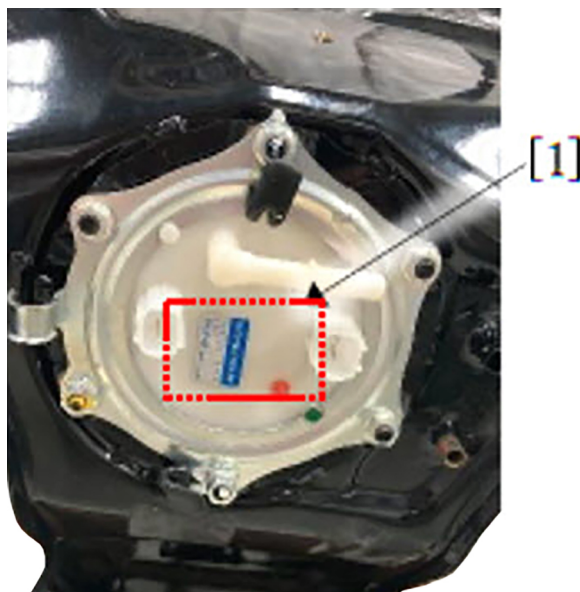

1. Check the part number of the pump.

For pumps with the last three digits of the part number **are not 013**, the pump **does not** need to be replaced and no repair is required. Proceed to filing an “Inspection Only” warranty claim.

For pumps with the last three digits of the part number **are 013**, proceed to step 2 to check the LOT number.

- Check the LOT number located in the bottom right-hand corner of the label. If the LOT number shows the production date is in the August 8, 2017 to April 30, 2020 range, the fuel pump must be replaced following the FUEL PUMP REPLACEMENT procedure on page 7.

Reassemble the unit following the MOTORCYCLE REASSEMBLY procedure on page 9.

Label examples:

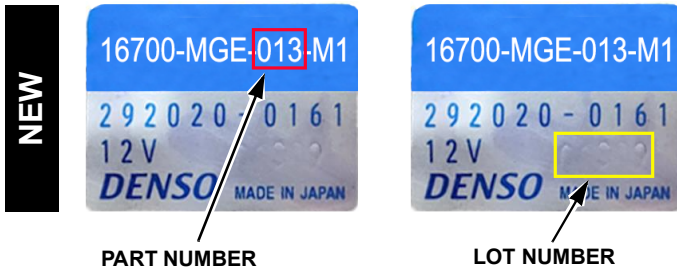

PART NUMBER

LOT NUMBER

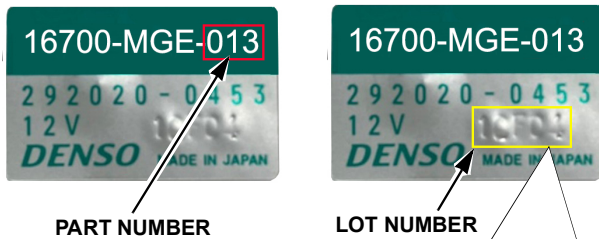

PART NUMBER

LOT NUMBER

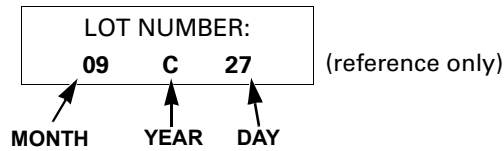

U: 2017 = Check the date
B: 2018 = Replace pump
C: 2019 = Replace pump
D: 2020 = Check the date
All YEAR letters not listed above are not affected by this safety recall.

Replace the fuel pump if the LOT number is in the 08U08 to 04D30 range (Aug. 8, 2017 to Apr. 30, 2020).

FUEL PUMP ACCESS

FUEL REMOVAL

Remove the fuel from the fuel tank before removing the fuel tank.

Drain the fuel into a clean container for refilling the tank after procedure is complete.

SEAT REMOVAL

Unlock the seat [1] using the ignition key [2]. Pull the seat back and remove it.

Installation is in the reverse order of removal.

- Install the seat while aligning its hooks [3] with the retainers on the fuel tank and seat rail.
- Push the seat forward, then down to lock it.

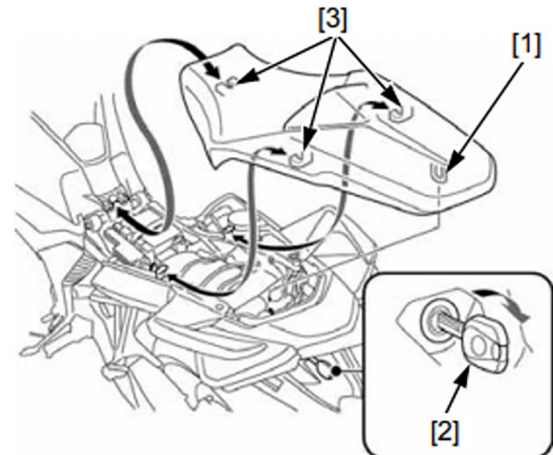

INNER LOWER COWL REMOVAL

Remove the clips [1], special bolt A [2], special bolt B [3] and inner lower cowl [4].

NOTE:

Be careful not to damage the tabs.

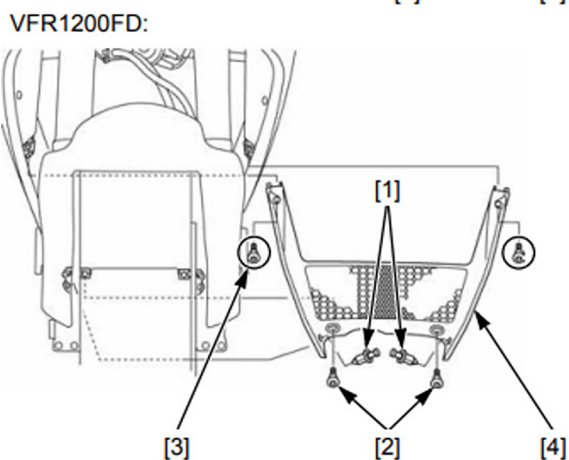
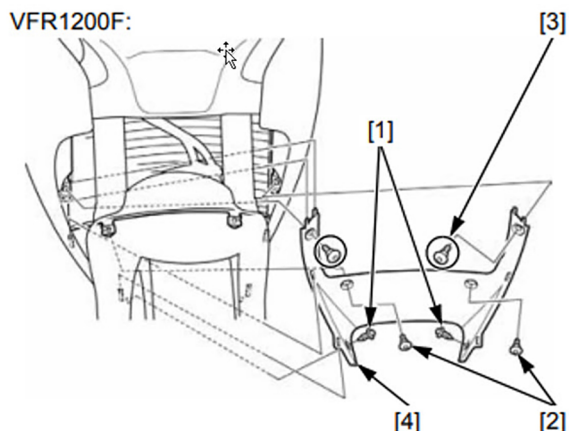

MIDDLE COWL REMOVAL

1. For each side, remove the two special bolts [1] and three clips [2].
2. Remove the middle cowl [3] forward by release the three hooks [4] and two bosses [5].

NOTE:

Be careful not to damage the tabs and bosses.

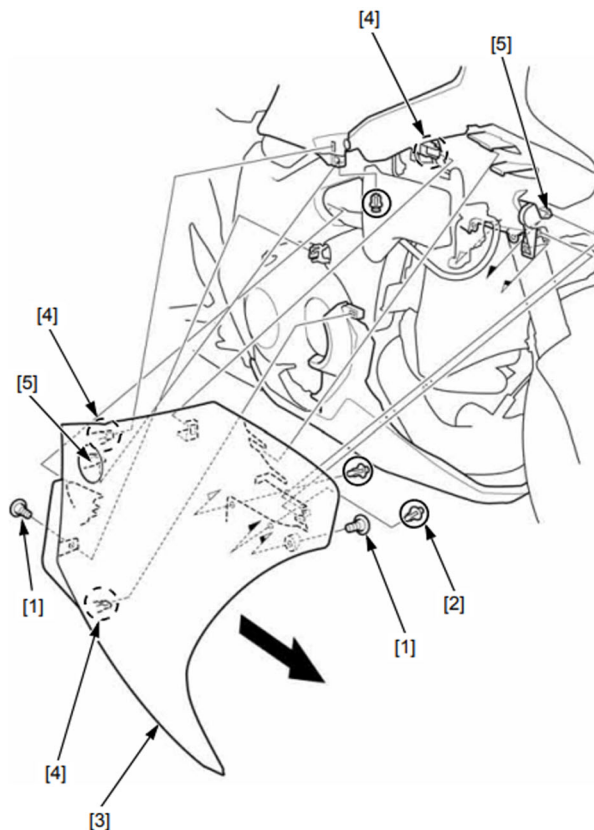

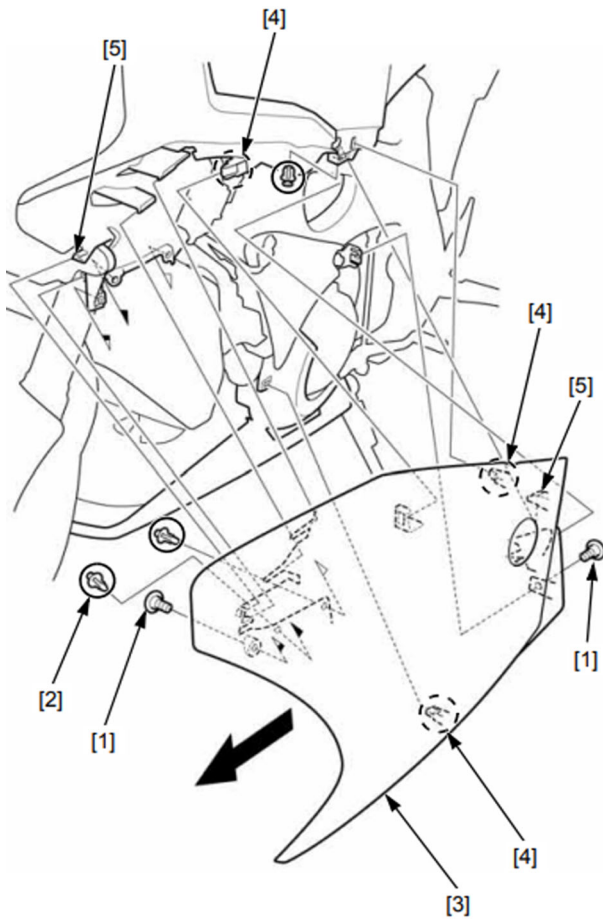

FUEL TANK COVER REMOVAL

1. Remove the trim clip [1] and left knee guard [2] by releasing the hook [3] and tabs [4].
2. In the same manner, remove the right knee guard.

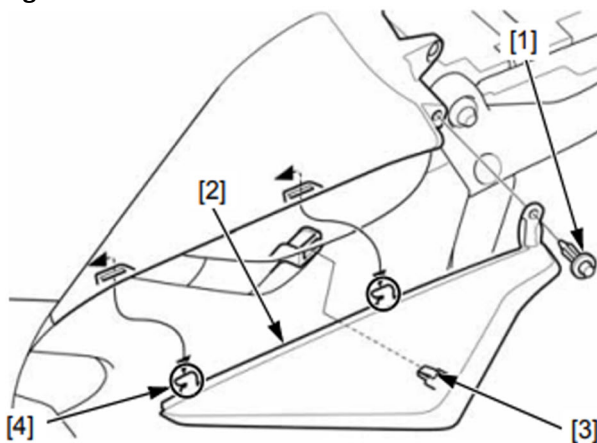

3. Remove the two trim clips [1] and four socket bolts [2].

4. Release the dual lock fasteners [3] of the fuel tank cover from the fuel tank.
5. Release the bosses [4] on the fuel tank covers [5] from the fuel tank.
6. Remove the fuel tank cover while releasing its tabs [6] from the upper side cowl grooves [7].

NOTE:
Be careful not to damage the fuel tank cover tabs.

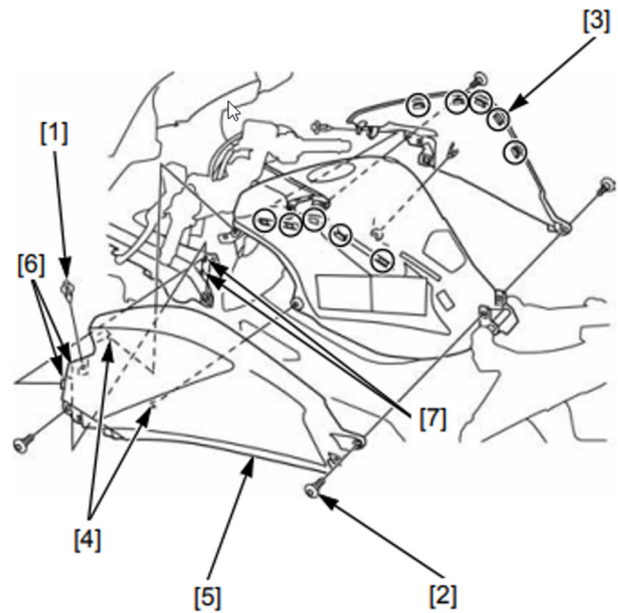

FUEL PRESSURE RELIEVING / QUICK CONNECT FITTING REMOVAL

1. Remove the two fuel tank mounting bolts [1].



2. Lift the fuel tank [1].

Support the fuel tank using a suitable support [2] as shown.



3. Before disconnecting the fuel hose, relieve any fuel pressure from the system as follows.

- a. Turn the ignition switch OFF.
- b. Remove the quick connect fitting cover [1] (fuel pump side only).
- c. Disconnect the fuel pump 2P (Brown) connector [2].



- d. Start the engine and let it idle until the engine stalls.
- e. Turn the ignition switch OFF.

6. Remove the battery holder band [1].

7. Disconnect the negative cable [2] and then the positive cable [3].

8. Remove the battery [4].

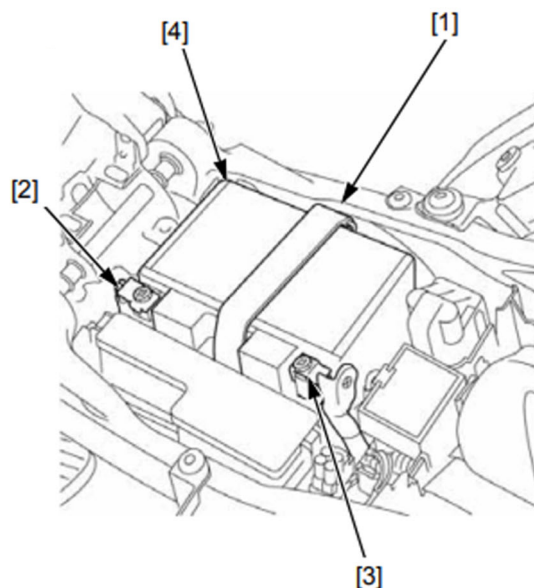

9. Check the fuel quick connect fitting for dirt, and clean if necessary.

10. Place a shop towel over the quick connect fitting.

11. Hold the connector [2] with one hand and squeeze the retainer tabs [3] with the other hand to release them from the locking pawls [4].

Pull the connector off, then remove the retainer from the fuel joint.

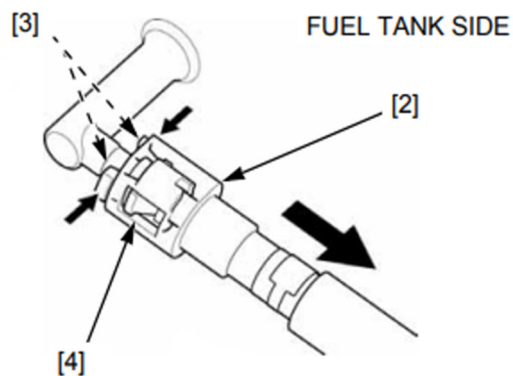

NOTES:

- Absorb the remaining fuel in the fuel hose from flowing out with a shop towel.
- Be careful not to damage the hose or other parts.
- Do not use tools.

- If the connector does not move, keep the retainer tabs pressed down, and alternately pull and push the connector until it comes off easily.
- To prevent damage and keep foreign matter out, cover the disconnected connector and fuel joint with plastic bags [1].

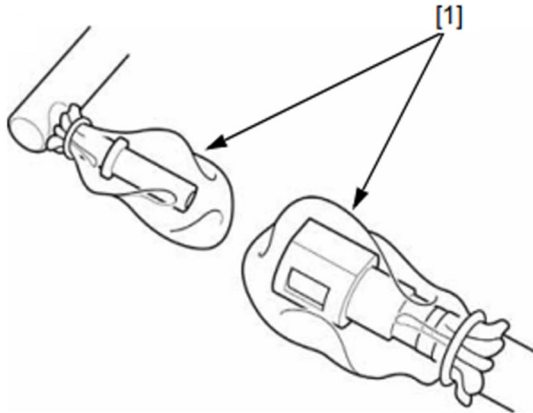

FUEL TANK REMOVAL

1. Disconnect the fuel reserve sensor 2P (Black) connector [1].
2. Remove the overflow hose from the clamps [2].



3. Disconnect the air vent hose [1] and overflow hose [2] from the fuel tank.
4. Remove the air vent hose and overflow hose from the clamps [3].

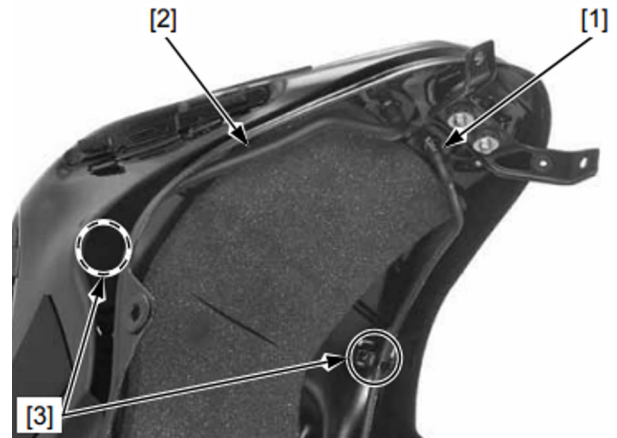

5. Remove the fuel tank pivot bolt, washer and mounting nut [1], then remove the fuel tank [2].

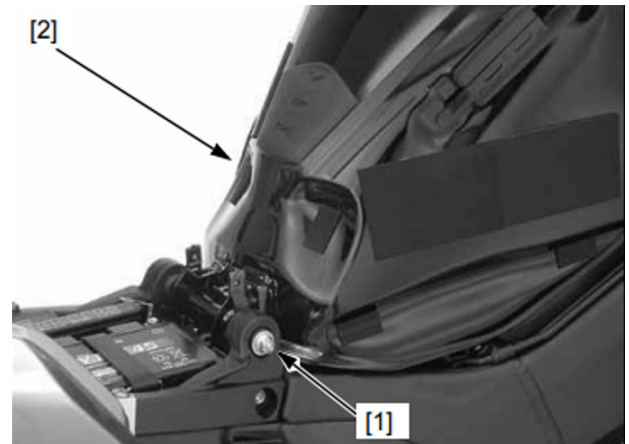

FUEL PUMP INSPECTION

See UNIT INSPECTION on page 3 for details.

If the fuel pump is not in the affected range, reassemble the motorcycle ([page 9](#)).

If the fuel pump is in the affected range, replace the fuel pump ([page 8](#)).

FUEL PUMP REPLACEMENT

1. Remove the fuel pump unit mounting nuts [1], clamp [2] and fuel pump stay [3].



2. Remove the fuel pump unit [1] and packings [2].

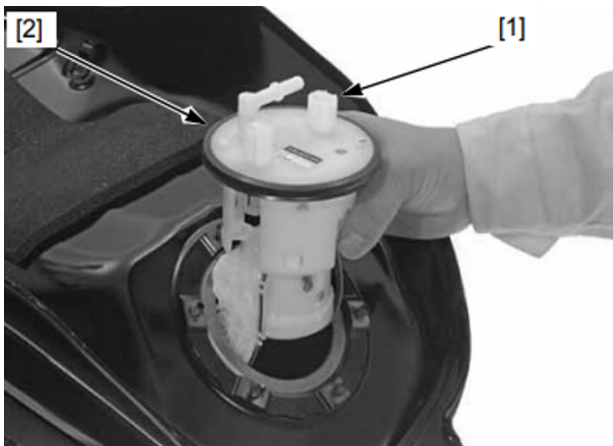

NOTE:
Be careful not to damage the pump wire and fuel level gauge.

Installation is in the reverse order of removal.

- Place new packings onto the fuel pump unit [2].
 - Be careful not to damage the pump wire and fuel level gauge.
 - **TORQUE:**
12 N·m (1.2 kgf·m, 106 in·lb)
3. Install the battery holder band [1].

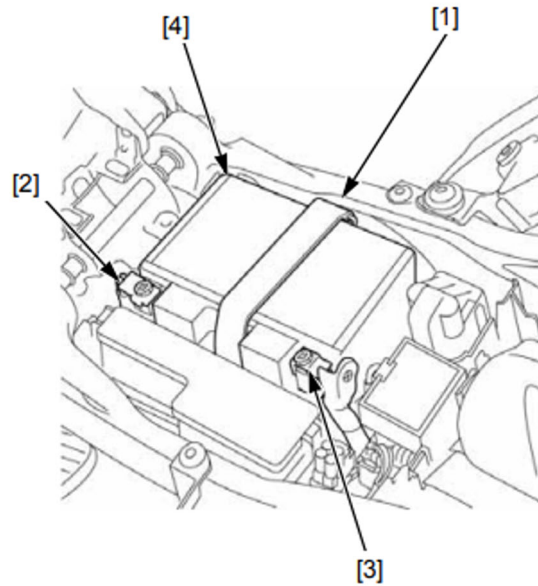

4. Install the quick connect fitting cover [2] (fuel pump side only).



5. Turn the ignition switch ON and engine stop switch.

The fuel pump will run for about 2 seconds, and fuel pressure will rise.

Repeat 2 or 3 times, and check that there is no leakage in the fuel supply system.

MOTORCYCLE REASSEMBLY

FUEL TANK INSTALLATION

NOTICE

- Route the hoses, wires and harness properly.
 - Be careful not to damage the harness and hose.
 - After installing the fuel tank, make sure the drain, air vent, overflow hose and fuel hoses are not kinked or bound.
1. Install the fuel tank [2], the fuel tank pivot bolt, washer and mounting nut [1],

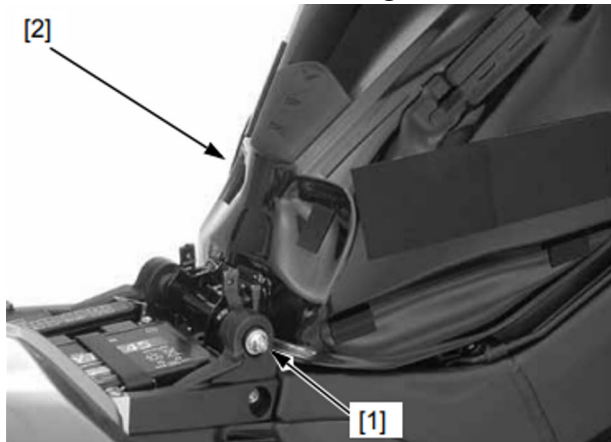

2. Place the air vent hose and overflow hose into the clamps [3].

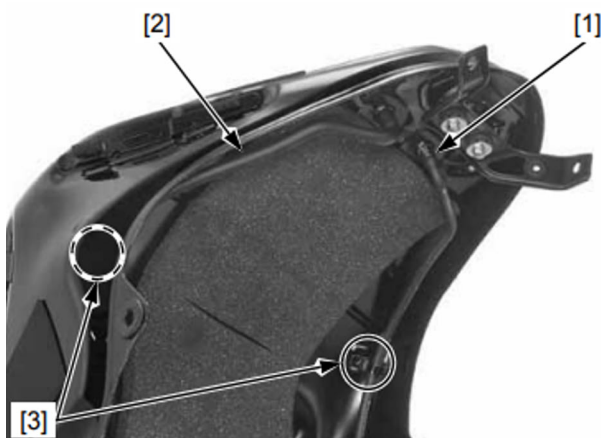

3. Connect the air vent hose [1] and overflow hose [2] to the fuel tank.
4. Place the overflow hose into the clamps [3].



5. Connect the fuel reserve sensor 2P (Black) connector [2].

**QUICK CONNECT FITTING
INSTALLATION**

NOTES:

- Always replace the retainer and rubber cap of the quick connect fitting when the fuel hose is disconnected.
- Do not bend or twist the fuel feed hose.
- If any retainer needs replacing, use the same manufacturer's retainer as the ones being removed (The various manufactures feature different retainer specification).

1. Insert a new retainer [1] into the connector [2].

NOTE:

Align the retainer locking pawls with the connector grooves.

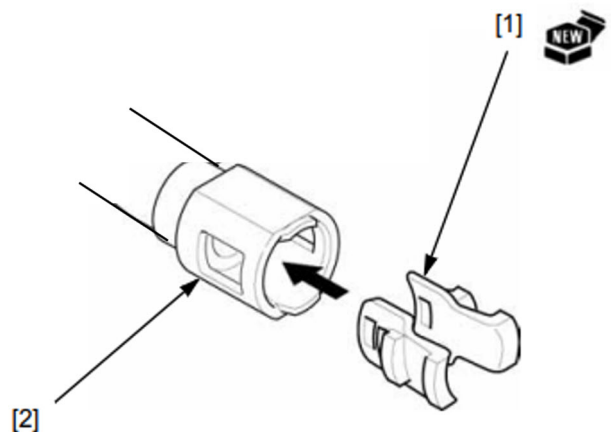

2. Align the quick connect fitting with the fuel joint. Then press the quick connect fitting onto the pipe until both retainer pawls [6] lock with a "CLICK".

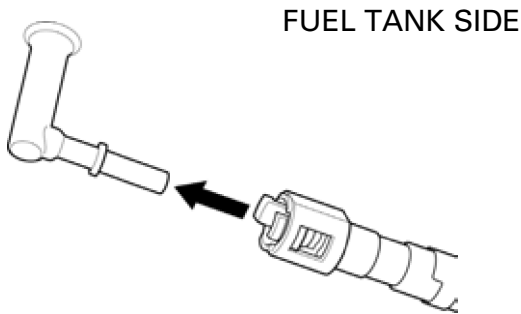

NOTE:
If it is hard to connect, put a small amount of engine oil on the pipe end.

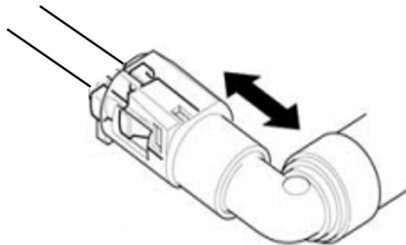

3. Make sure the connection is secure and that the pawls are firmly locked into place; check visually and by pulling the connector.
4. Make sure the rubber damper [8] is in place (between the flange [9] and retainer tab [10]).



5. Connect the fuel pump 2P (Brown) connector [1].
6. Install the battery [4].
7. Connect the positive cable [3] and then the negative cable [2].

8. Install the battery holder band [1].

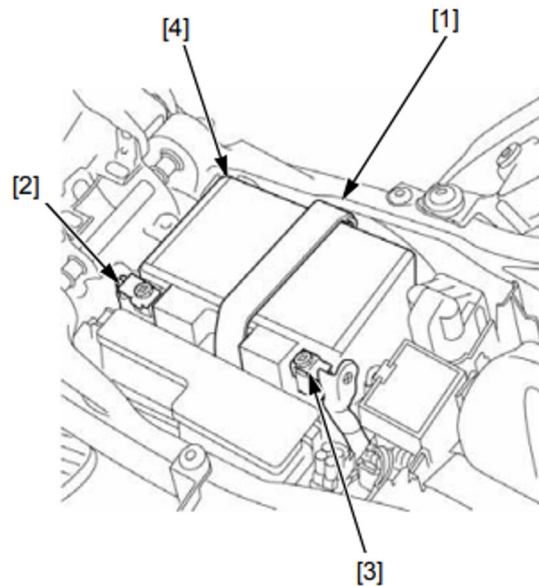

9. Install the quick connect fitting cover [2] (fuel pump side only).



10. Turn the ignition switch ON and engine stop switch.

The fuel pump will run for about 2 seconds, and fuel pressure will rise.

Repeat 2 or 3 times, and check that there is no leakage in the fuel supply system.

11. Support the fuel tank using a suitable support [2] as shown.

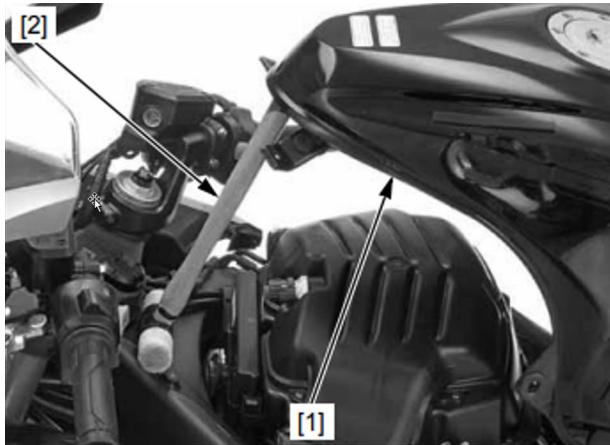

12. Remove the support, then close the fuel tank.
13. Install the fuel tank mounting bolts.
14. Tighten the bolts securely.

NOTE:

Be careful not to pinch the air vent and overflow hoses.

FUEL TANK COVER INSTALLATION

1. Install the fuel tank cover while inserting its tabs [1] into the upper side cowl grooves [2].
2. Set the fuel tank cover front side boss [3] into the fuel tank stay grommet [4].
3. Set the fuel tank cover center boss [5] into the fuel tank grommet [6].

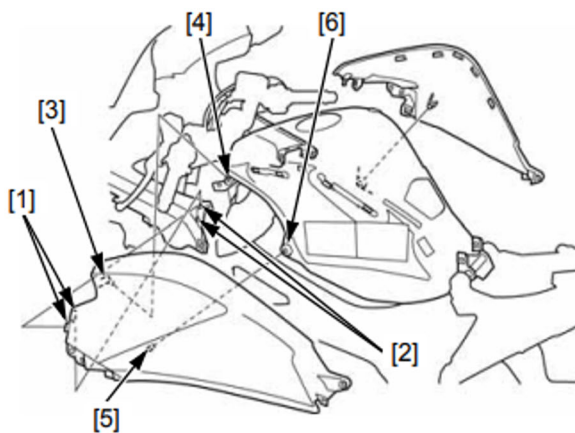

4. Install the fuel tank cover [1] by pushing the dual lock fastener position of the fuel tank cover in the following sequence.
 - Center [2] of dual lock fastener position

- Front side [3] of dual lock fastener position
- Rear side [4] of dual lock fastener position

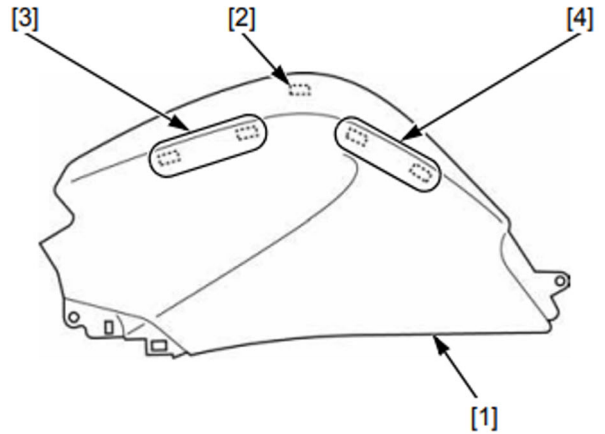

5. Install the two trim clips [1] and four socket bolts [2], then tighten the socket bolts securely.
6. Install the knee guards in the reverse order of removal.

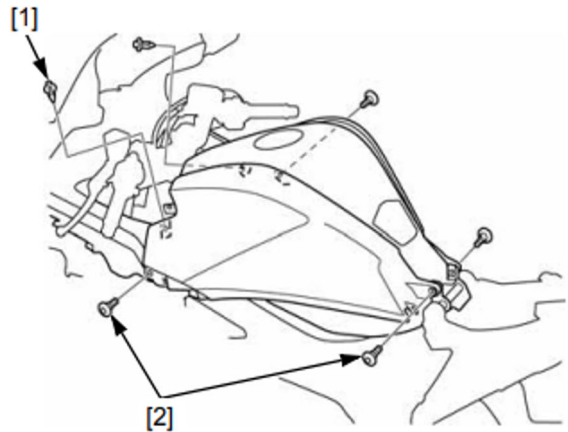

MIDDLE COWL INSTALLATION

NOTE:

Insert the tabs [3] under the rear fender B.

1. Install the two bosses [5], three hooks [4] and the middle cowl [3].
2. For each side, install the two special bolts [1] and three clips [2].

NOTE:

Be careful not to damage the tabs and bosses.

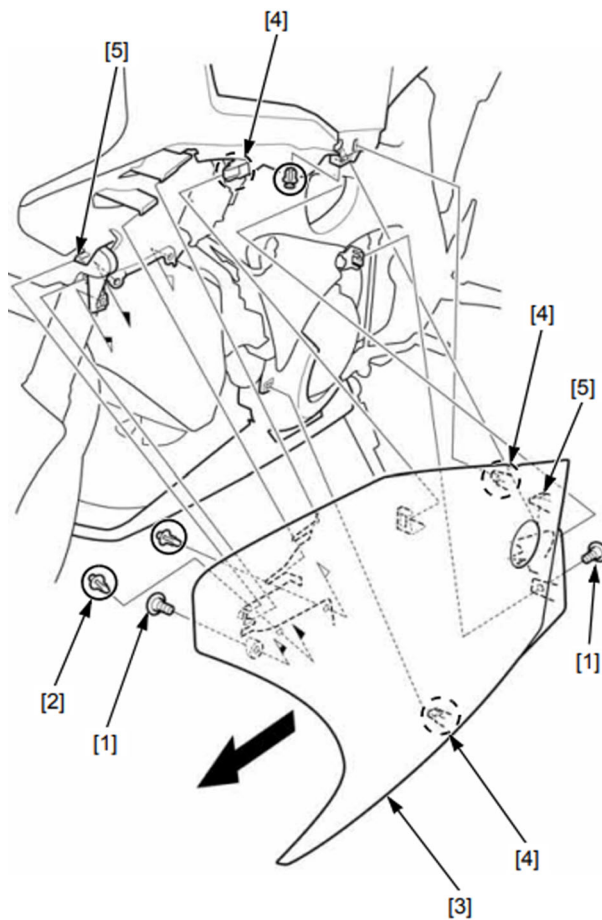
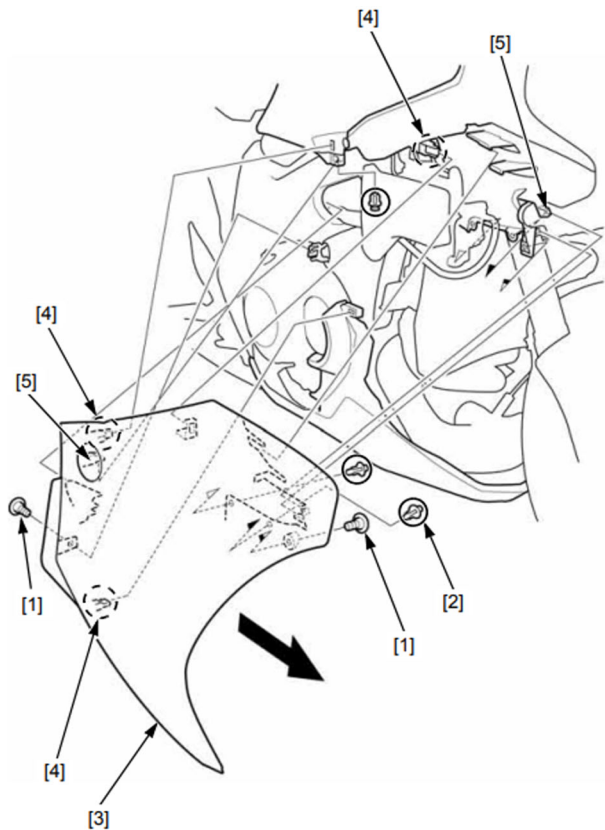

INNER LOWER COWL INSTALLATION

Install the inner lower cowl [3], special bolt B [2], special bolt A [1].

TORQUE: 9 N·m (0.9 kgf·m, 79 in·lb)

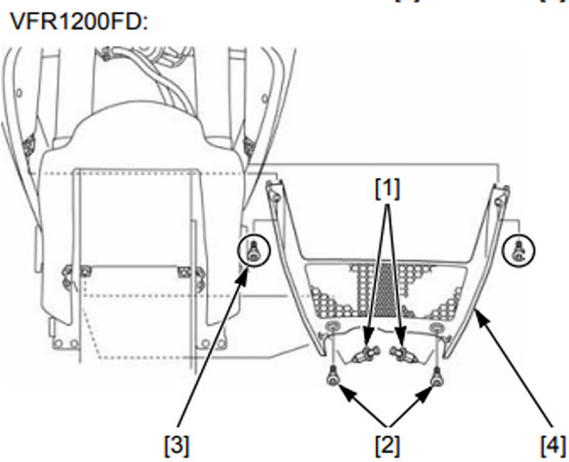
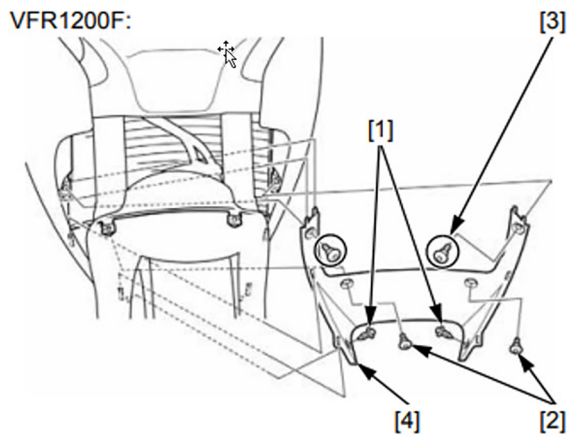

SEAT INSTALLATION

1. Install the seat while aligning its hooks [3] with the retainers on the fuel tank and seat rail.
2. Push the seat forward, then down to lock it.

