

P.O. Box 70
524 East Highway St.
Dodge Center, MN 55927



November 22, 2024

To: McNeilus Refuse Product Owner
Re: VSR-TSB-046 – Incorrectly Located License Plate Light/FMVSS 108
NHTSA Recall #24V-766

Dear McNeilus Refuse Product Owner,

An issue with the license plate lamp (light) location has prompted McNeilus to file a FMVSS noncompliance recall. Customer notifications are being released within the next couple of days. Please read and follow this procedure as soon as possible due to the noncompliance of the license plate light location.

Affected Vehicles

On certain 2010-2024 rear loader trucks with the optional dual reverse lights or rear light bar option, if the license plate light is positioned to illuminate the license plate from the bottom, then the vehicle is not compliant and the light must be relocated to be in compliance.

Reason for this Noncompliance Recall

To be in compliance, the license plate light must illuminate the license plate from the top (FMVSS 108). This recall provides the instructions to relocate the light using a new bracket to mount the light above the license plate.

Required Action

Review and verify your ownership of all affected serial numbers of McNeilus vehicles. If McNeilus records indicate that you are the owner of one or more affected units, a Serial Number List is enclosed. **Please be reminded that it is a violation of Federal law for you to sell or lease the vehicles covered by this notification until this recall has been performed on these vehicles. Substantial civil penalties apply to violations of this law.**

Time Completion

Upon receipt of the parts, complete the enclosed procedure for each affected unit. The time of accomplishment may vary due to a number of factors; however, the estimated time for completion of the procedure is one (1.0) hour under normal circumstances.



Reimbursement

In order to receive credit if you qualify, claims must be submitted through the normal McNeilus Warranty claim system. Claims must be received within 30 days of the repair. Claims must include the McNeilus serial number of the truck, the customer asset number, and the number of this bulletin.

NOTE: One claim per truck.

- Labor - One (1.0) work hour to reposition the license plate light and components

NOTE: The labor reimbursement of one work hour is for the active repair time (“hands-on” time) to reposition the license plate light and components. No additional time will be reimbursed for inspecting to determine if the license plate light is out of compliance. Nor will additional reimbursement time be given for down time while waiting for parts or repair.

- Cost of replacement part. Parts and ground shipping will be reimbursed to the customer. Parts necessary for this repair must be ordered from McNeilus Parts at 888-686-7278.

Perform the procedure to and make a warranty claim against only the vehicles either on the provided VIN list if available or as described in this bulletin by model, model year, and units affected.

The list of units affected by this campaign is included. Please review all aspects of this communication carefully. If you have any questions or concerns about these product update actions, contact the McNeilus service network support at 1-888-686-7278.

SAFETY NOTICE

Perform your company’s Lockout/Tagout procedure. If your company does not have a Lockout/Tagout procedure, follow OSHA 1910.147 and 1910.146 Confined Space as appropriate.

SAFETY NOTICE

Use appropriate Personal Protective Equipment (PPE) as required by your company.

Continuous Improvement:

The change included in this document is part of the McNeilus Continuous Improvement Process.

McNeilus’s quality policy is providing customer satisfaction through innovative products, dedicated service, and a constant focus on continuous improvement.



(888) 686-7278
www.streetsmartparts.com



Tools and Equipment Required

Technician to supply

- Wrenches, standard socket set, torque wrench

Parts Required

Purchase from McNeilus

Item	PN	Description	Qty.
1	1690166	LICENSE PLATE MOUNTING BRACKET	1
2	1243632	LOOM CLAMP .62X.25	1
3	1243909	NUT, LOCK FLANGE .25-20	1
4	1134366	BOLT, CAP HEX .25-20X.75	1

Inspection of suspect vehicle

- If the license plate light is located on the bottom of the mount (Figure 1), it is noncompliant. Follow the instructions in this safety recall to relocate the light to the correct position.
- If the license plate light is located above the plate (Figure 2), it is in compliance.

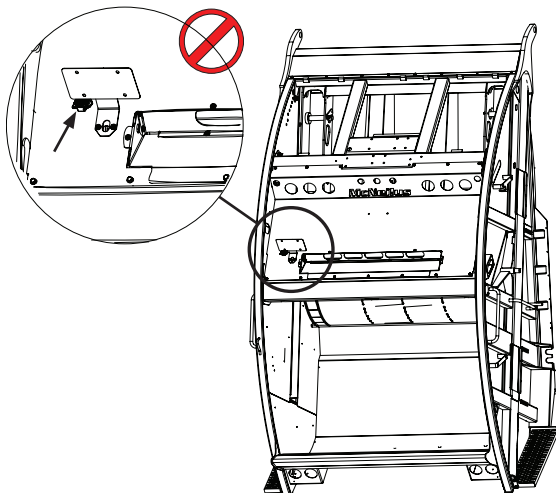

Figure 1
Incorrect location

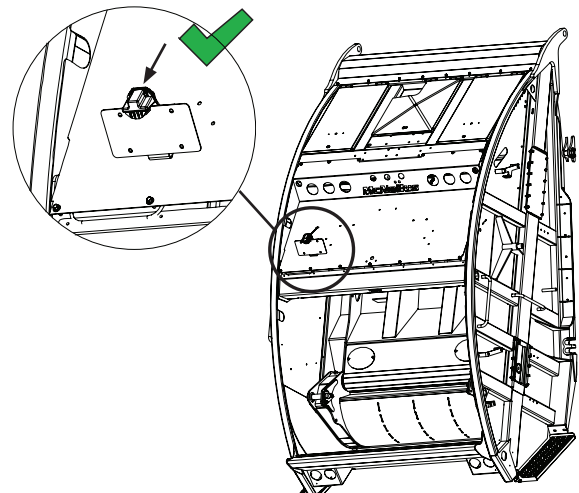

Figure 2
Correct location

Installation of new bracket

1. Perform your company’s Lockout/Tagout procedure. If your company does not have a Lockout/Tagout procedure, follow OSHA 1910.147 and 1910.146 Confined Space as appropriate.
2. Install the new bracket (Figure 3, Item 1) on the tailgate at the same holes as the old bracket.
3. Use the existing hardware from the old bracket (see note in Figure 3) and tighten.
4. Install the new loom clamp (PN 1243632) and route the harness through it. Secure using bolt (PN 1134366 HEX .25-20X.75) and nut (PN 1243909 lock nut .25-20). See Figure 3, Items 2, 3, and 4.
5. Install the existing gaskets on the new bracket (see note in Figure 3).
6. Route the existing harness through the hole and gaskets (back to front) of the new bracket.
7. Connect the existing harness connector to the existing light component (pin connector).



NOTE: Use existing light component, gasket components, and hardware to install new bracket and to install the light component to the new bracket and existing harness.

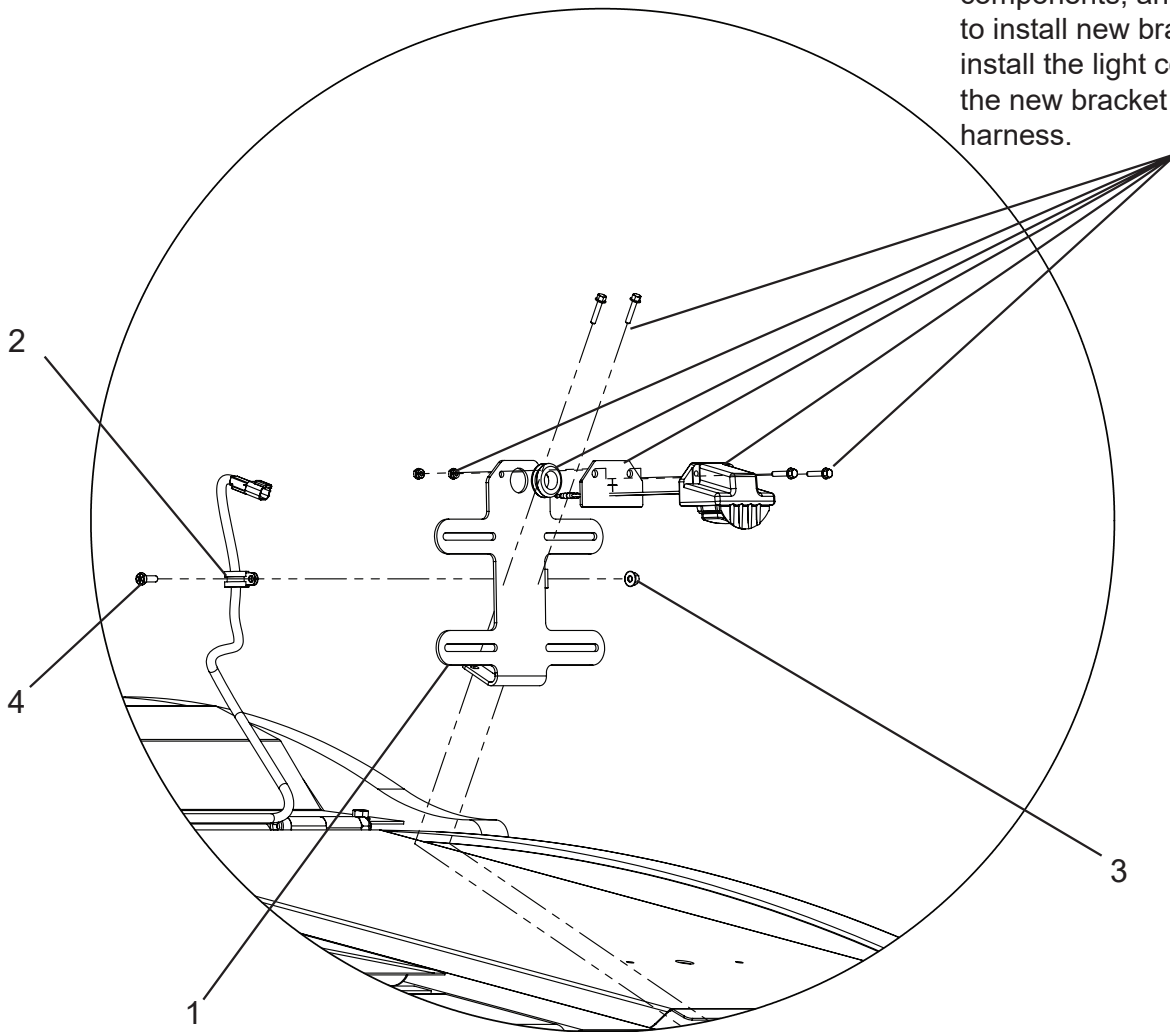

Figure 3

8. Reinstall the license plate with its hardware (Figure 4).
9. Remove your company's Lockout/Tagout procedure. If your company does not have a Lockout/Tagout procedure, follow OSHA 1910.147 and 1910.146 Confined Space as appropriate.
10. Turn the vehicle on and check the functioning of the license plate light (Figure 4).
 - If there are issues with the installation, call McNeilus service network support at 1-888-686-7278 to speak to your dealer service technicians.
11. Once the light is confirmed to be working, the procedure is complete and the vehicle can be returned to service. File your warranty claim within 30 days of completion.

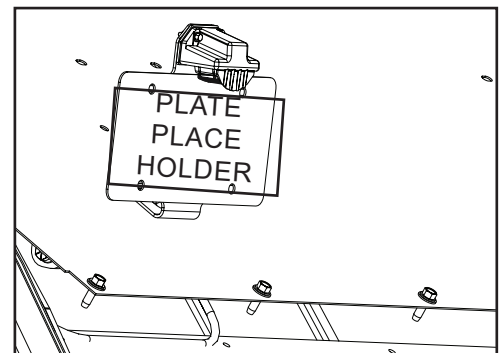

Figure 4