

Titre/Title : ITI-053_REVA Addition of rivets on top frame of HPO	
Équipement requis/Required equipment: Center punch, Drill with 1/8" (3.175mm) bit, Paper template, Rivet QS04242	
No kit: QS04242, no kit	Date: 2024-02-05
Video:	REV: C
Auteur/Author: Nancy Gravel	Client: Transtech

		<p>If you have an electronic version of this instruction, set the printer parameters to real size or actual size.</p> <p>Print the guide sheet on the second page of this instruction on a 8 1/2" x 11" sheet or a stiffer paper.</p> <p>Cut out image and fold it on the dotted line.</p>
--	--	--

		<p>Align the dotted line with the corner of the vertical side extrusion of the inner frame, just under the hinge, circles towards the exterior of the frame.</p> <p>Center punch the <b>upper mark only</b> of each paper guide.</p> <p>Remove the paper guide.</p>
--	--	---

		<p>Repeat the operation on the other side.</p>
--	--	--

		<p>With a 3mm (or 1/8") bit, relying on the punch marks, drill through 2 aluminum walls (max.12 mm).</p>
--	--	--

		<p>Install a QS04242 rivet in each hole.</p>
--	--	--

		<p>Fix the rivets.</p> <p>Final result.</p>
--	--	---

Ø 3.18mm

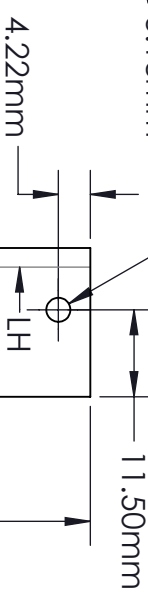

48mm

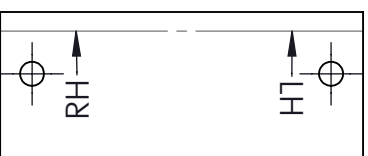
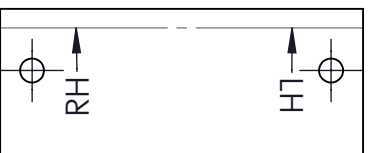
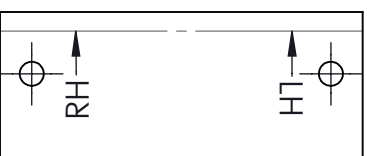
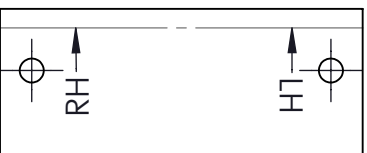
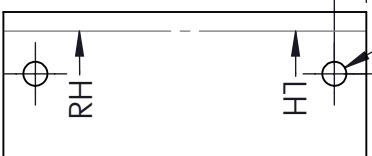
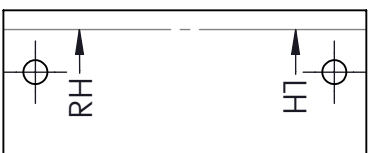

### Historique de révision / Revision History

Rev.	Description	Date	Par/By
R00	Relache Initiale/Initial Release DCDT 2023-070	2024/01/25	JS B
R01			
R02			
R03			

### Notes:

1) Paramètre d'impression: imprimer taille actuelle sur papier 8.5 x 11po. / Print setting, print to actual size on 8.5 x 11 in paper.

2) Valider mesures. / Validate dimension.

3) Couper sur la ligne pleine. / Cut out on solid line.

4) Plier sur ligne pointillée. / Fold on dotted line.

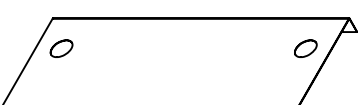

Symboles / Symbols

←LH : Gauche / Left Hand

RH → : Droit / Right Hand



GRUPEL C I CANADA INC.  
LCI CANADA GROUP INC.  
850 Meiller, Granby (Q.), Canada, J2L 1K7 | 450-978-6722 | www.LCIpartComponents.com

Composante soudée/Root component

IT1053\_Guide

Numéro de référence / Reference number

N/A

Description:

Guide rivets pour haut de cadre de POH/

Guide for adding rivets on top frame of HPO

Nom de page / Sheet name:

Matériel / Material:



Page:

1 de 1