

REFERENCE:	Nova Bus Manuals
SECTION:	14: Auxiliary Heater
RS N°:	MQR 7621-2454
EFFECTIVE IN PROD.:	N/A
TC RECALL N°:	2024-506
NHTSA RECALL N°:	24V657

APPLICATION DEADLINES: N/A CLAIM REFERENCE NUMBER: SR5637

SUBJECT:	Auxiliary Heater Air Intake
JUSTIFICATION:	Affected vehicles may have been manufactured with an auxiliary heater module that could stop working due to contaminants entering the unit through the air intake and settling on the electronic controller. The presence of contaminants on the electronic controller may create an electrical short which could increase the risk of a thermal event or fire. The electrical short may also cause the auxiliary heater to stop functioning. A non-functional auxiliary heater may reduce the performance of the windshield defroster system which could impair the driver's visibility, increasing the risk of a crash.

LEVEL	DESCRIPTION	DIRECT CHARGES		TIME
		LABOUR	MATERIAL	
1	Remove the original auxiliary heater air intake cover and install a snorkel hose type on the auxiliary heater air intake.	Nova Bus	Nova Bus	40 min
2	–	–	–	–

DISPOSAL OF PARTS

REMOVED PARTS ARE:	DISCARDED *	RETAINED	* Dispose of the unused parts and the defective parts in accordance with local environmental standards in effect.
	Yes	–	

REVISION HISTORY

REV.	DATE	CHANGE DESCRIPTION	WRITTEN BY
NR	2025JA27	Initial release	Luc Carignan

APPROVED BY:

Danna Dupuis Digitally signed by Danna Dupuis
Date: 2025.01.27 16:28:24 -05'00'

MATERIAL REQUIRED PER VEHICLE

QTY	PART N°	REV.	DESCRIPTION
LEVEL 1			
1	N111828-03	-	Hose 2.25 I.D. X 72 LG
4	N44884-01	D	Screw M6 X 20
1	N107530	-	90 Deg Hose Adaptor
4	N44890	-	M6 Nylon locknut
4	N56339	-	Tefzel cable ties
2	N56836	-	Spacer dual swivel saddle (Prévost 504751)
1	N22781-05	-	Breeze clamp 1 3/4 to 2 5/8 (Prévost 504754)
1	N92620	-	Air hose intake bracket
2	N84090-16	-	P-clamp ID 2.625
LEVEL 2			
-	-	-	-

Materials will be available within 107 days once your order has been placed.

To order, please contact novabus.parts@volvo.com

Or by phone for CANADA 1-800-771-6682, for USA 1-877-999-8808

Specify document number, quantity of parts required and shipping address.

CLIENT	ORDER	ROAD NUMBER		VIN (2NVY/4RKY...)		QTY
		FROM	TO	FROM	TO	
Academy Busline - New Jersey	LC95	—	—			2
Academy Busline - New Jersey	LE57	2201	2225			25
Ann Arbor Area Transportation Authority Michigan - AAATA	LD05	2000	2000			1
Ann Arbor Area Transportation Authority Michigan - AAATA	LD09	2001	2007			7
Ann Arbor Area Transportation Authority Michigan - AAATA	LE73	2200	2207			8
Barrie - Ontario - Metrolinx	LC63	2001	2002			2
Barrie - Ontario - Metrolinx	LD55	2101	2103			3
Barrie - Ontario - Metrolinx	LE18	2201	2203			3
Barrie - Ontario - Metrolinx	LE46	2204	2206			3
Belleville Transit - Ontario - Metrolinx	LD69	—	—			4
Belleville Transit - Ontario - Metrolinx	LE07	—	—			1
Brantford - Ontario - Metrolinx	LE09	102105	102109			5
Brantford - Ontario - Metrolinx	LE59	102201	102205			5
Burlington - Ontario - Metrolinx	LC18	1901	1907			7
Burlington - Ontario - Metrolinx	LD86	2101	2108			8
Burlington - Ontario - Metrolinx	LE48	72201	72207			7
Burlington - Ontario - Metrolinx	LF81	7-2104	7-2407			7
Capital Area Transportation Authority Michigan - CATA	LC07	6012	6015			4
Capital Area Transportation Authority Michigan - CATA	LC08	700	718			19
Capital Area Transportation Authority Michigan - CATA	LD34	719	730			12
Capital Area Transportation Authority Michigan - CATA	LD35	6016	6018			3
Capital Area Transportation Authority Michigan - CATA	LE04	731	737			7
Capital Area Transportation Authority Michigan - CATA	LE05	6020	6019			2
Capital Area Transportation Authority Michigan - CATA	LF62	738	745			8
Capital Area Transportation Authority Michigan - CATA	LF63	6021	6021			1
CHARM City Baltimore - Maryland	LC73	1910218	1910223			6
CHARM City Baltimore - Maryland	LD37	1910234	1910239			6
Cornwall - Ontario - Metrolinx	LD68	—	—			6
Demo - Altoona electric Bus - LFS-e+ (P9750)	LE01	—	—			1
Durham Region Transit - Ontario - Metrolinx	LC36	6113	6116			4
Durham Region Transit - Ontario - Metrolinx	LC62	9100	9105			6
Durham Region Transit - Ontario - Metrolinx	LD57	6117	6119			3
Durham Region Transit - Ontario - Metrolinx	LD91	7104	7117			14
Durham Region Transit - Ontario - Metrolinx	LD94	9106	9107			2
Durham Region Transit - Ontario - Metrolinx	LE20	7118	7122			5
Durham Region Transit - Ontario - Metrolinx	LF75	6136	6150			14

CLIENT	ORDER	ROAD NUMBER		VIN (2NVY/4RKY...)		QTY
		FROM	TO	FROM	TO	
Fredericton - New Brunswick	LE49	8221	8221			1
Fredericton - New Brunswick	LE79	8222	8223			2
Halifax - Nova Scotia	LC11	1300	1334			35
Halifax - Nova Scotia	LD77	1335	1369			35
Halifax - Nova Scotia	LE08	1370	1406			37
Halifax - Nova Scotia	LE78	1407	1413			7
Kingston - Ontario - Metrolinx	LB68	1901	1901			1
Kingston - Ontario - Metrolinx	LB69	1920	1951			5
Kingston - Ontario - Metrolinx	LD65	2101	2105			5
Kingston - Ontario - Metrolinx	LD74	2106	2106			1
Moncton (Codiac) - New Brunswick	LD73	—	—			4
Moncton (Codiac) - New Brunswick	LF47	—	—			1
Moncton (Codiac) - New Brunswick	LF67	—	—			4
Montgomery County - Maryland	LC33	1946000D	1946000D			1
Montgomery County - Maryland	LC34	1946001D	1946015D			15
Moose Jaw - Saskatchewan	LF44	18	18			1
Moose Jaw - Saskatchewan	LF68	20	24			2
NFTA - Buffalo, New York	LE03	2261	2270			10
NFTA - Buffalo, New York	LF43	2315	2324			10
NFTA - Buffalo, New York	LF93	202414	202418			3
Niagara Transit Commission - Metrolinx	LB98	1935	1936			2
Niagara Transit Commission - Metrolinx	LC19	—	—			2
Niagara Transit Commission - Metrolinx	LC37	—	—			2
Niagara Transit Commission - Metrolinx	LC61	1937	1938			2
Niagara Transit Commission - Metrolinx	LC84	2040	2043			4
Niagara Transit Commission - Metrolinx	LC85	—	—			1
Niagara Transit Commission - Metrolinx	LC89	1930	1934			5
Niagara Transit Commission - Metrolinx	LD53	2116	2119			4
Niagara Transit Commission - Metrolinx	LD54	2140	2140			1
Niagara Transit Commission - Metrolinx	LD63	2112	2115			4
Niagara Transit Commission - Metrolinx	LD67	2101	2112			12
Niagara Transit Commission - Metrolinx	LE22	—	—			2
Niagara Transit Commission - Metrolinx	LE24	2201	2209			9
Niagara Transit Commission - Metrolinx	LE34	2339	2340			2
Niagara Transit Commission - Metrolinx	LE38	—	—			1
North Bay - Ontario - Metrolinx	LC38	792	793			2
North Bay - Ontario - Metrolinx	LD52	794	794			1
North Bay - Ontario - Metrolinx	LE98	795	795			1
Oakville - Ontario	LC57	—	—			6
Oakville - Ontario	LD58	—	—			7
Ottawa - OC Transpo - Metrolinx	LC67	4683	4736			54
Ottawa - OC Transpo - Metrolinx	LC68	4737	4775			39
Ottawa - OC Transpo - Metrolinx	LD21	4776	4830			55
Ottawa - OC Transpo - Metrolinx	LD51	4831	4849			19

CLIENT	ORDER	ROAD NUMBER		VIN (2NVY/4RKY...)		QTY
		FROM	TO	FROM	TO	
Peterborough - Ontario - Metrolinx	LD72	—	—			6
Regina - Saskatchewan	LE40	2201	2202			2
RMA World wide chauffeured Transportation	LC98	N/A	N/A			12
Rochester New York - RTS	LB77	1902	1910			9
Rochester New York - RTS	LE92	2221	2247			27
Rochester New York - RTS	LF26	2301	2309			9
Sarnia - Ontario - Metrolinx	LD56	201	202			2
Sarnia - Ontario - Metrolinx	LE23	211	212			2
Sault Ste. Marie - Ontario - Metrolinx	LE56	—	—			3
Stratford - Ontario - Metrolinx	LD66	—	—			4
Stratford - Ontario - Metrolinx	LE41	—	—			2
Sudbury - Ontario - Metrolinx	LD71	910	919			10
Sudbury - Ontario - Metrolinx	LE25	921	927			7
Sudbury - Ontario - Metrolinx	LF85	241	246			3
Thunder Bay - Ontario	LE47	239	240			2
University of Arkansas	LC75	—	—			1
Whitehorse - Yukon	LE43	—	—			2
Windsor - Ontario - Metrolinx	LC21	8027	8045			19
Windsor - Ontario - Metrolinx	LE44	8046	8069			24
Windsor - Ontario - Metrolinx	LE61	8070	8071			2
Woodstock - Ontario	LE60	2201	2202			2
York Regional Transit - Ontario	LC24	1971	1980			10

**WARNING**

FOLLOW YOUR INTERNAL SAFETY PROCEDURES.

PROCEDURE

- 1.1. Park the vehicle on an even surface with the transmission on neutral.
- 1.2. Apply the parking brake and set the master control switch to the **stop** position.
- 1.3. Set the battery disconnect switch in the battery compartment to the **off** position.
- 1.4. Remove the air intake panel. Reserve the panel and hardware. See Figure 1.

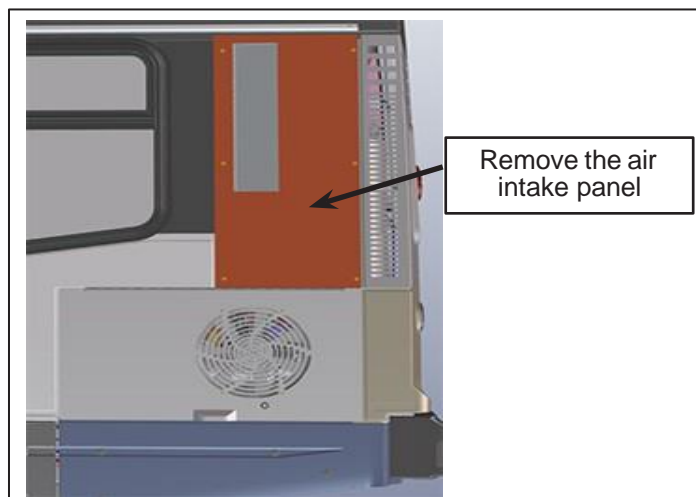

Figure 1 - Air Intake Panel

- 1.5. Using the air hose intake bracket N92620 as a template drill two 1/4 in. (6 mm) holes in the frame panel. See Figure 2 for hole location.

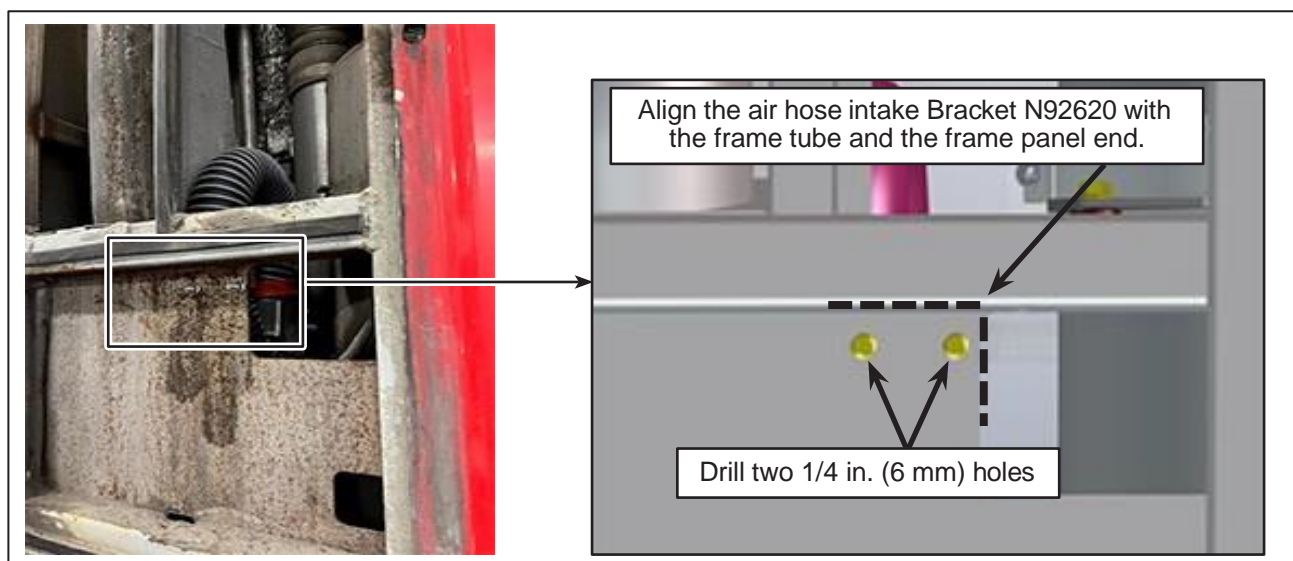

Figure 2 - Hole for Air Hose Intake Bracket

1.6. Prepare the sub-assembly of the air intake snorkel hose. See Figure 3 for the list of material.

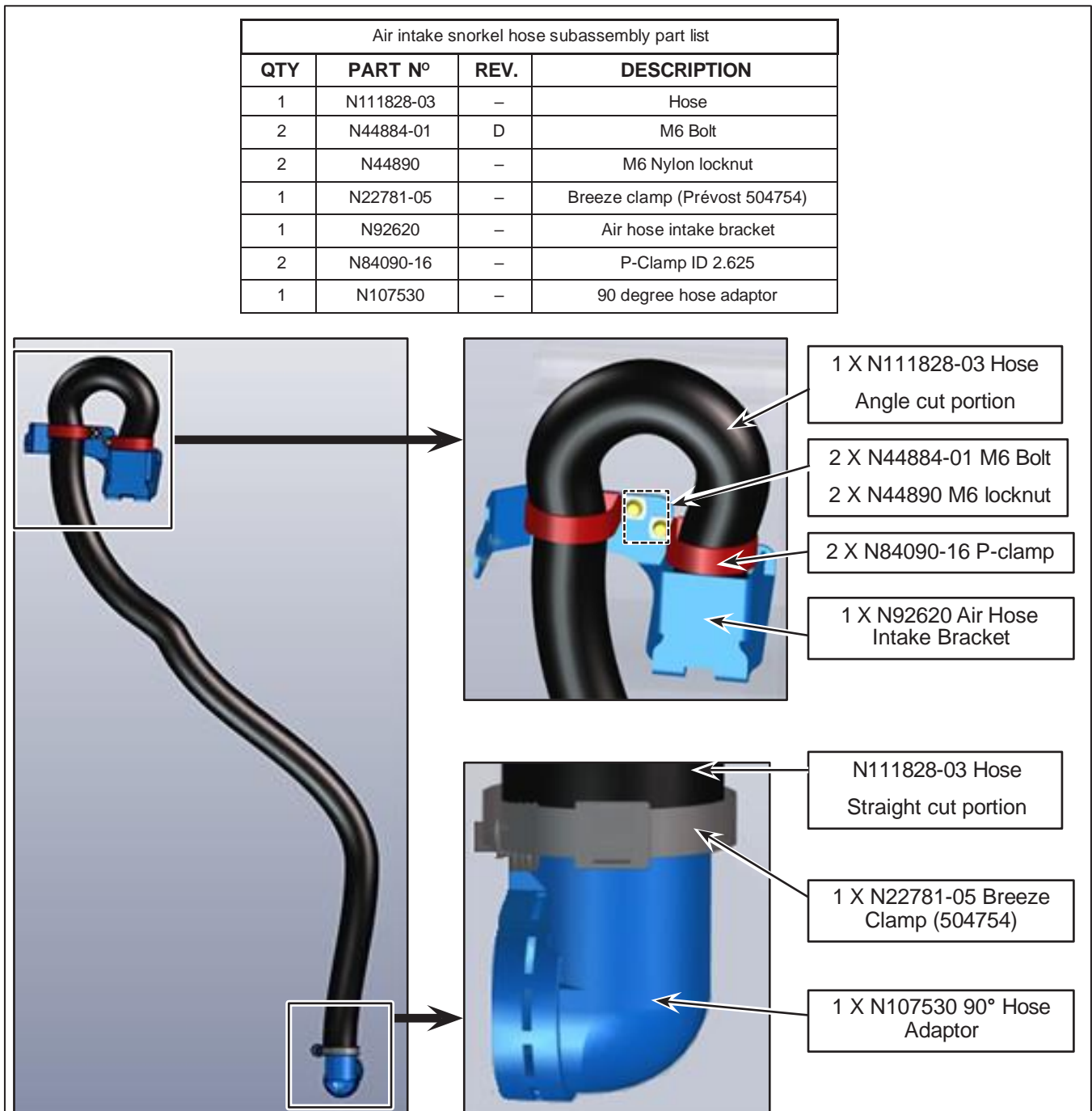

Figure 3 - Air Hose Snorkel Subassembly

- 1.7. Open the rear and street side engine access door.
- 1.8. Affix the air hose intake bracket N92620 to the frame using two N44884-01 M6 bolts and two N44890 M6 nylon locknut. See Figure 4.

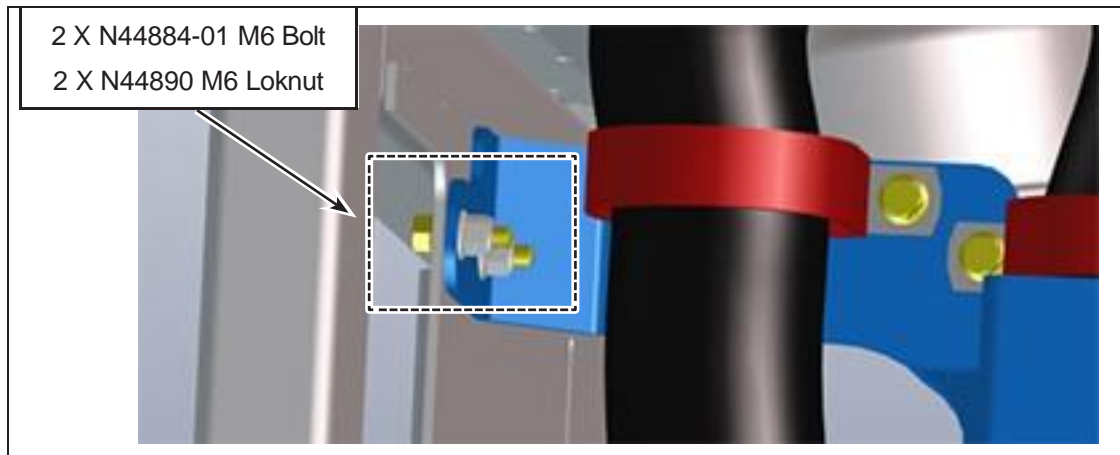

Figure 4 - Air Hose Intake Bracket Affix to the Frame

- 1.9. Lower down the rest of the hose in the engine compartment.
- 1.10. Raise the vehicle.



CAUTION

For information on hoisting and towing of the vehicle, see section 18: *hoisting and towing* in the Nova Bus maintenance manual. Use appropriate hoisting equipment for your protection and to prevent damage to the vehicle.

- 1.11. Remove and retain the dustpan locate under the auxiliary heater.

- 1.12. Remove the hardware fixing the auxiliary heater cradle to the frame and pivot the auxiliary heater cradle downward. Retain the hardware See Figure 5.

**CAUTION**

Before removing the nuts and bolts fixing the auxiliary heater to the frame, take the necessary precaution to prevent the support from swinging downward and freely.

- 1.13. Remove and discard the air intake cover from the auxiliary heater. See Figure 5.

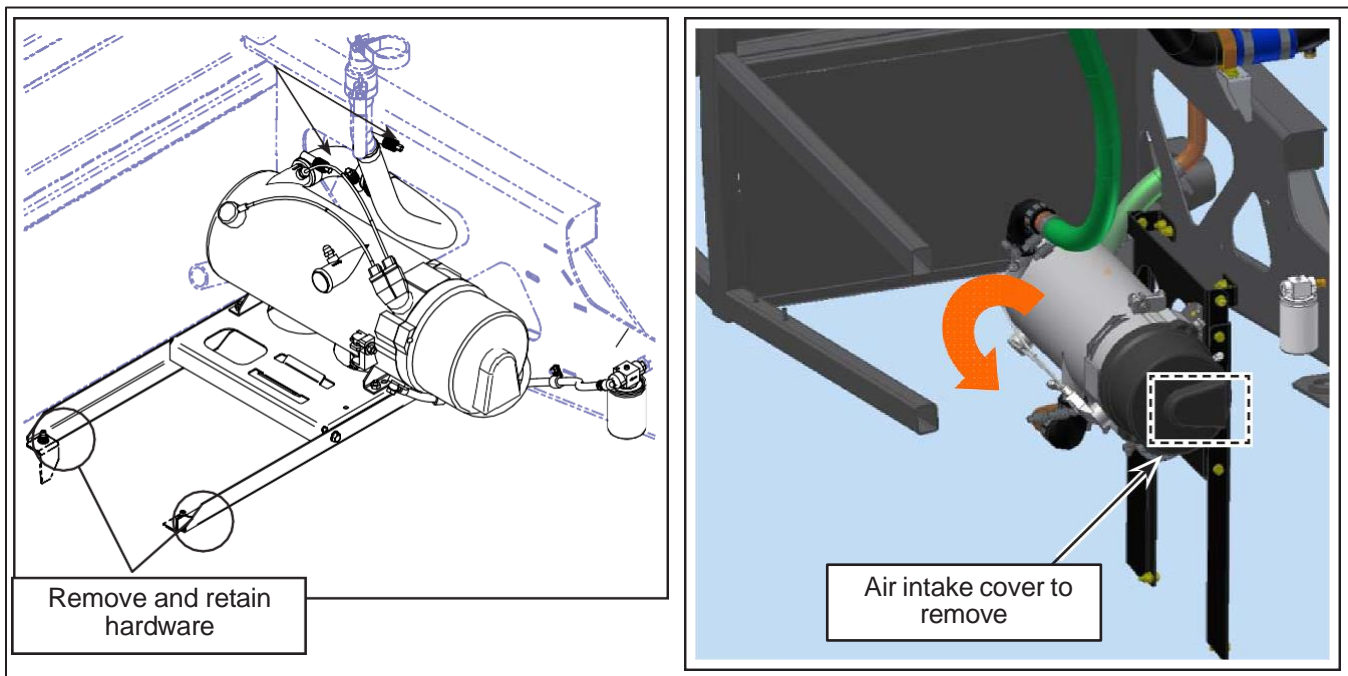

Figure 5 - Auxiliary Heater Pivot Down

- 1.14. Affix the N107530 90° hose adaptor to the auxiliary heater. See Figure 6.
- 1.15. Affix the N111828-03 hose to the coolant pipe using N56339 Tefzel cable ties and N56836 (504751) Spacer dual swivel saddle. See Figure 6.

**CAUTION**

The 90° adaptor N107530 and the hose N111828-03 must be free of contact or interference with other components in the engine compartment and positioned as shown in figure 6.

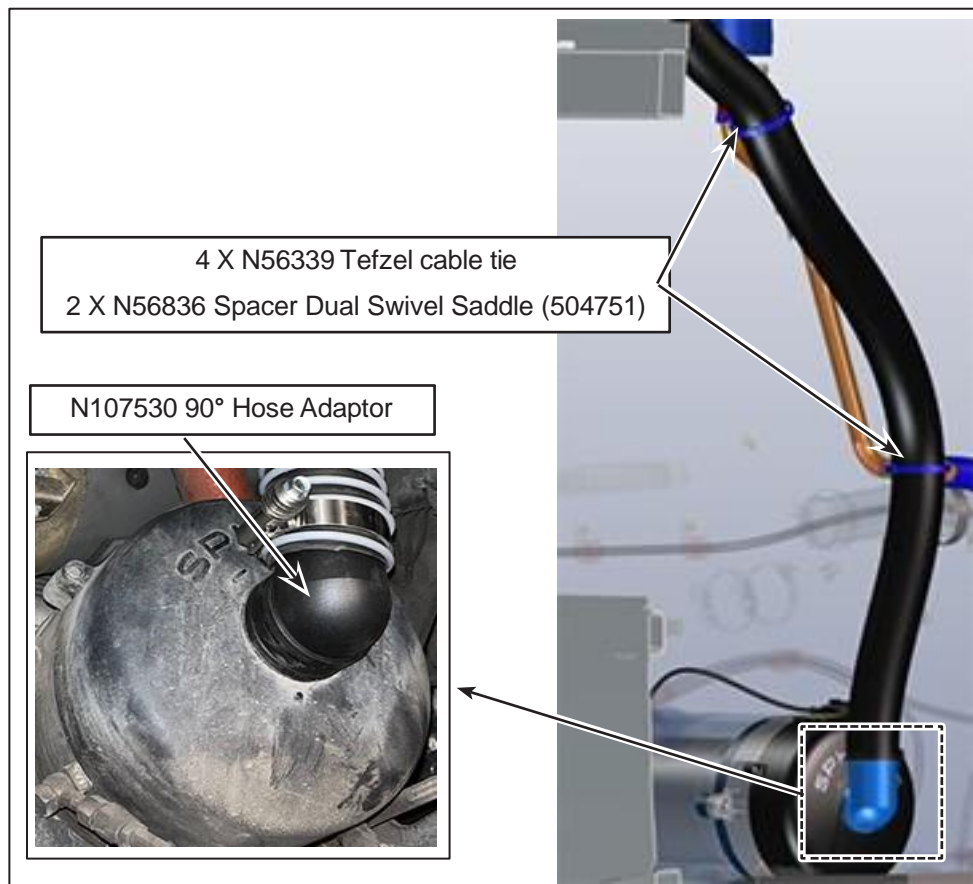

Figure 6 - Snorkel Hose Affix to the Auxiliary Heater and Coolant Pipe

- 1.16. Pivot upward the auxiliary heater cradle upward and affix the cradle to the frame with the retained hardware. For the torque value, see section **99: General Practice** of the Nova Bus maintenance manual.
- 1.17. Install the retained dustpan.
- 1.18. Lower the vehicle and close the open engine access door.
- 1.19. Install the retained air intake panel.
- 1.20. Return the vehicle in service.

