

NOTE: The information in Technical Service Bulletins are intended for use by trained, professional technicians with the knowledge, tools, and equipment to do the job properly and safely. It informs these technicians of conditions that may occur on some vehicles or provides information that could assist in proper vehicle service. These procedures should not be performed by "do-it-yourselfers". Do not assume that the condition described affects your bus. Contact Endera customer service to determine whether the Bulletin applies to your vehicle.



24-1007

09-03-2024

TECHNICAL SERVICE BULLETIN

Rear Emergency Exit Gas Strut – Replace with Positive Locking Door Prop

Model:

Endera:	Condition:	Mfg. Date:	Communication ID:
School Bus and MFSAB	Rear Emergency Exit Door does not meet NHTSA requirements	July 18, 2022 – December 11, 2023	24V630

Summary:

The Gas Shock currently installed on the rear exit door does not meet the NHTSA requirements as set forth in S5.4.2.1

Issue:

S5.4.2.1 (3(i)): Each emergency exit door of a school bus shall be equipped with a positive door opening device that, after the release mechanism has been operated, under the conditions of S6, before and after the window retention test required by S5.1.

S5.4.2.1 (3(A)): Bears the weight of the door

S5.4.2.1 (3(B)): Keeps the door from closing past the point at which the door is perpendicular to the side of the bus body, regardless of the body's orientation

S5.4.2.1 (3(C)): Provides a means for release or override

Action:

Replace the Gas Shock with Positive locking door prop. Follow the work instructions below.

Parts:

Service Part #	Qty.	Description	Notes:
500630	1	Positive Locking Door Prop	
1133078	8	1/4" x 0.625" OD Low Carbon Zinc Finish Steel SAE General Purpose Flat Washer	
0175543	2	1/4"-20 x 1/2" Square Drive Pan Head Grade 18-8 Stainless Steel Machine Screw	
0175544	2	1/4-20 x 3/4 Stainless steel square drive pan head bolt	
21161	2	1/4"-20 x 2" Zinc Finish ASTM A307 Grade A Round Head Carriage Bolt	
11550885	2	3/16" D .062-.437 Grip Range Steel/Steel Protruding Head Magna-Lok® Powerlock Rivet	
37708	4	1/4-20 Acorn Nut	

Tools:

Description
Drill
1/4" Drill Bit
3/16 Drill Bit
Center Punch
Hammer
7/16 Wrench
#2 Square Bit

Labor Times:

Description	Operation No.	Time
Remove and replace Gas Shock with Positive Locking Door Prop	1	0.7 Hrs.

Service Procedure:

Removal of Gas Shock

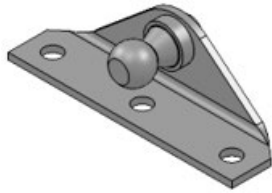

Strut Mount
#271779



Gas Strut
#310280

1. Fully open the Emergency Exit door to extend the gas strut.
2. Using a 3/16 drill bit, drill the head off of the rivets holding the threshold mount to the frame.



3. Drill out the rivets retaining the door mount to the door.



4. Discard the shock and bracket assembly.

Installation of Positive Locking Door Prop



Locking Door Prop
#500630

1. Cut out the templates provided along the dotted lines.

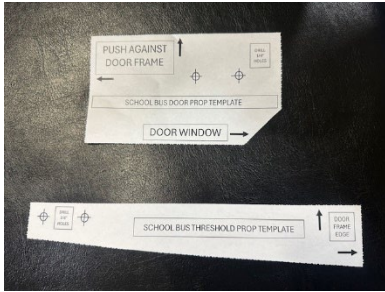

2. Place the door template into the upper left corner of the exit door as shown and tape into position.

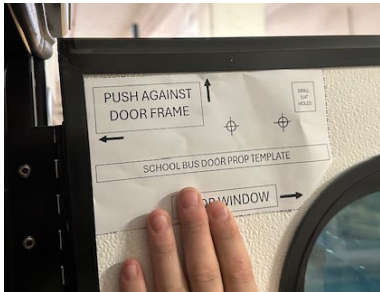

3. Using a center punch, mark the hole locations and remove the template.



4. Using a 1/4" drill bit, drill (2) holes through the door at the location marked. Holes should be parallel through the door.

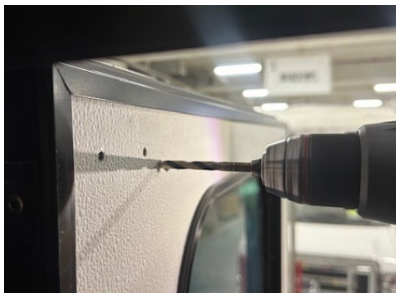

5. Next, tape the threshold template into position as shown.

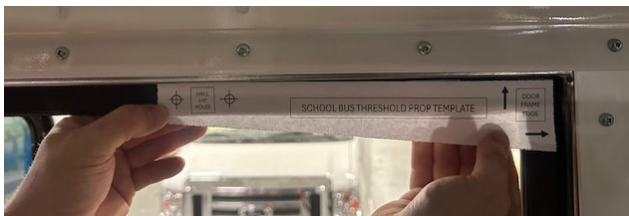

6. Using a center punch, mark the hole locations and remove the template.

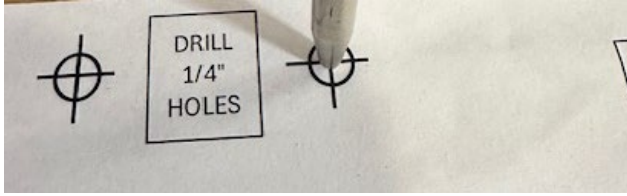

7. Carefully peel the rubber seal away from the frame behind the area marked to prevent damage while drilling. With the 1/4" drill bit, drill (2) holes at the marked locations in the upper threshold frame.



8. Install (2) Powerlock Rivets into the holes in the door that remain from the gas shock removal procedure.



9. From the exterior of the door, insert the (2) 1/4 -20 x 2 Carriage Bolts through the 1/4" holes. Use a hammer gently drive the bolt into the door to seat the bolt.



10. Install (2) washers on each bolt on the interior of the door.



11. Place the mounting flange of the Door Prop over the bolts and washers. Be sure to position the locking override slot toward the outside of the bus.



12. Place a washer over each bolt and fasten with (2) 1/4"-20 acorn nuts.



13. Insert (2) 1/4"-20 x 1/2" Square Drive Pan Head bolts into the holes drilled into the door threshold from the exterior inward.



14. Place the mounting flange over the bolts.



15. Install a washer and acorn nut on each bolt and tighten.



16. Place the rubber seal back into position and adhere it back to the frame.



17. Verify proper operation of the prop rod. When opened, the door will open and lock into position. To release, open door slightly further and close.



18. End of Process