



FIELD KIT

Vermeer Corporation

Environmental
Pella, Iowa 50219 USA

FIELD CAMPAIGN KIT #:	IK004576	DATE:	8 August 2024
For Dealer Reference: Service Bulletin #: SVC2024-080			

Brush Chipper Axle Mounting Hardware Replacement

CAMPAIGN TYPE:	Mandatory - Product Safety
CAMPAIGN CATEGORY:	Kit and Bulletin

MACHINE/ ATTACHMENT MODEL(S):	SERIAL NUMBERS:		
	Included	Excluded	Kit version
BC1200XL	51119 – 51203	51119, 51121, 51127 – 51129, 51185, 51189, 51193 - 51195, 51198 - 51203	IK01



Purpose: This kit includes parts and instructions to replace axle mounting hardware that may have been improperly torqued.

Special tools and conditions:

- None
- None

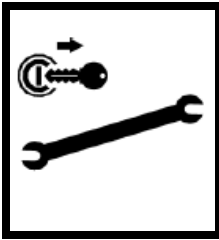

WARNING: Failure to use shutdown procedure can result in unexpected hazard(s). Death or serious injury could result due to entanglement, crushing, cutting, or other hazardous contact. Follow shutdown procedure after operating, before performing any service or maintenance, and before transporting.

Shutdown Procedure:

Stopping the Machine

NOTICE: For your safety and the safety of others, use shutdown procedure before working on the machine for any reason, including servicing, cleaning, unclogging, inspecting or transporting the chipper.

A variation of this procedure may be used if instructed within this manual, or if an emergency requires it.

1. Return *upper feed control bar* to STOP position.
2. Slow engine speed to LOW IDLE.

NOTICE: Whenever practical and consistent with good safety practice, run engine without load for a few minutes before shutting it off. This allows engine temperatures to decrease and equalize, which will increase engine life.

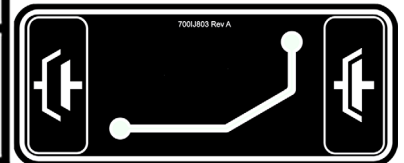
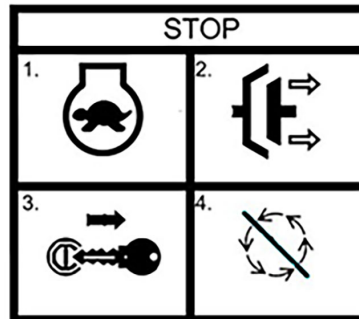

3. Wait for the cutter drum to slow.
4. Move *cutter engage lever* to disengaged position.
5. Turn ignition key to off position.
6. Wait for the cutter drum and belt to stop.

NOTICE: Cutter drum rotation can be checked by looking at the end of the shaft on the left side of the cutter wheel housing. The cutter drum will continue to turn for a short time after the engine has stopped.

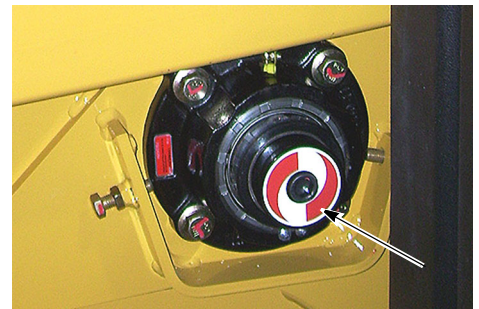

7. Remove ignition key.
8. Close and latch feed table or leave open if needed for removing plugs or for performing maintenance or service.



Unless indicated, new parts from kit have callouts with numbers. Callouts with letters indicate existing parts or general items.

Procedure IK01:

1. Follow Shutdown Procedure.



WARNING: Raised load can shift or fall. Death or serious injury could be possible if struck or crushed by falling load. Never allow anyone under a raised load unless load is securely supported to prevent it from shifting or falling.

2. Raise machine using a suitable lifting device.
3. Use appropriate device to support the machine on the frame.
4. Remove hardware (**A - G**) on right side of machine.

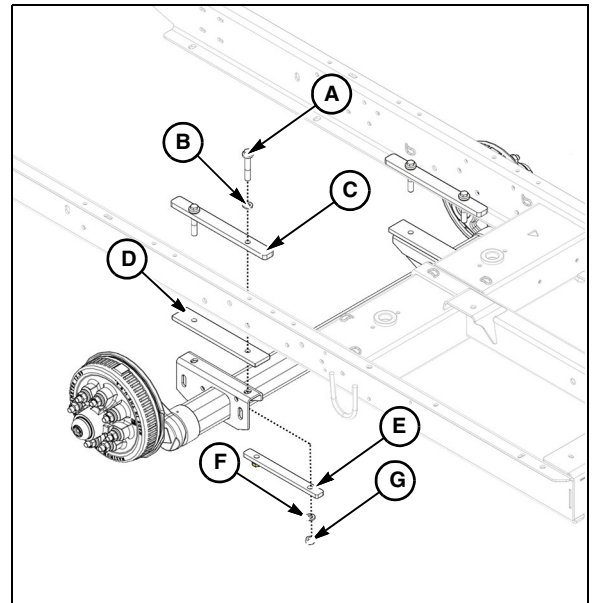

5. Install new parts (1 - 6) as shown.
6. Ensure frame mount bar (3) is installed correctly. The thickest side of the offset should be on the inside of the machine.
7. Torque mounting bolts (1) to 196 ft-lbs (266 Nm).

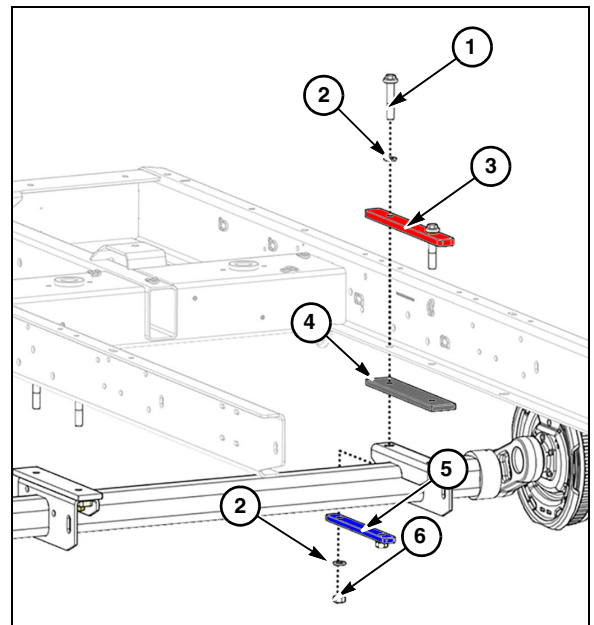

8. Repeat process on left side of machine.

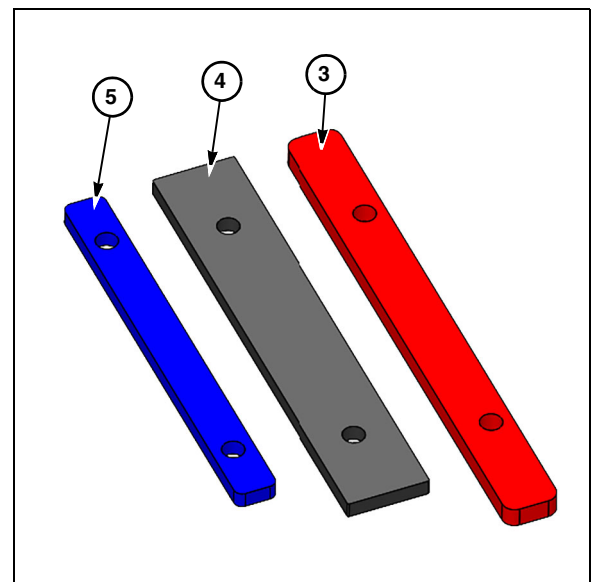

Remove Figure 1 and attach to the invoice or place in the manual storage box so unit owner can place with existing parts manual.

UNIT OWNER COPY
 Insert into parts manual
 for future reference.

Figure 1

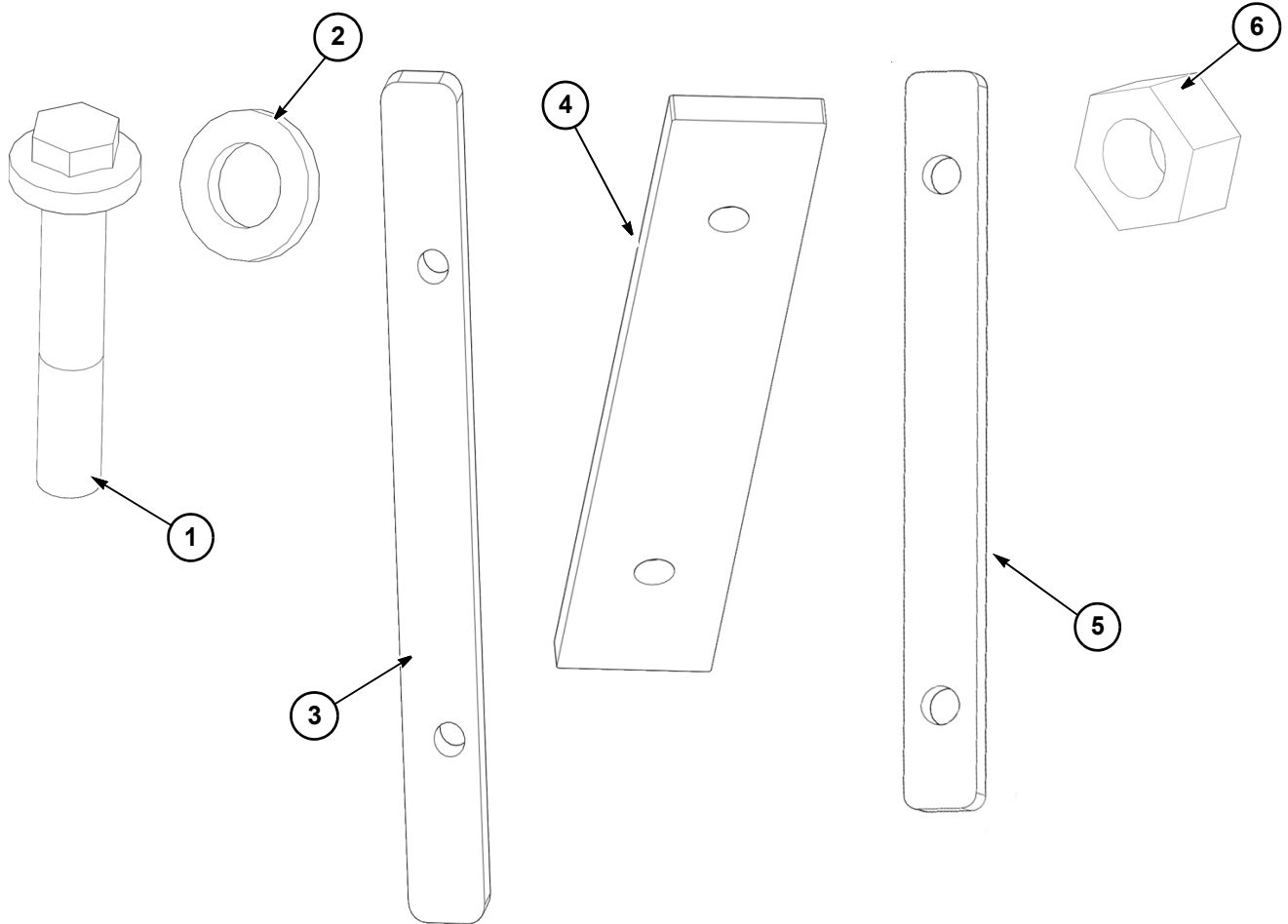

Figure 1 parts list

<u>REF. NO.</u>	<u>PART NO.</u>	<u>DESCRIPTION</u>	<u>IK01 QTY.</u>
1	507614090	SCREW-HFS-M16-2.00X90-10.9	4
2	508486016	WASHER-FLATHARD-M16-17.0X30.0-4.0-D6916	8
3	163709837	SUPPORT FRAME MOUNT	2
4	180010172	AXLE SPACER	2
5	163709835	SUPPORT AXLE MOUNT	2
6	507090016	NUT-HEX-M16-2.00-10	4
		Kit includes all items in Figure 1 parts list.	