

Recall Campaign Bulletin



Mercedes-Benz

Campaign No. 2024070005, July 2024

Revision A: 08/05/2024

TO: ALL MERCEDES-BENZ CENTERS

SUBJECT: **Model C-Class (206 platform)**
Model Year 2022 – 2023

Check Pre-Fuse Box Wiring

Mercedes-Benz AG, the manufacturer of Mercedes-Benz vehicles, has determined that on certain MY 2022-2023 C-Class (206 platform) vehicles, an electrical wire to the pre-fuse box in the passenger-side footwell might not be secured according to current production specifications. In this case, the electrical resistance of the connection might increase. Due to the high electrical currents potentially flowing through this connection, the temperature of the connection could increase. This might increase the risk of a fire. Additionally, a loss of propulsion without warning cannot be ruled out completely, potentially increasing the risk of a crash. An authorized Mercedes-Benz dealer will check the wiring of the pre-fuse box on the potentially affected vehicles and re-work it if necessary.

Prior to performing this Campaign:

- VMI must be checked before performing campaigns to verify that the campaign is required on a specific vehicle. Always check for any other open campaigns and perform accordingly.
- Please review the entire Campaign bulletin and follow the repair procedure exactly as described.

Approximately 1,058 vehicles are affected.

Order No. P-RC-2024070005

Recall Campaign Bulletin

Recall Campaign Bulletin

Recall Campaign Bulletin

Recall Campaign Bulletin

Recall Campaign Bulletin

Check Pre-Fuse Box Wiring

Revision notes:

- Work Procedure Step 1 updated, Figure 3 changed, Operation Item 12-2179 description updated.

Check/Test Procedure

1. Remove floor covering on front passenger side.
 ⓘ For basic information, see **AR68.80-P-0008WT**.
2. Disconnect ground line of 12 V on-board electrical system battery.
 ⓘ For basic information, see **AR54.10-P-0051WT**.
3. Remove passenger side footwell support (**Figure 1, 2**).
 ⓘ For this purpose, remove nuts (**Figure 1, 1**).
 ⓘ For basic information, see **AR54.15-P-1350WT**.
 ⓘ **Installation:** Tighten nuts (**Figure 1, 1**) with the specified tightening torque of **6 Nm**.

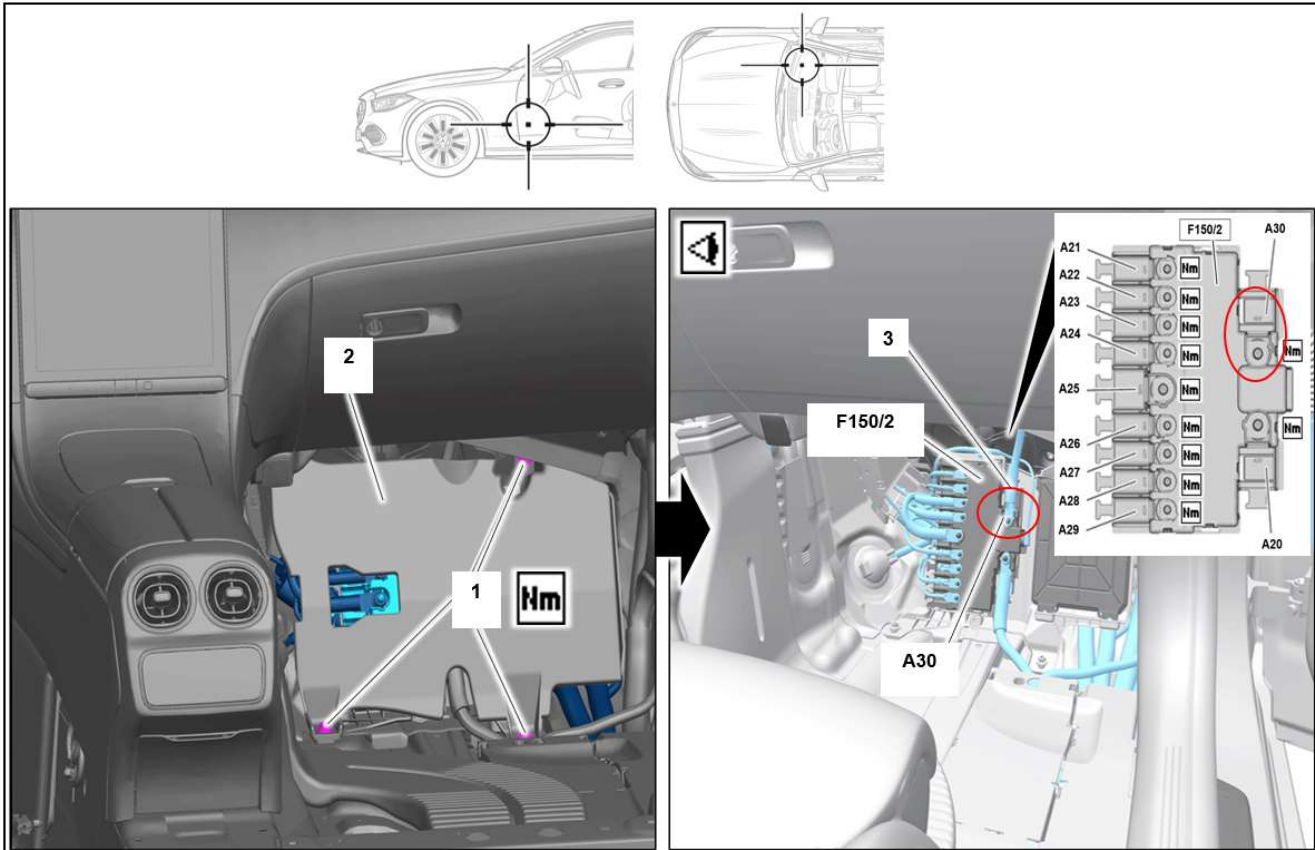

Figure 1

4. Inspect electrical connection (**Figure 2, A30**) of prefuse box **F150/2** visually for physical damage, such as arcing, scorch marks, melting and/or missing nut.
- If there is no damage to the electrical connection (**Figure 2, A30**), remove electric line (**Figure 2, 3**) at A30 connection and inspect the underside for damage. If there is no damage, re-install the electrical connection with nut (tightening torque of **16 Nm**) and **End Measure**.
 - If there is damage to the electrical connection (**Figure 2, A30**), carry out **Work Procedure**.
NOTE: Capture photos of damaged electrical connection to be included in Warranty claim

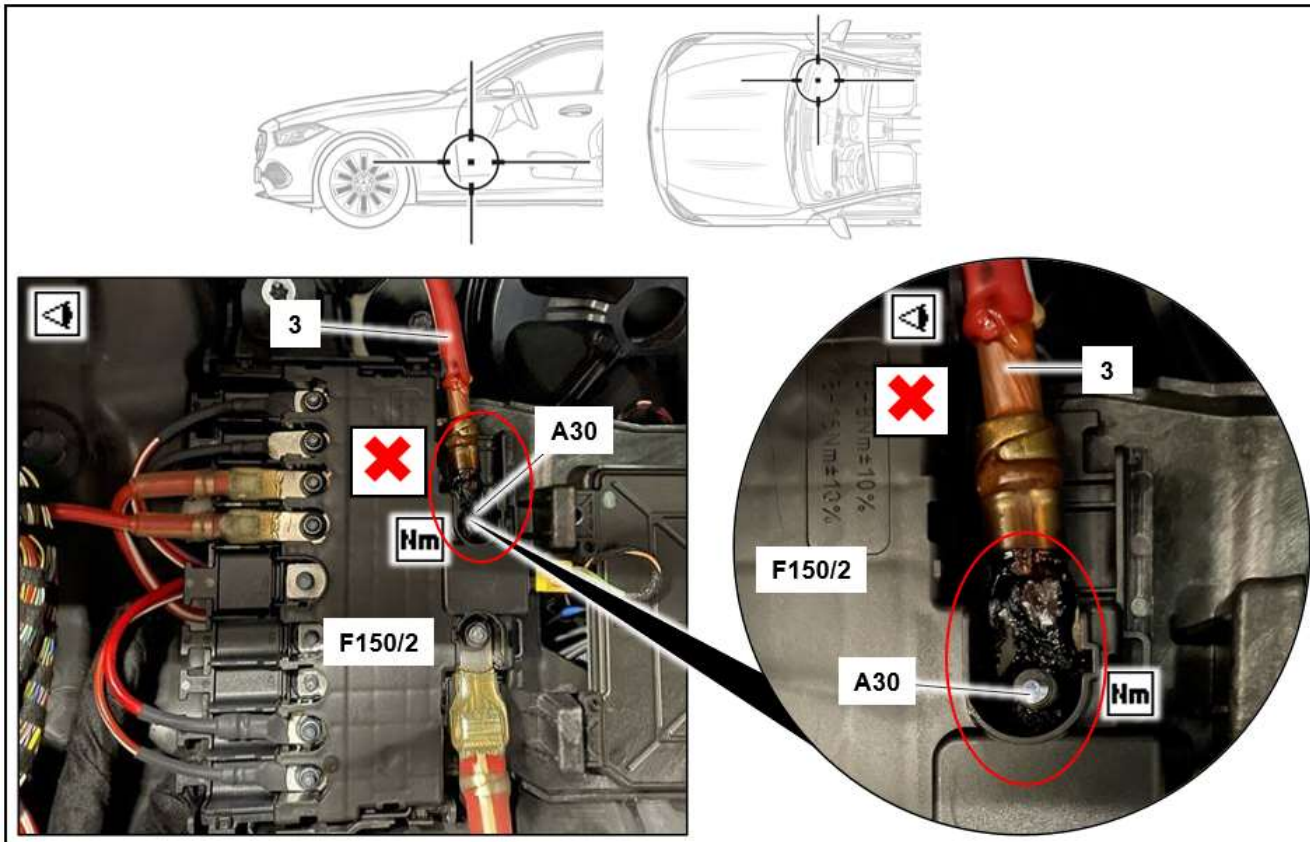

Figure 2 (prefuse box with thermal damage, NOK)

Work Procedure

1. Replace all damaged component parts:

NOTE: Capture photos of damaged component parts to be included in Warranty claim.

i Replace damaged prefuse box (Figure 2, F150/2) and/or install missing nut on electrical connection (Figure 2, A30). For basic information, see AR54.15-P-1350WT.

i Replace damaged electric line (Figure 3 and 4, 3):

To do this, completely remove the front prefuse box (Figure 3, F150/3) in the engine compartment (for basic information, see AR54.15-P-1330WT), and then push the 48 V battery (Figures 3 and 4, G1/3) to the side (Figure 4, direction of arrow) with only the coolant lines attached (for basic information, see AR54.10-P-0022WT).

i If replacing electric line (Figure 4, 3), it is not necessary to remove the coolant lines or drain the coolant for the 48 V battery G1/3.

i The necessary electric line (Figure 4, 3) is included in the electrical wiring harness parts package. Only the electric line (Figure 4, 3) is needed from this electrical wiring harness. The extra wiring harness in the parts package can be disposed of in accordance with applicable regulations.

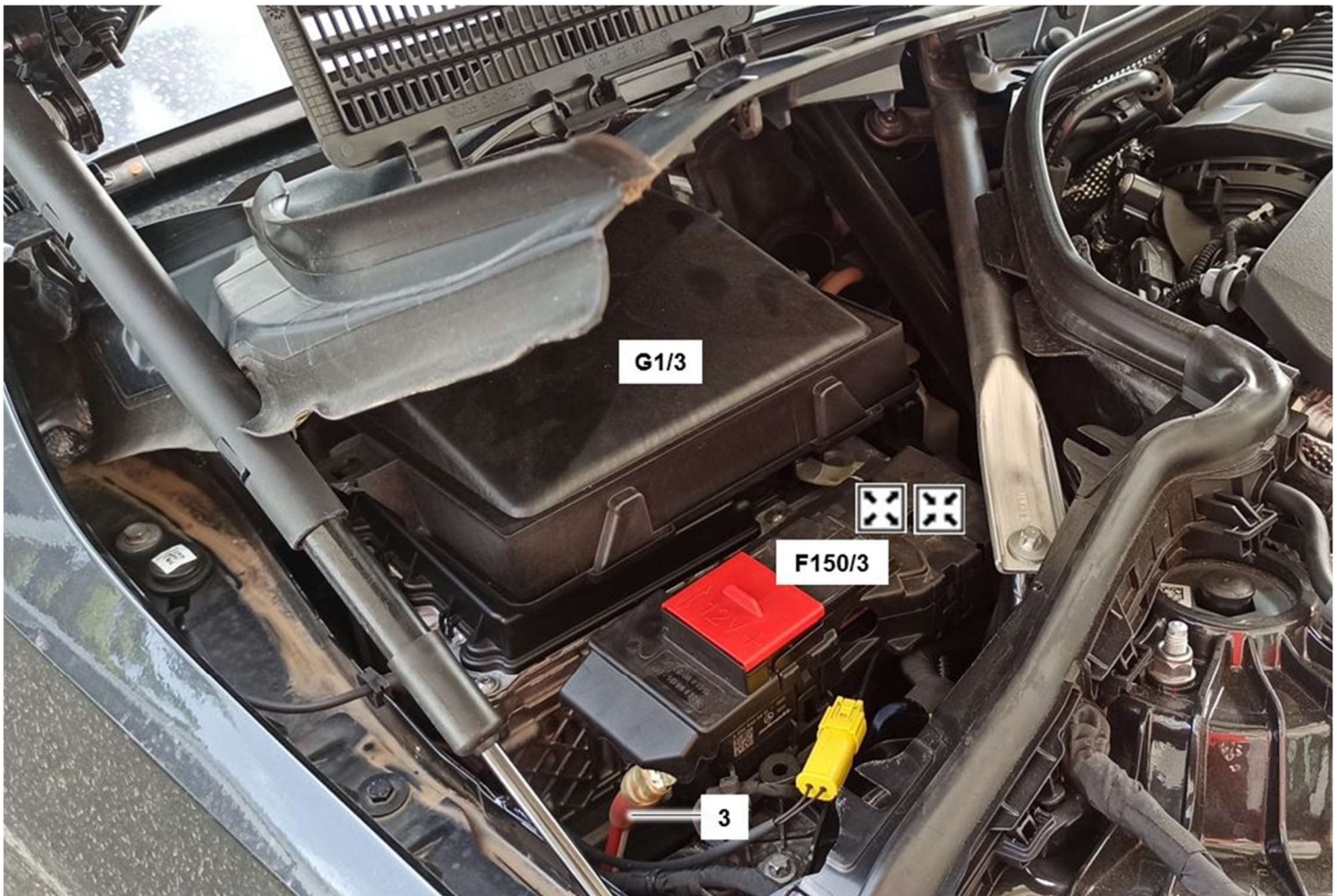

Figure 3 (passenger side of engine compartment)

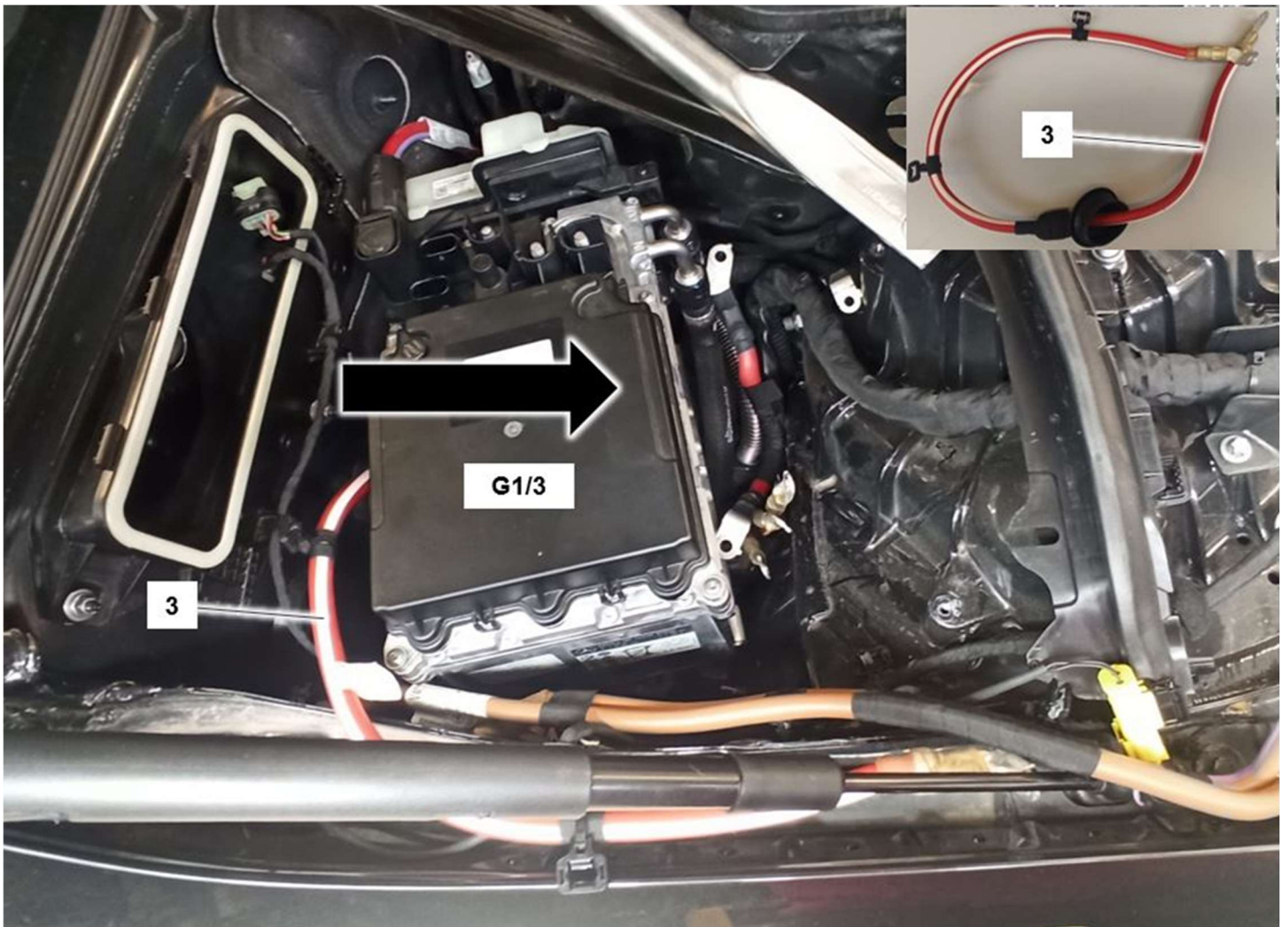

Figure 4 (passenger side of engine compartment)

2. Install in the reverse order.

Primary Parts Information

Qty.	Part Name	Part Number
As required (1)	Fuse box (F150/2) in passenger footwell	A 223 540 84 44
As required (1)	Electrical wiring harness**	*
As required (2)	Nut (M8)	N 000000 008271

* **The required replacement part for the equipment variant must be determined according to the vehicle identification number (VIN) via the XENTRY Parts Information system under the main group 54 Electrical equipment and instruments → 121 Body-side engine wiring harness → 150 Electrical Wiring harness.**

** **The necessary electric line is included in the electrical wiring harness parts package. Only the electric line (shown in Figure 4, 3) is needed from this electrical wiring harness. The extra wiring harness in the parts package can be disposed of in accordance with applicable regulations.**

i Small parts such as screws, lock nuts, sealing rings, cable ties, fluids, sealant, etc. are not listed in the parts list. The required small parts are taken into account in the budgeting.

i **Note:** The following allowable labor operation should be used when submitting a warranty claim for this repair:

Warranty Information

Damage Code	Operation Number	Description	Labor Time (hrs.)
54 976 03	12-2171	Operations: Check electrical connection at prefuse box in vehicle interior Includes: Disconnect/connect ground line of 12 V on-board electrical system battery, detach front passenger seat, remove/install front floor covering on front passenger side.	0.9
	12-2172*	Operations: Replace prefuse box in vehicle interior (after check).	0.5
	12-2179*	Operations: Replace electric line (after replacing prefuse box in vehicle interior) Includes: Remove/install complete front prefuse box (F150/3).	ZM

* Claims requiring pictures per respective OP-Code will be subject to denial

i **Note:** Always check Xentry Operation Time (XOT) for the current OP-Code times. Labor times are subject to change and updates may not be reflected in this document.