

4. Remove right foot support with rear master cylinder still installed.

Swingarm Dismount

1. Secure vehicle.
2. Jack rear wheel off the ground using a scissors jack under the flat surface at the bottom of the PEU.
3. Remove left foot support.
4. Remove belt guards.
5. Loosen rear axle.
6. Remove drive belt.
 - a. Loosen axle adjuster on each side equally.
 - b. Remove drive belt from motor sprocket.
7. Remove rear shock lower bolt and motor to rocker bolt.
8. Remove brake line P-clamp on motor.
9. Remove first brake line P-clamp on right side of swingarm.
10. Remove first two rear lighting Christmas tree fasteners on left side of swingarm.
11. See Figure 1. Remove both swingarm bearing caps (2).

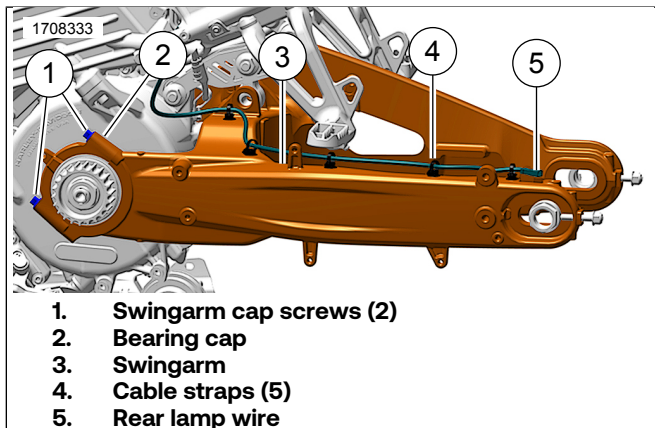

Figure 1. LH Swingarm

12. **NOTE**
Lower flat jack a few inches to reduce strain on brakes lines.

Carefully pull swingarm back and down to disengage from bearings, tip front of swingarm down and set it on to work surface.

Dismount Motor and Inspection

1. Remove High Voltage cover door on right side of vehicle.
 - a. Inspect cover seal and replace if any damage or deformities are noted.
2. Disconnect the two low voltage connectors.
3. Disconnect 3 phase high voltage fasteners from motor.
 - a. Remove screws from 3 phase lead caddy.
4. Place a second flat jack with blocks of wood to support motor.
 - a. Recommended: Protect painted parts around left side tail section seat support weldment.
 - b. Route a ratchet strap around the weldment then around the motor bearing.
 - c. Take slack out of strap. This will allow additional support of the motor.
5. Remove seven right side motor screws.
6. Remove two left side motor screws.
7. Carefully rotate motor several inches away from RESS assembly to provide tool access.
 - a. Inspect motor seal for any damage or if it has become unseated. Replace if necessary.
8. Torque stator retaining ring fastener. Tighten.
Torque: 2.6–3.2 N·m (23–28 in-lbs)

Install Motor

1. See Figure 2 and Figure 3. Ensure seal is properly seated in motor groove and align motor to RESS and start the seven fasteners on the right side of the vehicle.
 - a. Remove ratchet strap from motor.
 - b. Start two fasteners on left side of vehicle.

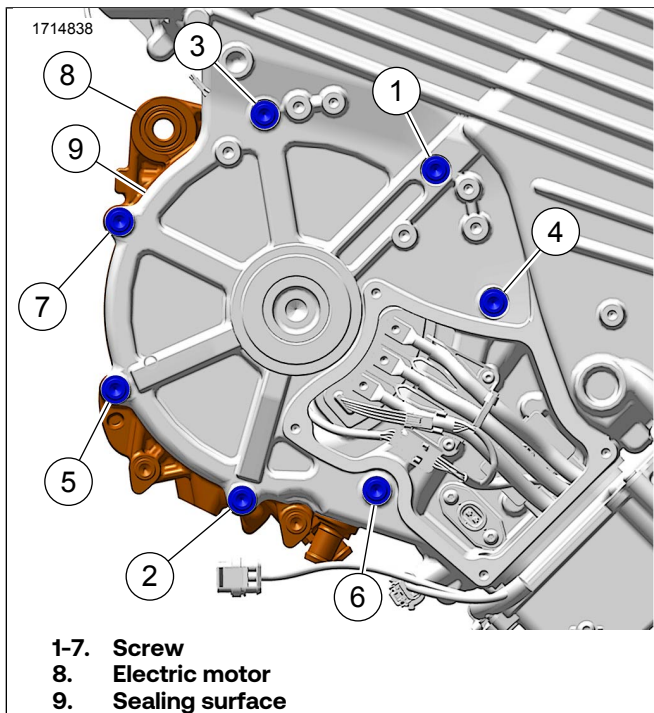

Figure 2. Right Motor Screws

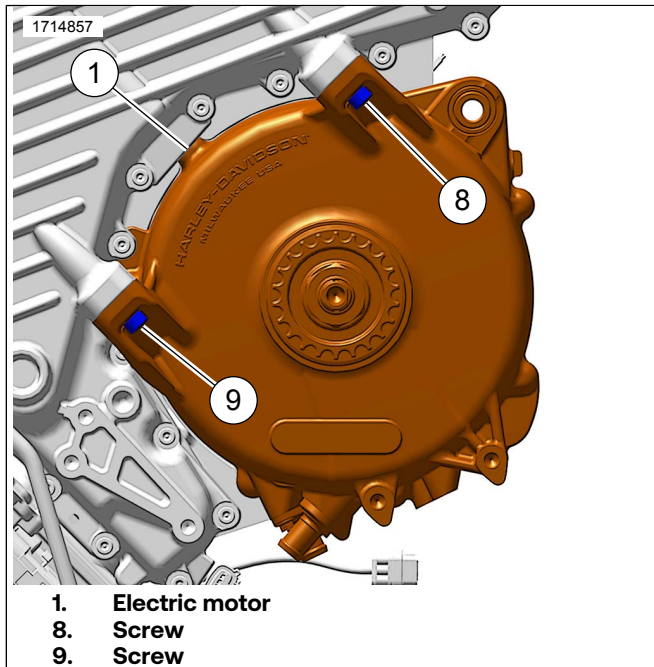

Figure 3. Left Motor Screws

2. Tighten screws (5) and (7).
Torque: 5–7 N·m (44–62 **in-lbs**)
3. Tighten left side screws (8) and (9).
Torque: 31.5–38.5 N·m (23–28 **ft-lbs**)
4. Tighten right side screws (1–7) in sequence.
Torque: 31.5–38.5 N·m (23–28 **ft-lbs**)
 - a. Remove flat jack and wood.

5. Install 3 phase caddy. Tighten screws.
Torque: 2.4–3 N·m (21–27 **in-lbs**)
6. Install 3 phase leads to motor. Tighten.
Torque: 5.3–6.5 N·m (47–58 **in-lbs**)

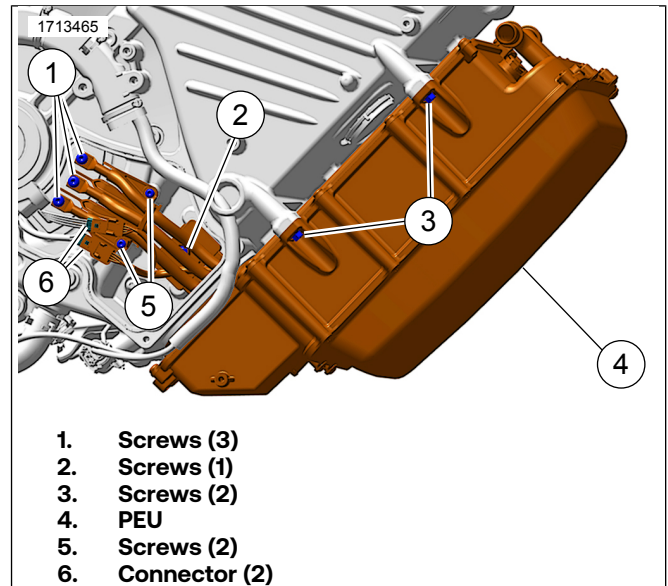

Figure 4. PEU Connections

7. Reconnect low voltage connectors and attach to caddy retainers.
8. Inspect HV cover seal and ensure it is properly seated.
 - a. Install High-Voltage cover. Tighten.
Torque: 5–6.1 N·m (44–54 **in-lbs**)

Install Swingarm

1. Lift swingarm and ensure brake lines route under the shock rocker.
2. Align and set swingarm against bearings securely.
3. Install bearing caps. Tighten beginning with left side.
Torque: 37.5–41.4 N·m (28–31 **ft-lbs**)
4. Install forward P-clamp on right side of swingarm. Tighten.
Torque: 8–10 N·m (71–89 **in-lbs**)
5. Install P-clamp on motor. Tighten.
Torque: 8–10 N·m (71–89 **in-lbs**)
6. Align rear shock rocker and install bolts.
 - a. Raising or lowering the vehicle on the jack can aid with alignment.
7. Tighten shock to rocker bolt.
Torque: 90–100 N·m (66–74 **ft-lbs**)
8. Tighten motor to rocker bolt.
Torque: 90–100 N·m (66–74 **ft-lbs**)

9. Connect rear lighting Christmas tree fasteners on left side of swingarm.

Tension Belt

1. Install belt on to sprocket and pulley.
2. Turn axle adjusters equal turns to take slack out of belt.
3. Adjust belt tension:
 - a. 57-63 Hz if new.
 - b. 48-52Hz if in service.
 - c. Or, adjust using Special Tool to 1/4 to 3/8-inch deflection.
Special Tool: BELT TENSION GAUGE (HD-35381-A)
4. Lower vehicle and remove jack.
5. Tighten axle nut.
Torque: 129–142 N·m (95–105 ft-lbs)
6. Install E-clip on axle.

Install Right Foot Bracket

1. Install right foot bracket assembly. Tighten.
Torque: 28–36 N·m (21–27 ft-lbs)
2. Install brake line/wire harness caddy. Tighten.
Torque: 5–7 N·m (44–62 **in-lbs**)
3. Install front right P-clip. Tighten.
Torque: 5–7 N·m (44–62 **in-lbs**)
4. Install motor cover. Tighten.
Torque: 5.9–6.5 N·m (52–58 **in-lbs**)

Install Belt Guard

1. Install upper and lower belt guards. Tighten.
Torque: 5.9–6.5 N·m (52–58 **in-lbs**)
2. Install sprocket cover and screws. Tighten.
Torque: 5.9–6.5 N·m (52–58 **in-lbs**)

Install Left Foot Bracket

1. Install left foot bracket. Tighten.
Torque: 28–36 N·m (21–27 ft-lbs)

Install Skid Plate

1. Place skid plate underneath vehicle.
2. Connect OBC filter harness to PEU.
 - a. Ensure harness crosses over the Inlet harness and under the coolant hoses.

3. Connect coolant hose retaining clip. Ensure the lock is oriented facing down and position rear of the white alignment marks on the hose. This will help prevent contact with side stand spring.
4. Connect Inlet harness to OBC filter assembly.
 - a. Ensure both connector locks are fully engaged.
5. Lift skid plate and route the ground strap under the OBC filter.

6. Install skid plate screws. Tighten.
Torque: 12.9–14.4 N·m (10–11 ft-lbs)
7. Install ground strap screw. Tighten.
Torque: 5–7 N·m (44–62 **in-lbs**)

Energize Vehicle

1. Remove fuse block cover.
2. Install 40 amp fuse.
3. Stow fuse block in rear caddy.

Complete

1. Install top cover. Tighten fasteners.
Torque: 5.9–6.5 N·m (52–58 **in-lbs**)
2. Turn vehicle ignition ON.
3. Connect Digital Technician II (DT II).
4. Navigate to Vehicle Setup.
5. Select Resolver Offset and perform the procedure.
6. Check Diagnostic Trouble Codes (DTCs). Clear if any are found.
7. If any DTCs return. See the Electrical Diagnostic Manual (EDM) to troubleshoot.
8. Install seat. See service manual.

Credit Procedure

NOTE

Enter bulletin and any part numbers with quantities replaced into comment section of claim.

Submit a warranty claim per Table 3.

Table 3. S2 Del Mar Fastener Inspection

ITEM	DATA
Claim Type	Recall
Customer Concern Code	1002
Condition Code	9981
Problem Part Number	10100089
Replacement Part Number	N/A
Quantity	N/A
Model	S2 Del Mar
Model Year	2024
Labor Time	3 hours
<i>(1) Download may be required</i>	