

REFERENCE:	Nova Bus Manuals
SECTION:	09 : Alternator and voltage regulator
RS N°:	MQR 7621-2758
EFFECTIVE IN PROD.:	LF51-033
TC RECALL N°:	N/A
NHTSA RECALL N°:	24v203

APPLICATION DEADLINES: N/A CLAIM
REFERENCE NUMBER: SR5570

SUBJECT:	Alternator power cables
JUSTIFICATION:	The alternator power cable nut may not have been tightened properly.

LEVEL	DESCRIPTION	DIRECT CHARGES		TIME
		LABOUR	MATERIAL	
1	Inspection of the alternator terminal hardware for proper stack up and torque.	Nova Bus	Nova Bus	30 min
2	Replace damaged cables if required.	Nova Bus	Nova Bus	1h

MATERIAL REQUIRED PER VEHICLE

QTY	PART N°	REV.	DESCRIPTION
LEVEL 1			
-	-	-	-
LEVEL 2 (only if required**)			
1	N101828-05	-	CABLE ASSY C1401 4/0 AWG BK-RD (positive)
1	N101827-05	-	CABLE ASSY C1400 4/0 AWG BK (negative)
1	N8951904	-	EMP alternator stud hardware kit

Materials will be available within 63 days once your order has been placed.

To order, please contact novabus.parts@volvo.com

Or by phone for CANADA 1-800-771-6682, for USA 1-877-999-8808

Specify document number, quantity of parts required and shipping address.

**The material identified in Level 2 is to be ordered only for vehicles that meet the criteria defined in Level 1.

DISPOSAL OF PARTS

REMOVED PARTS ARE:	DISCARDED	RETAINED	* Dispose of the unused parts and the defective parts in accordance with local environmental standards in effect.
	*		
	Yes	-	

REVISION HISTORY

REV.	DATE	CHANGE DESCRIPTION	WRITTEN BY
NR	2024AL03	Initial release	André Pelletier

APPROVED BY:

PAGE 1 OF 9

CLIENT	ORDER	ROAD NUMBER		VIN (2NVY/4RKY...)		QTY
		FROM	TO	FROM	TO	
New York City Transit - NYCT - New York	LD06	8755	8758	L82J3L9	[REDACTED]	4
New York City Transit - NYCT - New York	LD08	8759	8963	L82J5M9	[REDACTED]	205
Trimet - Portland, Oregon	LD14	4501	4501	S92J3M9	[REDACTED]	1
Trimet - Portland, Oregon	LD15	4502	4531	S92J6M9	[REDACTED]	30
Chicago Transit Authority - CTA - Illinois	LD75	—	—	L82J0M9	[REDACTED]	1
Maryland Transit Administration - MTA - Maryland	LD82	21001	21070	L82J2M9	[REDACTED]	70
San Juan Puerto Rico – AMA	LE06	2021-11	2021-17	L82JXM9	[REDACTED]	7
Ames Transportation Agency - Iowa	LE35	6149	6149	S92J2M9	[REDACTED]	1
Maryland Transit Administration - MTA - Maryland	LE53	22001	22070	L82JXN9	[REDACTED]	70
Mack Defense	LE68	—	—	L82J6N9	[REDACTED]	4
Ann Arbor Area Transportation Authority Michigan - AAATA	LE73	2200	2207	L82JXN9	[REDACTED]	8
Ames Transportation Agency - Iowa	LE80	6150	6150	S92J0N9	[REDACTED]	1
San Juan Puerto Rico – AMA	LE83	2022-01	2022-11	L82J0N9	[REDACTED]	11
New York City Transit - NYCT - New York	LE84	8964	8964	L82J7N9	[REDACTED]	1
New York City Transit - NYCT - New York	LE84	8965	8965	L82J9N9	[REDACTED]	1
New York City Transit - NYCT - New York	LE84	8966	8966	L82J0N9	[REDACTED]	1
New York City Transit - NYCT - New York	LE84	8968	8968	L82J9N9	[REDACTED]	1
New York City Transit - NYCT - New York	LE84	8970	8970	L82J1N9	[REDACTED]	1
New York City Transit - NYCT - New York	LE84	8972	8972	L82J5N9	[REDACTED]	1
New York City Transit - NYCT - New York	LE84	8973	8973	L82J7N9	[REDACTED]	1
New York City Transit - NYCT - New York	LE84	8975	8975	L82J1P9	[REDACTED]	1
New York City Transit - NYCT - New York	LE84	8977	8977	L82J6P9	[REDACTED]	1
New York City Transit - NYCT - New York	LE84	8978	8978	L82J8P9	[REDACTED]	1
New York City Transit - NYCT - New York	LE84	8979	8979	L82JXP9	[REDACTED]	1
New York City Transit - NYCT - New York	LE84	8983	8983	L82J4P9	[REDACTED]	1
New York City Transit - NYCT - New York	LE84	8985	8985	L82J3P9	[REDACTED]	1
New York City Transit - NYCT - New York	LE84	8987	8987	L82J1P9	[REDACTED]	1
New York City Transit - NYCT - New York	LE84	8988	8988	L82J3P9	[REDACTED]	1
New York City Transit - NYCT - New York	LE84	8989	8989	L82J5P9	[REDACTED]	1
New York City Transit - NYCT - New York	LE84	8990	8990	L82J7P9	[REDACTED]	1
New York City Transit - NYCT - New York	LE84	8991	8991	L82J2P9	[REDACTED]	1
New York City Transit - NYCT - New York	LE84	8992	8992	L82J4P9	[REDACTED]	1
New York City Transit - NYCT - New York	LE84	8993	8993	L82J6P9	[REDACTED]	1
New York City Transit - NYCT - New York	LE84	8994	8994	L82J8P9	[REDACTED]	1
New York City Transit - NYCT - New York	LE84	8995	8995	L82JXP9	[REDACTED]	1
New York City Transit - NYCT - New York	LE84	8996	8996	L82J4P9	[REDACTED]	1
New York City Transit - NYCT - New York	LE84	8997	8997	L82J6P9	[REDACTED]	1
New York City Transit - NYCT - New York	LE84	8998	8998	L82J8P9	[REDACTED]	1
New York City Transit - NYCT - New York	LE84	8999	8999	L82JXP9	[REDACTED]	1
New York City Transit - NYCT - New York	LE84	9000	9000	L82J1P9	[REDACTED]	1
New York City Transit - NYCT - New York	LE84	9001	9001	L82J3P9	[REDACTED]	1
New York City Transit - NYCT - New York	LE84	9002	9002	L82J5P9	[REDACTED]	1

CLIENT	ORDER	ROAD NUMBER		VIN (2NVY/4RKY...)		QTY
		FROM	TO	FROM	TO	
New York City Transit - NYCT - New York	LE84	9003	9003	L82J7P9	[REDACTED]	1
New York City Transit - NYCT - New York	LE84	9004	9004	L82J3P9	[REDACTED]	1
New York City Transit - NYCT - New York	LE84	9005	9005	L82J5P9	[REDACTED]	1
New York City Transit - NYCT - New York	LE84	9007	9007	L82J9P9	[REDACTED]	1
New York City Transit - NYCT - New York	LE84	9008	9008	L82J0P9	[REDACTED]	1
New York City Transit - NYCT - New York	LE84	9009	9009	L82J2P9	[REDACTED]	1
New York City Transit - NYCT - New York	LE84	9010	9010	L82J4P9	[REDACTED]	1
New York City Transit - NYCT - New York	LE84	9011	9011	L82J6P9	[REDACTED]	1
New York City Transit - NYCT - New York	LE84	9012	9012	L82J1P9	[REDACTED]	1
New York City Transit - NYCT - New York	LE84	9013	9013	L82J3P9	[REDACTED]	1
New York City Transit - NYCT - New York	LE84	9014	9014	L82J5P9	[REDACTED]	1
New York City Transit - NYCT - New York	LE84	9016	9016	L82J9P9	[REDACTED]	1
New York City Transit - NYCT - New York	LE84	9017	9017	L82J0P9	[REDACTED]	1
New York City Transit - NYCT - New York	LE84	9019	9019	L82J9P9	[REDACTED]	1
New York City Transit - NYCT - New York	LE84	9020	9020	L82J0P9	[REDACTED]	1
New York City Transit - NYCT - New York	LE84	9022	9022	L82J4P9	[REDACTED]	1
New York City Transit - NYCT - New York	LE84	9023	9023	L82J6P9	[REDACTED]	1
New York City Transit - NYCT - New York	LE84	9024	9024	L82J8P9	[REDACTED]	1
New York City Transit - NYCT - New York	LE84	9025	9025	L82JXP9	[REDACTED]	1
New York City Transit - NYCT - New York	LE84	9027	9027	L82J4P9	[REDACTED]	1
New York City Transit - NYCT - New York	LE84	9028	9028	L82J6P9	[REDACTED]	1
New York City Transit - NYCT - New York	LE84	9029	9029	L82J8P9	[REDACTED]	1
New York City Transit - NYCT - New York	LE84	9030	9030	L82J4P9	[REDACTED]	1
New York City Transit - NYCT - New York	LE84	9031	9031	L82J6P9	[REDACTED]	1
New York City Transit - NYCT - New York	LE84	9033	9033	L82J7P9	[REDACTED]	1
New York City Transit - NYCT - New York	LE84	9034	9034	L82J9P9	[REDACTED]	1
New York City Transit - NYCT - New York	LE84	9035	9035	L82J0P9	[REDACTED]	1
New York City Transit - NYCT - New York	LE84	9036	9036	L82J2P9	[REDACTED]	1
New York City Transit - NYCT - New York	LE84	9037	9037	L82J4P9	[REDACTED]	1
New York City Transit - NYCT - New York	LE84	9038	9038	L82J6P9	[REDACTED]	1
New York City Transit - NYCT - New York	LE84	9039	9039	L82J8P9	[REDACTED]	1
New York City Transit - NYCT - New York	LE84	9040	9040	L82JXP9	[REDACTED]	1
New York City Transit - NYCT - New York	LE84	9041	9041	L82J1P9	[REDACTED]	1
New York City Transit - NYCT - New York	LE84	9042	9042	L82J3P9	[REDACTED]	1
New York City Transit - NYCT - New York	LE84	9043	9043	L82JXP9	[REDACTED]	1
New York City Transit - NYCT - New York	LE84	9044	9044	L82J1P9	[REDACTED]	1
New York City Transit - NYCT - New York	LE84	9045	9045	L82J3P9	[REDACTED]	1
New York City Transit - NYCT - New York	LE84	9046	9046	L82J5P9	[REDACTED]	1
New York City Transit - NYCT - New York	LE84	9048	9048	L82J6P9	[REDACTED]	1
New York City Transit - NYCT - New York	LE84	9049	9049	L82J2P9	[REDACTED]	1
New York City Transit - NYCT - New York	LE84	9051	9051	L82J6P9	[REDACTED]	1
New York City Transit - NYCT - New York	LE84	9052	9052	L82J8P9	[REDACTED]	1
New York City Transit - NYCT - New York	LE84	9053	9053	L82JXP9	[REDACTED]	1

CLIENT	ORDER	ROAD NUMBER		VIN (2NVY/4RKY...)		QTY
		FROM	TO	FROM	TO	
New York City Transit - NYCT - New York	LE84	9056	9056	L82J5P9	L82J5P9	1
New York City Transit - NYCT - New York	LE84	9060	9060	L82J6P9	L82J6P9	1
New York City Transit - NYCT - New York	LE84	9061	9061	L82J8P9	L82J8P9	1
New York City Transit - NYCT - New York	LE84	9063	9063	L82J1P9	L82J1P9	1
New York City Transit - NYCT - New York	LE84	9064	9064	L82J4P9	L82J4P9	1
New York City Transit - NYCT - New York	LE84	9067	9067	L82J0P9	L82J0P9	1
New York City Transit - NYCT - New York	LE84	9068	9068	L82J7P9	L82J7P9	1
New York City Transit - NYCT - New York	LE84	9070	9070	L82J1P9	L82J1P9	1
New York City Transit - NYCT - New York	LE84	9074	9074	L82J9P9	L82J9P9	1
New York City Transit - NYCT - New York	LE84	9078	9078	L82J8P9	L82J8P9	1
New York City Transit - NYCT - New York	LE84	9080	9080	L82J2P9	L82J2P9	1
New York City Transit - NYCT - New York	LE84	9081	9081	L82J4P9	L82J4P9	1
New York City Transit - NYCT - New York	LE84	9083	9083	L82J6P9	L82J6P9	1
New York City Transit - NYCT - New York	LE84	9084	9084	L82J8P9	L82J8P9	1
New York City Transit - NYCT - New York	LE84	9085	9085	L82J3P9	L82J3P9	1
New York City Transit - NYCT - New York	LE84	9086	9086	L82J5P9	L82J5P9	1
New York City Transit - NYCT - New York	LE84	9093	9093	L82J5P9	L82J5P9	1
Rochester New York - RTS	LE92	2221	2247	L82J5N9	L82J8N9	27
Puerto Rico Highway and Transportation Authority – PRHTA	LF14	23-01	23-09	L82J0P9	L82JXP9	9
Rochester New York - RTS	LF26	2301	2309	L82J3P9	L82J2P9	9
San Juan Puerto Rico – AMA	LF41	2022-12	2022-12	L82J8P9	L82J8P9	1
Maryland Transit Administration - MTA - Maryland	LF46	23001	23001	L82J1P9	L82J1P9	1
Maryland Transit Administration - MTA - Maryland	LF46	23006	23006	L82J4P9	L82J4P9	1
Maryland Transit Administration - MTA - Maryland	LF46	23007	23007	L82J6P9	L82J6P9	1
Maryland Transit Administration - MTA - Maryland	LF46	23008	23008	L82J8P9	L82J8P9	1
Maryland Transit Administration - MTA - Maryland	LF46	23009	23009	L82JXP9	L82JXP9	1
Maryland Transit Administration - MTA - Maryland	LF46	23010	23010	L82J1P9	L82J1P9	1
Maryland Transit Administration - MTA - Maryland	LF46	23011	23011	L82J9P9	L82J9P9	1
Maryland Transit Administration - MTA - Maryland	LF46	23012	23012	L82J0P9	L82J0P9	1
Maryland Transit Administration - MTA - Maryland	LF46	23013	23013	L82J2P9	L82J2P9	1
Maryland Transit Administration - MTA - Maryland	LF46	23014	23014	L82J4P9	L82J4P9	1
Maryland Transit Administration - MTA - Maryland	LF46	23015	23015	L82J6P9	L82J6P9	1
Maryland Transit Administration - MTA - Maryland	LF46	23016	23016	L82J2P9	L82J2P9	1
Maryland Transit Administration - MTA - Maryland	LF46	23017	23017	L82J4P9	L82J4P9	1
Maryland Transit Administration - MTA - Maryland	LF46	23018	23018	L82J6P9	L82J6P9	1
Maryland Transit Administration - MTA - Maryland	LF46	23019	23019	L82J2P9	L82J2P9	1
Maryland Transit Administration - MTA - Maryland	LF46	23020	23020	L82J4P9	L82J4P9	1
Maryland Transit Administration - MTA - Maryland	LF46	23021	23021	L82J5P9	L82J5P9	1
Maryland Transit Administration - MTA - Maryland	LF46	23022	23022	L82J7P9	L82J7P9	1
Maryland Transit Administration - MTA - Maryland	LF46	23023	23023	L82J9P9	L82J9P9	1
Maryland Transit Administration - MTA - Maryland	LF46	23024	23024	L82J5P9	L82J5P9	1
Maryland Transit Administration - MTA - Maryland	LF46	23025	23025	L82J7P9	L82J7P9	1
Maryland Transit Administration - MTA - Maryland	LF46	23026	23026	L82J9P9	L82J9P9	1

CLIENT	ORDER	ROAD NUMBER		VIN (2NVY/4RKY...)		QTY
		FROM	TO	FROM	TO	
Maryland Transit Administration - MTA - Maryland	LF46	23027	23027	L82J0P9	[REDACTED]	1
Maryland Transit Administration - MTA - Maryland	LF46	23028	23028	L82J2P9	[REDACTED]	1
Maryland Transit Administration - MTA - Maryland	LF46	23029	23029	L82J4P9	[REDACTED]	1
Maryland Transit Administration - MTA - Maryland	LF46	23030	23030	L82J6P9	[REDACTED]	1
Maryland Transit Administration - MTA - Maryland	LF46	23031	23031	L82J8P9	[REDACTED]	1
Maryland Transit Administration - MTA - Maryland	LF46	23032	23032	L82JXP9	[REDACTED]	1
Maryland Transit Administration - MTA - Maryland	LF46	23033	23033	L82J1P9	[REDACTED]	1
Maryland Transit Administration - MTA - Maryland	LF46	23034	23034	L82J8P9	[REDACTED]	1
Maryland Transit Administration - MTA - Maryland	LF46	23035	23035	L82JXP9	[REDACTED]	1
Maryland Transit Administration - MTA - Maryland	LF46	23036	23036	L82J1P9	[REDACTED]	1
Maryland Transit Administration - MTA - Maryland	LF46	23037	23037	L82J3P9	[REDACTED]	1
Maryland Transit Administration - MTA - Maryland	LF46	23038	23038	L82J5P9	[REDACTED]	1
Maryland Transit Administration - MTA - Maryland	LF46	23039	23039	L82J7P9	[REDACTED]	1
Maryland Transit Administration - MTA - Maryland	LF46	23040	23040	L82J9P9	[REDACTED]	1
Maryland Transit Administration - MTA - Maryland	LF46	23041	23041	L82J0P9	[REDACTED]	1
Maryland Transit Administration - MTA - Maryland	LF46	23042	23042	L82J2P9	[REDACTED]	1
Maryland Transit Administration - MTA - Maryland	LF46	23043	23043	L82J0P9	[REDACTED]	1
Maryland Transit Administration - MTA - Maryland	LF46	23044	23044	L82J2P9	[REDACTED]	1
Maryland Transit Administration - MTA - Maryland	LF46	23045	23045	L82J4P9	[REDACTED]	1
Maryland Transit Administration - MTA - Maryland	LF46	23046	23046	L82J6P9	[REDACTED]	1
Maryland Transit Administration - MTA - Maryland	LF46	23047	23047	L82J8P9	[REDACTED]	1
Maryland Transit Administration - MTA - Maryland	LF46	23048	23048	L82JXP9	[REDACTED]	1
Maryland Transit Administration - MTA - Maryland	LF46	23049	23049	L82J1P9	[REDACTED]	1
Maryland Transit Administration - MTA - Maryland	LF46	23050	23050	L82J3P9	[REDACTED]	1
Maryland Transit Administration - MTA - Maryland	LF46	23051	23051	L82J5P9	[REDACTED]	1
Maryland Transit Administration - MTA - Maryland	LF46	23052	23052	L82J7P9	[REDACTED]	1
Maryland Transit Administration - MTA - Maryland	LF46	23053	23053	L82JXP9	[REDACTED]	1
Maryland Transit Administration - MTA - Maryland	LF46	23054	23054	L82J1P9	[REDACTED]	1
Maryland Transit Administration - MTA - Maryland	LF46	23055	23055	L82J3P9	[REDACTED]	1
Maryland Transit Administration - MTA - Maryland	LF46	23056	23056	L82J5P9	[REDACTED]	1
Maryland Transit Administration - MTA - Maryland	LF46	23058	23058	L82J9P9	[REDACTED]	1
Maryland Transit Administration - MTA - Maryland	LF46	23059	23059	L82J0P9	[REDACTED]	1
Maryland Transit Administration - MTA - Maryland	LF46	23060	23060	L82J2P9	[REDACTED]	1
Maryland Transit Administration - MTA - Maryland	LF46	23061	23061	L82J4P9	[REDACTED]	1
Maryland Transit Administration - MTA - Maryland	LF46	23064	23064	L82J4P9	[REDACTED]	1
Maryland Transit Administration - MTA - Maryland	LF46	23065	23065	L82J6P9	[REDACTED]	1
Maryland Transit Administration - MTA - Maryland	LF46	23066	23066	L82J8P9	[REDACTED]	1
New York City Transit - NYCT - New York	LF51	9099	9099	L82J4P9	[REDACTED]	1

**WARNING**

FOLLOW YOUR INTERNAL SAFETY PROCEDURES.

PROCEDURE

- 1.1. Park the vehicle on an even surface with the transmission on neutral.
- 1.2. Apply the parking brake and set the master control switch to the **stop** position.
- 1.3. Set the battery disconnect switch in the battery compartment to the **off** position.

**CAUTION**

Wait 10 minutes after the battery disconnect switch has been placed in the off position. This step will maintain the electronic circuit's discharge path and protect the engine's electronic control module (ECM).

- 1.4. Disconnect all cables from the batteries positive terminals.
- 1.5. Disconnect all cables from the batteries negative terminals.
- 1.6. To get access to the alternator power cables terminals from the inside of the vehicle, remove the bolts and lift the mid section of the rear cross seat. Secure it for the duration of the repair.

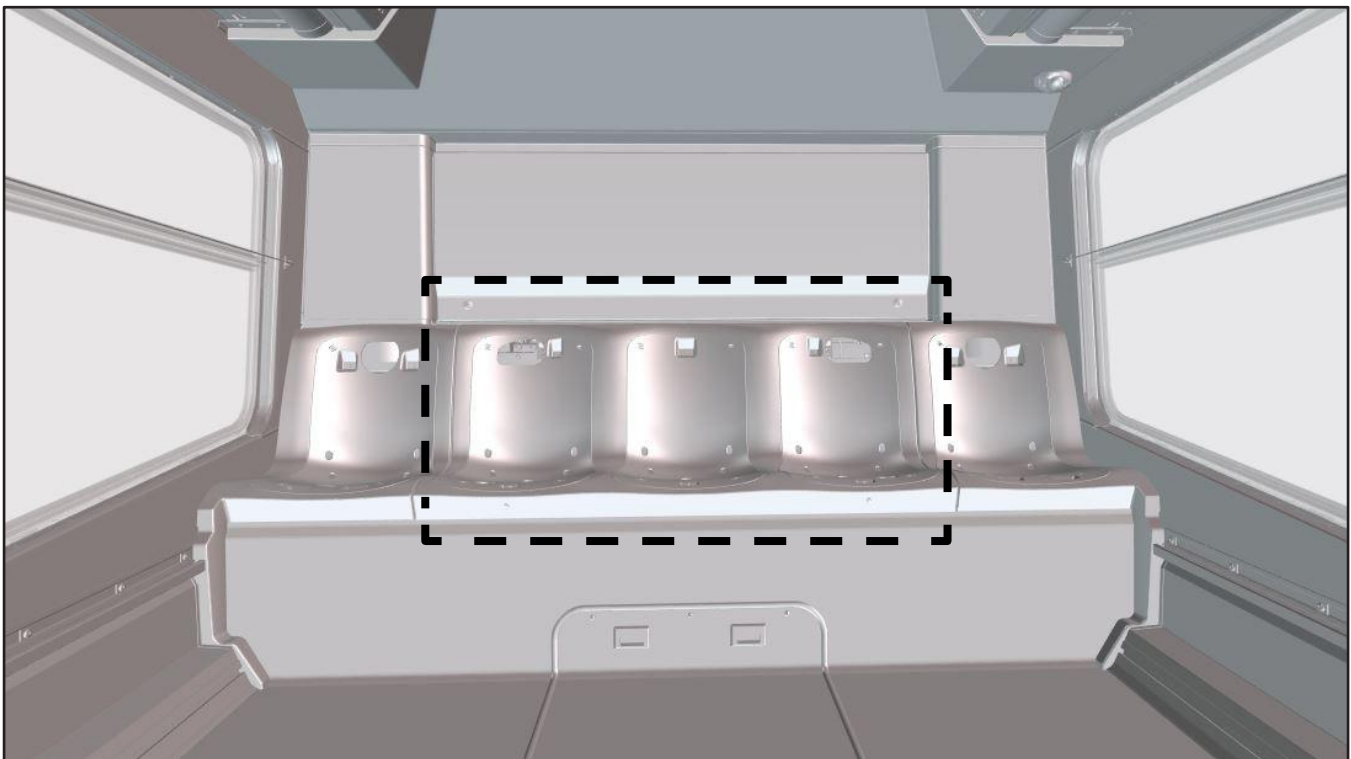

Figure 1 - Lift the Rear Cross Seat

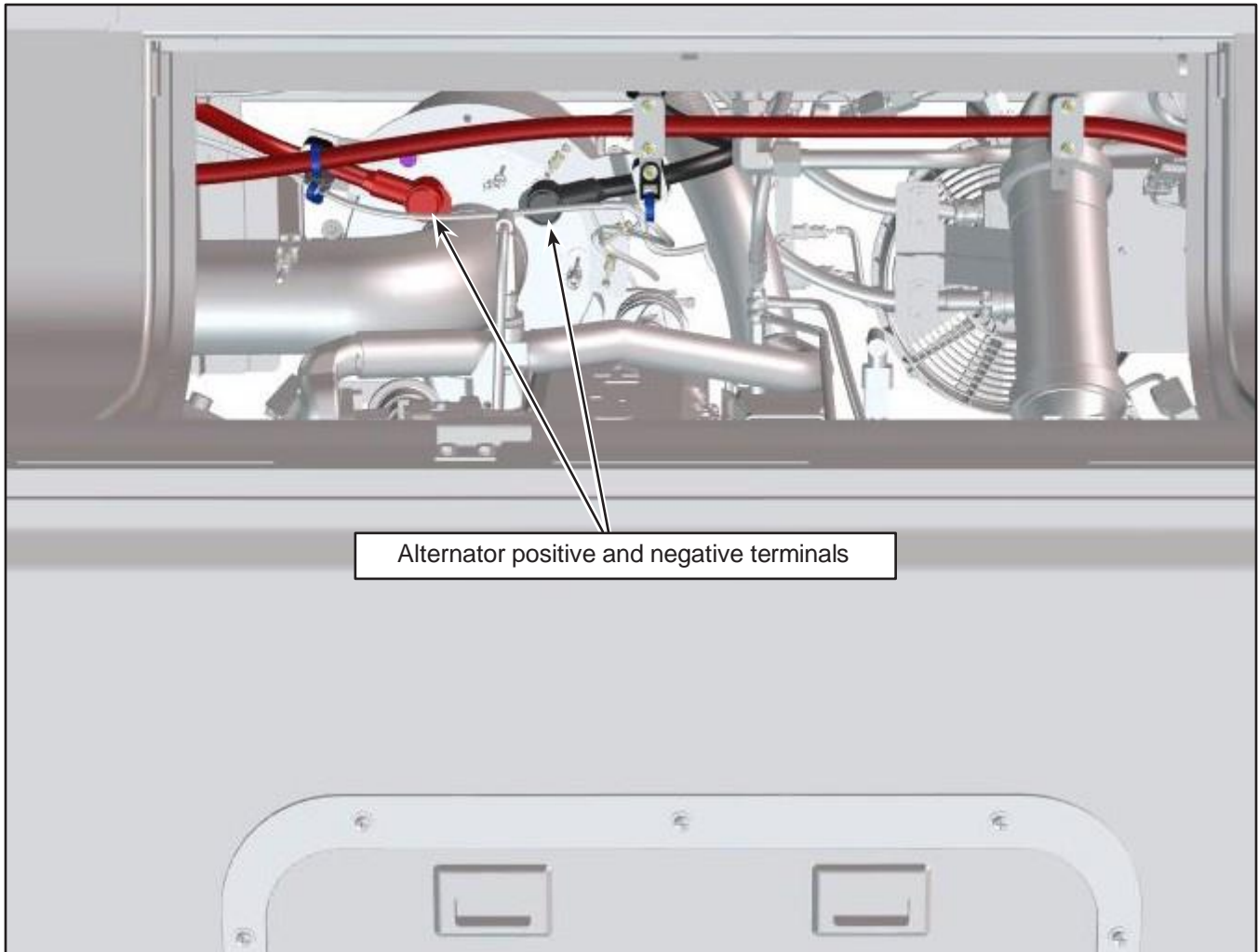

Figure 2 - Alternator Power Cables Location, View From the Cross Seat Access

- 1.7. Move the protective boots and inspect the positive and the negative cables to make sure there are no signs of arcing near the alternator terminals. If there is damages or insulation looks bubbled, then replace the cable. See the level 2 on page 9.

1.8. Verify the correct stacking of the hardware for each terminal. See the next figure.

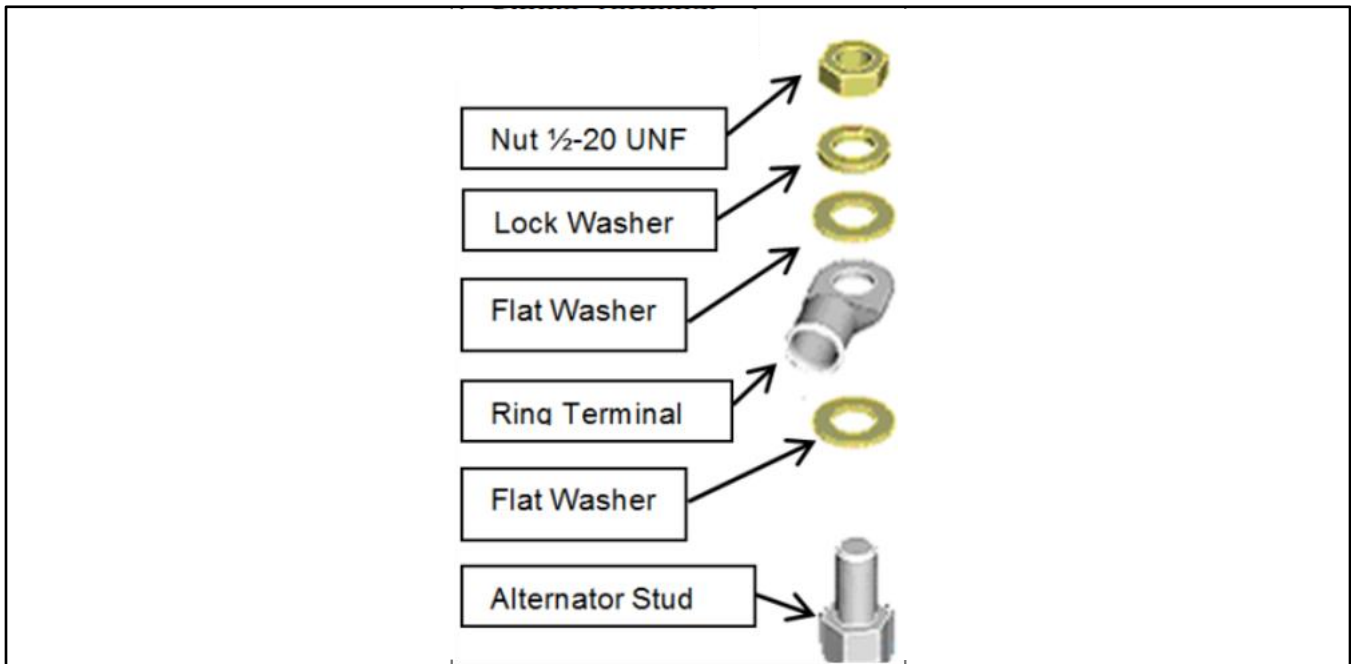

Figure 3 - Verify the Correct Stacking

- 1.9. If the stacking is correct, apply a torque of 32 to 35 lb-ft (41 to 47 N·m) to the nut. Apply a torque seal then NCP2 corrosion preventative like N67314 to the exposed metal.
- 1.10. If the stacking is incorrect. Use a brake cleaner, like N8951729 or equivalent, to remove any corrosion preventative on the terminals, flat washers and alternator studs. Do the assembly as per the figure 3. Apply a torque of 32 to 35 lb-ft (41 to 47 N·m) to the nut. Apply a torque seal then NCP2 corrosion preventative like N67314 to the exposed metal of the terminals, cables, studs and hardware.
- 1.11. Reinstall the boot cover of each terminal.
- 1.12. Reinstall the cross seat section, applying a torque of 17 ± 1.5 lb-ft (23 ± 2 N·m) to the screws.



WARNING

Connect the batteries after the repair is completed. See your manual section 16: Batteries for the procedure.

- 1.13. The vehicle can return to service.

LEVEL 2: CABLE REPLACEMENT

- 2.1. If any signs of arcing or damaged were found, replace the cable according to the material list level 2 on page 1.
- 2.2. Install the new cable, refer to the next figure.
- 2.3. Once the new cable is installed, refer to the figure 3 and the step 1.9 for the proper stacking and torque on the alternator studs and NCP2 application. Then finish the level 1 procedure steps 1.11 to 1.13.

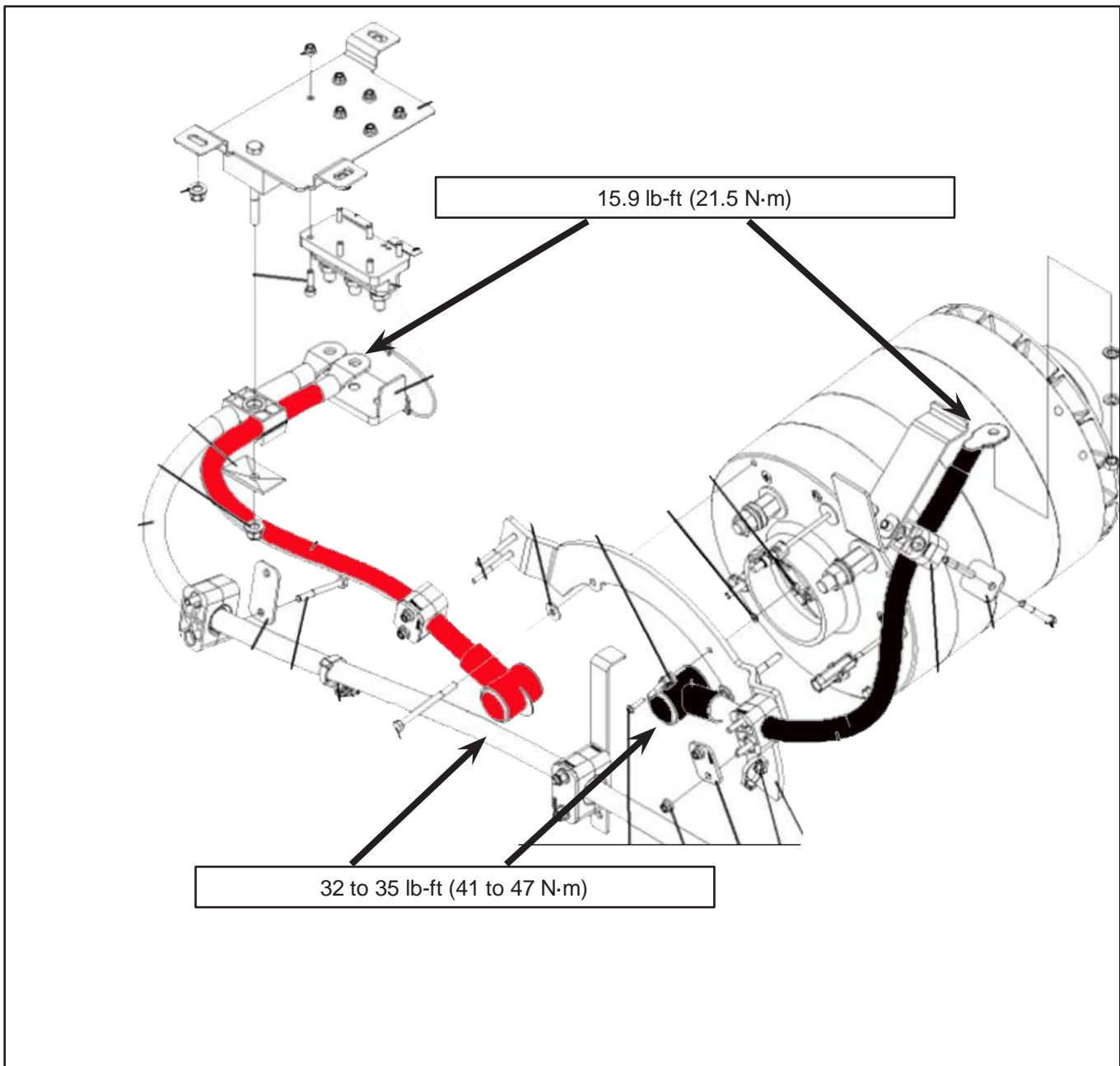

Figure 4 - Exploded View